



BRAND Hadco by Signify

DESCRIPTION

DUL1D Composite LED Wall Mount Decklyte is fabricated from one piece injection molded high performance polymer composite. Composite is textured, pressure formed, molded in color in Black, Verde or Bronze finish. Frosted annealed glass lens. Reflector is a stamped specular aluminum. 1.7 watt LED included. Available with Cool 4000K or Warm 3000K color temperature. Pre-wired with a 6 foot pigtail of 18-2 AWG wire. 3.5 inch diameter x 1.9 inches deep. ETL listed for wet locations. IP67 Rating. Requires magnetic remote transformer not included.



SHADE COLOR	Frosted
BODY FINISH	Black
WATTAGE	1.7W
DIMMER	Dimmable
DIMENSIONS	3.5"W x 1.9"D
INTEGRATED LED MODULE	
LAMP	1 x LED/12V LED

Technical Information

LAMP COLOR	3000K
COLOR RENDERING	80 CRI

SPEC # HAD119588

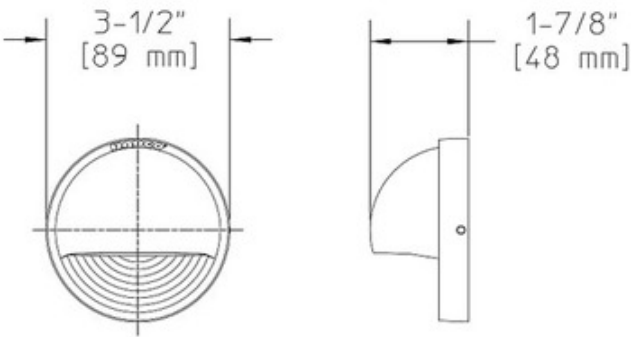

COMPANY	PROJECT	FIXTURE TYPE	APPROVED BY	DATE