



BRAND

Contrast Lighting

DESCRIPTION

Eco Series LED 4 Inch Insulated Ceiling Housing with electronic driver is made of galvanized steel construction and features below ceiling accessibility for maintenance. Perfect fit to ceiling with no light leakage. Meets Air Tight ASTM-283 requirements. Includes 120 volt power supply driver. Available in 6 watt and 10 watt in 2700K or 3000K color temperature with narrow flood or wide flood beam (to be selected with the trim option). Dimmable at 120 volts with compatible electronic low voltage dimmers that use reverse phase technology (recommended Lutron DIVA DVW-603PH, Lutron Maestro MAELV-600, Lutron Maestro MAW-600H, or Lutron Skylark S-603PR). Installation cutout 4.25 inch. Installs in ceilings up to 1.5 inch thick. Available in Chicago Plenum or California Title 24 version upon request. cUL listed. Compatible trims include ECOL2A Round Adjustable, ECOL2B Shower and ECOL2C Round Adjustable Regressed. Mounting bars extend from 10 to 24.5 inches. 13.5 inch length x 10 inch width x 6.1 inch height. Includes 5 year warranty on LED module and driver.



TRIM COLOR	N/A
BODY FINISH	Galvanized Steel
WATTAGE	N/A
DIMMER	Low Voltage Electronic
DIMENSIONS	13.5"L x 10"W x 6.1"H
BULB NOT INCLUDED	
LAMP	LED/120V LED

SPEC #

CLT168113

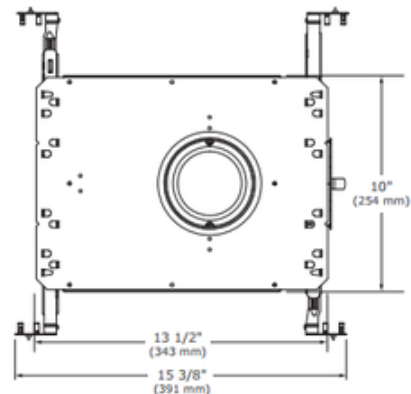
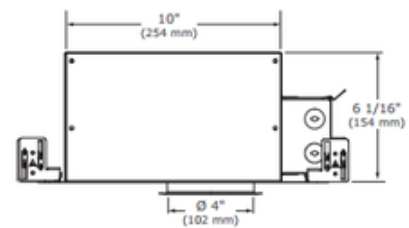

COMPANY

PROJECT

FIXTURE TYPE

APPROVED BY

DATE