



BRAND Eurofase

DESCRIPTION

GU4-00 4 Inch 120 Volt Non-IC Retrofit Remodel Housing is intended to be installed in an existing ceiling and inserted into the ceiling through the ceiling cut-out hole. Non-IC designation requires that insulation be kept a minimum of 3 inches away from housing. One 50 watt, 120 volt MR16 type GU10 base halogen bulb (or LED equivalent) is required, but not included. Halogen dimmable with a standard incandescent dimmer, sold separately. Consult with bulb manufacturer for dimmer compatibility when using LED equivalent. ETL listed. 4.38 inch width x 5.25 inch height x 12 inch length. A complete fixture includes a housing and trim, sold separately.



TRIM COLOR	N/A
BODY FINISH	Aluminum
WATTAGE	50W
DIMMER	Dimmable
DIMENSIONS	12"L x 4.38"W x 5.25"H
BULB NOT INCLUDED	
LAMP	1 x MR16/GU10/50W/120V Halogen 1 x MR16/GU10/120V LED
Technical Information	
CEILING TYPE	Drywall with Trim
HOUSING TYPE	Remodel IC
HOUSING HEIGHT	6"
APERTURE SIZE	4.000"
SPEC #	EUF184741

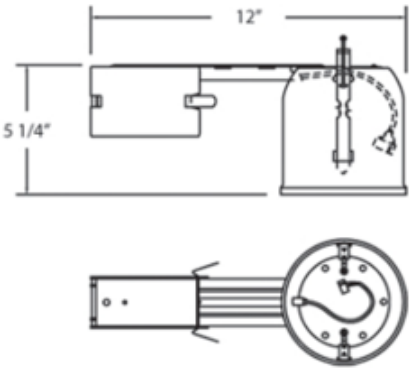

COMPANY	PROJECT	FIXTURE TYPE	APPROVED BY	DATE