



BRAND Lightolier by Signify

DESCRIPTION

1000LVR Lytecaster 5 Inch Low Voltage MR16 Non-IC Remodel Frame-In Kit is made of 20 gauge galvanized steel and will accommodate existing ceilings up to 2 inches thick. Non-IC designation requires that insulation be kept a minimum of 3 inches away from housing. Includes outboard magnetic low voltage transformer, removable from below. UL listed. Suitable for damp locations. 13.25 inch width x 5.5 inch depth. Overall height dependent on selected trim option. Lamp type and wattage dependent on frame-in kit/trim combination. A complete fixture includes a frame-in kit and a trim kit, sold separately. Dimmable with a low voltage magnetic dimmer if used with a halogen MR16 lamp.



TRIM COLOR	N/A
BODY FINISH	Galvanized Steel
WATTAGE	75W
DIMMER	Dimmable
DIMENSIONS	13.25"W x 5.5"D
BULB NOT INCLUDED	
LAMP	1 x MR16/GU5.3 (bipin)/75W/12V Halogen 1 x MR16/GU5.3 (bipin)/12V LED

Technical Information

CEILING TYPE	Drywall with Trim
HOUSING TYPE	Remodel NON IC
HOUSING HEIGHT	4"
APERTURE SIZE	5.000"

SPEC # LTL18965

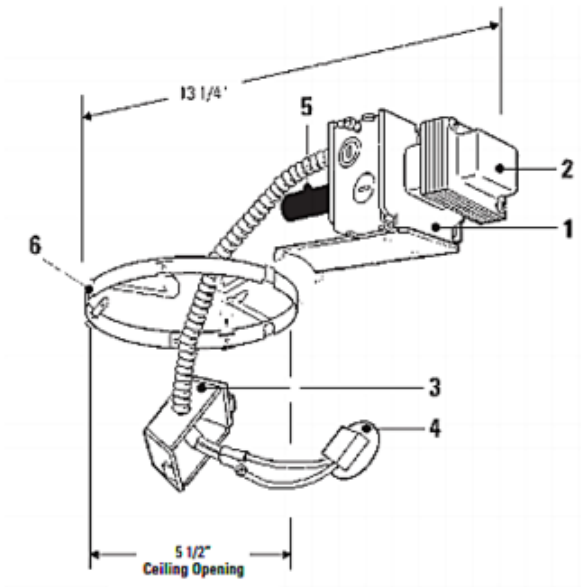

COMPANY	PROJECT	FIXTURE TYPE	APPROVED BY	DATE