



BRAND Lightolier by Signify

DESCRIPTION

Lytecaster 1100AICM 6.75 Inch Incandescent AirSeal Insulated Ceiling Frame-In Kit is made of galvanized steel. IC designation allows for direct contact with thermal insulation. AirSeal housing minimizes air leakage to less than 2CFM at 1.57 PSF and reduces heat loss and condensation in ceiling. Accommodates all ceilings up to 1 inch thick. UL listed. Suitable for damp locations. Dimensions: 15.5 inch width x 9 inch depth x 7.3 inch height. Lamp type and wattage dependent on frame-in kit/trim combination. A complete fixture includes a frame-in kit and a trim kit, sold separately.



TRIM COLOR	N/A
BODY FINISH	Galvanized Steel
WATTAGE	72W
DIMMER	Dimmable
DIMENSIONS	15.5"W x 7.3"H x 9"D
BULB NOT INCLUDED	
LAMP	1 x A19/Medium (E26)/72W/120V Incandescent 1 x BR40/Medium (E26)/120V Incandescent 1 x PAR38/Medium (E26)/120V Halogen 1 x BR30/Medium (E26)/120V Incandescent 1 x A19/Medium (E26)/120V LED

Technical Information

CEILING TYPE	Drywall with Trim
HOUSING TYPE	New construction IC Airtight
HOUSING HEIGHT	7"
APERTURE SIZE	6.750"

SPEC # LTL19053

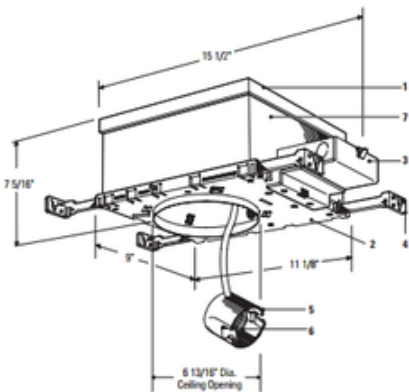

COMPANY	PROJECT	FIXTURE TYPE	APPROVED BY	DATE