



### BRAND

WAC Lighting

### DESCRIPTION

Tesla 3.5 Inch LED Non-IC Airtight New Construction Housing and junction box is made of 20 gauge steel with frame and hanger bars in heavy gauge galvanized steel. Insulation must be kept at least 3 inches away from housing. Three knockouts and three Romex style wiring connectors provided for ease of installation. Supplied with hanger bars adjustable from 14.5 to 24.5 inches including a captive mounting screw nail and integral t-bar clamps. Accommodates surfaces from .5 to 1 inch thickness. Rated for branch wiring. Includes electronic driver, 120VAC 50/60Hz input, 21.5 watt output. 4 5/8 inch cut out. UL listed. 120 volt may be dimmed to 15 percent with an electronic low voltage dimmer, sold separately. 120-277 volt may be dimmed to 10 percent with a 0-10V dimmer, sold separately. ETL listed. 5 year product warranty. Dimensions: 14.5 to 24.5 inch length x 8.25 inch width x 6.6 inch height. A complete fixture consists of a housing and trim, sold separately.



TRIM COLOR	N/A
BODY FINISH	N/A
WATTAGE	21.5W
DIMMER	Dimmable
DIMENSIONS	24.5"L x 8.25"W x 6.6"H
INTEGRATED LED MODULE	
LAMP	1 x LED/21.5W/120V LED

#### Technical Information

COLOR RENDERING	85 CRI
FUNCTION	Downlight
CEILING TYPE	Drywall with Trim
HOUSING TYPE	New construction NON IC Airtight

SPEC #

WAC196628

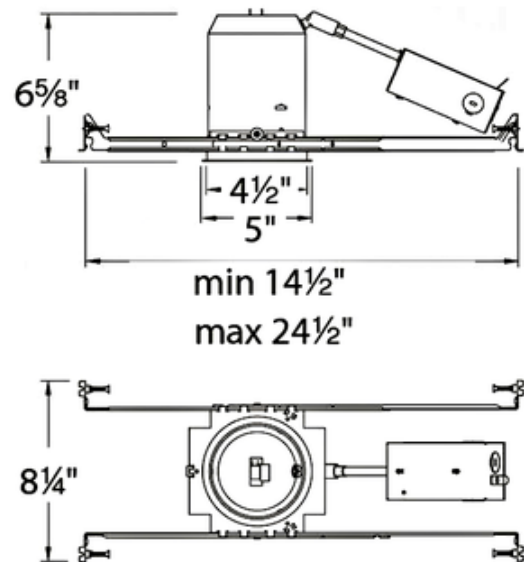

COMPANY

PROJECT

FIXTURE TYPE

APPROVED BY

DATE