



BRAND

Juno Lighting

DESCRIPTION

IC20 5 Inch IC New Construction Housing is an energy efficient aluminum housing. IC designation allows for housing to be completely covered with insulation. Accommodates ceiling thickness up to 1 inch. When used with Air-Loc gasket (ALG5), stops infiltration and exfiltration of air, reducing heating and cooling costs. Trims shown with Air-Loc symbol do not require a gasket. One 120 volt, A19, PAR30, PAR20, R20 or A15 medium base incandescent/halogen or LED equivalent lamp is required, but not included. Lamp type and wattage dependent on housing/trim combination. Halogen/incandescent dimmable with a standard incandescent dimmer. Consult lamp manufacturer for dimmer compatibility when using an LED equivalent. UL listed for through-branch wiring and damp locations. Trims 210N, 211 and 212N are wet location approved for covered ceiling applications. Trims 215 and 216 are wet location approved for covered ceiling applications when used with outdoor rated lamps. 11.9 inch length x 6.75 inch width x 7.5 inch height. A complete fixture includes a housing and trim, sold separately.



Shown in: Aluminum

| | |
|-------------------|--|
| TRIM COLOR | N/A |
| BODY FINISH | Aluminum |
| WATTAGE | N/A |
| DIMMER | Dimmable |
| DIMENSIONS | 11.9"L x 6.75"W x 7.5"H |
| BULB NOT INCLUDED | |
| LAMP | 1 x A19/Medium (E26)/120V Incandescent 1 x A19/Medium (E26)/120V LED 1 x BR30/Medium (E26)/120V Halogen 1 x BR30/Medium (E26)/120V Incandescent 1 x BR30/Medium (E26)/120V LED |

Technical Information

| | |
|--------------------|---------------------|
| CEILING TYPE | Drywall with Trim |
| HOUSING TYPE | New construction IC |
| HOUSING HEIGHT | 8" |
| PRODUCT DIMENSIONS | Cutout: 5.63 inch |

SPEC # JUN25875

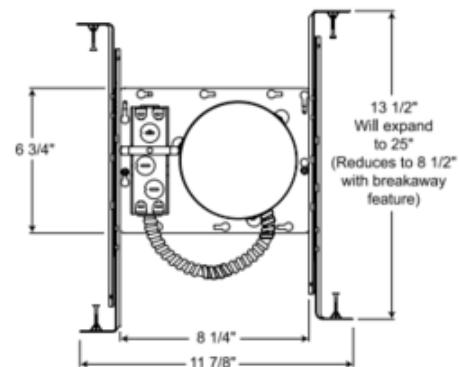
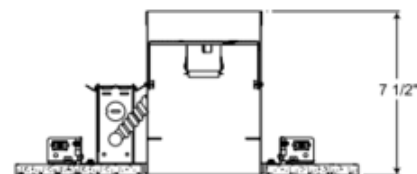

5 5/8" CEILING CUTOUT

| COMPANY | PROJECT | FIXTURE TYPE | APPROVED BY | DATE |
|---------|---------|--------------|-------------|------|
| | | | | |