



BRAND

Juno Lighting

DESCRIPTION

T393 PAR20 Studio I Track Fixture features a drawn steel housing with steel yoke and striking details that will enhance any traditional environment. Finish available in White with a black phenolic baffle. 90 degree vertical aiming capability and 358 degree rotation. One locking knob included. Copper alloy contacts provide precise spring action-no arcing and will not take a set. True, positive electrical ground. On/off switch included. Patented embossed polarity arrows on bottom of adapter. Spring-loaded positive latch with embossed polarity arrows secure track light to track. Pull-up contact to up position for two-circuit application. One 30-50 watt R20 or 35-50 watt PAR20, 120 volt medium base bulb is required, but not included. Halogen and incandescent bulb options dimmable with a standard incandescent dimmer. Check with bulb manufacturer for dimmer compatibility when using LED bulb option. Optional optical accessories available, sold separately. UL listed. Compatible with Juno Lighting Trac-Lites, Trac-Master 1-circuit and Trac-Master 2-circuit 120 volt line voltage track systems.



SHADE COLOR	N/A
BODY FINISH	White
WATTAGE	50W
DIMMER	Standard 120V
DIMENSIONS	3.5"W x 5"D
BULB NOT INCLUDED	
LAMP	1 x PAR20/Medium (E26)/50W/120V Halogen 1 x R20/Medium (E26)/120V LED 1 x PAR20/Medium (E26)/120V LED 1 x R20/Medium (E26)/120V Incandescent

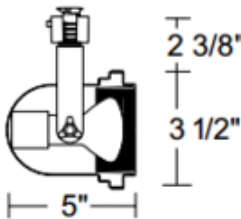

SPEC # JUN26130

COMPANY	PROJECT	FIXTURE TYPE	APPROVED BY	DATE