

Installation Instructions for Monorail 2 Circuit 4" Round Feed-End Power Canopy

IMPORTANT INFORMATION

- This product is ETL listed for indoor dry locations.
- This product can be installed to a 4" electrical box with round plaster ring, or to an octagon electrical box.
- Minimum electrical box volume must be 6 cubic inches (98 cubic centimeters).
- This product should be installed by a qualified electrician.

SAVE THESE INSTRUCTIONS!

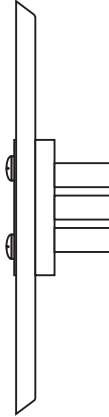

For New Construction

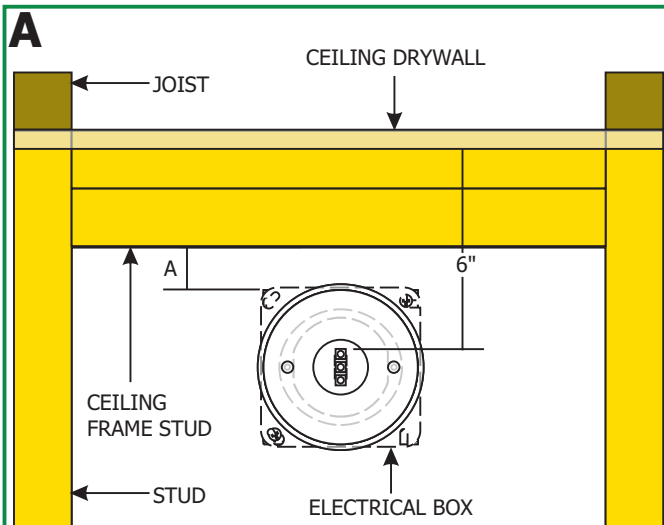

1: For Double Ceiling Frame Stud, use the Monorail 2 Circuit 6" standoff to mount the Feed-End Power Canopy closest to the ceiling. Refer to the chart below to determine the 4" electrical box distance from the ceiling frame stud.

DRY WALL THICKNESS	A
1/2"	1.79"
5/8"	1.92"
3/4"	2.04"

2: For Single Ceiling Frame Stud, use the Monorail 2 Circuit 6" standoff. Cut 3" off of the standoff rod, to mount the Feed-End Power Canopy closest to the ceiling. Refer to the chart below to determine the 4" electrical box distance from the ceiling frame stud.

DRY WALL THICKNESS	A
1/2"	0.33"
5/8"	0.45"
3/4"	0.57"

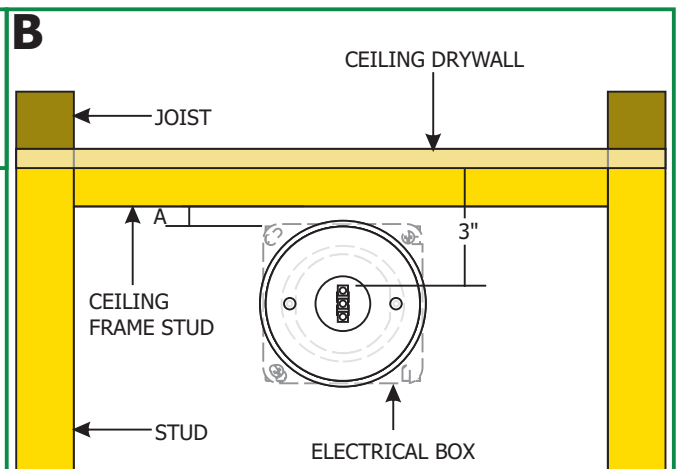

Install the Canopy

NOTE: Use the universal round crossbar (provided) if the electrical box holes are not spaced 2-3/4" apart.

NOTE: The low voltage wires should be present in the electrical box. Refer to the instructions provided with the remote transformer and the low voltage wires before proceeding with the steps below.

- 1: Turn the power to electrical box off.
- 2: Connect the wire that is attached to the bottom end connector to the low voltage wire marked "COM" with a wire nut.
- 3: Connect the wire that is attached to the middle end connector to the low voltage wire marked "HOT 2" with a wire nut.
- 4: Connect the wire that is attached to the top end connector to the low voltage wire marked "HOT 1" with a wire nut.

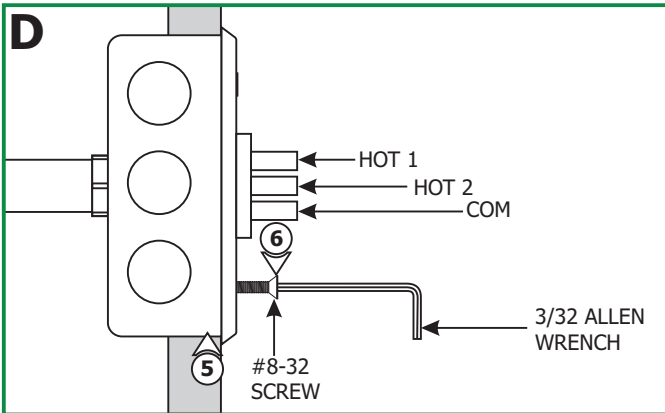
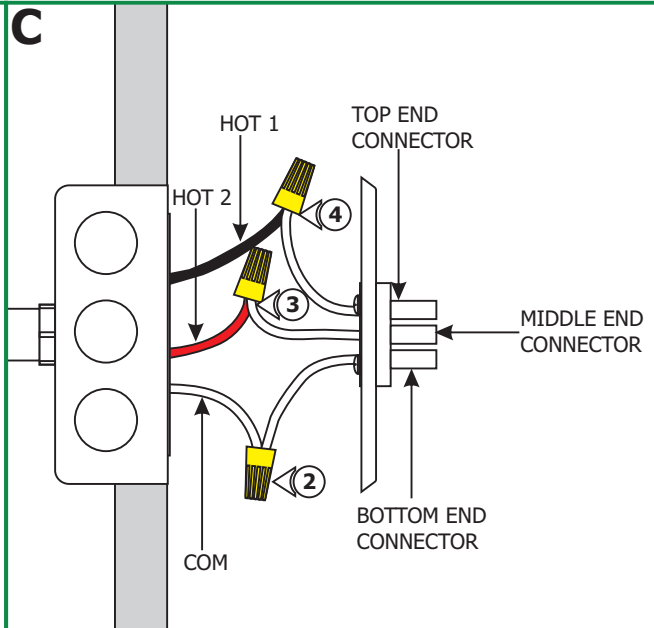

- 5: Place all wires inside the electrical box.
- 6: Secure the power feed canopy to the electrical box by tightening the two provided #8-32 screws with the 3/32 Allen wrench.

Install the Monorail 2 Circuit to Power Feed Canopy

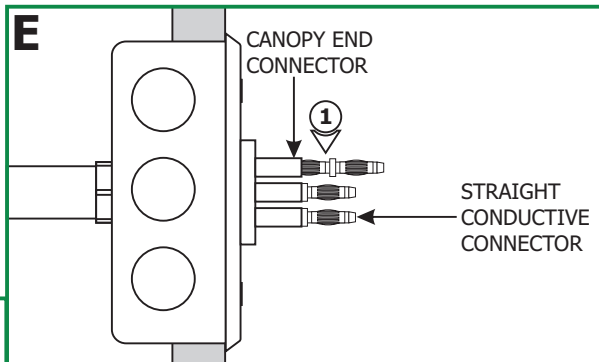

- 1: Push the straight conductive connectors into the canopy end connector.

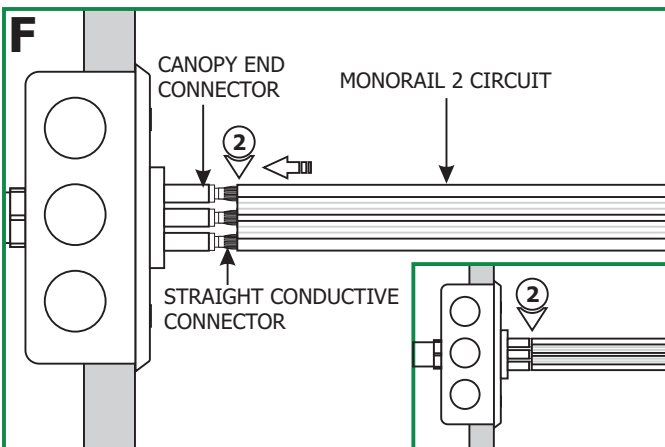

- 2: Push a Monorail 2 Circuit section entirely onto the straight conductive connectors. **Make sure that Monorail 2 Circuit section is supported by Monorail 2 Circuit standoffs.**