

Installation Instructions for **Mirror Defogger**

IMPORTANT INFORMATION

- This product is for wall mounted Mirror installations only.
- This product is to be used only with Edge Lighting Mirrors.

SAVE THESE INSTRUCTIONS!

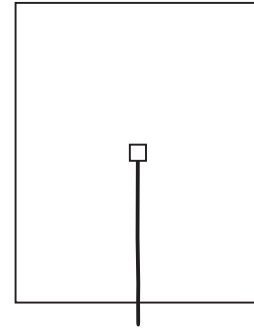

Install the Defogger to a Mirror

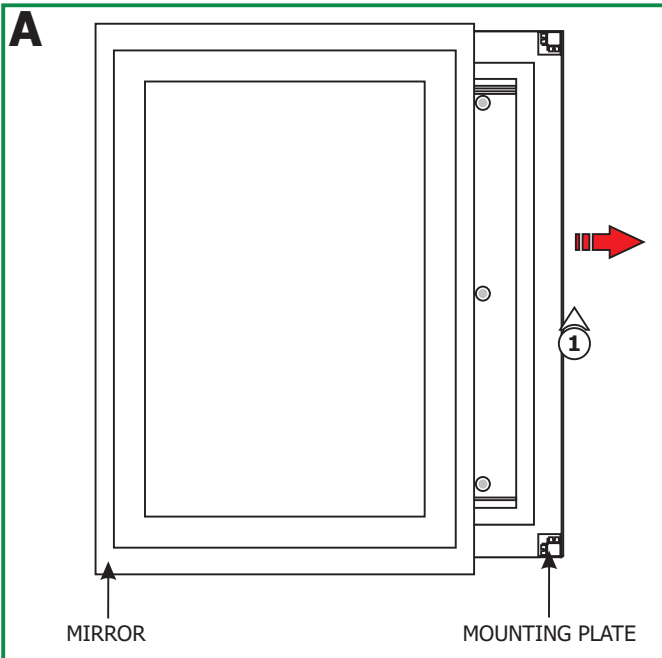

NOTE: Below are the steps on how to install defogger to an Edge lighting mirror, for additional information refer to the instruction provided with the mirror.

- 1:** Refer to instructions provided with the mirror assembly to remove the mirror.

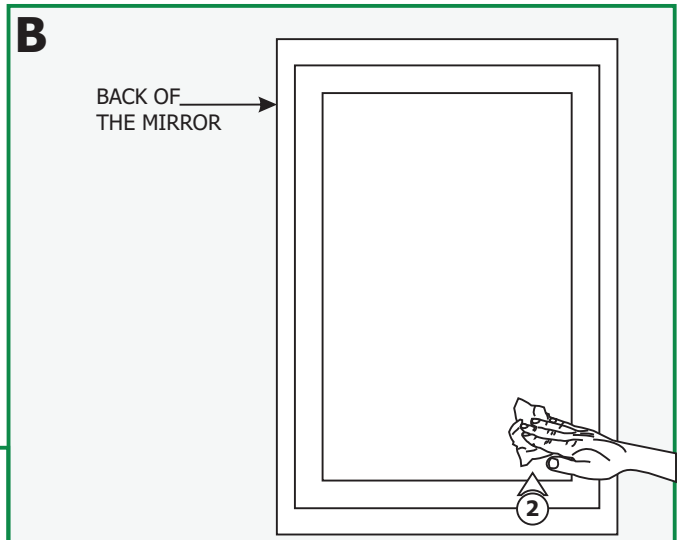

- 2:** Gently place the mirror on a padded flat surface, and clean the back of the mirror from any dust or grease. Make sure to completely dry mirror before continuing.

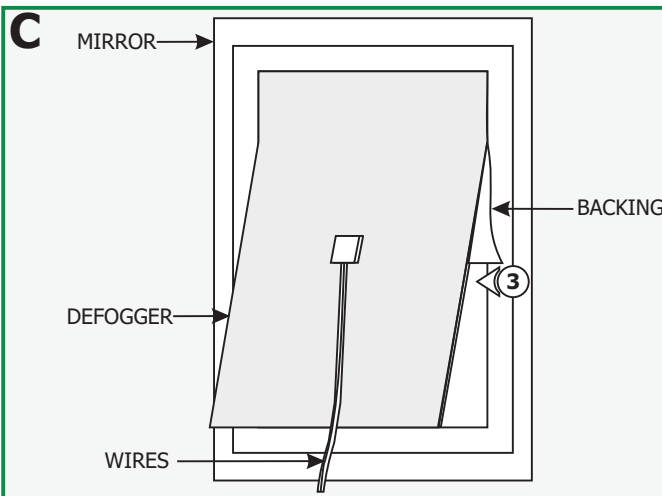

- 3:** Remove the backing from the defogger and firmly press it down on back of the dimmer, little at a time to avoid air bubbles.

- 4:** Connect the defogger wires to the 120 Volt power wires with wire nuts.