

Installation Instructions for 2" Round & Square Fast Jack LED Power Canopies w/2" Plaster Ring

IMPORTANT INFORMATION

- This product is ETL listed for indoor dry locations.
- This product mounts to a 4" standard electrical box or octagon electrical box using the 2" plaster ring provided.
- Minimum electrical box volume must be 6 cubic inches (98 cubic centimeters).
- This product is for use only with LED fixtures.
- For dimming information visit www.edgelighting.com

SAVE THESE INSTRUCTIONS!

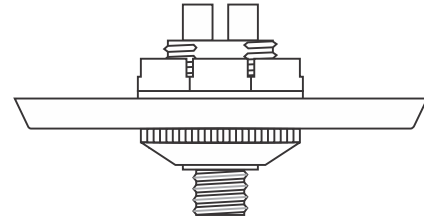

Install 2" Plaster Ring Adapter (New Construction)

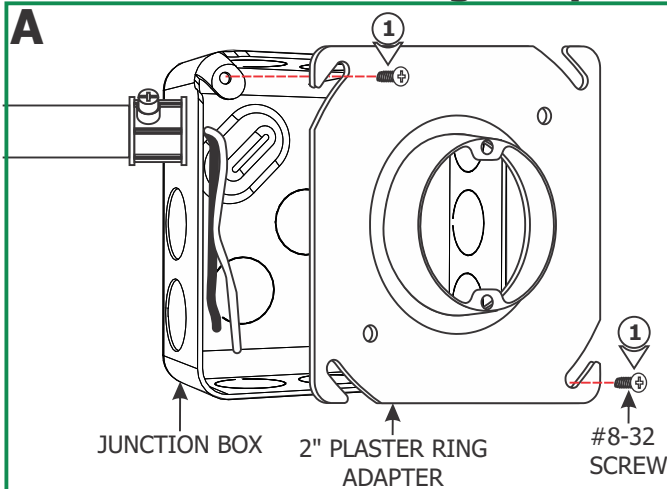

NOTE: Junction box must be mounted to allow clearance of 1/2" between the face of the junction box and the drywall surface.

- 1:** Install the 2" Plaster Ring Adapter to the junction box using two #8-32 screws.

- 2:** Use a circular saw to cut out the drywall section where the junction box opening is.

- 3:** Install the drywall. If necessary, plaster and finish the drywall.

- 4:** Complete installation per "Install Fast Jack Port" section on Page 2.

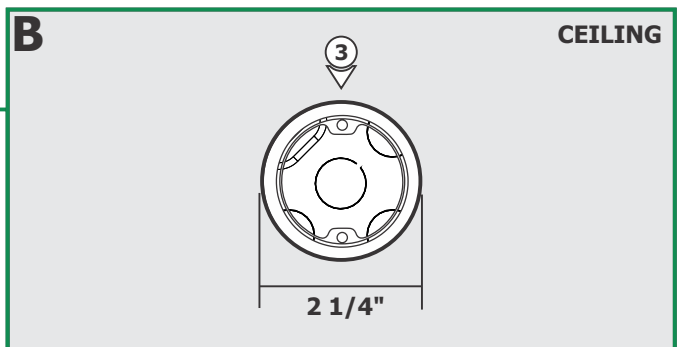

Install 2" Plaster Ring Adapter (Remodel)

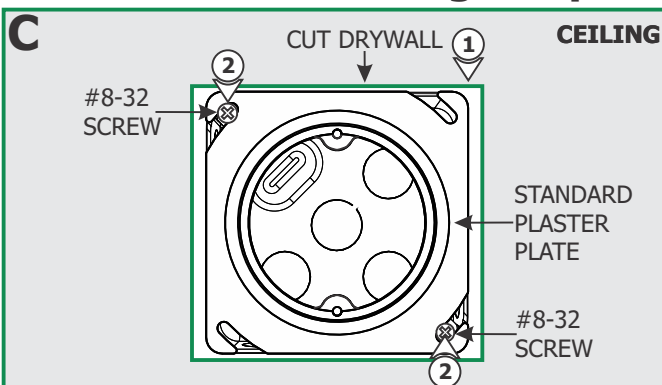

- 1:** Cut away the drywall where the junction box is located.

- 2:** Uninstall the standard junction box by removing the #8-32 screws.

- 3:** Install the 2" Plaster Ring to the junction box using two #8-32 screws.

- 4:** Plaster and finish around the junction box opening.

- 5:** Finish Cable Grip installation by following steps in "Install Fast Jack Port" section.

Install Fast Jack Port

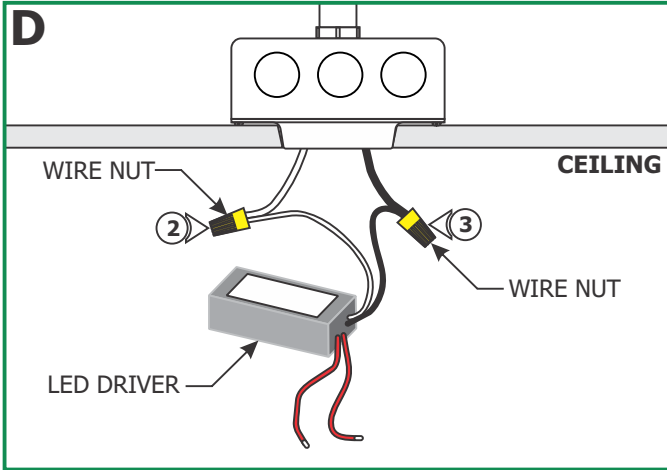

- 1: Turn the power to the junction box off.
- 2: Connect the white LED driver wire to the neutral power wire with a wire nut.
- 3: Connect the black LED driver wire to the hot power wire with a wire nut.
- 4: Place the LED driver and connections inside the junction box.

- 5: Connect each transformer wire to one Fast Jack fixture wire with a wire nut.

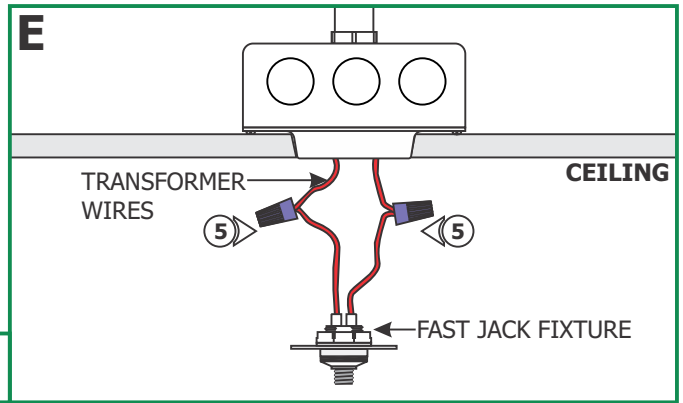

- 6: Place all wire and wire nut connections properly inside the junction box. Mount the Fast Jack port to the 2" Plaster Ring using two #8-32 screws provided.

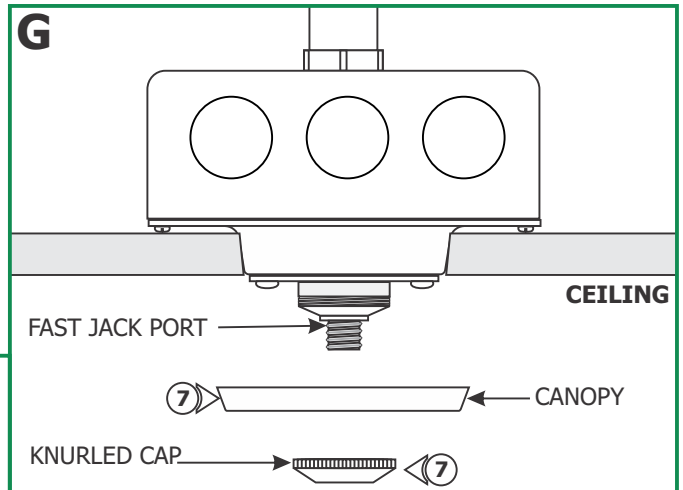
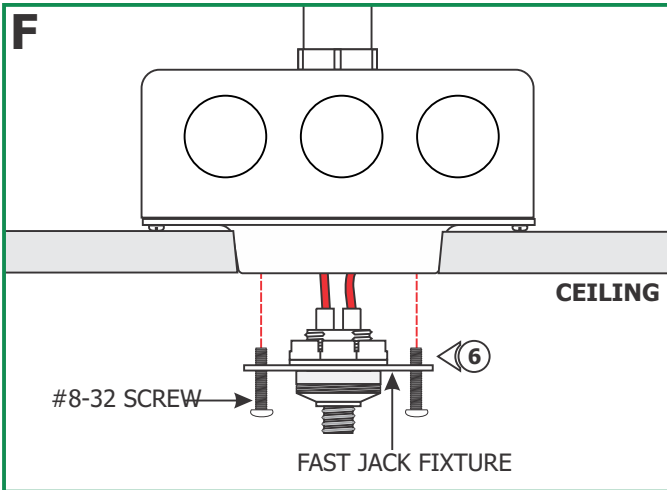

- 7: Place the canopy onto the Fast Jack port against drywall and secure it in place by tightening the knurled cap to the Fast Jack port. **Make sure the knurled cap is not cross threaded.**

CAUTION: Risk of Fire: MAX load of Fast Jack LED canopy is **60 Watt.**

- 8: Use fingers to tighten the Fast Jack fixture connector into the Fast Jack port.

