

Installation Instructions for **Controller Dial with Power Supply**

IMPORTANT INFORMATION

- This instruction shows a typical installation.

SAVE THESE INSTRUCTIONS!

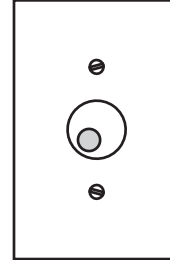

Installing CDP Panel

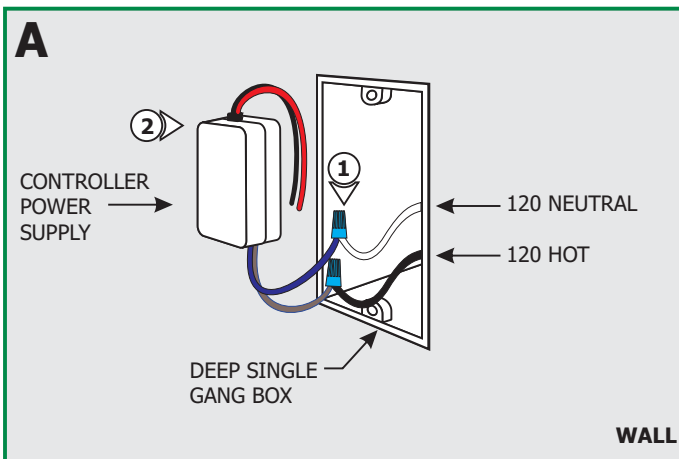

NOTE: Before beginning any electrical work, ensure that power to the electrical box is turned off.

NOTE: This product requires deep double gang electrical box.

1: Connect the brown and blue wires of the 24VDC transformer to the 120 volt hot and neutral wires with wire nuts respectively.

2: Place the controller power supply inside the double gang box.

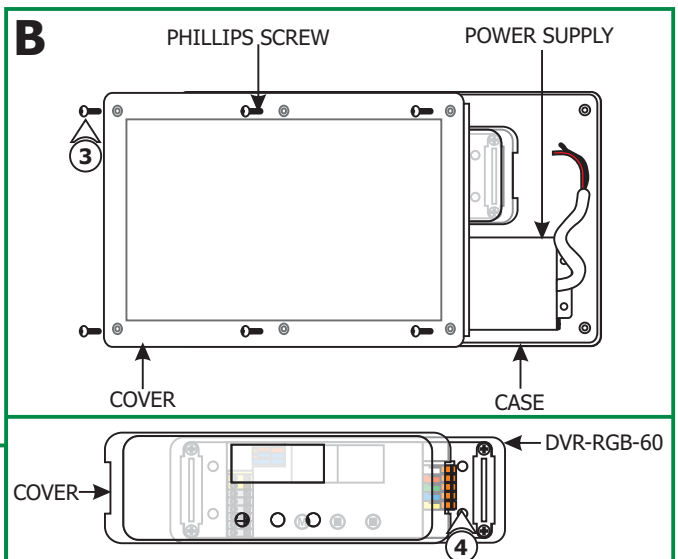

3: Loosen the six Phillips screws on front of the power supply to remove the cover.

4: Carefully pull off the cover from the DVR-RGB-60 driver.

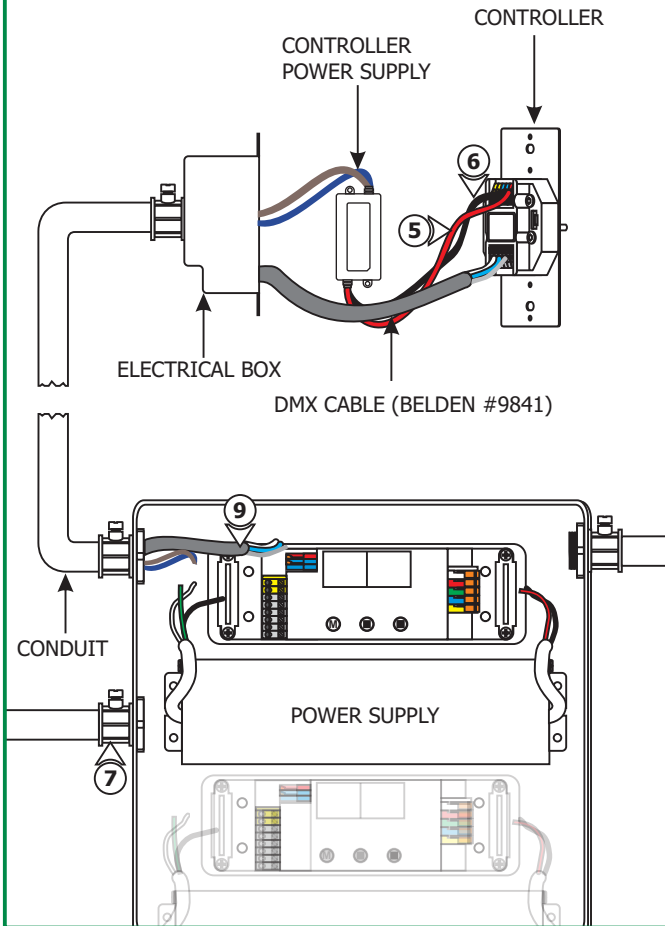
C

NOTE: Refer to the "Configuring DimWheel" & "Operating DimWheel" for help on programming the Dimwheel.

- 5: Connect the red wire of the power supply to the "VDC+" terminal of the controller.
- 6: Connect the black wire of the power supply to the "Ground" terminal of the controller.
- 7: Run the blue and brown line voltage wires coming from the controller power supply to the power supply case.
- 8: Install conduits from controller, main panel (line voltage), and soft strip to power supply.
- 9: Run proper DMX cable (**Belden #9841 recommended**) with three data wires from controller to the power supply box.

NOTE: "DMX in+", "DMX in-", "EXT in+" & "EXT in-", controller terminals are not used on controller.

- 10: Install a red wire from the power supply to DVR-RGB-60 "VDC+" red terminal and a black wire from power supply to DVR-RGB-60 "VDC-" blue terminal.
- 11: Connect one end of a data wire (blue with white stripes wire) to controller "LEDSYNC OUT-" terminal. Connect the other end into the DVR-RGB-60 "DMX in -" terminal.
- 12: Connect one end of a data wire (white with blue stripes wire) to controller "LEDSYNC OUT+" terminal. Connect the other end into the DVR-RGB-60 "DMX in +" terminal.
- 13: Connect one end of a data wire (bare shield wire) to controller "LEDSYNC SHIELD" terminal. Connect the other end into the DVR-RGB-60 "DMX in shield" terminal.

NOTE: For assistance wiring a fixture to LED Driver reference fixture installation instructions.

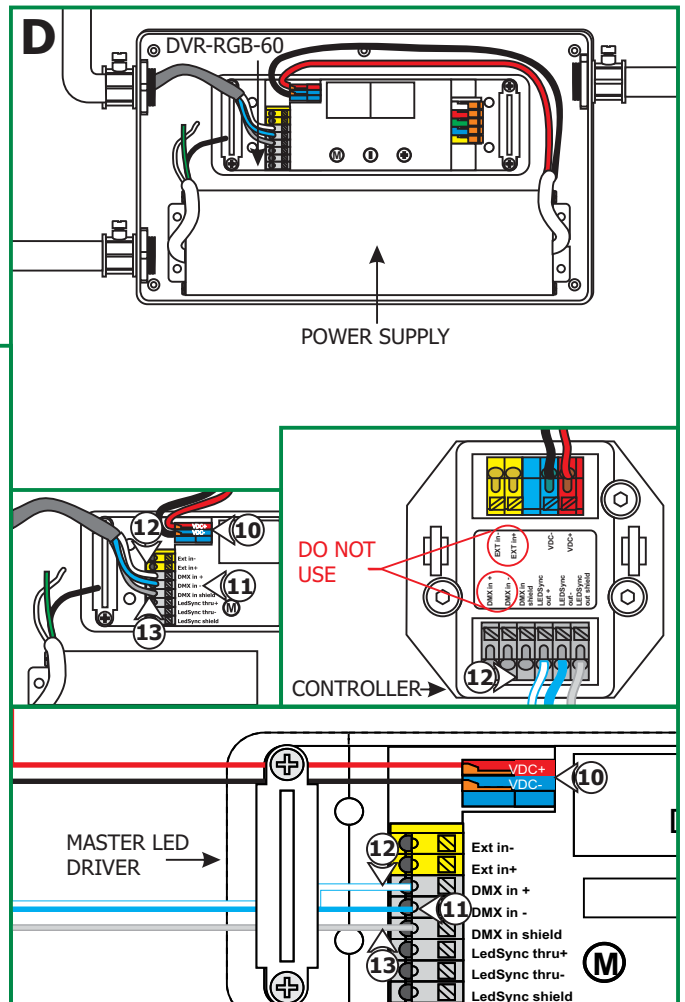

E

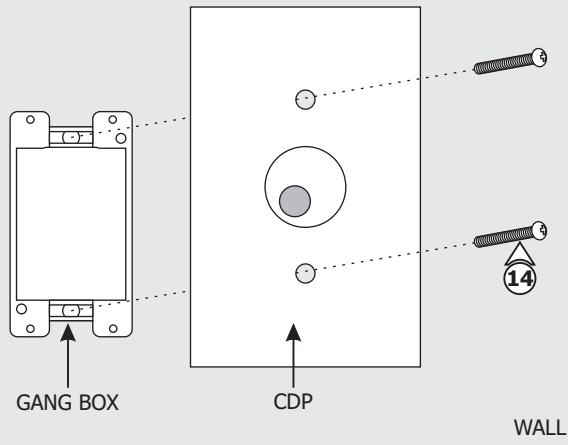

14: Screw CDP unit onto gang box using provided screws.

NOTE: Reference operation guide for information on programming CDP unit.