

# Operational Guide for **Controller Dial with Power Supply**

## Selecting Modes

Configure your CDP by setting the DIP switches on the front:



**NOTE:** The DIP switches must remain accessible after installation. When making changes in the DIP switch settings, disconnect and reconnect the power supply to activate new settings.

## Operating CDP

1- Turn the light on

**TAP**

2- Change brightness

**BRIGHTNESS**

3- Turn the light off

**TAP**

## Advanced Operation for Color Mode

1- Turn the light on

**TAP**

2- Activate configuration mode

**2 SEC**

3- Set Color

4- Save color saving

**TAP**

## Advanced Operation for Chase Mode

1- Turn the light on

**TAP**

2- Activate configuration mode

**2 SEC**

3- Set show speed

4- Save color setting

**TAP**

**Advanced Operation for RGBW**

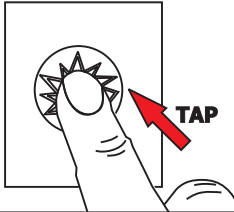
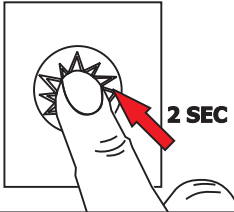
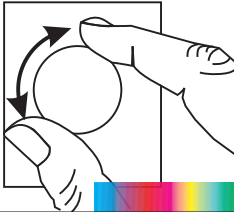
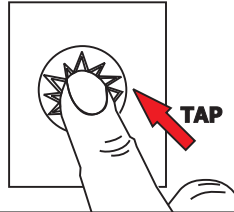
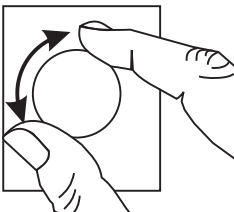
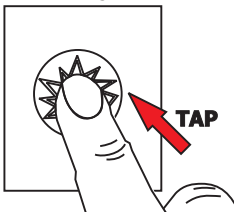
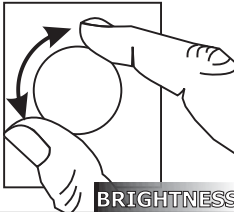
<p>1- Turn the light on</p> 	<p>2- Activate configuration mode</p> 	<p>3- Set Color</p> 	<p>4- Activate White</p> 
<p>5- Set White</p> 	<p>6- Save settings</p> 	<p>7- Dim</p> 	

## Installation Instructions for **Controller Dial with Power Supply**

### IMPORTANT INFORMATION

- This instruction shows a typical installation.

**SAVE THESE INSTRUCTIONS!**

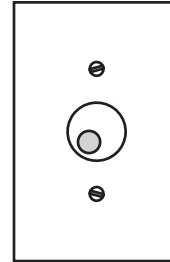

### Installing CDP Panel

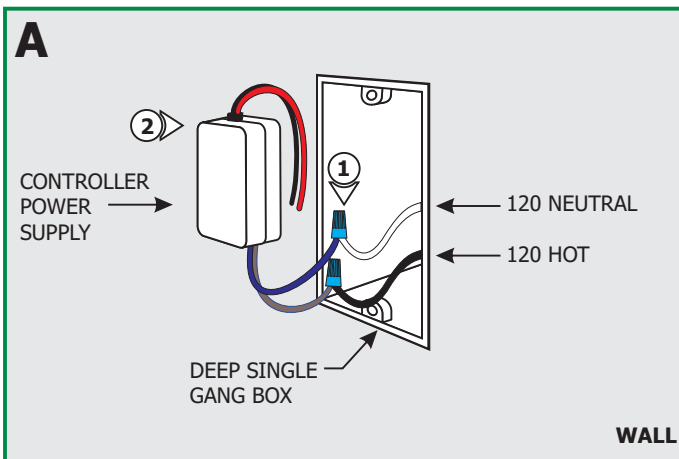

**NOTE:** Before beginning any electrical work, ensure that power to the electrical box is turned off.

**NOTE:** This product requires deep double gang electrical box.

**1:** Connect the brown and blue wires of the 24VDC transformer to the 120 volt hot and neutral wires with wire nuts respectively.

**2:** Place the controller power supply inside the double gang box.

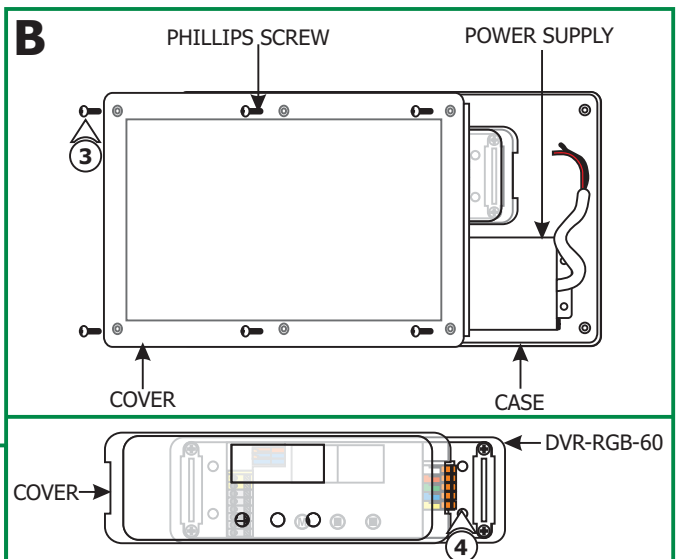

**3:** Loosen the six Phillips screws on front of the power supply to remove the cover.

**4:** Carefully pull off the cover from the DVR-RGB-60 driver.

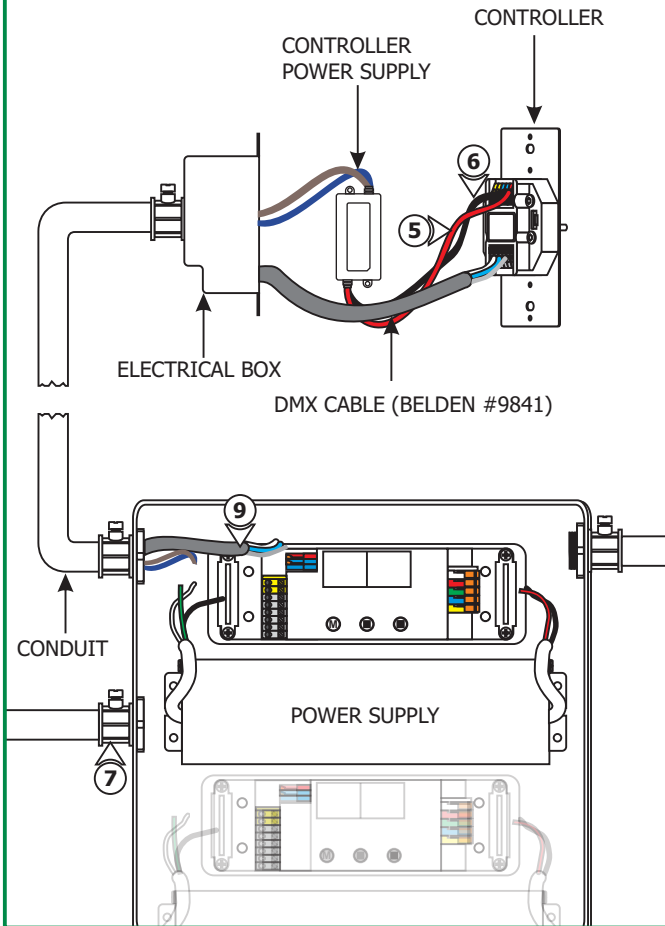
**C**

**NOTE:** Refer to the "Configuring DimWheel" & "Operating DimWheel" for help on programming the Dimwheel.

- 5: Connect the red wire of the power supply to the "VDC+" terminal of the controller.
- 6: Connect the black wire of the power supply to the "Ground" terminal of the controller.
- 7: Run the blue and brown line voltage wires coming from the controller power supply to the power supply case.
- 8: Install conduits from controller, main panel (line voltage), and soft strip to power supply.
- 9: Run proper DMX cable (**Belden #9841 recommended**) with three data wires from controller to the power supply box.

**NOTE:** "DMX in+", "DMX in-", "EXT in+" & "EXT in-", controller terminals are not used on controller.

- 10: Install a red wire from the power supply to DVR-RGB-60 "VDC+" red terminal and a black wire from power supply to DVR-RGB-60 "VDC-" blue terminal.
- 11: Connect one end of a data wire (blue with white stripes wire) to controller "LEDSYNC OUT-" terminal. Connect the other end into the DVR-RGB-60 "DMX in -" terminal.
- 12: Connect one end of a data wire (white with blue stripes wire) to controller "LEDSYNC OUT+" terminal. Connect the other end into the DVR-RGB-60 "DMX in +" terminal.
- 13: Connect one end of a data wire (bare shield wire) to controller "LEDSYNC SHIELD" terminal. Connect the other end into the DVR-RGB-60 "DMX in shield" terminal.

**NOTE:** For assistance wiring a fixture to LED Driver reference fixture installation instructions.

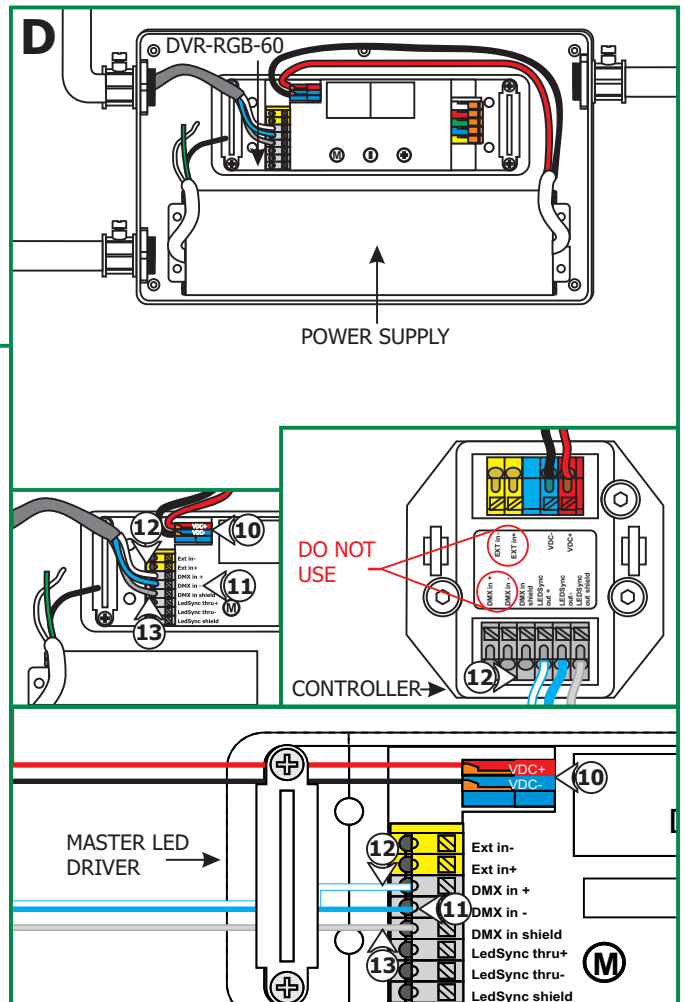

**E**

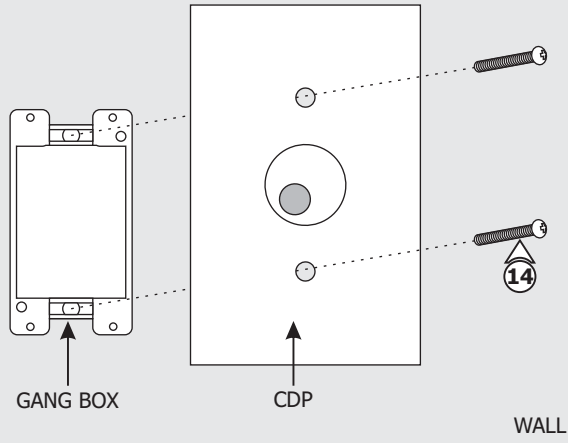

**14:** Screw CDP unit onto gang box using provided screws.

**NOTE:** Reference operation guide for information on programming CDP unit.