

Installation Instructions for Crystal Galaxy

IMPORTANT INFORMATION

- Use this fixture indoors only.
- **RISK OF FIRE:** Use only the type of lamp and maximum wattage indicated in this instruction manual.
- This product is ETL listed for indoor dry locations and approved to be used at any height above the finished floor.

SAVE THESE INSTRUCTIONS!

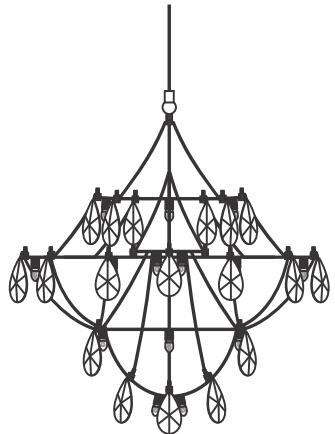

Adjust the Fixture Height

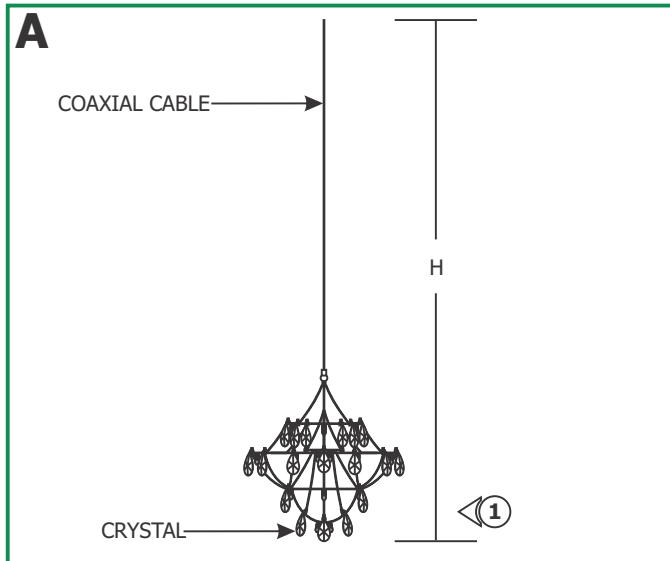

1: Cut the coaxial cable to the desired height (H) with a sharp cutter. The overall fixture height is measured from the bottom of the crystals to the end of the coaxial cable.

2: Loosen the M4 set screw on base of the coaxial fixture connector with the 2mm Allen wrench provided. **Do not remove this set screw.**

3: Remove the M3 set screw on tip of the connector with the 1.5mm Allen wrench provided.

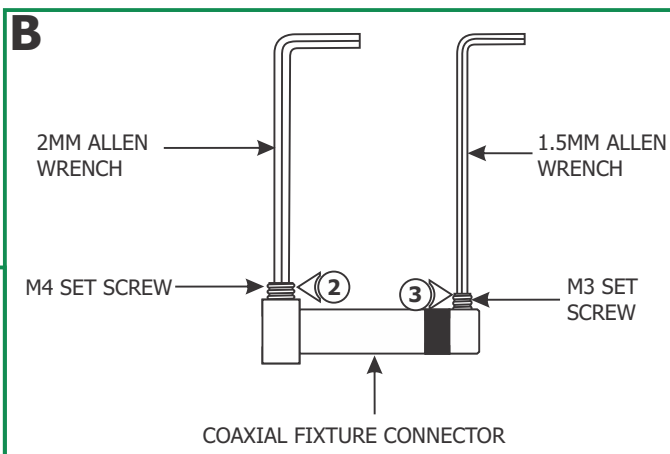

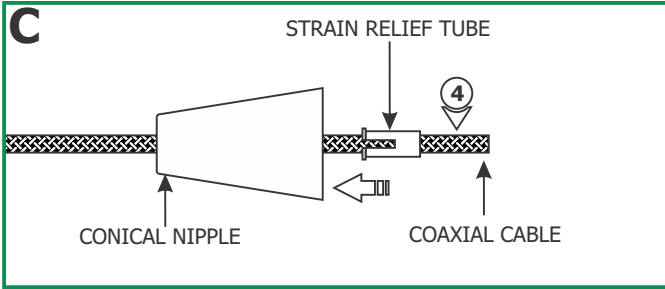

4: Feed the coaxial cable through the conical nipple and flared side of the strain relief tube. Slide the conical nipple and strain relief tube down the coaxial cable.

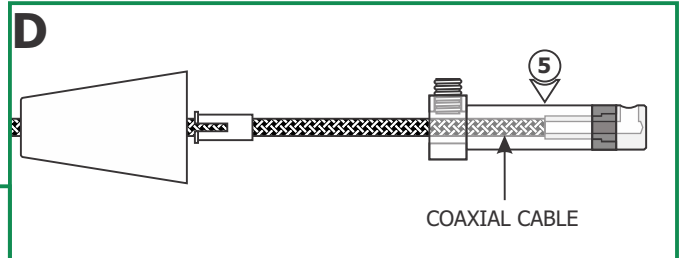

5: Feed the coaxial cable into the coaxial fixture connector. The coaxial cable will come to a stop point.

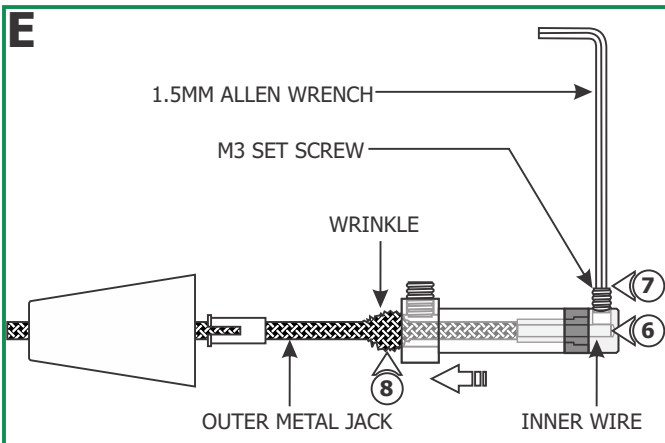

6: Keep feeding the coaxial cable in until the inner wire is visible in the screw hole of the fixture connector tip. The outer metal jacket will start to wrinkle.

7: Hold the fixture connector in place. Replace and tighten the M3 set screw on fixture connector tip with the 1.5mm Allen wrench.

8: Pull down the outer metal jacket to smooth the wrinkles.

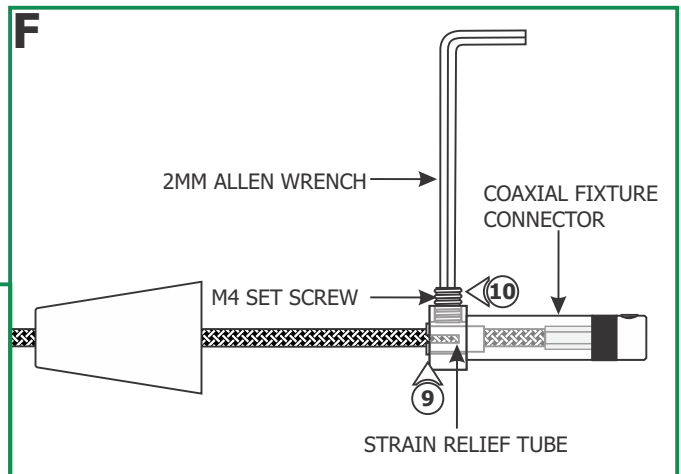

9: Push the strain relief tube completely into the coaxial fixture connector. Make sure the slot on the strain relief tube is not inline with the M4 set screw.

10: Tighten the M4 set screw with the 2mm Allen wrench.

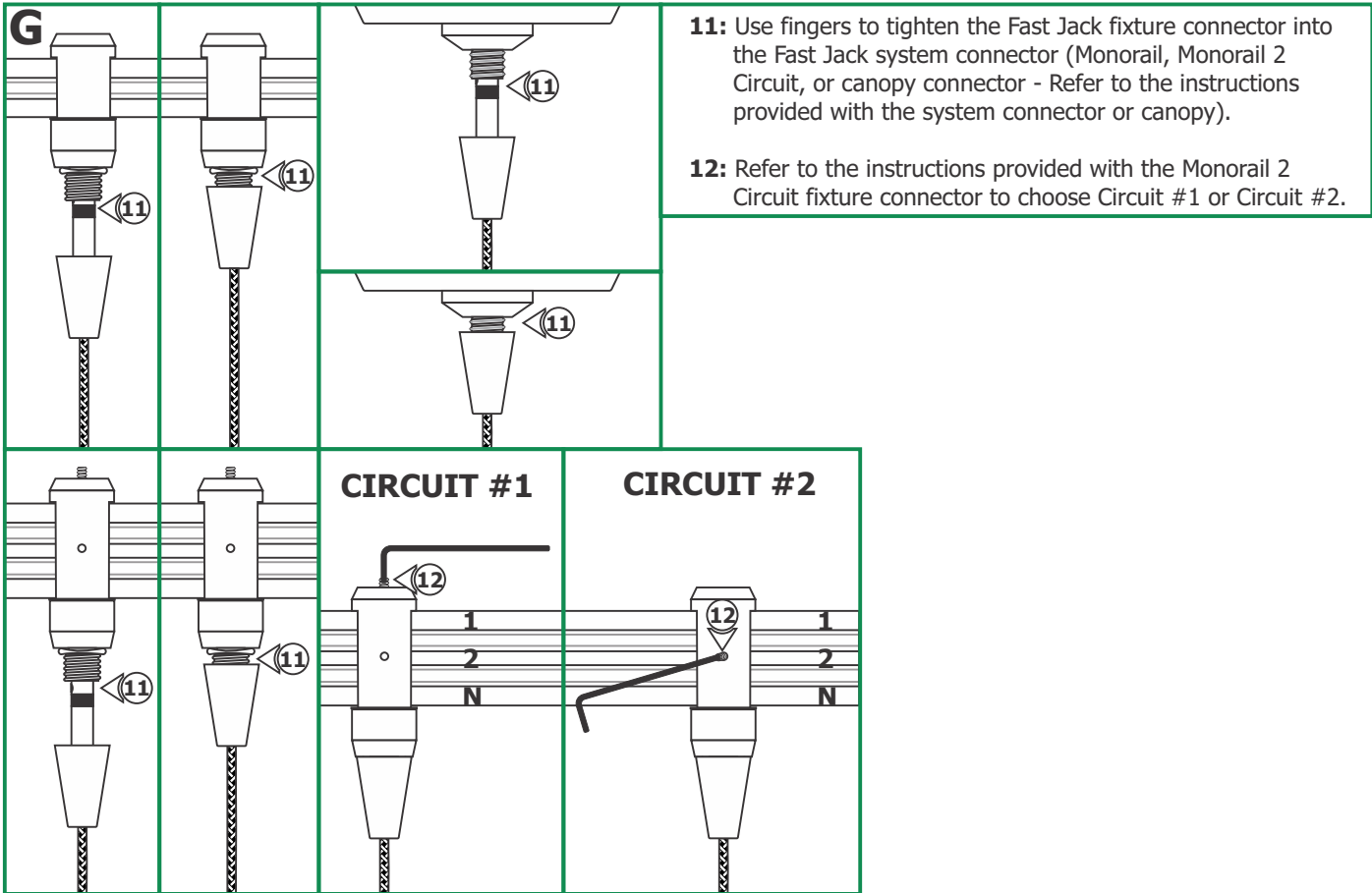

Install the Lamp

H

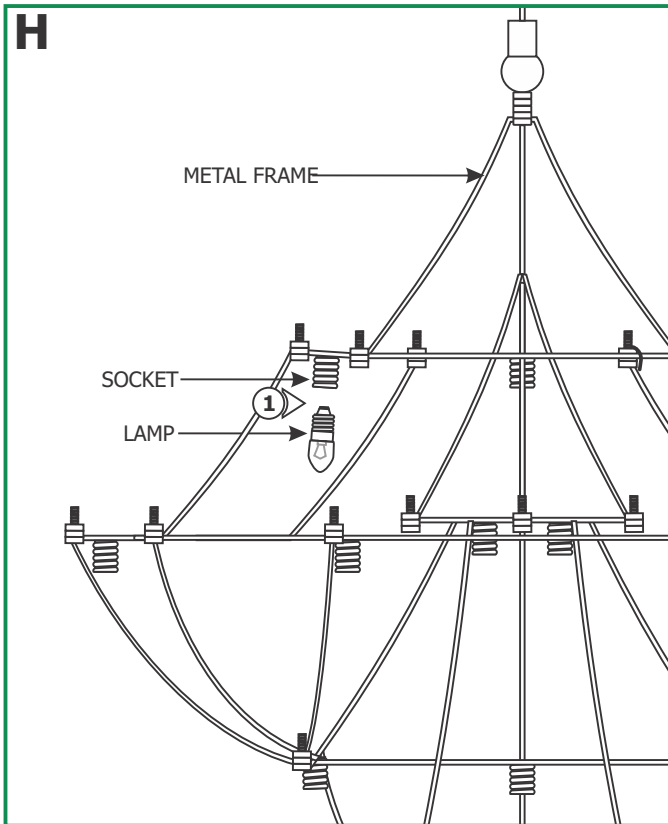

CAUTION: To reduce risk of a burn or electrical shock during lamping, disconnect the power to the fixture.

Use **MAX 2** Watt, Type E10 Miniature Lamp, for each Socket.



NOTE: Use a soft cloth and fingers to install the lamp.

1: Screw each lamp completely into the sockets.

I

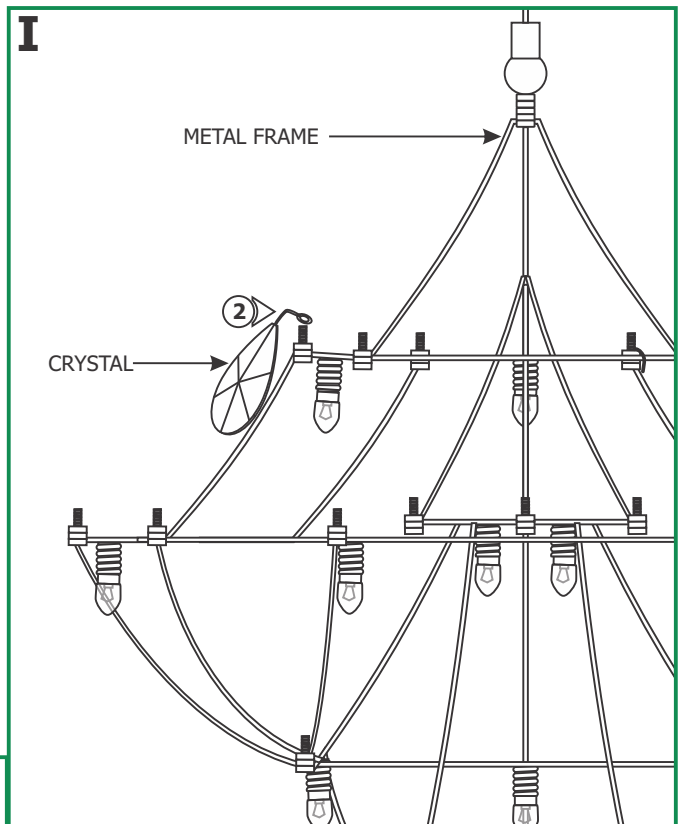

2: Secure each crystal Loop to a threaded post on the metal frame.