



# TRAC-MASTER®

Avant Garde

## OPEN BACK SPOTLIGHTS

T196, T696, T362, T363 and T368

Project: \_\_\_\_\_

Fixture Type: \_\_\_\_\_

Location: \_\_\_\_\_

Contact/Phone: \_\_\_\_\_

### PRODUCT DESCRIPTION

The clean, functional lines of the open back allows maximum adjustability. Open Back Spotlights relamp from back and have floating socket mount and on/off switch. The minimum profile with stylized yoke design is ideal for retail and commercial applications.

**Construction** Die-formed steel.

**Aiming** 90° vertical aiming capability and 358° rotation.

**Labels** UL listed, CSA certified.

Product specifications subject to change without notice.



### Low Voltage MR16

**Lamp** 12V, 50W maximum MR16 GU5.3/GX5.3 bi-pin.

**Socket** Ceramic bi-pin.

**Transformer** Must be ordered separately • Compatible with T537 or T538 12V electronic transformer for halogen lamps ([D1.2.1](#)) • Compatible with T537U universal 12V electronic transformer for LED or halogen lamps ([D1.2.5](#)) • Compatible with T539 12V electronic transformer for halogen lamps ([D1.2.0](#)) • Compatible with T542 or T543 12V magnetic transformer for LED or halogen lamps ([D1.2.0](#)).

Catalog Number	Finish	Lamp
T196WH	White	50W MR16 max.
T196BL	Black	50W MR16 max.
T196SC	Satin Chrome	50W MR16 max.

### ACCESSORIES

Cat. No.	Description	Cat. No.	Description	Cat. No.	Description
T551-5	Color Filters	T557	Prismatic Spread Lens	T559	Linear Spread Lens
T5501-18	Dichroic Filters	T5520	Diffusion Lens	T5521	Uniformity Lens
T5522	UV Filter	T5559BL	Hexcell Louver		

See specification sheet [D1.2.2](#) for details.

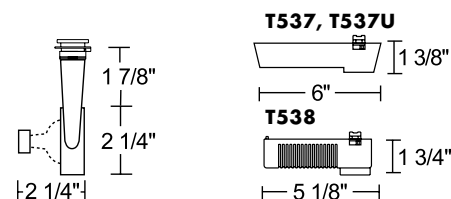

### Low Voltage MR16

**Lamp** 12V, 75W maximum MR16 GU5.3/GX5.3 bi-pin.

**Socket** Ceramic bi-pin.

**Transformer** Must be ordered separately • Compatible with T537 or T538 12V electronic transformer for halogen lamps ([D1.2.1](#)) • Compatible with T537U universal 12V electronic transformer for LED or halogen lamps ([D1.2.5](#)) • Compatible with T539 12V electronic transformer for halogen lamps ([D1.2.0](#)) • Compatible with T542 or T543 12V magnetic transformer for LED or halogen lamps ([D1.2.0](#)).

Catalog Number	Finish	Lamp
T696WH	White	75W MR16 max.
T696BL	Black	75W MR16 max.

### ACCESSORIES

Cat. No.	Description	Cat. No.	Description	Cat. No.	Description
T551-5	Color Filters	T557	Prismatic Spread Lens	T559	Linear Spread Lens
T5501-18	Dichroic Filters	T5520	Diffusion Lens	T5521	Uniformity Lens
T5522	UV Filter	T5559BL	Hexcell Louver		

See specification sheet [D1.2.2](#) for details.

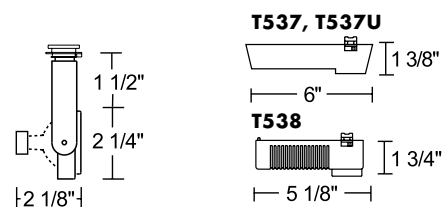

**TRAC-MASTER®**

Avant Garde

**OPEN BACK SPOTLIGHTS****T196, T696 T362, T363 and T368****Line Voltage PAR20****Lamp** 120V, 50W maximum PAR20 medium base.**Socket** Medium base porcelain with nickel plated copper screw shell.

**Adapter** Copper alloy contacts provide precise spring action - no arcing and will not take a set • True, positive electrical ground • On/off switch included

- Patented embossed polarity arrows on bottom of adapter
- Spring-loaded positive latch with embossed polarity arrows secures trac light to trac
- "Pull-up" contact to up position for two-circuit application.

Catalog Number	Finish	Lamp
<b>T362WH</b>	White	50W PAR20 max.
<b>T362BL</b>	Black	50W PAR20 max.
<b>T362SC</b>	Satin Chrome	50W PAR20 max.

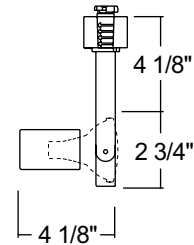
**Line Voltage PAR30****Lamp** 120V, 75W maximum PAR30 medium base.**Socket** Medium base porcelain with nickel plated copper screw shell.**Adapter** Refer to **T362**.

Catalog Number	Finish	Lamp
<b>T363WH</b>	White	75W PAR30 max.
<b>T363BL</b>	Black	75W PAR30 max.
<b>T363SC</b>	Satin Chrome	75W PAR30 max.
<b>T363NA</b>	Natural	75W PAR30 max.

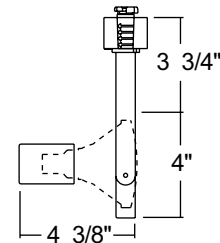
**Line Voltage PAR38****Lamp** 120V, 150W maximum PAR38 medium base.**Socket** Medium base porcelain with nickel plated copper screw shell.**Adapter** Refer to **T362**.

Catalog Number	Finish	Lamp
<b>T368WH</b>	White	150W PAR38 max.
<b>T368BL</b>	Black	150W PAR38 max.
<b>T368SC</b>	Satin Chrome	150W PAR38 max.
<b>T368NA</b>	Natural	150W PAR38 max.

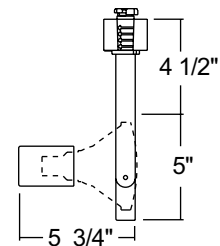
**ACCESSORIES**

Cat. No.	Description	Cat. No.	Description	Cat. No.	Description
<b>T571-6</b>	Color Filters	<b>T579BL</b>	Cube Cell Louver	<b>T5721</b>	Uniformity Lens
<b>T5722</b>	UV Filter	<b>T5777</b>	Prismatic Spread Lens	<b>T5778</b>	Linear Spread Lens
<b>T5718</b>	Color Correction Filter				

See specification sheet [D1.2.2](#) for details.