



TRAC-MASTER®

Project: _____

Fixture Type: _____

Location: _____

Contact/Phone: _____

Professional Series Halogen CONIX® PAR LAMPHOLDERS T407, T408, and T409

PRODUCT DESCRIPTION

The sleek sculptured look and style of the Conix fixture is unparalleled in the industry. Its elegance is carried through the entire design for a fresh, contemporary appeal. Conix fixtures relamp from the front and have snap-in accessory holders. All can accommodate up to two accessories. Lampholders have integral horizontal rotation and vertical aiming locks.



PRODUCT SPECIFICATIONS

Construction Molded polycarbonate yoke • Die cast aluminum back housing • Formed steel front housing.

Socket Medium base porcelain with nickel plated copper screw shell.

Aiming Greater than 360° horizontal rotation eliminates aiming dead spots • 90° vertical aiming capability • Vertical aiming and horizontal rotation locking screws secure lampholder position during relamping cycles.

Adapter Copper alloy contacts provide precise spring action - no arcing and will not take a set • True, positive electrical ground • On/off switch included • Patented embossed polarity arrows on bottom of adapter • Spring-loaded positive latch with embossed polarity arrows secures trac light to trac • "Pull-up" contact to up position for two-circuit application.

Labels UL listed, CSA certified.

Product specifications subject to change without notice.

Line Voltage PAR20

Catalog Number	Finish	Lamp
T407WH	White	35-50W PAR20
T407BL	Black	35-50W PAR20
T407SL	Silver	35-50W PAR20

ACCESSORIES

Cat. No.	Description	Cat. No.	Description	Cat. No.	Description
T591-6	Color Filters	T597	Prismatic Spread Lens	T598	Linear Spread Lens
T5928BL	Hexcell Louver	T5921	Uniformity Lens	T5922	UV Filter

T5918 Color Correction Filter

See specification sheet [D1.2.2](#) for details.

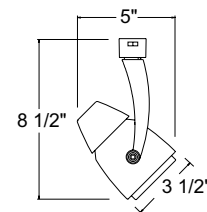

Line Voltage PAR30

Catalog Number	Finish	Lamp
T408WH	White	35-75W PAR30
T408BL	Black	35-75W PAR30
T408SL	Silver	35-75W PAR30

ACCESSORIES

Cat. No.	Description	Cat. No.	Description	Cat. No.	Description
T561-6	Color Filters	T5677	Prismatic Spread Lens	T5678	Linear Spread Lens
T569BL	Cube Cell Louver	T5621	Uniformity Lens	T5622	UV Filter

T5618 Color Correction Filter

See specification sheet [D1.2.2](#) for details.

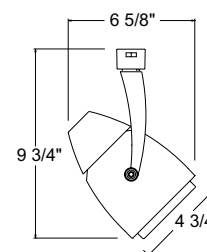

TRAC-MASTER®

Professional Series Halogen
CONIX® PAR LAMP HOLDERS
T407, T408, and T409

Line Voltage PAR38

Catalog Number	Finish	Lamp
T409WH	White	45-150W PAR38
T409BL	Black	45-150W PAR38
T409SL	Silver	45-150W PAR38

ACCESSORIES

Cat. No.	Description	Cat. No.	Description	Cat. No.	Description
T571-6	Color Filters	T579BL	Cube Cell Louver	T5721	Uniformity Lens
T5722	UV Filter	T5777	Prismatic Spread Lens	T5778	Linear Spread Lens
T5718	Color Correction Filter				

See specification sheet [D1.2.2](#) for details.

