

JUNO**TRAC-MASTER®**

Avant Garde

GYRUS™**T640 and T645**

Project: _____

Fixture Type: _____

Location: _____

Contact/Phone: _____

PRODUCT DESCRIPTION

A new spin on an old idea, the Gyrus™ combines dramatic aerodynamic styling with the convenience of a front relamping gimbal ring. The MR16 has an integrated accessory holder that accepts standard up to two 2" diameter lenses and louvers. An optional snap-in, dual-media cartridge is available for the PAR30 that smartly integrates into the fixture design.

Aiming 90° vertical aiming capability and 358° rotation.

Construction Die-cast aluminum lamp housing • Extruded aluminum support stem conceals lamp lead wires.

Labels UL listed, CSA certified.

Product specifications subject to change without notice.

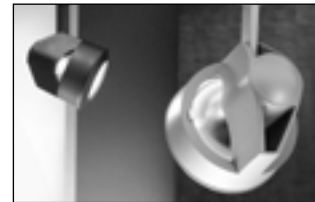
**Low Voltage MR16 - Gyrus™**

Lamp 12V, 50W maximum MR16 GU5.3/GX5.3 bi-pin.

Socket Ceramic bi-pin.

Accessory Holder Integral to fixture design • Die cast aluminum construction • Accommodates up to two accessories simultaneously • Clear glass lens included with fixture.

Construction Die-cast aluminum lamp housing • Extruded aluminum support stem conceals lamp lead wires.

Transformer Must be ordered separately • Compatible with T537 or T538 12V electronic transformer for halogen lamps (D1.2.1) • Compatible with T537U universal 12V electronic transformer for LED or halogen lamps (D1.2.5) • Compatible with T539 12V electronic transformer for halogen lamps (D1.2.0) • Compatible with T542 or T543 12V magnetic transformer for LED or halogen lamps (D1.2.0).

| Catalog Number | Description | Finish | Lamp |
|----------------|-------------|--------|---------------|
| T640WH | Gyrus™ | White | 50W MR16 max. |
| T640BL | Gyrus™ | Black | 50W MR16 max. |
| T640SL | Gyrus™ | Silver | 50W MR16 max. |

ACCESSORIES

| Cat. No. | Description | Cat. No. | Description | Cat. No. | Description |
|----------|------------------|----------|-----------------------|----------|--------------------|
| T741-6 | Color Filters | T7477 | Prismatic Spread Lens | T7478 | Linear Spread Lens |
| T7401-18 | Dichroic Filters | T7420 | Diffusion Lens | T7421 | Uniformity Lens |
| T7422 | UV Filter | T7459BL | Hexcell Louver | | |

See specification sheet [D1.2.2](#) for details.

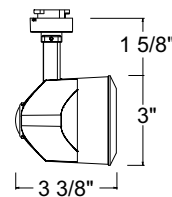
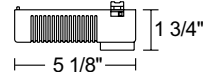
T537, T537U**T538****Line Voltage PAR30 - Gyrus™**

Lamp 120V, 75W maximum PAR30 medium base.

Socket Medium base porcelain with nickel plated copper screw shell.

Construction Die-cast aluminum lamp housing • Extruded aluminum support stem conceals lamp lead wires.

Adapter Copper alloy contacts provide precise spring action - no arcing and will not take a set
 • True, positive electrical ground • Spring-loaded positive latch polarity indicator embossed on copper contact
 • "Pull-up" contact to up position for two-circuit application.

| Catalog Number | Description | Finish | Lamp |
|----------------|-------------|--------|----------------|
| T645WH | Gyrus™ | White | 75W PAR30 max. |
| T645BL | Gyrus™ | Black | 75W PAR30 max. |
| T645SL | Gyrus™ | Silver | 75W PAR30 max. |

| Catalog Number | Description | Finish | Accessory |
|----------------|-----------------|--------|---|
| T645MC-WH | Media Cartridge | White | Compatible with up to two 3 3/4" accessories as noted below |
| T645MC-BL | Media Cartridge | Black | Compatible with up to two 3 3/4" accessories as noted below |
| T645MC-SL | Media Cartridge | Silver | Compatible with up to two 3 3/4" accessories as noted below |

ACCESSORIES

| Cat. No. | Description | Cat. No. | Description | Cat. No. | Description |
|----------|------------------|----------|-----------------------|----------|-------------------------|
| T569BL | Cube Cell Louver | T577BL | Black Eyebrow | T5678 | Linear Spread Lens |
| T561-6 | Color Filters | T5677 | Prismatic Spread Lens | T5618 | Color Correction Filter |
| T5621 | Uniformity Lens | T5622 | UV Filter | | |

See specification sheet [D1.2.2](#) for details.

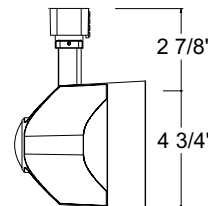

TRAC-MASTER®

Avant Garde

GYRUS™

T640 and T645

CBCP • Centerbeam candlepower
FC • Footcandles at beam center (aim point)

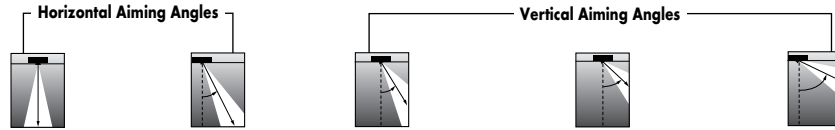

| Lamp | Beam Type | Beam Spread° | Rated Life | CBCP | 0° | | 30° | | | 30° | | | 45° | | | | 60° | | | | | | | | |
|---------------|-----------|--------------|------------|------|------|------|-----|-----|------|------|------|-----|-----|------|------|-----|-----|-----|------|------|-----|-----|------|-----|-----|
| | | | | | MH | FC | L | W | FC | L | W | D | FC | X | L | W | FC | X | L | W | D | FC | X | L | W |
| Q35W MR16 SP | SP | 20° | 5000 | 3900 | 4 | 244 | 1.4 | 1.4 | 158 | 1.9 | 1.6 | 2 | 122 | 3.5 | 3.1 | 1.4 | 345 | 2.0 | 1.5 | 1.0 | 4 | 158 | 2.3 | 1.9 | 1.6 |
| | | | | | 6 | 108 | 2.1 | 2.1 | 70 | 2.8 | 2.4 | 3 | 54 | 5.2 | 4.7 | 2.1 | 153 | 3.0 | 2.2 | 1.5 | 6 | 70 | 3.5 | 2.8 | 2.4 |
| | | | | | 8 | 61 | 2.8 | 2.8 | 40 | 3.8 | 3.3 | 4 | 31 | 6.9 | 6.2 | 2.8 | 86 | 4.0 | 2.9 | 2.0 | 8 | 40 | 4.6 | 3.8 | 3.3 |
| | | | | | 10 | 39 | 3.5 | 3.5 | 25 | 4.7 | 4.1 | 5 | 20 | 8.7 | 7.8 | 3.5 | 55 | 5.0 | 3.6 | 2.5 | 10 | 25 | 5.8 | 4.7 | 4.1 |
| 12 | 27 | 4.2 | 4.2 | 18 | 5.7 | 4.9 | 6 | 14 | 10.4 | 9.3 | 4.2 | 38 | 6.0 | 4.4 | 3.0 | 12 | 18 | 6.9 | 5.7 | 4.9 | | | | | |
| Q50W MR16 NSP | NSP | 15° | 6000 | 9100 | 4 | 638 | 1.0 | 1.0 | 414 | 1.3 | 1.1 | 2 | 319 | 3.5 | 2.1 | 1.0 | 902 | 2.0 | 1.0 | 0.7 | 8 | 104 | 4.6 | 2.6 | 2.3 |
| | | | | | 6 | 283 | 1.5 | 1.5 | 184 | 2.0 | 1.7 | 3 | 142 | 5.2 | 3.1 | 1.5 | 401 | 3.0 | 1.5 | 1.0 | 10 | 66 | 5.8 | 3.3 | 2.8 |
| | | | | | 8 | 159 | 2.0 | 2.0 | 104 | 2.6 | 2.3 | 4 | 80 | 6.9 | 4.1 | 2.0 | 225 | 4.0 | 2.0 | 1.4 | 12 | 46 | 6.9 | 3.9 | 3.4 |
| | | | | | 10 | 102 | 2.5 | 2.5 | 66 | 3.3 | 2.8 | 5 | 51 | 8.7 | 5.1 | 2.5 | 144 | 5.0 | 2.5 | 1.7 | 14 | 34 | 8.1 | 4.6 | 4.0 |
| | 12 | 71 | 2.9 | 2.9 | 46 | 3.9 | 3.4 | 6 | 35 | 10.4 | 6.2 | 2.9 | 100 | 6.0 | 3.0 | 2.1 | 16 | 26 | 9.2 | 5.3 | 4.5 | | | | |
| | NFL | 25° | 6000 | 3200 | 4 | 213 | 1.9 | 1.9 | 138 | 2.6 | 2.2 | 2 | 106 | 3.5 | 4.6 | 1.9 | 301 | 2.0 | 2.0 | 1.4 | 4 | 138 | 2.3 | 2.6 | 2.2 |
| | | | | | 6 | 94 | 2.9 | 2.9 | 61 | 3.9 | 3.3 | 3 | 47 | 5.2 | 7.0 | 2.9 | 134 | 3.0 | 3.1 | 2.0 | 6 | 61 | 3.5 | 3.9 | 3.3 |
| | | | | | 8 | 53 | 3.8 | 3.8 | 35 | 5.2 | 4.4 | 4 | 27 | 6.9 | 9.3 | 3.8 | 75 | 4.0 | 4.1 | 2.7 | 8 | 35 | 4.6 | 5.2 | 4.4 |
| | | | | | 10 | 34 | 4.8 | 4.8 | 22 | 6.5 | 5.5 | 5 | 17 | 8.7 | 11.6 | 4.8 | 48 | 5.0 | 5.1 | 3.4 | 10 | 22 | 5.8 | 6.5 | 5.5 |
| | 12 | 24 | 5.8 | 5.8 | 15 | 7.8 | 6.7 | 6 | 12 | 10.4 | 13.9 | 5.8 | 33 | 6.0 | 6.1 | 4.1 | 12 | 15 | 6.9 | 7.8 | 6.7 | | | | |
| | FL | 40° | 6000 | 1700 | 4 | 116 | 2.9 | 2.9 | 75 | 4.1 | 3.4 | 2 | 58 | 3.5 | 9.6 | 2.9 | 164 | 2.0 | 3.4 | 2.1 | 4 | 75 | 2.3 | 4.1 | 3.4 |
| | | | | | 6 | 51 | 4.4 | 4.4 | 33 | 6.1 | 5.0 | 3 | 26 | 5.2 | 14.5 | 4.4 | 73 | 3.0 | 5.0 | 3.1 | 6 | 33 | 3.5 | 6.1 | 5.0 |
| 8 | | | | | 29 | 5.8 | 5.8 | 19 | 8.1 | 6.7 | 4 | 14 | 6.9 | 19.3 | 5.8 | 41 | 4.0 | 6.7 | 4.1 | 8 | 19 | 4.6 | 8.1 | 6.7 | |
| 10 | | | | | 19 | 7.3 | 7.3 | 12 | 10.2 | 8.4 | 5 | 9 | 8.7 | 24.1 | 7.3 | 26 | 5.0 | 8.4 | 5.1 | 10 | 12 | 5.8 | 10.2 | 8.4 | |
| 12 | 13 | 8.7 | 8.7 | 8 | 12.2 | 10.1 | 6 | 6 | 10.4 | ** | 8.7 | 18 | 6.0 | 10.1 | 6.2 | 12 | 8 | 6.9 | 12.2 | 10.1 | | | | | |

| Lamp | Beam Type | Beam Spread° | Rated Life | CBCP | 0° | | 30° | | | 30° | | | 45° | | | | 60° | | | | | | | | |
|-------------------|-----------|--------------|------------|-------|----|-----|-----|-----|-----|------|------|---|-----|------|------|-----|-----|-----|------|-----|----|-----|-----|------|-----|
| | | | | | MH | FC | L | W | FC | L | W | D | FC | X | L | W | FC | X | L | W | D | FC | X | L | W |
| 75W PAR30 Halogen | SP | 10° | 2000 | 13000 | 6 | 361 | 0.9 | 0.9 | 235 | 1.3 | 1.1 | 3 | 181 | 5.2 | 1.9 | 0.9 | 511 | 3.0 | 0.9 | 0.7 | 8 | 132 | 4.6 | 1.7 | 1.5 |
| | | | | | 8 | 203 | 1.3 | 1.3 | 132 | 1.7 | 1.5 | 4 | 102 | 6.9 | 2.6 | 1.3 | 287 | 4.0 | 1.3 | 0.9 | 10 | 84 | 5.8 | 2.1 | 1.8 |
| | | | | | 10 | 130 | 1.6 | 1.6 | 84 | 2.1 | 1.8 | 5 | 65 | 8.7 | 3.2 | 1.6 | 184 | 5.0 | 1.6 | 1.1 | 12 | 59 | 6.9 | 2.5 | 2.2 |
| | | | | | 12 | 90 | 1.9 | 1.9 | 59 | 2.5 | 2.2 | 6 | 45 | 10.4 | 3.8 | 1.9 | 128 | 6.0 | 1.9 | 1.3 | 14 | 43 | 8.1 | 2.9 | 2.5 |
| | | | | | 14 | 66 | 2.2 | 2.2 | 43 | 2.9 | 2.5 | 7 | 33 | 12.1 | 4.5 | 2.2 | 94 | 7.0 | 2.2 | 1.6 | 16 | 33 | 9.2 | 3.4 | 2.9 |
| | FL | 27° | 2000 | 3100 | 6 | 86 | 2.9 | 2.9 | 56 | 3.9 | 3.3 | 3 | 43 | 5.2 | 7.0 | 2.9 | 122 | 3.0 | 3.1 | 2.0 | 4 | 126 | 2.3 | 2.6 | 2.2 |
| | | | | | 8 | 48 | 3.8 | 3.8 | 31 | 5.2 | 4.4 | 4 | 24 | 6.9 | 9.3 | 3.8 | 69 | 4.0 | 4.1 | 2.7 | 6 | 56 | 3.5 | 3.9 | 3.3 |
| | | | | | 10 | 31 | 4.8 | 4.8 | 20 | 6.5 | 5.5 | 5 | 16 | 8.7 | 11.6 | 4.8 | 44 | 5.0 | 5.1 | 3.4 | 8 | 31 | 4.6 | 5.2 | 4.4 |
| | | | | | 12 | 22 | 5.8 | 5.8 | 14 | 7.8 | 6.7 | 6 | 11 | 10.4 | 13.9 | 5.8 | 30 | 6.0 | 6.1 | 4.1 | 10 | 20 | 5.8 | 6.5 | 5.5 |
| | | | | | 14 | 16 | 6.7 | 6.7 | 10 | 9.1 | 7.8 | 7 | 8 | 12.1 | 16.2 | 6.7 | 22 | 7.0 | 7.1 | 4.8 | 12 | 14 | 6.9 | 7.8 | 6.7 |
| | FL | 40° | 2000 | 2000 | 6 | 56 | 4.0 | 4.0 | 36 | 5.6 | 4.6 | 3 | 28 | 5.2 | 12.1 | 4.0 | 79 | 3.0 | 4.5 | 2.8 | 4 | 81 | 2.3 | 3.7 | 3.1 |
| | | | | | 8 | 31 | 5.4 | 5.4 | 20 | 7.4 | 6.2 | 4 | 16 | 6.9 | 16.1 | 5.4 | 44 | 4.0 | 6.0 | 3.8 | 6 | 36 | 3.5 | 5.6 | 4.6 |
| | | | | | 10 | 20 | 6.7 | 6.7 | 13 | 9.3 | 7.7 | 5 | 10 | 8.7 | 20.1 | 6.7 | 28 | 5.0 | 7.5 | 4.7 | 8 | 20 | 4.6 | 7.4 | 6.2 |
| | | | | | 12 | 14 | 8.0 | 8.0 | 9 | 11.1 | 9.3 | 6 | 7 | 10.4 | 24.1 | 8.0 | 20 | 6.0 | 9.0 | 5.7 | 10 | 13 | 5.8 | 9.3 | 7.7 |
| | | | | | 14 | 10 | 9.4 | 9.4 | 7 | 13.0 | 10.8 | 7 | 5 | 12.1 | ** | 9.4 | 14 | 7.0 | 10.5 | 6.6 | 12 | 9 | 6.9 | 11.1 | 9.3 |

The beam spread in degrees and the beam "L" and "W" in the following tables are computed at 50% of centerbeam candlepower and represent areas of "effective illumination."

**Due to steep aiming angle, length of beam extends beyond 25'.

