



**Description:** TruLine .5A TruQuad offers glare-free architectural lighting accents—in square or rectangular configurations—that fit within 5/8" drywall. The 24VDC linear LED system features a shallow, 5/8" deep plaster-in aluminum extrusion (thinner than drywall) that houses a single row of high CRI, commercial-grade white or color changing LED Soft Strip. Its .5" wide diffuser lens projects a clean line of light without LED dots. System mounts directly to studs without joist modification. TruQuad is sold in 1 inch increments from 6 inches to 400 inches. Coordinate installation with electrician and drywall contractors. Fixture includes 5 year warranty. ETL listed. Patent pending.

**Design Note:** TruQuad can be installed on a single surface (wall or ceiling) and allows for the creation of personalized square or rectangular configurations. LEDs mount to side wall of the channel, wrapping continuously to create seamless illumination

**Applications:** Indoor Only — General illumination and architectural accent lighting for offices, hospitality, retail, residences, libraries, closets, hallways, bath/vanity.

**Lamp:**

Watts per Foot	Lumens per Watt	Lumens per Foot	85+CRI 24k, 35K, 40K, 57K	90+CRI 2K4K	95+CRI 27K, 30K	RGB	RGBW
2WDC	52	169	•		•		
5WDC	50	244	•	•	•	•	
6WDC	N/A	N/A					•

Lumen values are based on the 3000K LED test.

**Average Lamp Life:** 50,000 hours

**24VDC Power Supply:**

**White LED system, compatible Electronic Low Voltage Dimming (ELV) 120VAC input:**

PSB-60W-ELV-24VDC (60W output) | PSB-100W-ELV-24VDC (96W output) | PSB-2X100W-ELV-24VDC (2X96W output) | PSB-3X100W-ELV-24VDC (3X96W output) | PSB-4X100W-ELV-24VDC (4X96W output)

**White LED system, compatible 0-10 Volt Dimming (010) 120-277VAC input:**

PSB-96W-010-24VDC (96W output) | PSB-2X96W-010-24VDC (2X96W output) | PSB-3X96W-010-24VDC (3X96W output) | PSB-4x96W-010-24VDC (4X96W output)

**In-Wall Mounting Kits:** PSB-60W-ELV-24VDC-IW | PSB-100W-ELV-24VDC-IW | PSB-2X100W-ELV-24VDC-IW | PSB-96W-010-24VDC-IW | PSB-2X96W-010-24VDC-IW

**RGB and RGBW LED System:** PSB-100W-24VDC-RGB (100W output) | PSB-2X100W-24VDC-RGB (2X100W output) | PSB-3X100W-24VDC-RGB (3X100W output) | PSB-4X100W-24VDC-RGB (4X100W output)

**Dimming and Controls:**

**ELV Dimmers:** Legrand: Adorne ADTH700RMTU ; Lutron: DIVA DVELV-300P, Skylark SELV-300P and Maestro MAELV-600. **010V Dimmers:** Lutron: Radio Ra2 (with GRX-TVI), Grafik Eye Qs (with GRX-TVI), Diva (with PP20); Nova T; Philips: Sunrise SR1200ZTUNV; Leviton: IP710-LF.

**RGB Controls:** Touch Screen Controller with Power Supply (CTP), or Color Dial Controller with Power Supply (CDP).

**Included Components:** TruQuad channel, lens, LED Soft Strip, appropriate number of L-shaped Power Channel Connectors and all mounting hardware. See page 2 of spec sheet for additional details.

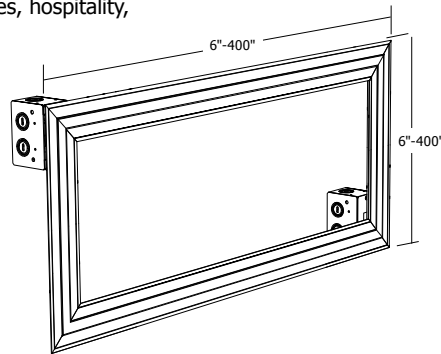

**TRULINE .5A TRUQUAD ORDERING CODE**

System	Watts per Foot	Length x Width in Inches	Color Temperature
<b>TL.5A</b>	<b>- 2W</b>	<b>- 6X400</b>	<b>- 27K</b>
<b>TL.5A</b>	TruLine .5A .5" Wide 5/8" Deep	<b>2W</b> 2.5 Watts <b>5W</b> 5 Watts <b>6W</b> 6 Watts	6-400 Inches (in 1 inch increments) Per Side <b>24K</b> 2400K Amber White <b>27K</b> 2700K Very Warm White <b>30K</b> 3000K Warm White <b>35K</b> 3500K Neutral White <b>40K</b> 4000K Cool White <b>57K</b> 5700K Daylight White <b>2K4K</b> 2000K-4100K Tunable White (5WDC only) <b>RGB</b> Red, Green and Blue (5W only) <b>RGBW</b> RGB and 20K (6W only)

For custom design and layout assistance, send drawings to design@purelighting.com

COMPANY		FIXTURE TYPE		DATE	
PROJECT		APPROVED BY			

Product specification subject to change without notification. REV. 05.05.16





TRUQUAD - LED ON SIDE OF CHANNEL

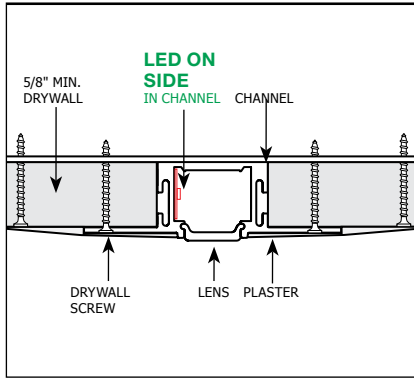

TRULINE .5A  
SECTION VIEW - LED ON SIDE

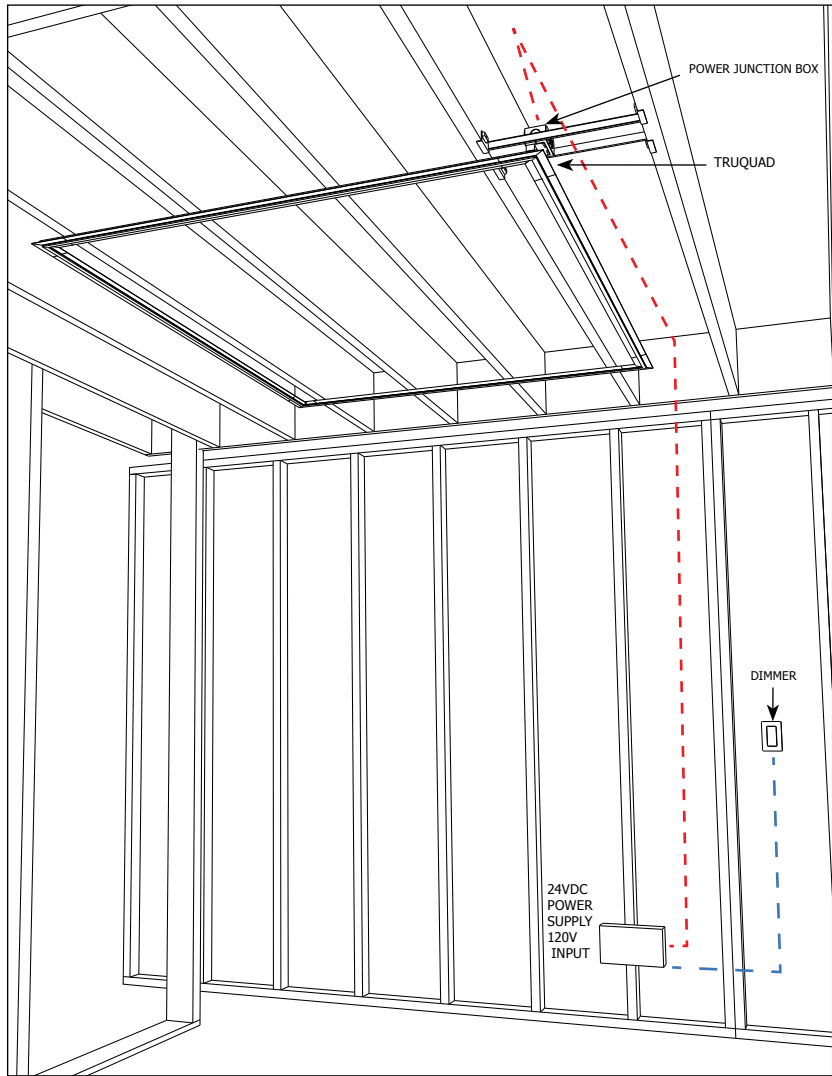

INCLUDED COMPONENTS

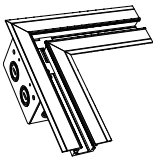

**TRULINE .5A L-SHAPED POWER CHANNEL CONNECTORS**

TruQuad includes 1, 2 or 4 L-shaped Power Channel Connectors based on max wattage of design.



**LED SOFT STRIP**

TruQuad includes desired commercial grade white or color-changing LED Soft Strip. See Lamp data on page 1 of spec sheet for additional details.

COMPANY		FIXTURE TYPE		DATE	
PROJECT		APPROVED BY			

Product specification subject to change without notification. REV. 05.05.16

A Division of PureEdge Lighting 1718 W. Fullerton Chicago, IL 60614 • Ph: 773.770.1196 • Ph: 773.883.6128 • Fax: 773.883.6128 • www.purelighting.com





**Application:** 0-10V dimming for TruLine .5A Channel  
**Power Supply:** PSB-96W-010-24VDC (24VDC 96W output) | PSB-2X96W-010-24VDC (24VDC 2X96W output).  
**Dimming:** Radio Ra2 (with GRX-TVI), Grafik Eye Qs (with GRX-TVI), Diva (with PP20); Nova T; Philips: Sunrise SR1200ZTUNV; Leviton: IP710-LF.

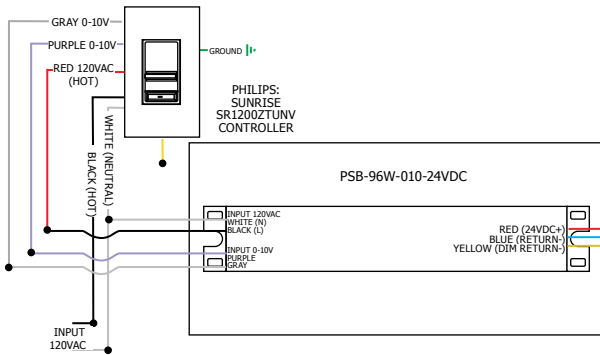

96W, 24VDC LOW VOLTAGE WIRE SIZE CHART: 3% VOLTAGE DROP

WIRE LENGTH (FT)	UP TO 33FT	34FT-52FT	53FT-86FT	87FT-130FT
WIRE SIZE	14 AWG	12 AWG	10 AWG	8 AWG
VOLTAGE AT END OF WIRE	23.28VDC	23.29VDC	23.28VDC	23.28VDC

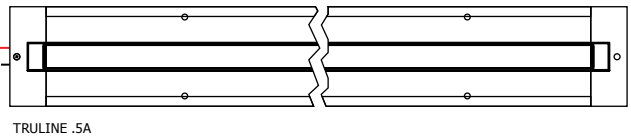

**TO ORDER TRUQUAD POWER SUPPLY**

Select power supply based on total system wattage (100 watts max before refeeding). Order the desired Class 2, 24VDC power supply that best fits the dimming and mounting conditions.

See example below for ordering 384 inches of TruQuad, which consumes 160 total watts and requires (2) PSB-100W-ELV-24VDC power supplies. See Pg. 1 of specification sheet for compatible power supply options and TruQuad ordering code.

Example:

Determine Power Supplies

$$384 \div 12 = 32 \times 5 = 160 =$$

Total Number of System Inches (All Lengths Added Together)      Total Feet      Watts per Foot      Total System Wattage

2 X Power Supply Ordering Code

Product      Wattage      Dimming      Voltage

**PSB - 100W - ELV - 24VDC**

1 X TruQuad Square or Rectangle Ordering Code

System      Watts per Foot      Length x Width in Inches      Color Temperature

**TL.5A - 5W - 20X172 - 27K**

**POWER SUPPLY COMPATIBILITY FOR WHITE LED SYSTEMS**

TOTAL SYSTEM WATTAGE	COMPATIBLE POWER SUPPLIES	
1-60W	PSB-60W-ELV-24VDC	PSB-96W-010-24VDC
60W-100W	PSB-100W-ELV-24VDC	PSB-96W-010-24VDC
100W-200W	PSB-2X100W-ELV-24VDC	PSB-2X96W-010-24VDC
200W-300W	PSB-3X100W-ELV-24VDC	PSB-3X96W-010-24VDC
300W-400W	PSB-4X100W-ELV-24VDC	PSB-4X96W-010-24VDC

COMPANY		FIXTURE TYPE		DATE	
PROJECT		APPROVED BY			

Product specification subject to change without notification. REV. 05.05.16

