



©2016 Pure Lighting. All Rights Reserved.

Installation Instructions For TruLine 1.6A TruQuad



1718 W. Fullerton Ave
Chicago, IL 60614
Tel: 773-770-1196
Fax: 773-883-6128
www.purelighting.com
info@purelighting.com

IMPORTANT INFORMATION

- This product is wall or ceiling mount.
- This instruction shows a typical installation.
- This product is ETL listed for indoor use.

SAVE THESE INSTRUCTIONS!

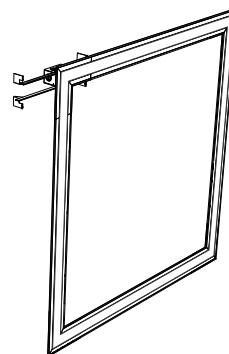

Section One: Prepare and Install Junction Box and Power Connections

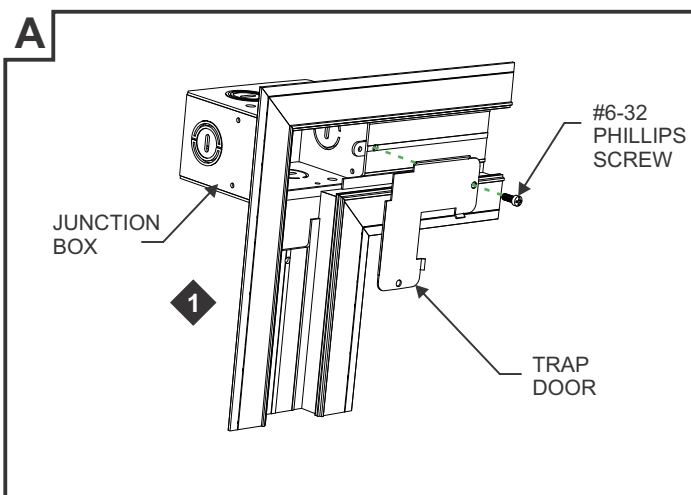

1: Remove the #6-32 screw from the junction box to remove the trap door from the assembly.

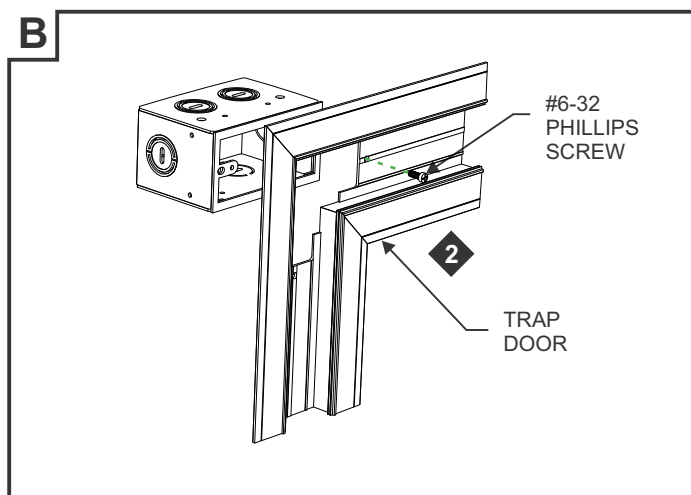

2: Remove the #6-32 screw from the junction box to remove the L-Power Connector assembly.

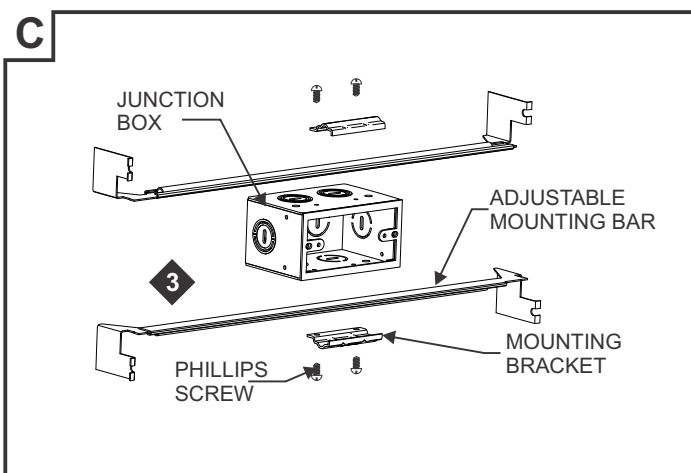

3: Mount each adjustable mounting bar to one side of the junction box and secure them with the mounting brackets and two Phillips screws provided.

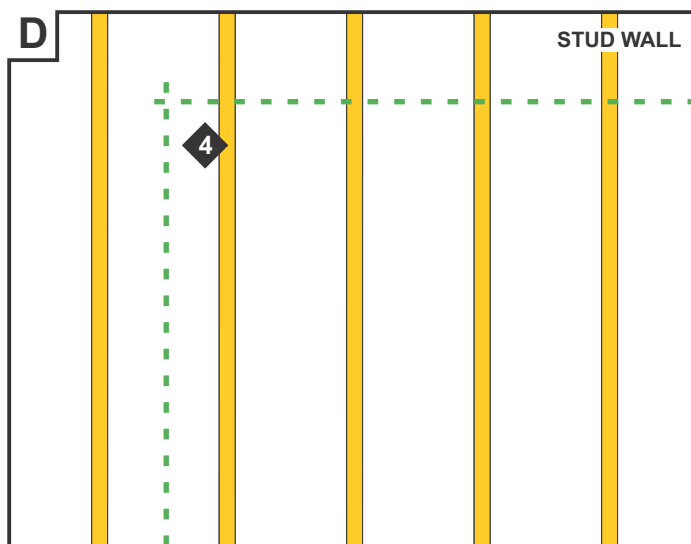

4: Measure and locate desired junction box mounting location. Determine the corner that the junction box will be installed to. Longer installation lengths may require two (opposing corners) or four (all corners) junction boxes.

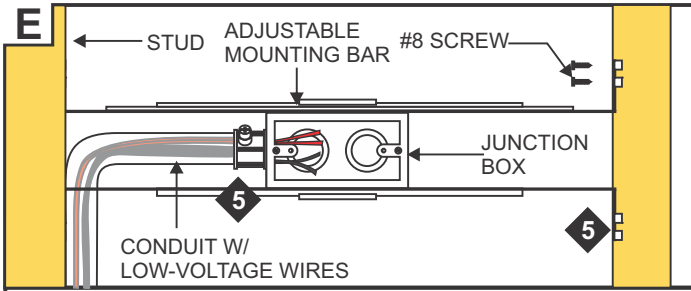

NOTE: The adjustable mounting bars mount to studs that are spaced 13" to 24" apart.

- 5: Place the lips on the adjustable mounting bars against the studs. Secure the adjustable bars to the studs with the eight #8 screws.
- 6: Install power supply (reference installation instructions included with power supply) and conduit (if required by local electrical code) and run low-voltage power wires to the junction box.

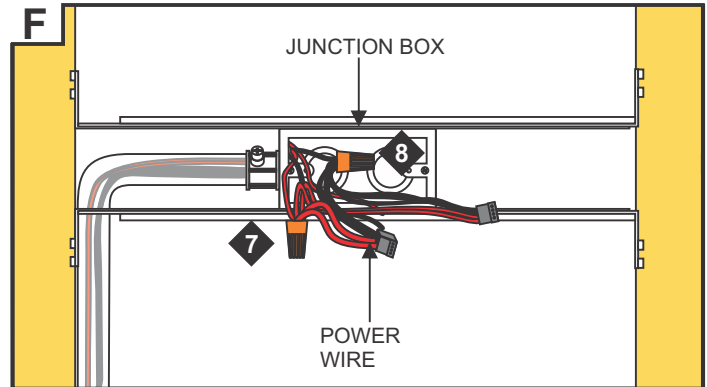

- 7: Connect the red power supply (24VDC+) wires to each red power wire with a wire nut inside the junction box.
- 8: Connect the black power supply (24VDC-) wires to each black power wire with a wire nut inside the junction box.
- 9: Place the wire nut connections inside junction box.

Section Two: Prepare Drywall and Install Channel

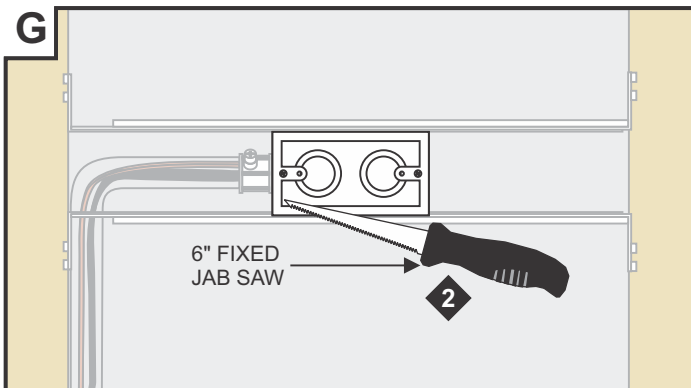

- 1: Install drywall.
- 2: Using location measurements from previous steps, mark the drywall and cut a section where the junction box will be located using a 6" fixed jab saw or other appropriate tool.

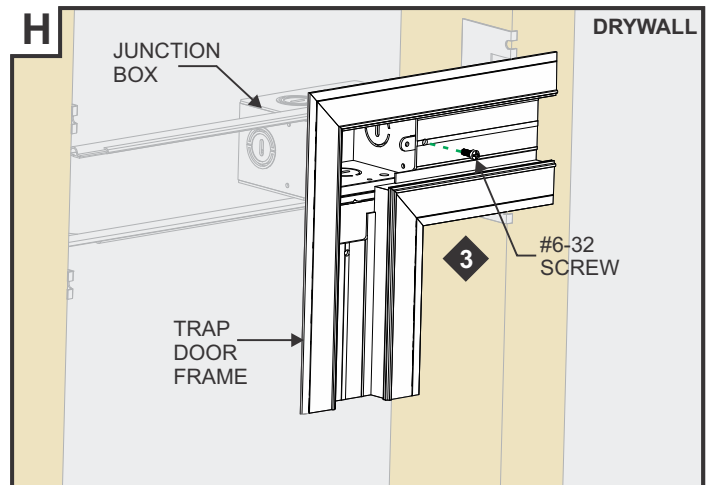

- 3: Attach the assembled trap door frame to the junction box using a #6-32 screw.

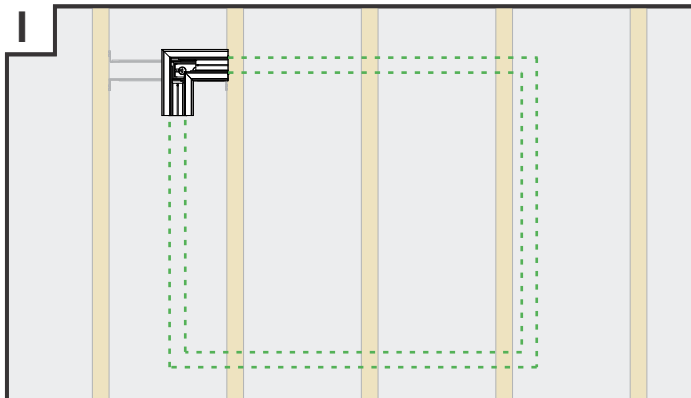

- 4: Mark the installation location on the drywall using a pencil or chalk line before cutting.

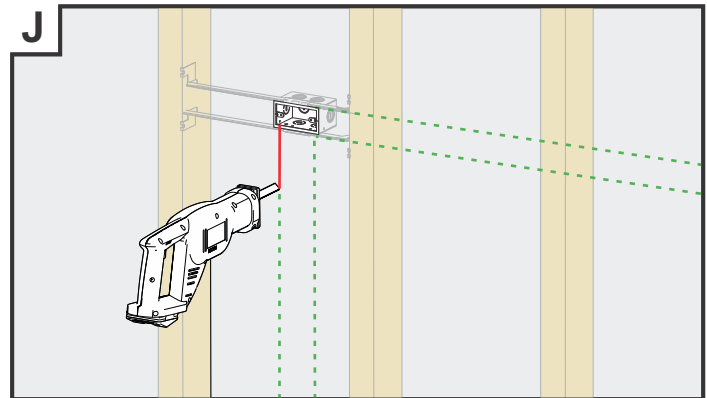

- 5: Remove the trap door frame before cutting.
- 6: Cut the drywall along the marked installation path using a reciprocating saw or other appropriate tool.

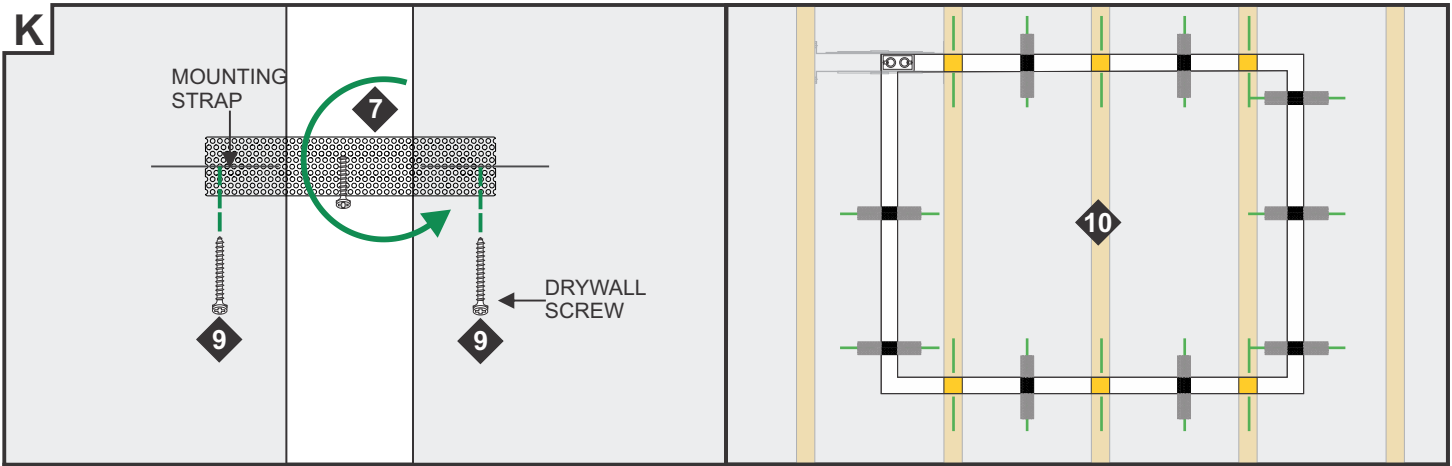

- 7:** Install mounting straps behind the drywall where studs are not available (suggested spacing is every 32") by threading a drywall screw into the perforated material.
- 8:** Place the mounting strap behind the cut drywall and rotate into place using the drywall screw as a handle.
- 9:** Secure the mounting strap to the drywall using two drywall screws.
- 10:** Mark the location of the studs and mounting straps on the drywall.

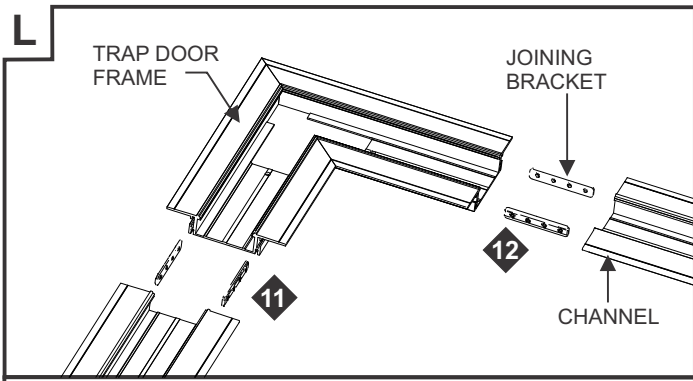

- 11:** Insert joiner bars halfway into the Trap Door Frame. Tighten the M4 set screws on each joiner bar with a 1.5MM Allen wrench.
- 12:** Slide the other section of channel onto the joining bars and tighten the remaining M4 set screws with a 1.5MM Allen wrench.

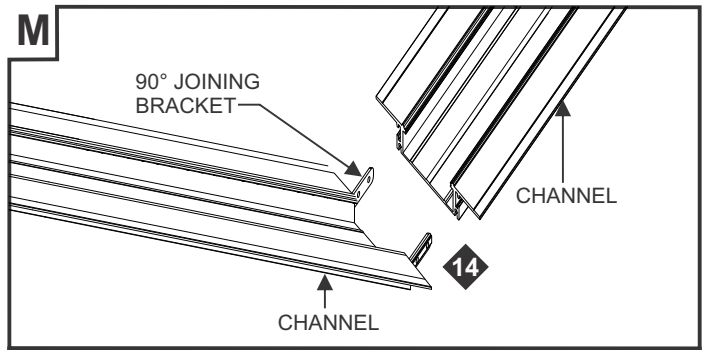

- 13:** Insert a 90° joiner bracket halfway into one mitered channel corner. Tighten the two M4 set screws on each joiner bar with a 1.5MM Allen wrench.
- 14:** Slide the other section of mitered channel onto the 90° joining brackets and tighten the remaining M4 set screws with a 1.5MM Allen wrench.

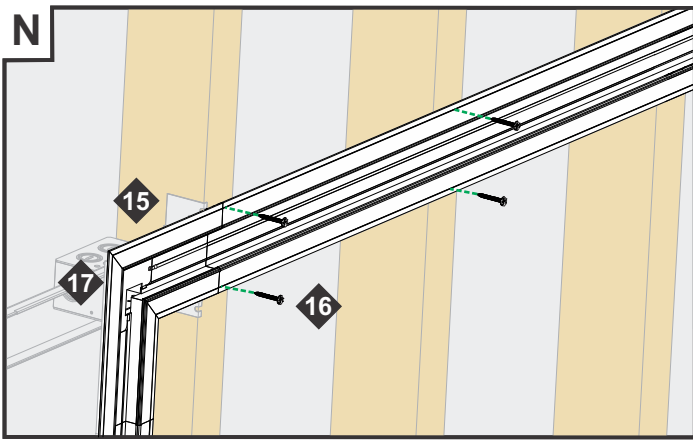

- 15:** Place the assembled channel to the drywall cutout. Using the marked locations on the drywall, drill and countersink the channel using the provided square drill with counter sink bit.
- 16:** Secure the channel to the studs/mounting straps through the drywall with the #6 screws using the provided square recess bit.
- 17:** Secure the Trap Door channel section to the junction box with the supplied screw.

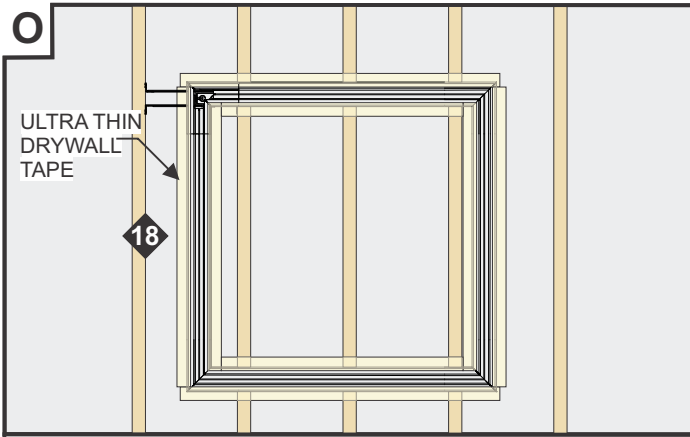

NOTE: Test the LED strip before any plaster work is done.

18: Apply ultra-thin drywall tape along edges of channel to prevent cracking of plaster after installation. **DO NOT OVERLAP DRYWALL TAPE!**

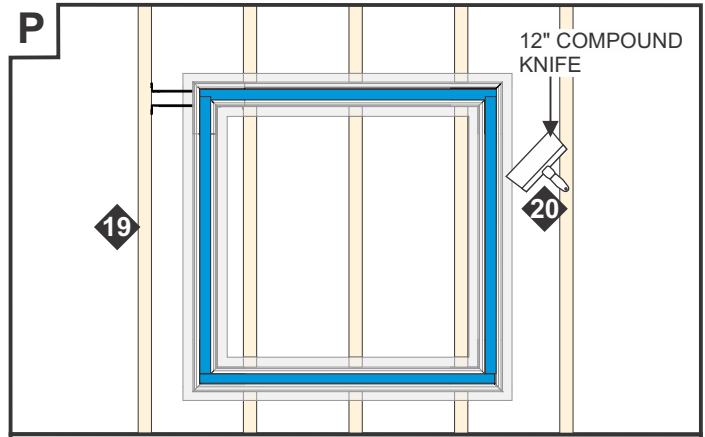

19: Mask the interior surfaces of the channel using blue contractor's tape before plastering and painting.

20: Use a 12" compound knife for a smooth compound spread. Sand, paint, and finish the plaster and drywall before removing the blue contractor's tape.

Section Three: Install Soft Strip and Lens

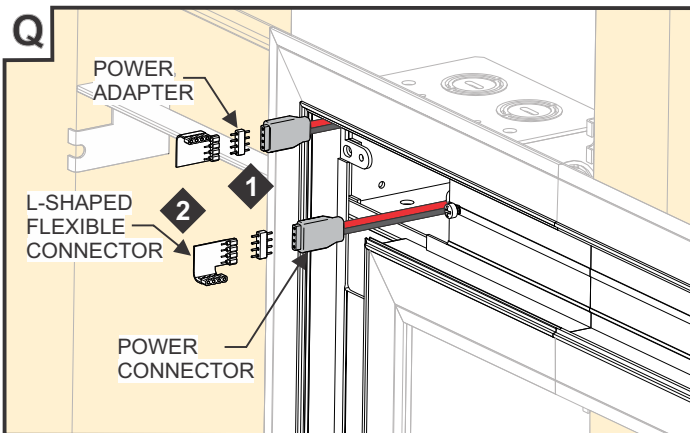

1: Insert one male-to-male power adapter to each power connector.

2: Connect one L-Shaped Flexible Power Connector to each male-to-male power adapter.

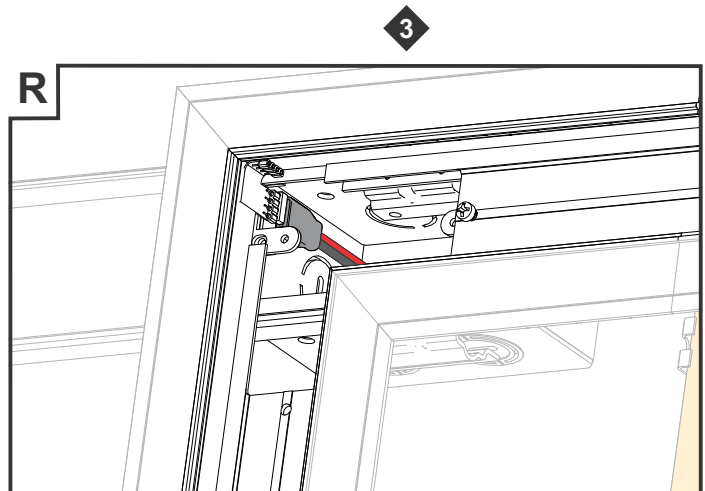

3: Place the assembled outer corner power connection into the channel where the LED strip will be installed.

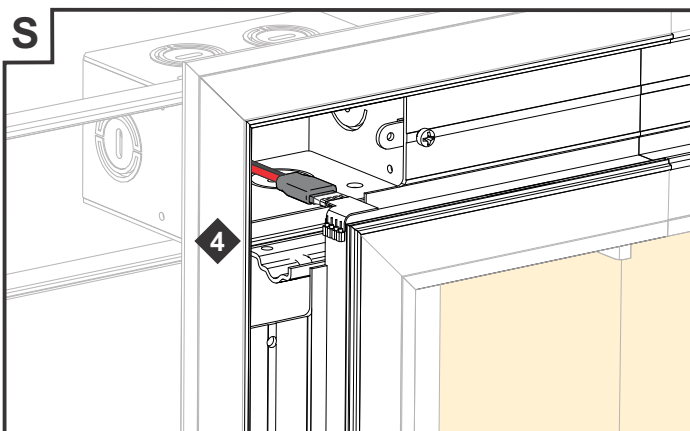

4: Place the assembled inner corner power connection into the channel where the LED strip will be installed.

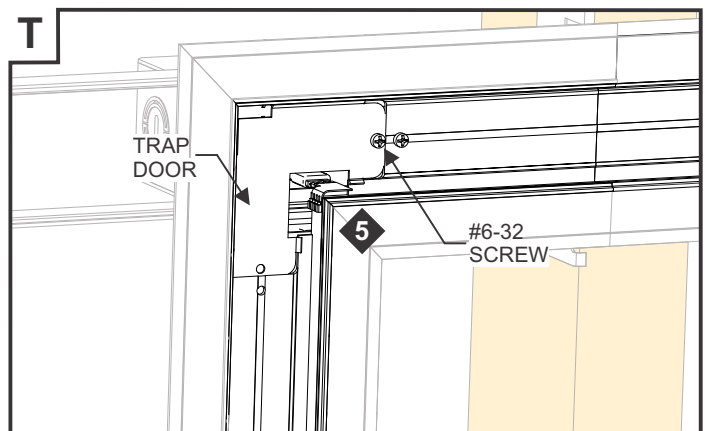

5: Replace the trap door and secure using the #6-32 screws.

6: If necessary (depending on design), repeat step 1 through 5 for other corners.

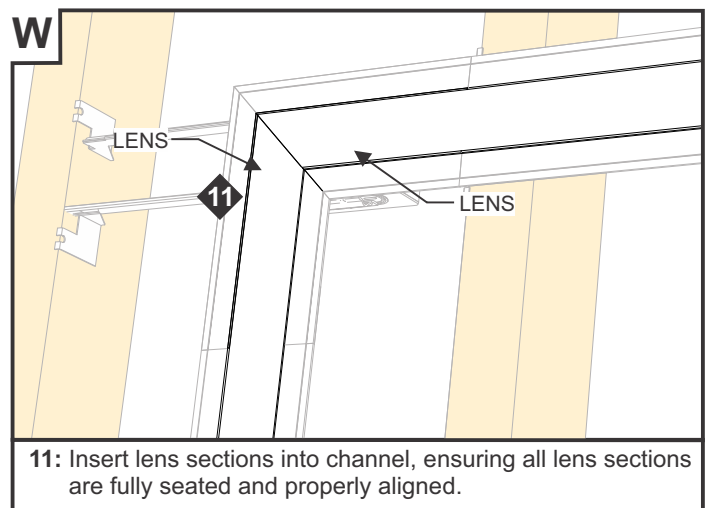
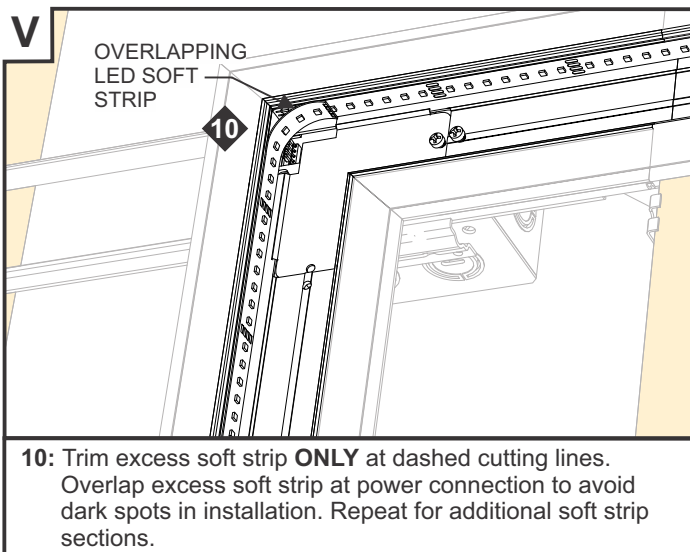
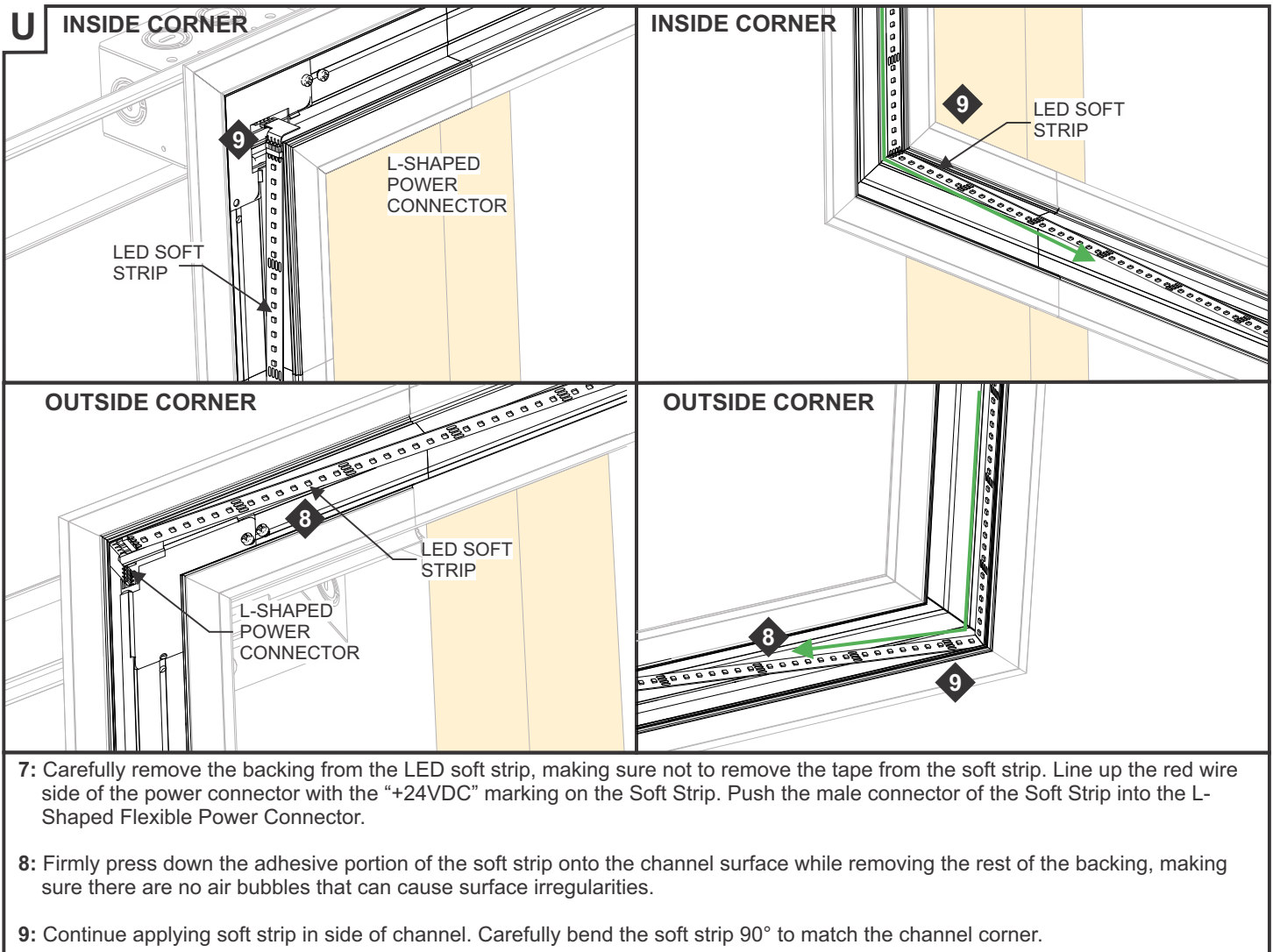

Section Four: Wiring Diagrams

Standard 24VDC Configuration

Using 24VDC Power Supply with 24VDC LED Soft Strip

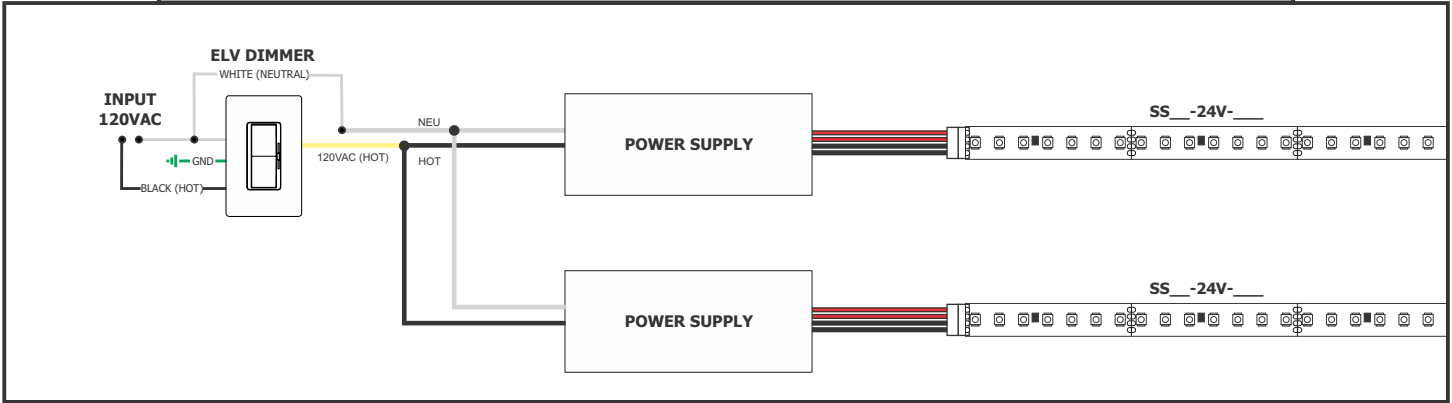

Standard RGB Configuration

Using LED Power Supply with RGB Soft Strip & CDP or CTP Control

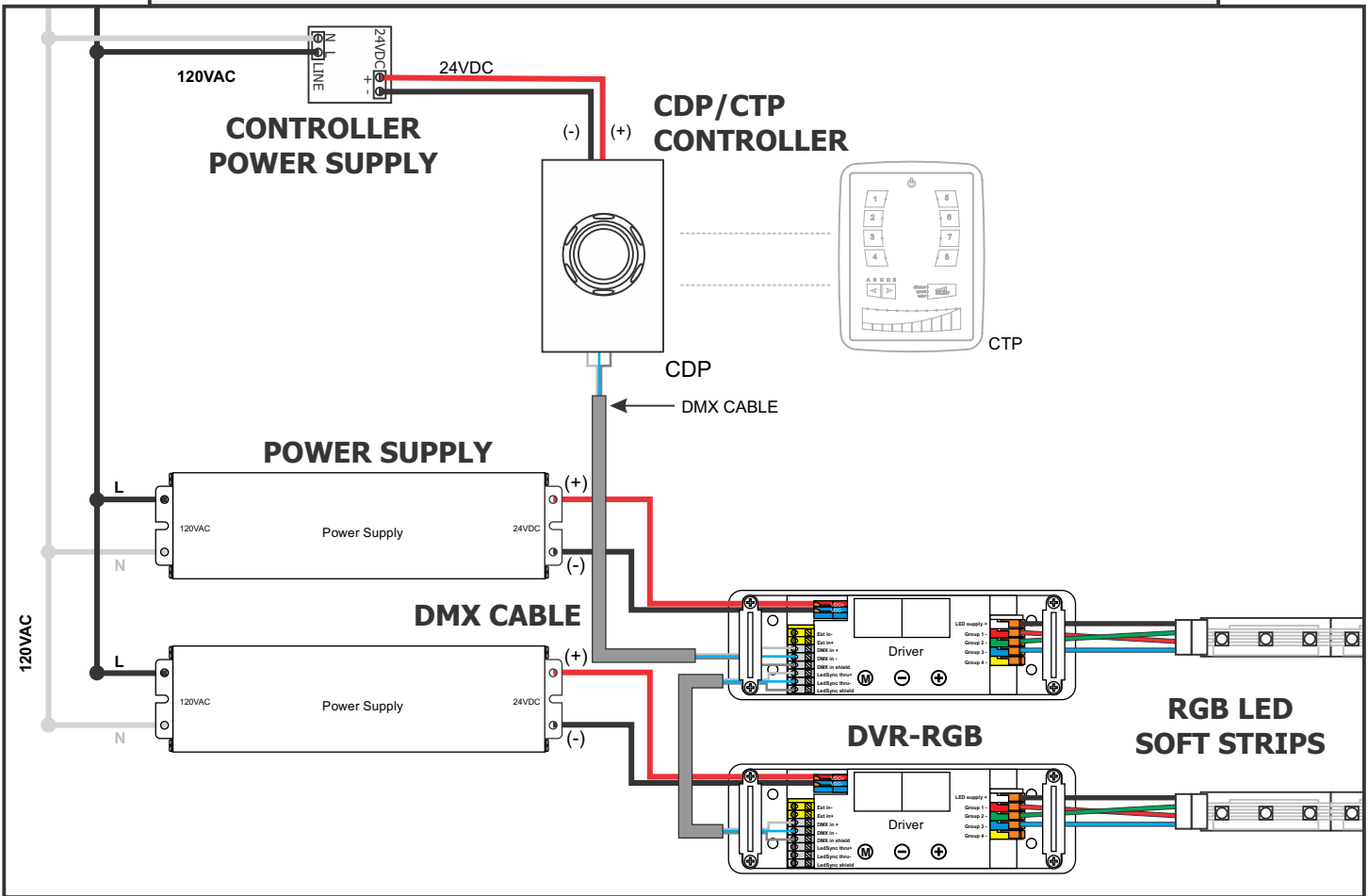

RGB+W Configuration

Using LED Power Supply with RGB+W Soft Strip & CDP or CTP Control

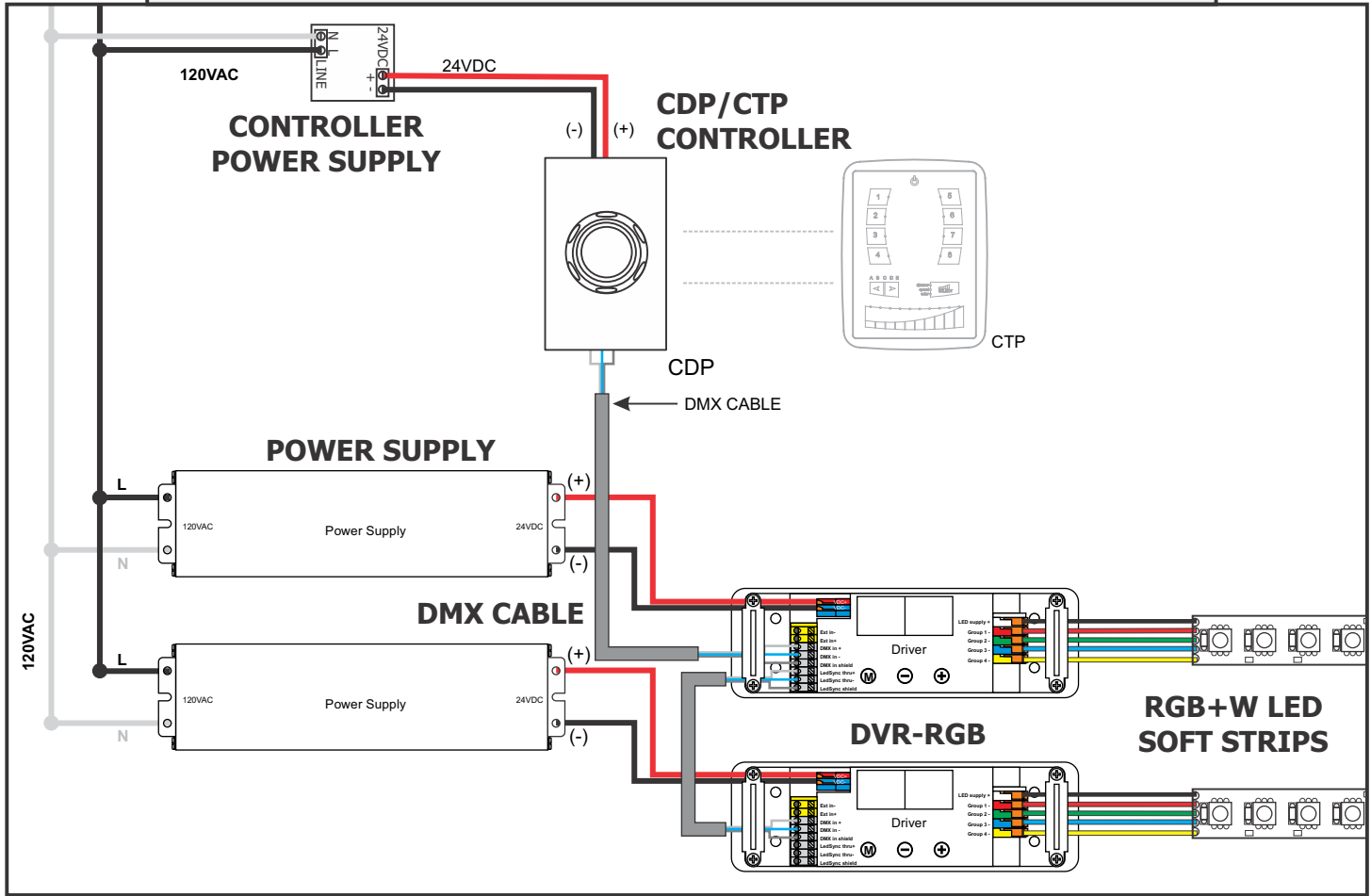

Tunable White Configuration

Dual Power Supplies Controlled Via Individual ELV Dimmers

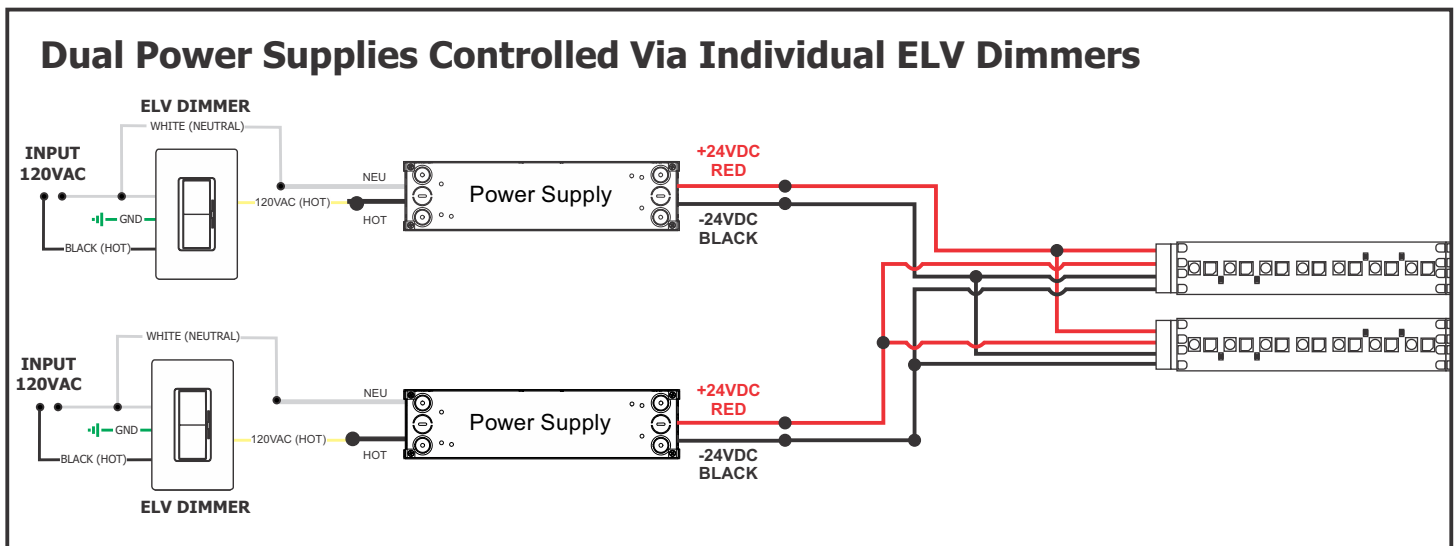

Tunable White Configuration

RGB Power Supply with DMX Controller

If using a CDP Color Dial, configure your CDP to Warm White mode using DIP switches and follow CDP operating instructions:

