



© 2017 Pure Lighting. All Rights Reserved.

Installation Instructions For TruLine 1.6A L-Picture Frame Power Channel Connector

1718 W. Fullerton Ave
Chicago, IL 60614
Tel: 773-770-1196
Fax: 773-883-6128
www.purelighting.com
info@purelighting.com

IMPORTANT INFORMATION

- This instruction must be used concurrently with other TruLine 1.6A BIY installation instructions.
- This fixture is wall or ceiling mount.
- This instruction shows a typical installation.

SAVE THESE INSTRUCTIONS!

Section One: Install the Junction Box

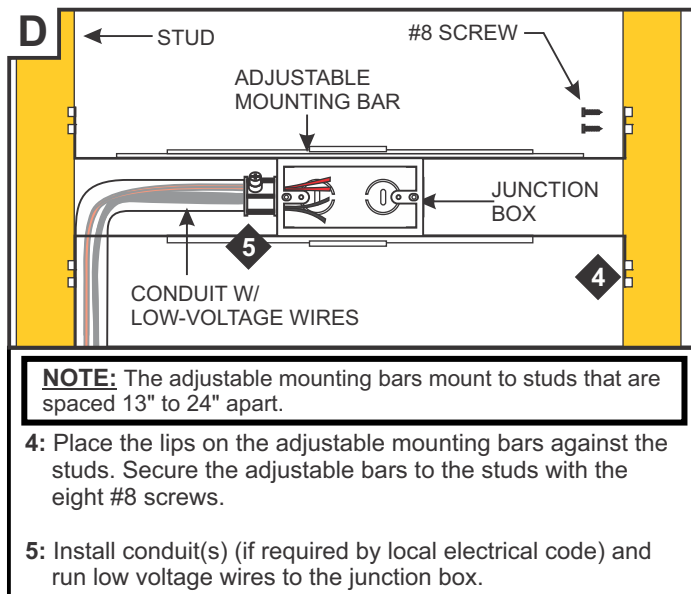
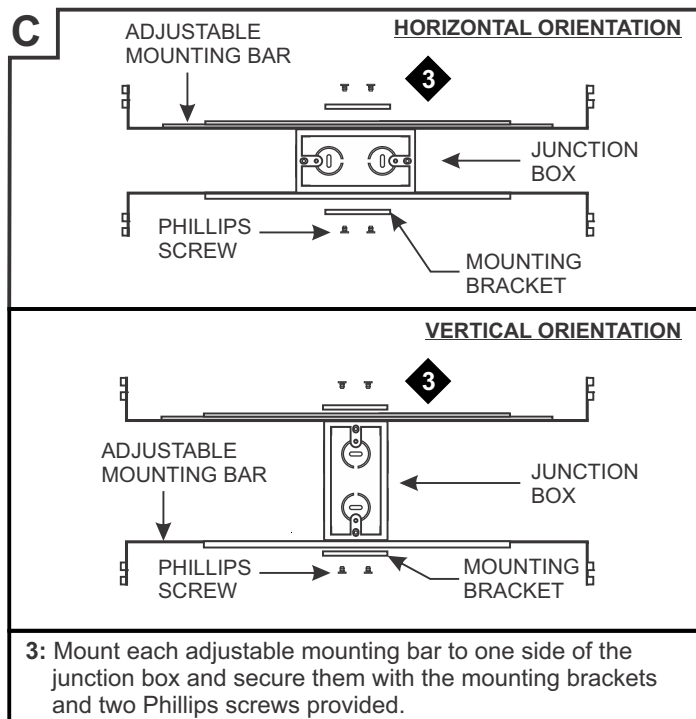
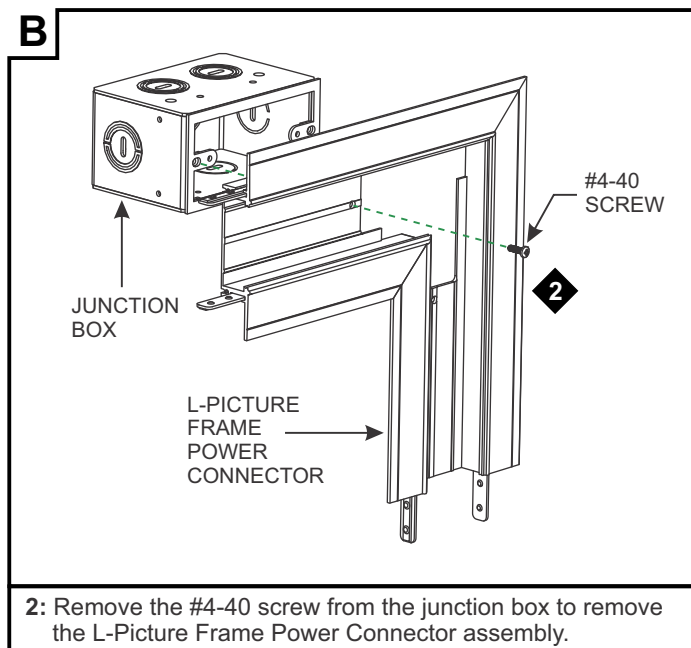
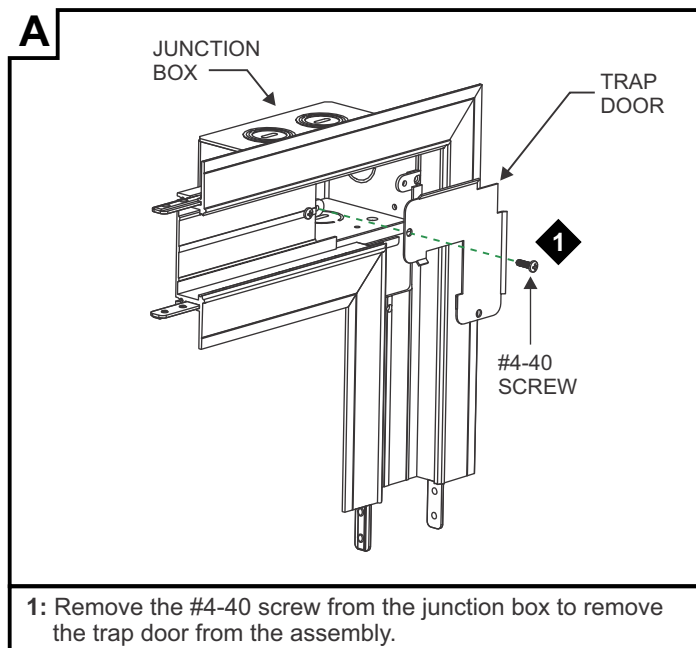

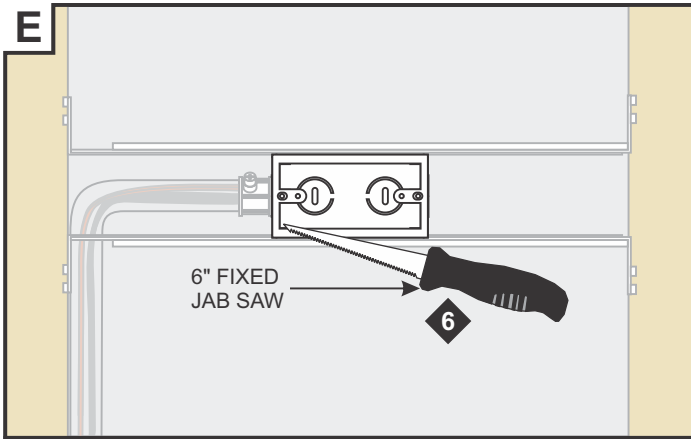

6: Cut a section of drywall where the junction box will be located using a 6" fixed jab saw or other appropriate tool.

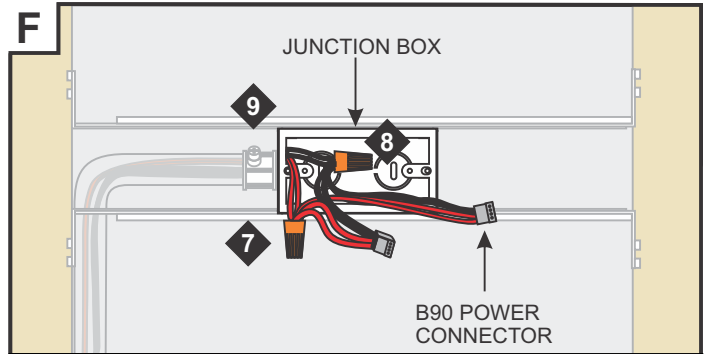

NOTE: Remote power supply wires must be present in junction box. Refer to instructions provided with power supply.

7: Connect the red low voltage wires to the red power connector wires with a wire nut.

8: Connect the black low voltage wires to the black power connector wires with a wire nut.

9: Place all wire nut connections inside the junction box.

Section Two: Prepare and Install the L-Picture Frame Power Connector

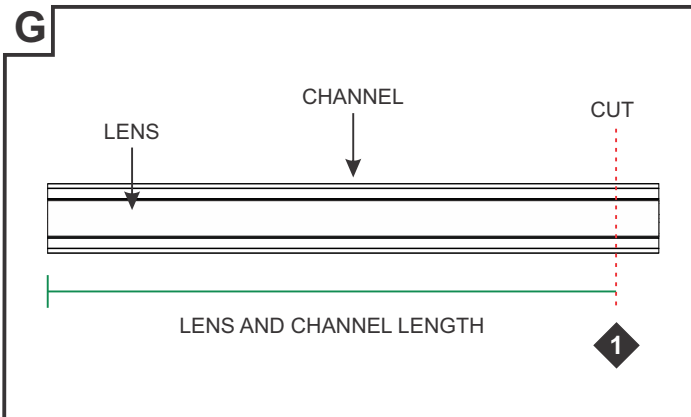

1: Refer to Section One in the TruLine 1.6A Channel and Lens instructions to measure and cut the channel and lens before continuing.

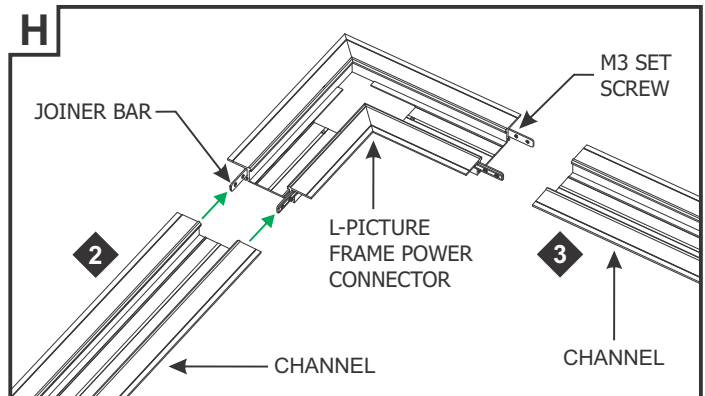

2: Slide a straight channel onto the joiner bars and tighten the remaining M3 set screws with a 1.5mm Allen wrench.

3: Repeat step 2 for the other end of the L-Picture Frame Power Connector.

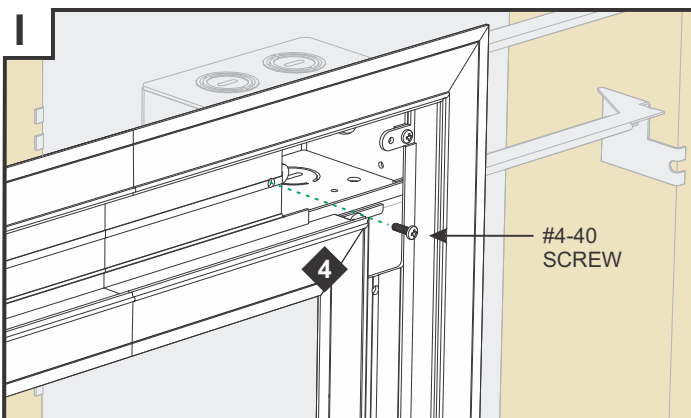

4: Attach the assembled trap door frame to the junction box using the #4-40 screw.

NOTE: Refer to Section Three in the TruLine 1.6A Channel and Lens instructions to plaster before continuing.

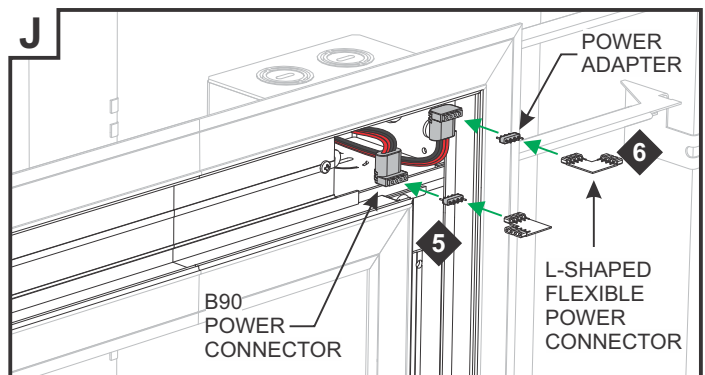

5: Insert the male-to-male power adapter to the B90 power connector.

6: Connect the L-Shaped Flexible Power Connector to the male-to-male power adapter.

NOTE: L-Shaped Flexible Power Connector is used for installations when the LED strip is placed on the side of the channel. For alternate LED strip installation, see Section Four or Section Five.

Section Three: Install the LED Soft Strip

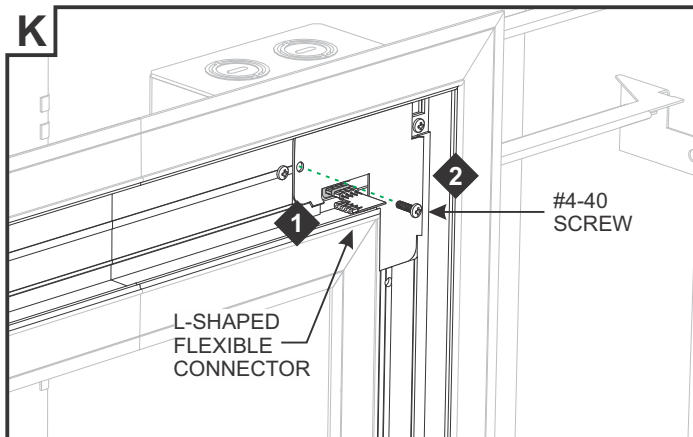

- 1: Place the assembled power connectors into the channel where the LED soft strip will be installed.
- 2: Replace the trap door and secure using the #4-40 screw.

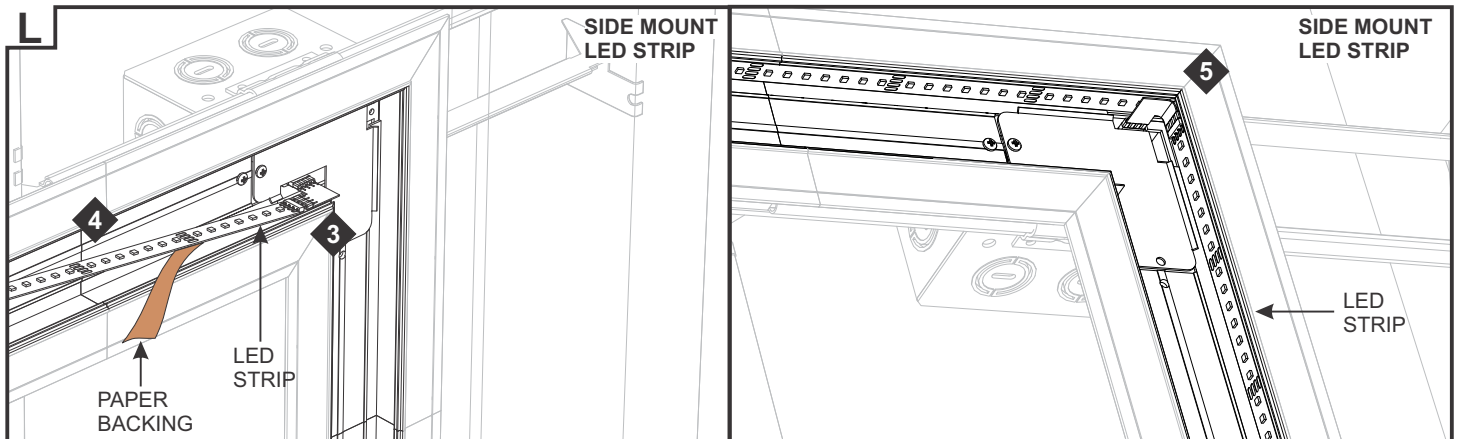

- 3: Carefully remove the backing from the LED soft strips, making sure not to remove the tape from the LED strips. Line up the red wire side of the power connector with the "+24VDC" marking on each LED strip. Push the male connector of the LED strips into the L-Shaped Flexible Power Connectors.
- 4: Firmly press down the adhesive portion of the LED strips onto the channel surface while removing the rest of the backing, making sure there are no air bubbles that can cause surface irregularities.
- 5: Trim excess LED strip **ONLY** at dashed cutting lines. Overlap excess LED strip at power connection to avoid dark spots.

NOTE: Refer to Sections Five and Six in the TruLine 1.6A Channel and Lens instructions to complete the installation.

Section Four: Alternate LED Soft Strip Installation

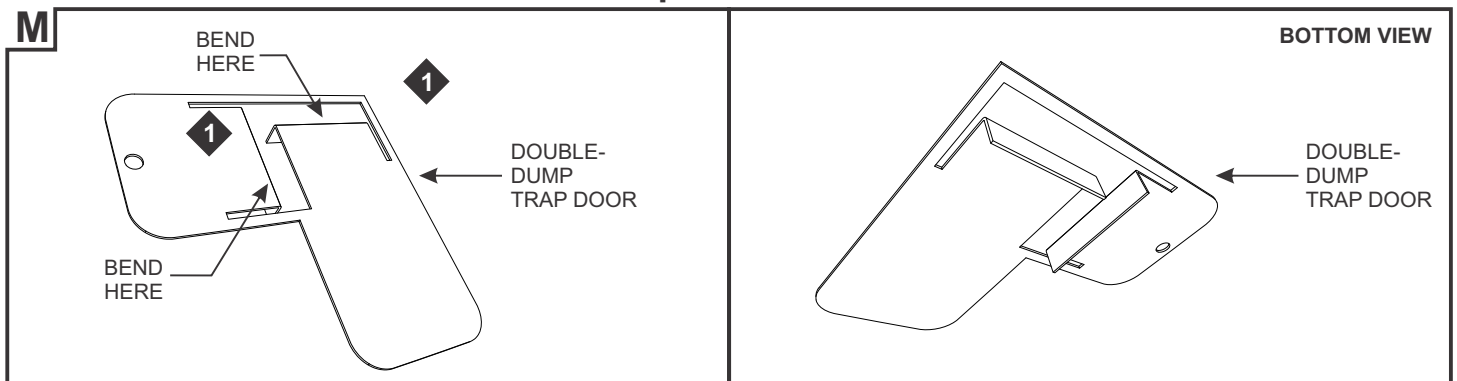

NOTE: For installations where the LED Soft Strip will lay in the bottom of the channel it is necessary to use a double-dump trap door.

- 1: Use pliers to bend the sections of the trap door cover ~90° to allow for access to power connections.

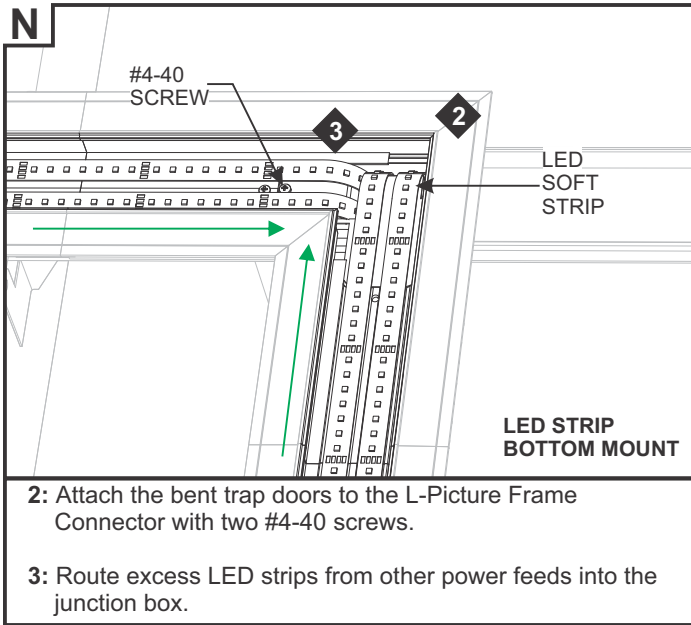

- 2:** Attach the bent trap doors to the L-Picture Frame Connector with two #4-40 screws.
- 3:** Route excess LED strips from other power feeds into the junction box.

Section Five: L-Picture Frame Dual Feed Power Channel Connector

Install the LED Soft Strip on Bottom of Channel

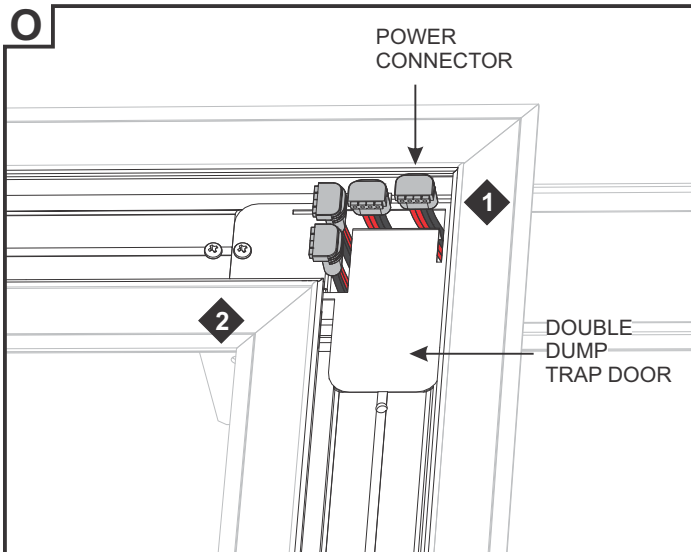

NOTE: This product can be used as a combination of side and bottom mount.

- 1:** Repeat steps 7 through 9 in Section One to connect two additional power connectors to the power supply(s) wires.
- 2:** Repeat steps 1 and 2 in Section Four to attach the double-dump trap door.

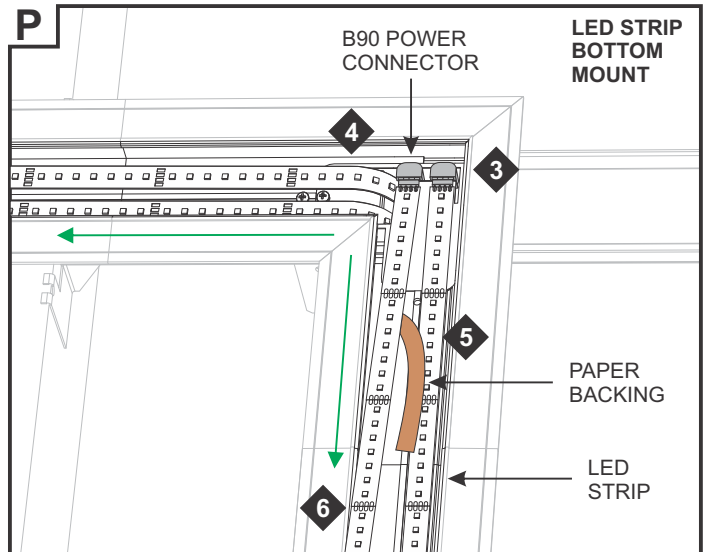

- 3:** Line up the red wire side of the power connector with the "+24VDC" marking on the LED strip. Push the male connector of the LED strip into the female connector of the power connector.
- 4:** Place the connections inside the junction box.
- 5:** Carefully remove the backing from the LED strip, making sure not to remove the tape from the strip.
- 6:** Firmly press down the adhesive portion of the LED strip onto the channel surface while removing the rest of the backing, making sure there are no air bubbles that can cause surface irregularities.
- 7:** Repeat steps 3 through 6 for each LED strip.

NOTE: Refer to Sections Four and Six in the TruLine 1.6A Channel and Lens instructions to complete the installation.

Install the LED Soft Strip on Sides of Channel

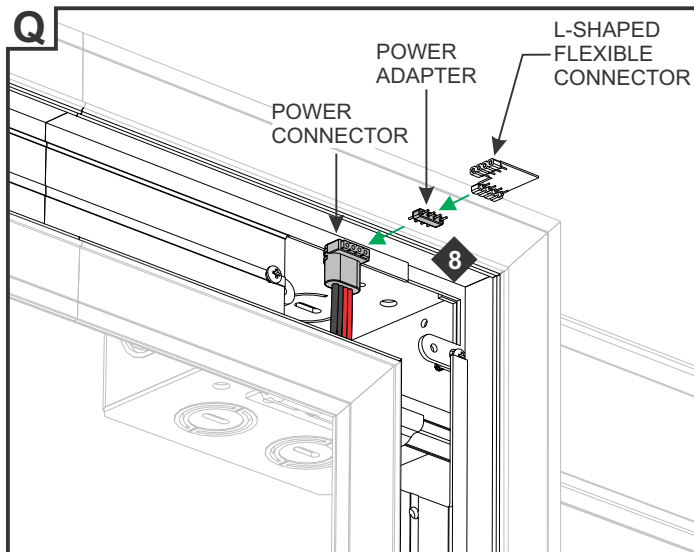

8: Insert the male-to-male power adapter to the power connector. Connect the L-Shaped Flexible Power connector to the male-to-male power adapter.

9: Repeat step 8 for additional power connectors.

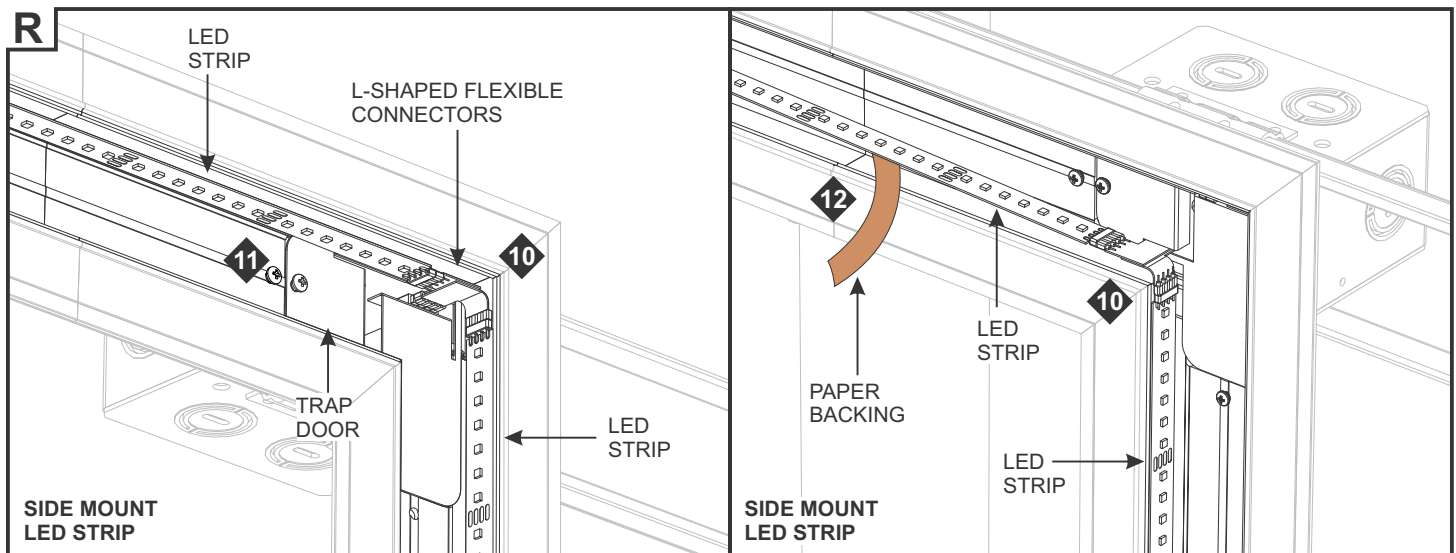

10: Place the assembled power connectors into the channel where the LED soft strips will be installed. L-Shaped Flexible Connectors should be overlapped as shown.

11: Replace the trap door and secure using the #4-40 screw.

12: Repeat steps 3 and 4 in Section Three to install the LED soft strips.

NOTE: Refer to Sections Five and Six in the TruLine 1.6A Channel and Lens instructions to complete the installation.