



BRAND

Castor Design

DESCRIPTION

The Deadstock Catherine Table Lamp was designed around a cylindrical shade salvaged from a defunct lighting factory. The base is made from Carrara marble and the support is made of machined brass. Available with a Gunmetal Black or a White powder-coated shade. Inline dimmer on cord.



Shown in: Brass / Black

SHADE COLOR	Black
BODY FINISH	Brass
WATTAGE	5W
DIMMER	Included
DIMENSIONS	19"L x 4.75"W x 16.5"H
BULB INCLUDED	
LAMP	1 x B10/Candelabra (E12)/5W/120V LED

Technical Information

LUMINOUS FLUX	310 lumens
LUMENS/WATT	62.00
LAMP COLOR	2700K

SPEC # CSD107248

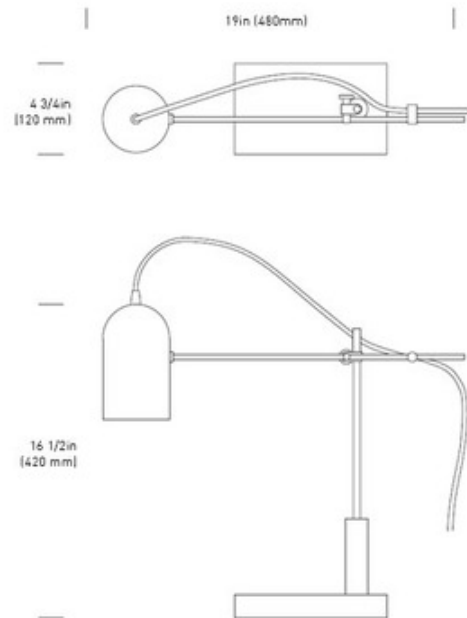

COMPANY	PROJECT	FIXTURE TYPE	APPROVED BY	DATE