

R731 MR16 Gimbal Ring Track Fixture 12V



Description:

R731 MR16 Gimbal Ring Low Voltage Track Fixture features a 90 degree vertical aiming capability and 358 degree rotation. Polycarbonate transformer housing with a painted formed steel lamp housing. Copper alloy contacts provide precise spring action. True, positive electrical ground. On/off switch included. 50 watt 12V electronic transformer with circuit protection included. Patented embossed polarity arrows on bottom of adapter. Spring-loaded locking latch with embossed polarity arrows secures fixture to the track. Pull-up contact to up position for use on two-circuit trac. Finish available in Black or White. One 50 watt, 12 volt MR16 halogen bulb or LED equivalent is required, but not included. Halogen dimmable with a low voltage electronic dimmer. Consult bulb manufacturer for dimmer compatibility when using LED equivalent. 2 inch diameter x 2 inches high. UL listed. Compatible with Juno Lighting Trac-Lites 1-circuit and Trac-Master 1-circuit and 2-circuit 120 volt line voltage track systems.

Shown in: White

List Price: \$66.60
Our Price: \$39.96

- Shade Color:** N/A
- Body Finish:** White
- Lamp:** 1 x MR16/GU5.3 (bipin)/50W/12V Halogen
1 x MR16/GU5.3 (bipin)/12V LED
- Wattage:** 50W
- Dimmer:** Low Voltage Electronic
- Dimensions:** 5.25"L x 2"H x 2"W

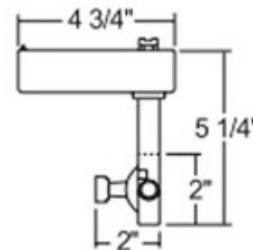

Product Number: JUN25986			
Company:		Fixture Type:	Date: Apr 20, 2018
Project:		Approved By:	

#1000BT-LVGIMBA-002H1-00WH

Fax: (773) 883-6131

Phone: 866-954-4489

Address: 1718 W. Fullerton Ave. Chicago IL 60614

www.Lightology.com