



**BRAND**

Hunza Lighting

**DESCRIPTION**

The Step Lite Solid Eyelid Outdoor Light is designed with a 3.5 inch flange and recessed body for flush mounting into canister for concrete masonry, stone or wood, providing illumination of steps and low level features such as exterior paved areas. When used with Hunza mounting canister there are no mounting holes in the flange. The eyelid feature eliminates all upward light, providing an excellent glare-free illuminating effect. Machined from thick aluminum in powder coat finish Bronze or Black, solid Copper, or 316 Stainless Steel with a clear tempered stepped glass lens. UL listed. IP67 rated for wet locations. Required mounting canister (DKcan for wood or SLcan for concrete or stone) and low voltage transformer, sold separately. Dimmer type dependent on type of transformer/power supply selected (low voltage electronic or low voltage magnetic).



*Shown in: Copper*

<b>SHADE COLOR</b>	N/A
<b>BODY FINISH</b>	Copper
<b>WATTAGE</b>	20W
<b>DIMMER</b>	Dimmable
<b>DIMENSIONS</b>	3.5"W x 3.5"H x 4"D
<b>BULB NOT INCLUDED</b>	
<b>LAMP</b>	1 x MR16/GU5.3 (bipin)/20W/12V Halogen 1 x MR16/GU5.3 (bipin)/12V LED

**SPEC #** HUZ38392

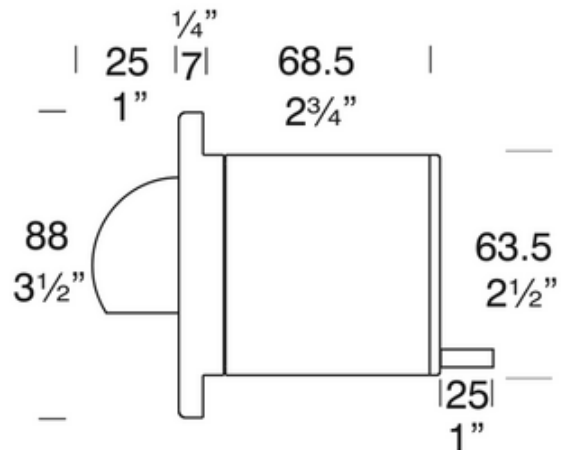

COMPANY	PROJECT	FIXTURE TYPE	APPROVED BY	DATE