

R3152 3.5 Inch Square Regressed Pinhole Trim



Description:

R3152 3.5 Inch Square Regressed Pinhole Trim is available in a powder coat painted or plated die-formed steel trim finish in White, Black, Gold Plated 24K, Chrome, Brushed Chrome, Architectural Bronze, Antique Copper, Matte White, Brushed Nickel, Satin Nickel, Metallic Grey or Antique Nickel. Anodized aluminum reflector standard. Additional reflector finishes include specular Clear or Black, or painted White, Black or Matte White. See attached manufacturer specification for housing/trim combination options. Lamp options include 12 volt GU5.3 MR16 halogen up to 50 watts, 120 volt PAR16 LED up to 8 watts, 12 volt GU5.3 MR16 LED up to 11.5 watts, 120 volt GU10 MR16 halogen up to 50 watts, and 120 volt GU10 MR16 LED up to 9.8 watts. Use supplied glass lens only with MR16 lamps with no glass cover. See housing specification for dimmer information. UL listed. Suitable for damp locations. 1 year warranty. 4.25 inch square x 2 inch height. 1.7 inch diameter aperture. A complete fixture includes a housing and trim, sold separately.

Shown in: Brushed Nickel/ Anodized Reflector

List Price: \$80.25
Our Price: \$49.11

Shade Color: N/A
Body Finish: Brushed Nickel/ Anodized Reflector
Lamp: 1 x MR16/GU5.3 (bipin)/50W/12V Halogen
 1 x MR16/GU5.3 (bipin)/12V LED
 1 x MR16/GU10/120V Halogen
 1 x MR16/GU10/120V LED
 1 x PAR16/Medium (E26)/120V LED

Wattage: 50W
Dimmer: Dimmable
Dimensions: 2"H x 4.25"W x 4.25"D

Technical Information
Function: Downlight
Ceiling Type: Drywall with Trim
Aperture Shape: Pinhole
Aperture Size: 1.700"

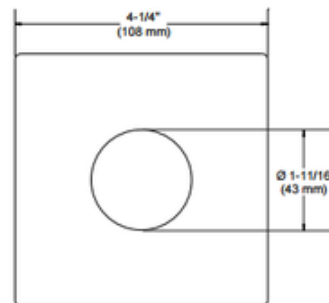
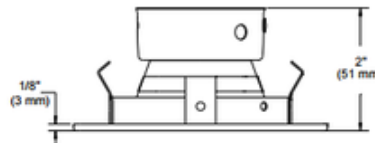

Product Number: CLT51559			
Company:		Fixture Type:	Date: Apr 20, 2018
Project:		Approved By:	