

ASSEMBLY & INSTALLATION INSTRUCTIONS

A988

Snaps Pendant Medium 401315



HUBBARDTON FORGE.

Component Parts

A	Canopy	S	Toggle Anchor (6)
B	Barrel Knobs (2)	T	2" Stud (6)
C	Cover Plate	U	Hook (6)
D	Ground Screw	V	Wood Stud (6)
E	Cupped Washer	W	Adapter (6)
F	Standoffs (2)	X	Knurled Nut (6)
G	Long Leather Strap (2)		
H	LED Stud (6)		
I	Knob (12)		
J	Alabaster (12)		
K	LED Board (12)		
L	Housing (6)		
M	Short Leather Strap (2)		
N	Knurled Screw (2)		
O	Cover (2)		
P	Nut (4)		
Q	Female Snap (8)		
R	Male Snap (8)		



Snaps Pendant Medium 401315

CAUTION: FAILURE TO INSTALL THIS FIXTURE PROPERLY MAY RESULT IN SERIOUS PERSONAL INJURY OR DEATH AND PROPERTY DAMAGE. We recommend installation by a licensed electrician. This product must be installed in accordance with applicable installation code(Q), by a person familiar with the construction and operation of the product and the hazards involved.*

Caution: Do not exceed maximum wattage noted on fixture. Use only recommended bulbs with fixture.

Please Note: After installation extra hardware and accessories are possible; our kits are used on multiple products.

To Install Fixture (Figure 1)

CAUTION: BE SURE POWER IS OFF AT THE MAIN BREAKER BOX PRIOR TO INSTALLATION.

1. Carefully unpack all components from the carton.
2. Locate canopy (A) and unscrew barrel knobs (B) to remove from cover plate (C). Retain for later step.
3. Thread wires in electrical box through hole in canopy (A) while moving canopy (A) into position. Using two machine screws (not provided) fasten canopy (A) to the electric box.

Note: A new electric box comes with screws. When replacing a fixture, retain the existing screws for use with the new fixture.

4. Attach a pigtail lead to the canopy (A) using the ground screw (D) and cupped washer (E) found in kit bag.
5. Please review labels on cover plate (C) to ensure you are installing cover plate (C) in the correct orientation. Failure to do so will cause the LEDs not to light.
6. Hold cover plate (C) close to canopy (A). Using suitable wire connectors (not provided), connect driver wires to supply wires (white to white and black to black). Connect all ground wires (bare copper or green to bare copper or green) together.

CAUTION: MAKE SURE WIRE CONNECTORS ARE TWISTED ON SECURELY, AND NO BARE WIRE IS EXPOSED.

7. Raise cover plate (C) to canopy (A). Align holes in cover plate (C) with standoffs (F) and secure with barrel knobs (B).
8. Follow steps on next page to continue installation.

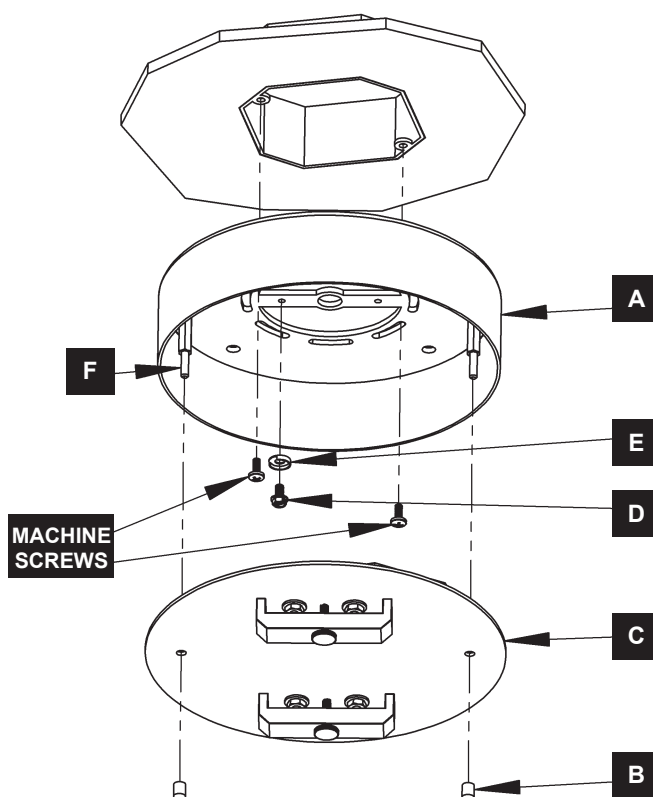

(Figure 1)



To Install Leather To Canopy (Figure 2)

1. Remove knurled screw (N) from canopy (A), then remove cover (O) and two nuts (P) from fixture studs. Retain these parts for later use.
2. Align holes in long leather strap (G) with fixture studs and secure with nuts (P).

Caution: *Be sure to tighten as this creates an electrical connect.*

3. Reattach cover (O) by threading knurled screw (N) into canopy (A). Knurled screw (N) should align with center hole of leather strap (G).
4. Repeat steps 1-3 for other leather strap (G).
5. Follow steps on next page to complete installation.

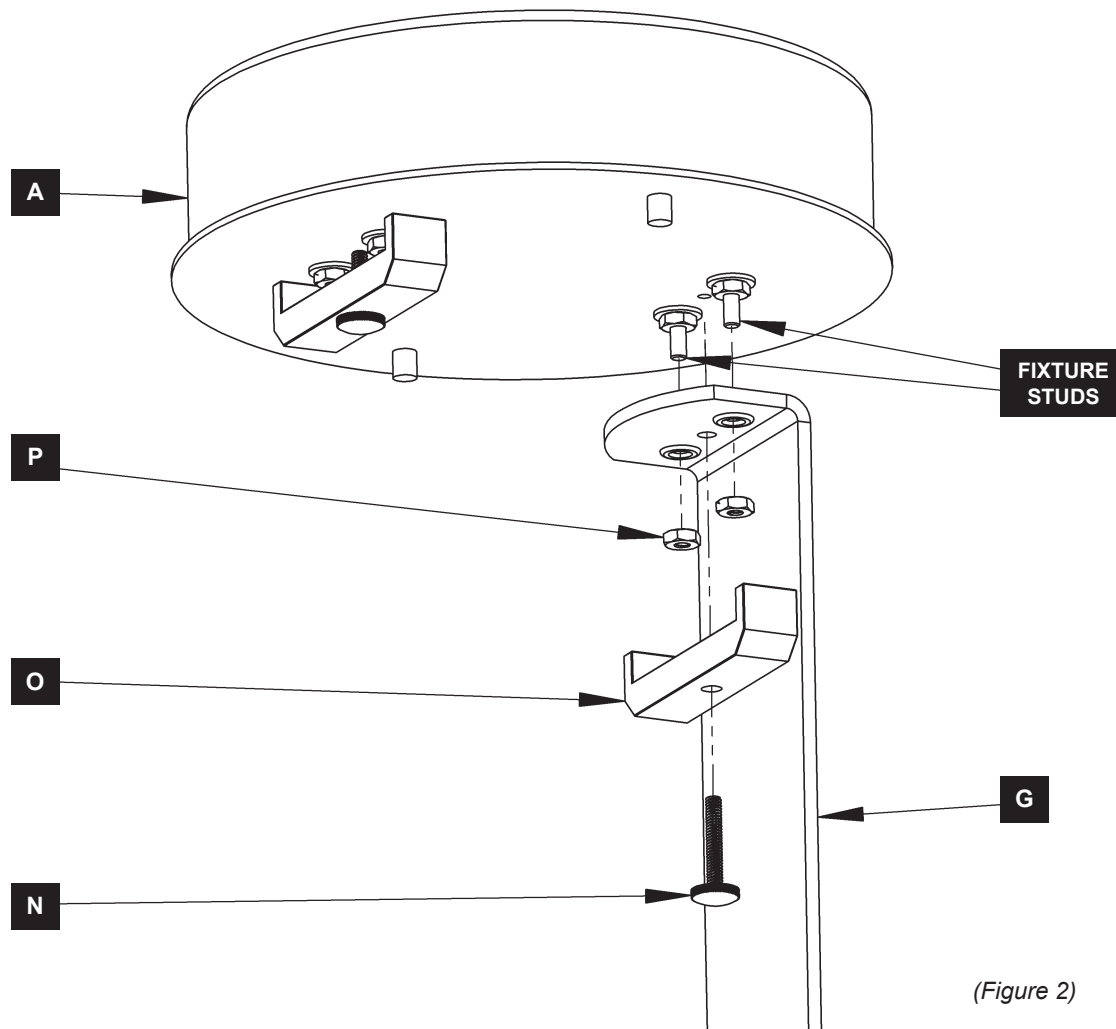

(Figure 2)

To Connect Leather Straps *(Figure 3)*

1. Align female snaps (Q) on short leather strap (M) with male snaps (R) on long strap (G).
2. Press firmly to lock all snaps (Q & R) together.
3. Follow steps on next page to install LED Boards & Alabaster.

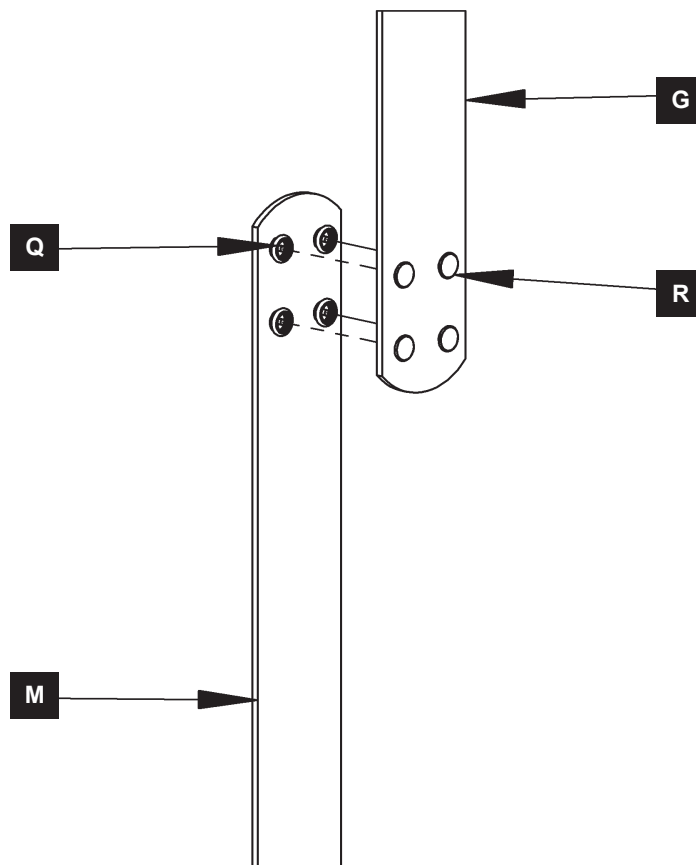

(Figure 3)

Snaps Pendant Medium 401315

To Assemble Alabaster (Figure 4)

1. Locate LED stud (H) with knobs (I) attached. Remove one knob (I) and retain for later step.
2. Carefully unpack alabaster (J), housing (L), and LED boards (K).
3. Slide housing (L) over leather strap (G) and center over male snaps (R).

Note: it may be necessary to disconnect leather straps temporarily to install housings.

4. Locate (+) side of leather strap. Align (+) side of LED board (K) with leather strap and pop led board onto snaps. Be sure both snaps on board engage fully.
5. Repeat steps for LED board (K) on opposite side, being sure (+) side is aligned with (+) side of leather strap (G).
6. Slide stud (H) through alabaster (J), hole in leather strap (G), and second piece of alabaster (J).

Note: Be careful not to harm LED boards (K) when assembling.

7. Thread knob (I) onto stud (H) and tighten to secure alabaster (J) around housing (L).

Note: Be careful not to overtighten as this could break alabaster.

8. Restore electricity at main breaker.

NOTE: If any LED Boards do not light, remove alabaster and check orientation of (+) and (-) sides of board. LED board might need to be rotated on leather strap.

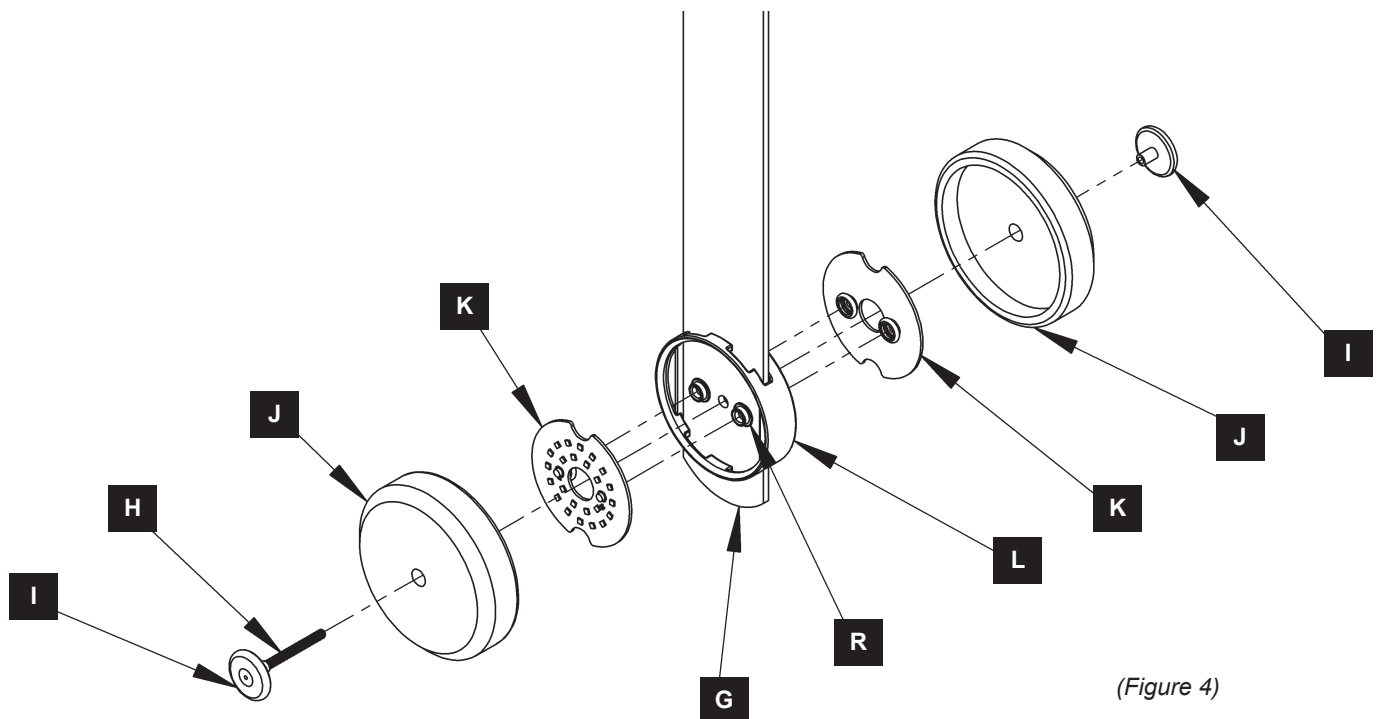

Optional Mounting - Leather Hook

To Mount in Drywall - (Figure 5)

1. Locate toggle anchor (S), 2" stud (T), hook (U), all found in kit bag.
2. Drill 1/2" hole in ceiling/wall in desired location.
3. Thread toggle (S) onto 2" stud (T). Direction critical as toggle (S) will fold onto stud (T) when pushing into drywall.
4. Push toggle (S) through hole until it's able to open. Pull stud (T) back down until you feel toggle (S) engage with backside of drywall.
5. Carefully thread hook (U) onto stud (T). Adjust length of stud in toggle so that stud doesn't stick through hook as that can scratch the leather.
6. Raise leather strap, gently fold and install into hook (U).

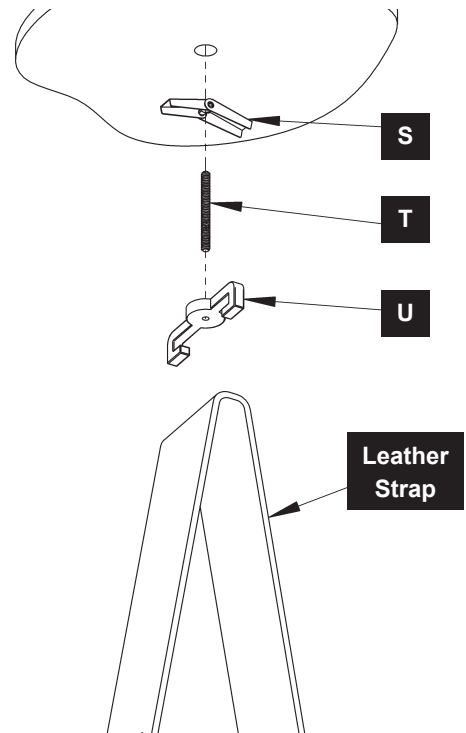

(Figure 5)

To Mount in Wood - (Figure 5B)

1. Locate hook (U) and wood stud (V), found in kit bag.
2. Jam two nuts (provided in kit bag) together onto wood stud (V). Thread into wood until only 5/16" of stud is left showing. Remove nuts.

Note: Nuts are to help install the stud without marking up threads.

3. Carefully thread hook (U) onto wood stud (V) until tight.
4. Raise leather strap, gently fold and install into hook (U).

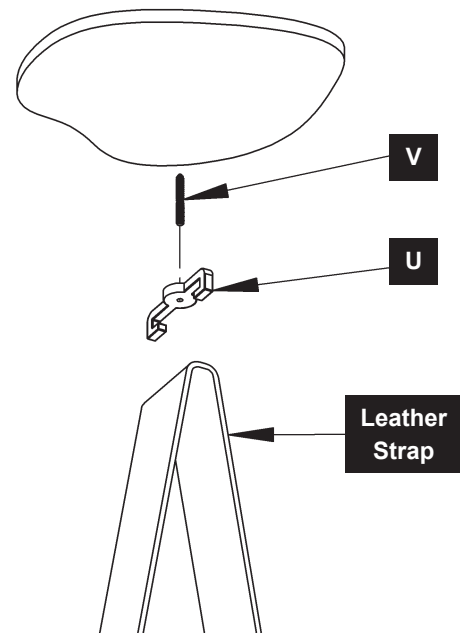

(Figure 5B)

Optional Mounting - Alabaster Adapter

To Mount in Drywall - (Figure 6)

1. Locate toggle anchor (S), 2" stud (T), adapter (W), all found in kit bag.
2. Drill 1/2" hole in ceiling/wall in desired location.
3. Thread toggle (S) onto 2" stud (T). Direction critical as toggle (S) will fold onto stud (T) when pushing into drywall.
4. Push toggle (S) through hole until it's able to open. Pull stud (T) back down until you feel toggle (S) engage with backside of drywall.
5. Thread knurled nut (X) onto stud (T) and tighten to drywall. Adjust stud (T) until there is 3/8" of stud sticking through knurled nut (X).
6. Carefully thread adapter (W) onto stud (T) and up to knurled nut (X) until tight.
7. Remove one knob (I) from LED stud (H)
8. Slide LED stud (H) through alabaster (J), hole in leather strap (G), and second piece of alabaster (J).

Note: Be careful not to harm LED boards when assembling.

9. Press alabaster up to adapter and thread LED stud into adapter until all parts are tight.

Note: Be careful not to overtighten as this could break alabaster.

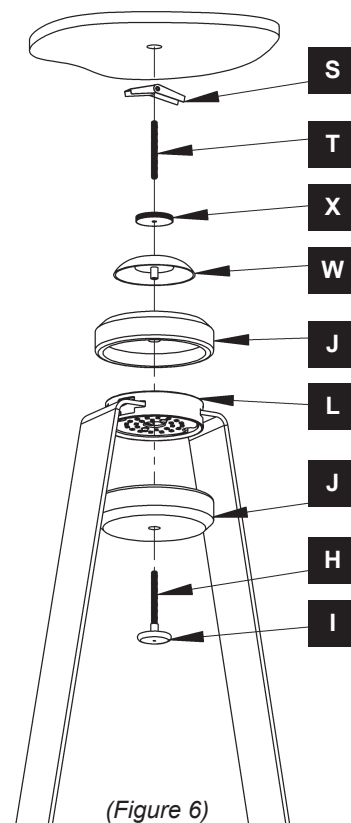

To Mount in Wood - (Figure 6B)

1. Locate adapter (W) and wood stud (V), found in kit bag.
2. Jam two nuts (provided in kit bag) together onto wood stud (V). Thread into wood until only 3/8" of stud is left showing. Remove nuts.

Note: Nuts are to help install the stud without marking up threads.

3. Carefully adapter (W) onto wood stud (V) until tight.
4. Remove one knob (I) from LED stud (H)
5. Slide LED stud (H) through alabaster (J), hole in leather strap, and second piece of alabaster (J).

Note: Be careful not to harm LED boards when assembling.

6. Press alabaster up to adapter and thread LED stud into adapter until all parts are tight.

Note: Be careful not to overtighten as this could break alabaster.

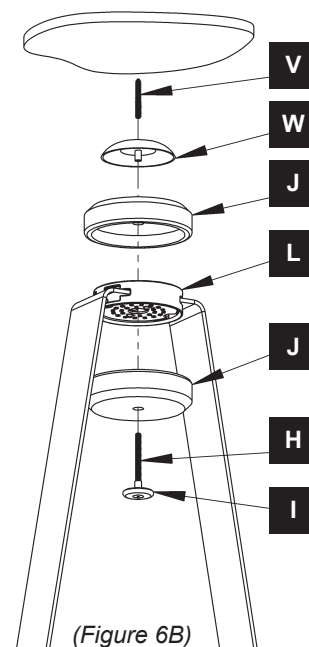

Snaps Pendant Medium 401315

IMPORTANT NOTES:

- Additional leather straps and LED alabaster modules can be ordered individually. Contact the dealer from which you purchased this product for more information.
- Due to electrical components included with this fixture, a max of (5) additional LED alabaster modules can be added.
- If more than the allowed LED modules are desired, please contact dealer about a custom fixture.
- Leather extension straps without LEDs can also be purchased.

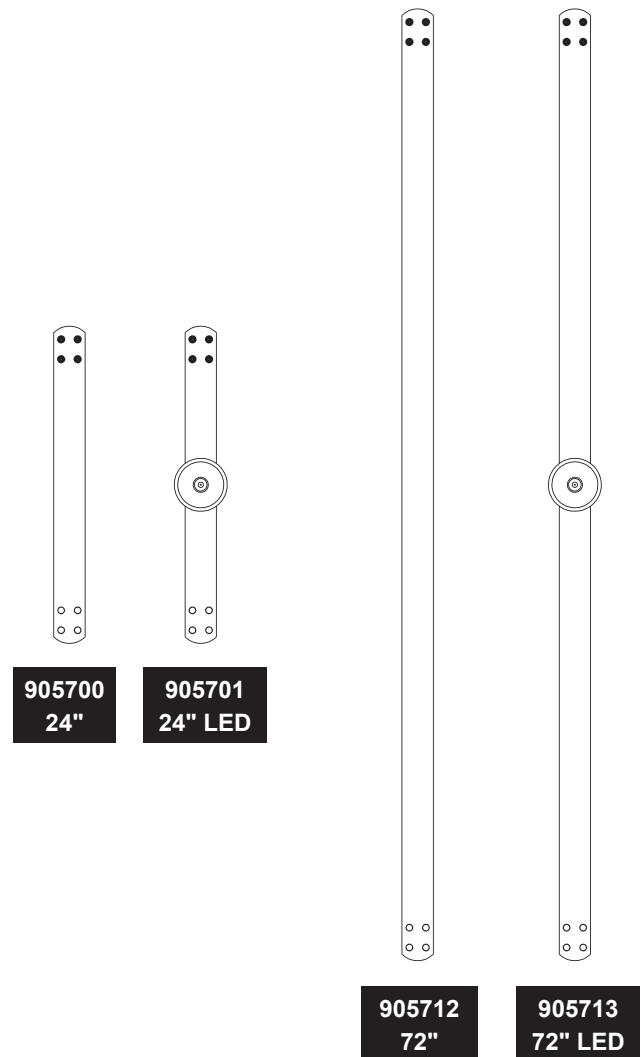

Product Care & Cleaning:

Leather: Leather is a natural product and straps can have variations in color and imperfections in the hides. This leather can be oiled or dyed to enhance the look. For cleaning, wipe entire surface with a soft cloth and cool water to even out any abrasions or stains. Do not spot rub, for it will darken only that area. Occasional use of Aniline Leather Cleaner, Conditioner, & Protector, or Aniline Leather Maintenance Kit is recommended. Other leather cleaners such as saddle soap or household cleaners that may contain harsh chemicals, alcohol, or ink removers should never be used.

Alabaster: Use a dry soft cloth or a “feather duster” to remove any dust accumulation. Raw alabaster should not be polished with wax, or cleaned with wet or acidic cleaners.

If you need further assistance, or find that you are missing any parts, please contact the dealer from which you purchased this product. We hope you enjoy your fixture!

** Hubbardton Forge will not be liable for injury or damage caused by improper installation, lamping or use of this fixture.*