

ASSEMBLY & INSTALLATION INSTRUCTIONS

B541

Veneto Sconce 402030

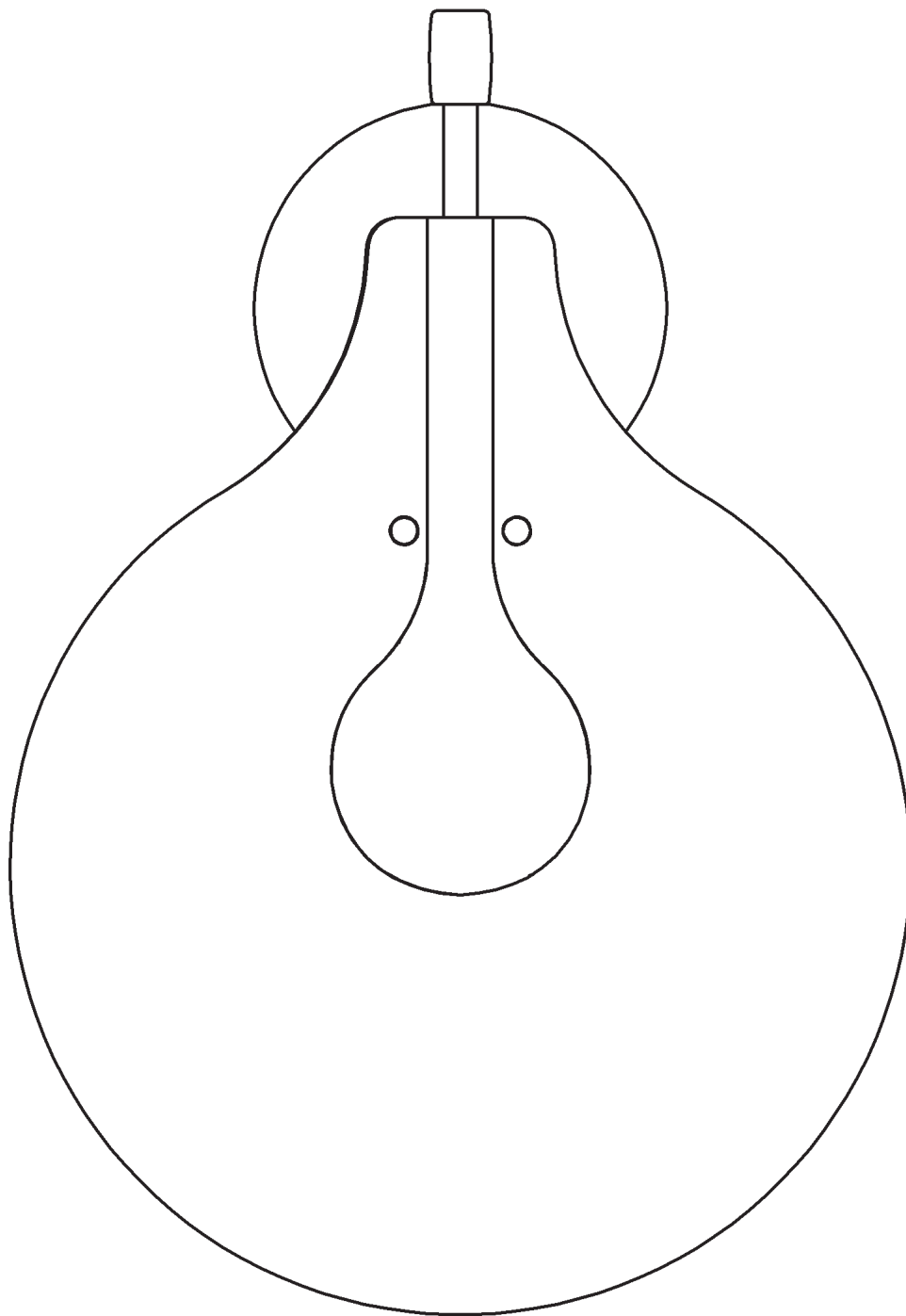

HUBBARDTON FORGE.

MODERN AMERICAN BLACKSMITHS | FINE, HAND CRAFTED LIGHTING
CASTLETON, VERMONT USA | HUBBARDTONFORGE.COM

55911

1 OF 4

Component Parts

- A Fixture
- B Cap
- C Nipple
- D Crossbar
- E Nut
- F Ground Screw
- G Bulb (Not included)
- H Socket
- I Stud (2)
- J Glass (2)
- K Knurled Ball (4)

ASSEMBLY & INSTALLATION INSTRUCTIONS

B541

Veneto Sconce 402030

CAUTION: FAILURE TO INSTALL THIS FIXTURE PROPERLY MAY RESULT IN SERIOUS PERSONAL INJURY OR DEATH AND PROPERTY DAMAGE. We recommend installation by a licensed electrician. This product must be installed in accordance with applicable installation code(s), by a person familiar with the construction and operation of the product and the hazards involved.*

Please Note: This fixture is designed to be mounted on a standard wall surface and may not be suitable for all applications. If installing in a non-wood frame application, we recommend consulting a qualified builder or electrician.

Please Note: After installation extra hardware and accessories are possible due to our kits are used on multiple products and options.

To Mount Fixture to Wall and Install Glass (Figure 1, next page)

CAUTION: BE SURE POWER IS OFF AT THE MAIN BREAKER BOX PRIOR TO INSTALLATION.

1. Carefully unpack fixture (A) from the carton.
2. Cap (B) is shipped installed on nipple (C). Remove cap (B) from nipple (C) and retain for later use.
3. Screw nipple (C) into crossbar (D).
4. Thread nut (E) onto nipple (C). Do not tighten.
5. Using two machine screws (not provided), fasten the crossbar (D) to the electric box making sure that fixture mounting holes are level.

Note: A new electric box comes with screws. When replacing a fixture, retain the existing screws for use with the new fixture.

6. Adjust the length of nipple (C) in crossbar (D) so that cap (B) will hold fixture (A) tightly against the wall. When the correct adjustment is established, tighten nut (E) against crossbar (D) to hold adjustment.
7. Hold fixture (A) close to the wall and using suitable wire connectors, not provided, connect fixture wires to supply (white to white and black to black). Run a pigtail lead from the crossbar ground screw (F) to the junction box. Connect all ground wires (bare copper or green to bare copper or green) together..

CAUTION: MAKE SURE WIRE CONNECTORS ARE TWISTED ON SECURELY, AND NO BARE WIRE IS EXPOSED.

8. Slide fixture (A) over crossbar (D) and push firmly to wall, making sure that no wires are pinched between fixture back and wall and secure with cap (B). Be sure nipple (C) is fully seated in cap (B).
9. Install bulb (G), (not included) into socket (H).
10. Thread studs (I) into fixture (A) until about halfway through.

Note: The thickness of the glass can vary. 2 different lengths of glass studs (I) are provided. Clear cushioning washers are also provided to help with securing glass (J). Clear washers should be placed between glass and knurled balls.

11. Slide glass (J) onto studs and secure with Knurled balls (K).
12. Restore electricity at the main breaker.

ASSEMBLY & INSTALLATION INSTRUCTIONS

Veneto Sconce 402030

B541

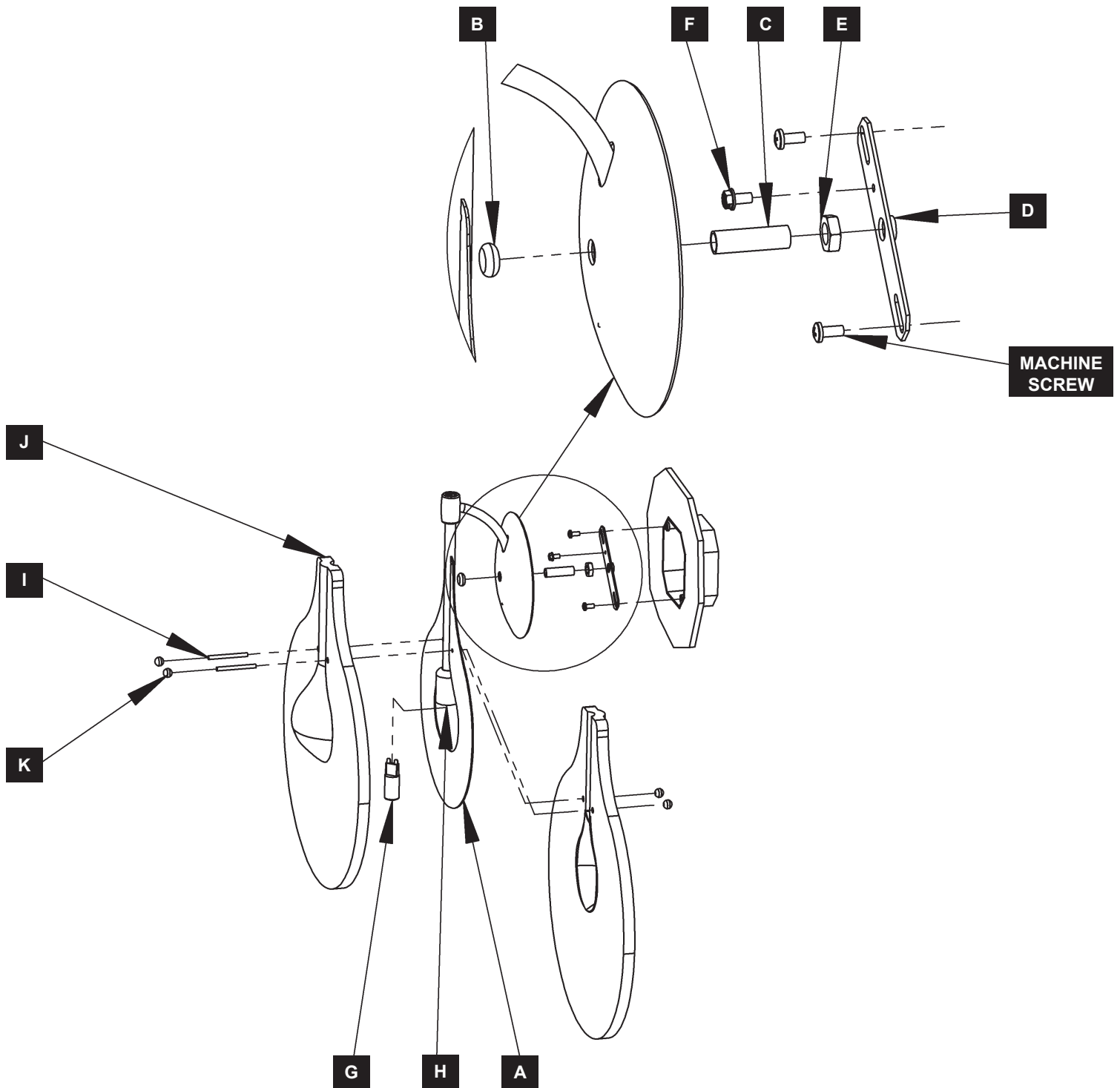

(Figure 1)

If you need further assistance, or find that you are missing any parts, please contact the dealer from which you purchased this product. We hope you enjoy your fixture!

** Hubbardton Forge will not be liable for injury or damage caused by improper installation, lamping or use of this fixture.*



HUBBARDTON FORGE.

MODERN AMERICAN BLACKSMITHS | FINE, HAND CRAFTED LIGHTING
CASTLETON, VERMONT USA | HUBBARDTONFORGE.COM

55911

4 OF 4