

# ASSEMBLY & INSTALLATION INSTRUCTIONS

C123

241104 Quill Torchiere

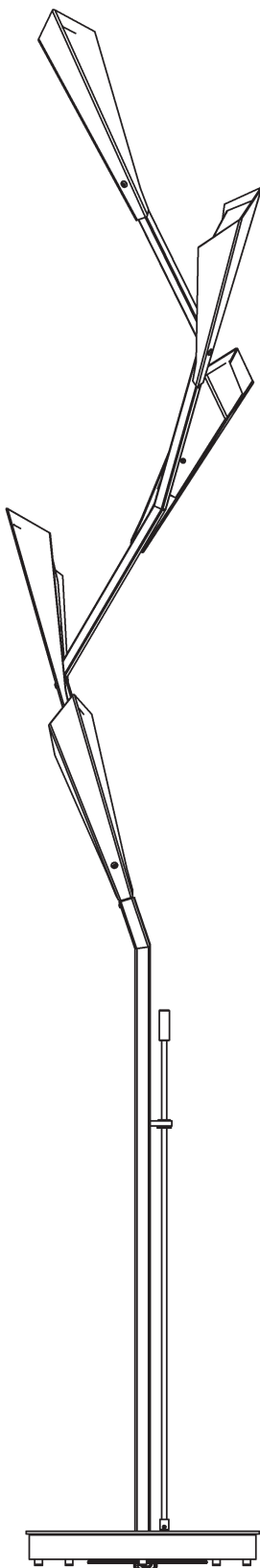

HUBBARDTON FORGE.

MODERN AMERICAN BLACKSMITHS | FINE, HAND CRAFTED LIGHTING  
CASTLETON, VERMONT USA | HUBBARDTONFORGE.COM

55904

1 OF 3

Component Parts

- A      Fixture
- B      Quill
- C      Set Screw
- D      Cable
- E      Screw (4)
- F      Bottom Plate

## 241104 Quill Torchiere

**CAUTION: FAILURE TO INSTALL THIS FIXTURE PROPERLY MAY RESULT IN SERIOUS PERSONAL INJURY OR DEATH AND PROPERTY DAMAGE.** We recommend installation by a licensed electrician. This product must be installed in accordance with applicable installation code(s), by a person familiar with the construction and operation of the product and the hazards involved.\*

**Caution:** Do not exceed maximum wattage noted on fixture. Use only recommended bulbs with fixture.

### Assemble Fixture (Figures 1 & 2)

1. Carefully unpack fixture (A) from carton.
2. Install quill (B) into fixture (A). Secure by tightening set screw (C).
3. If cable (D) is hindering assembly, unscrew screws (E) from fixture (A) to remove bottom plate (F). This will allow for cable (D) to be pulled through fixture (A) from the bottom. Reinstall bottom plate (F) and screws (E) afterwards.
4. Plug in power cord.

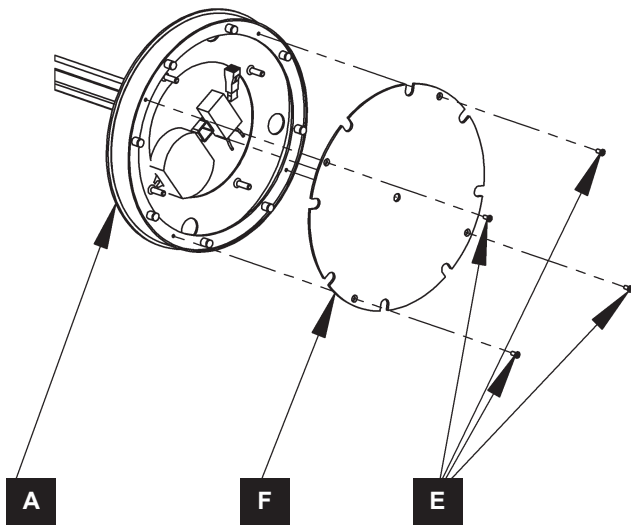

(Figure 2)

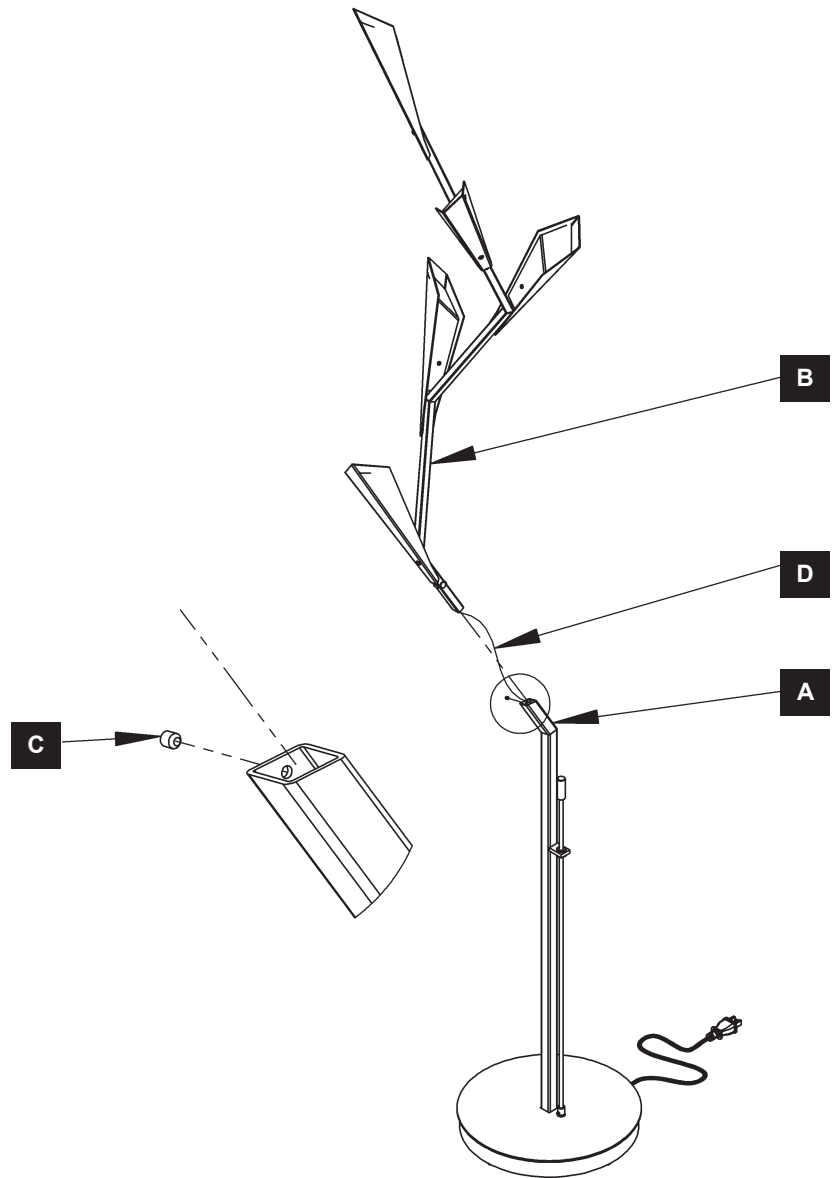

(Figure 1)

If you need further assistance, or find that you are missing any parts, please contact the dealer from which you purchased this product.  
We hope you enjoy your fixture!

**\* Hubbardton Forge will not be liable for injury or damage caused by improper installation, lamping or use of this fixture.**