

## ASSEMBLY INSTRUCTIONS

### ITEM DESCRIPTION:

ITEM NO.:DWC50 NAME: GARLAND SCNCE

MATERIAL TYPE: METAL FINISH: ANTIQUE BRASS

SOCKET TYPE: : LED SOCKET QTY: 1

BULB WATTAGE: 7W

VOLTAGE: 100V-120V ITEM NET WEIGHT: 4LBS

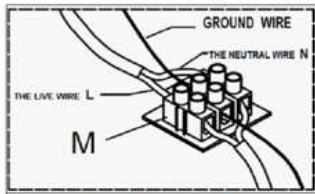
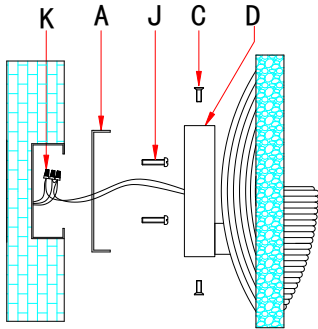

**PLEASE IGNORE THIS DEVICE  
ON THE BACK PLATE.**

### PARTS INCLUDED:

Mounting Plate(A)	Qty: 1PC
Canopy Screw(C)	Qty:2PCS
Back Plate(D)	Qty: 1PC
Mounting Screw(J)	Qty:2PCS
Plastic Wire Connector(K)	Qty:3PCS

### HARDWARE INCLUDED:

Mounting Screws	Qty: 2PCS
Canopy Screws	Qty: 2PCS
Green Ground Screw	Qty: 1PC
Plastic Wire Connector	Qty: 3PCS

### TOOLS NEEDED (Not Included):

1 Screwdriver

These instructions are provided for safety. It is very important that they are read carefully and completely before beginning installation.

We strongly suggest that all hard-wired fixtures must be installed by a professional electrician.

For customer service questions call 1-800-338-2150



### TO ASSEMBLE:

1. Shut off the main electrical supply from the main fuse box/circuit breaker.
2. Carefully unpack all fixture parts and hardware and lay them on a soft surface for assembly.
3. Gently pull wiring down from junction box and allow to hang.
4. Remove the mounting plate(A) from the back plate(D) by loosening the canopy screw (C) using a Phillips screwdriver.
5. Place the mounting plate(A) over the center of the junction box.
6. Align the holes in the mounting plate (A) with the holes in the junction box and secure it with two mounting screws (J). Secure the screws using a Phillips head screwdriver.
7. Connect ground wire from wall to ground wire from lamp using wire caps (K).
8. Attach house wire to lamp wires as shown. Fasten the pairs together with a wire caps  
DO NOT REVERSE THE HOT AND NEUTRAL CONNECTIONS OR SAFETY WILL BE COMPROMISED.
9. PLEASE PAY SPECIAL ATTENTION TO THE FACT THAT YOU DO NOT NEED TO CONNECT THE WIRE TO THE DEVICE (M). IT IS USED FOR WIRE CONNECTIONS IN THE EUROPEAN MARKET.
10. Finally, please note that this product is suitable for 0-10V dimmer switches. Connect the purple wire (+) and the gray wire (-) to the dimmer switch as shown in Figure 1. Ensure that no strands are exposed.  
BE SURE NO STRANDS ARE EXPOSED.
11. Gently tuck the wire connections(K) neatly into the junction box.
12. Attach the back plate (D) to the mounting plate (A) using 2 set screws (C), and tighten them with a screwdriver.
13. Restore power to junction box and test fixture.

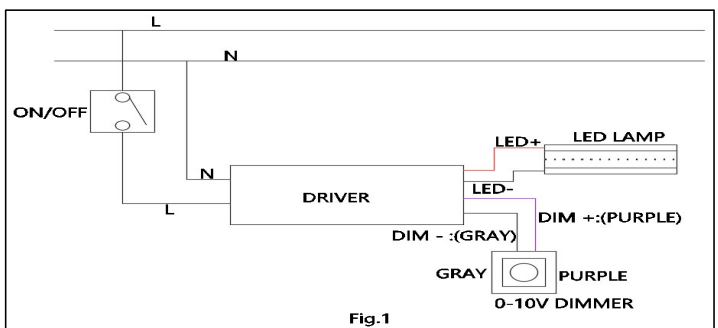
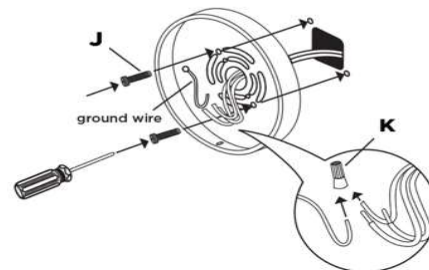

### CARE INSTRUCTIONS:

Wipe with a soft, dry cloth. To protect finish, avoid the use of chemicals and household cleaners.

ARTERIO RS