

ASSEMBLY & INSTALLATION INSTRUCTIONS

B580

Muse Sconce 201064

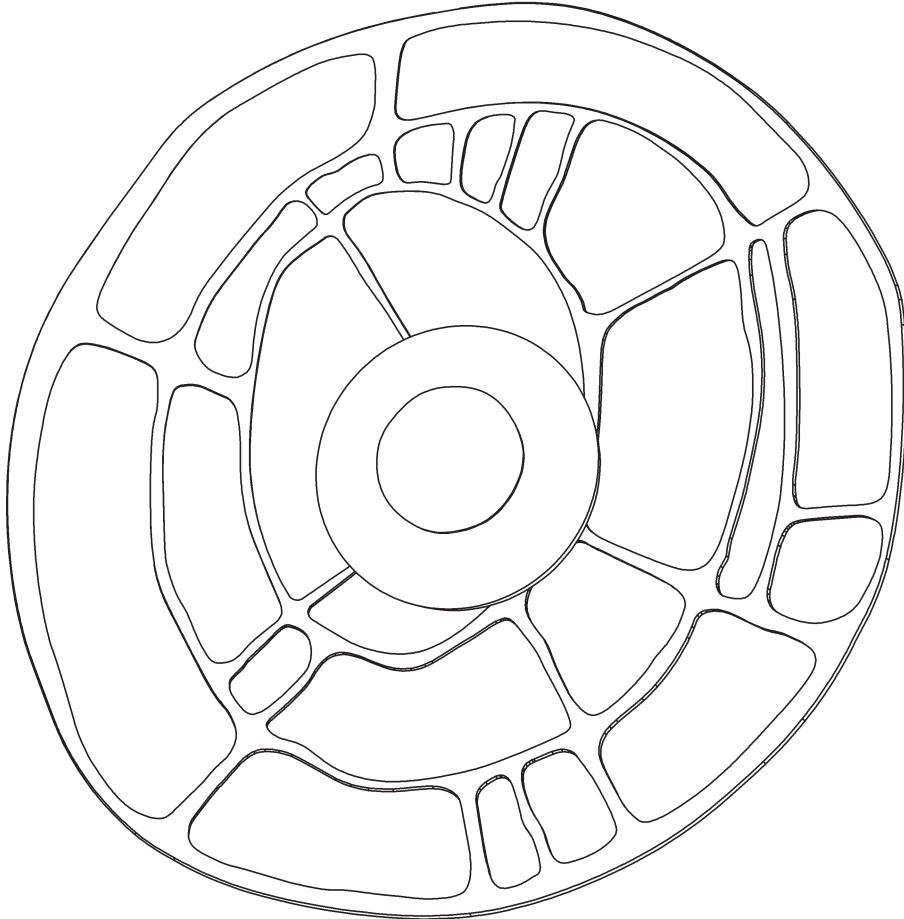

Component Parts

- A Fixture**
- B Mounting Bracket**
- C Ground Screw**
- D Cupped Washer**
- E #8 Screws (4)**
- F Nipple**
- G Glass**
- H Rubber Washer**
- I Steel Washer**
- J Decorative Cover**



ASSEMBLY & INSTALLATION INSTRUCTIONS

B580

Muse Sconce 201064

CAUTION: FAILURE TO INSTALL THIS FIXTURE PROPERLY MAY RESULT IN SERIOUS PERSONAL INJURY OR DEATH AND PROPERTY DAMAGE. We recommend installation by a licensed electrician. This product must be installed in accordance with applicable installation code(s), by a person familiar with the construction and operation of the product and the hazards involved.*

Caution: Do not exceed maximum wattage noted on fixture. Use only recommended bulbs with fixture.

Please Note: After installation extra hardware and accessories are possible; our kits are used on multiple products.

To Install Fixture *(Figure 1 - on following page)*

CAUTION: BE SURE POWER IS OFF AT THE MAIN BREAKER BOX PRIOR TO INSTALLATION.

1. Carefully unpack the fixture (A) from the carton.
2. Remove screws (E) and mounting bracket (B) from fixture (A). Retain for later step. Take note of mounting bracket (B) orientation to fixture.
3. Thread wires in electrical box through hole in mounting bracket (B) while moving bracket into desired position. Place mounting bracket over electrical box and secure with two machine screws (not provided).

NOTE: A NEW ELECTRIC BOX COMES WITH SCREWS. WHEN REPLACING A FIXTURE, RETAIN EXISTING SCREWS FOR USE.

4. Attach a pigtail lead to mounting bracket (B) using ground screw (C) and cupped washer (D) found in kit bag.
5. Hold fixture (A) close to wall. Using suitable wire connectors (not provided), connect fixture wires to supply wires (white to white and black to black). Connect all ground wires (bare copper or green to bare copper or green) together.

CAUTION: MAKE SURE WIRE CONNECTORS ARE TWISTED ON SECURELY, AND NO BARE WIRE IS EXPOSED.

6. Place fixture (A) over mounting bracket (B). Secure with (4) #8 screws (E).

NOTE: BE SURE NO WIRES ARE PINCHED BETWEEN FIXTURE AND WALL.

7. Follow steps on last page to complete installation.

ASSEMBLY & INSTALLATION INSTRUCTIONS

B580

Muse Sconce 201064

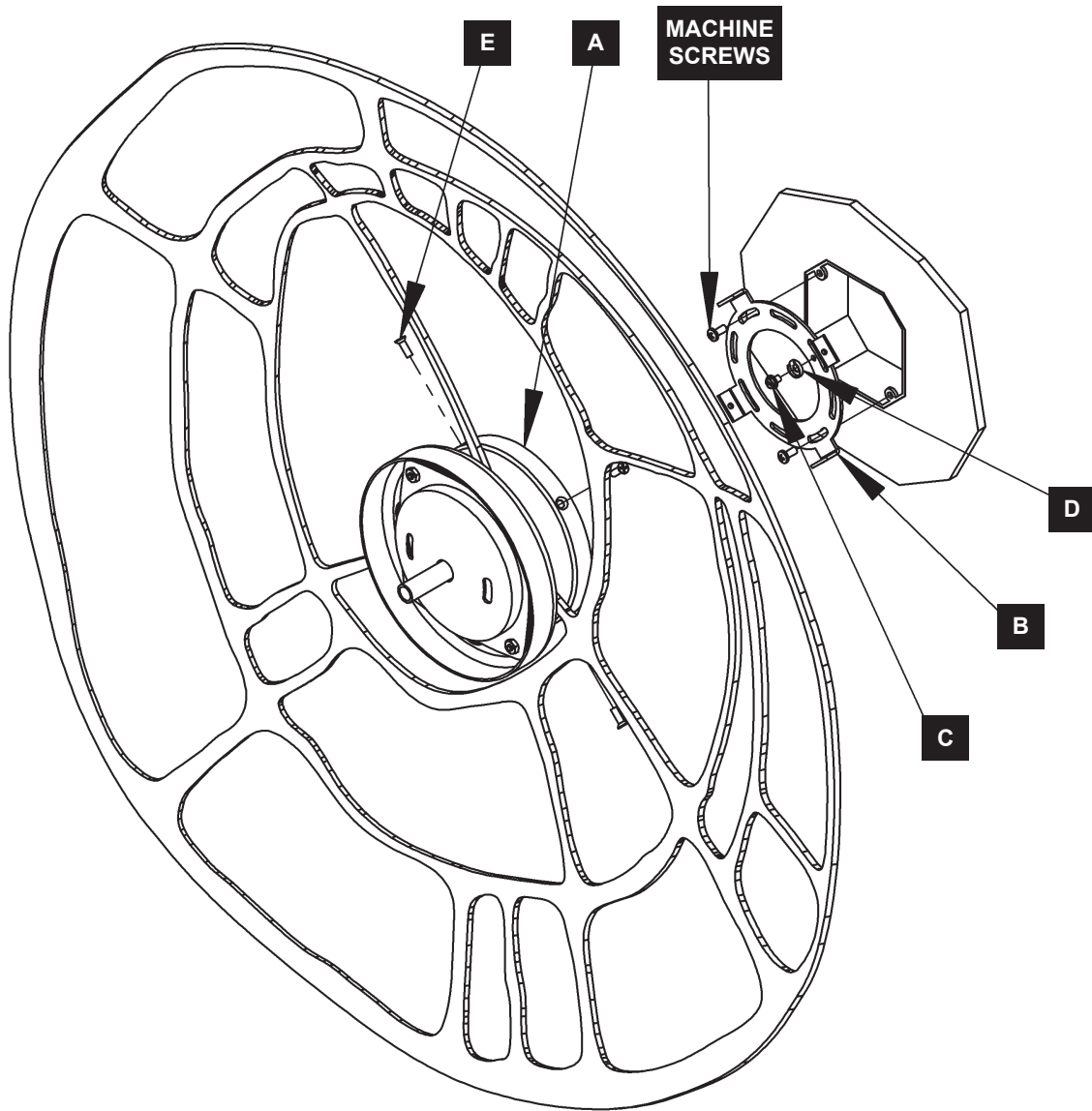

(Figure 1)

Muse Sconce 201064

To Install Glass (Figure 2)

1. Carefully unpack glass (G).
2. Decorative cover (J) and washers (H & I) are shipped on nipple (F). Remove cover (J) and washers (H & I) and retain for later step.
3. Place glass (G) over nipple (F) with textured side facing wall.
4. Slide rubber washer (H) over nipple (F), followed by steel washer (I) and press up against glass (G).
5. Thread decorative cover (J) onto nipple (F) to secure glass. Longer nipple is supplied in kit bag if needed due to glass thickness.

Caution: Be careful not to overtighten decorative cover as this could break glass.

6. Restore electricity at main breaker.

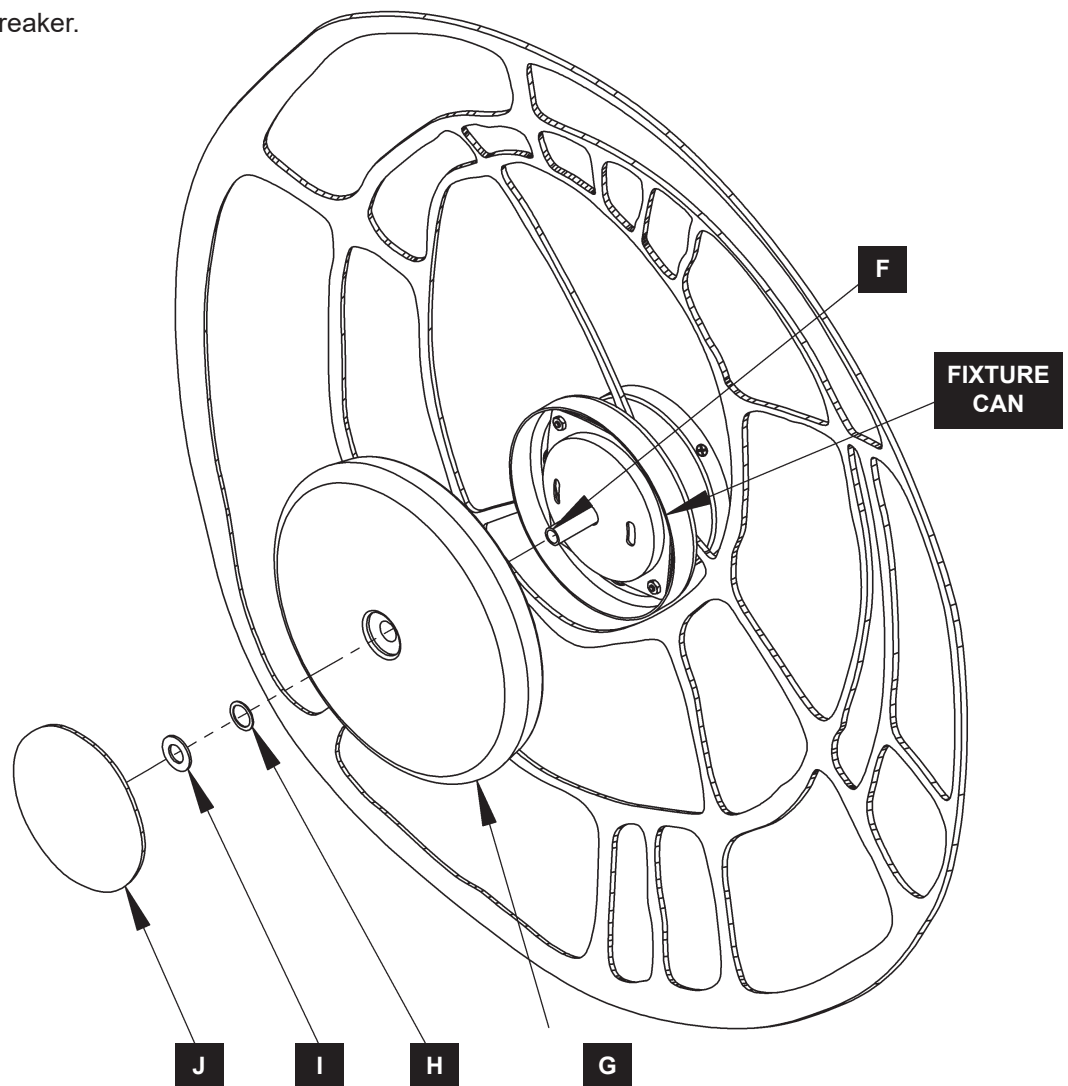

(Figure 2)

If you need further assistance, or find that you are missing any parts, please contact the dealer from which you purchased this product.
We hope you enjoy your fixture!

*** Hubbardton Forge will not be liable for injury or damage caused by improper installation, lamping or use of this fixture.**