

# ASSEMBLY & INSTALLATION INSTRUCTIONS

Riverbed Circular Pendant 139982

A1038

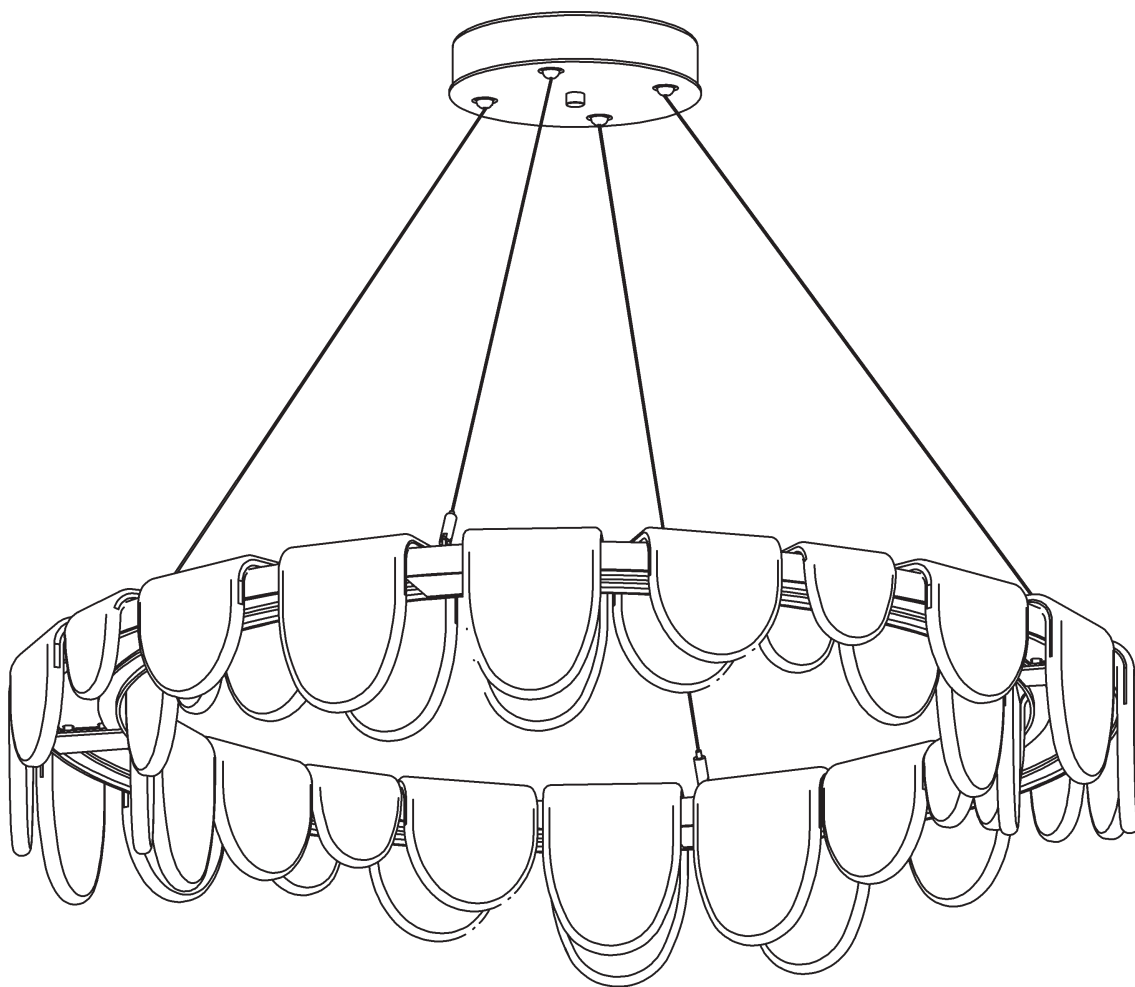

HUBBARDTON FORGE.

Component Parts

- A Canopy
- B Cap
- C Cover Plate
- D #8 Screws (2)
- E Gripper Plate
- F Lag Screws (4)
- G Fixture
- H Ground Screw
- I Cupped Washer
- J Gripper
- K Supply/Support Cables (4)
- L Glass Large (8)
- M Glass Medium (8)
- N Glass Small (4)

**CAUTION: FAILURE TO INSTALL THIS FIXTURE PROPERLY MAY RESULT IN SERIOUS PERSONAL INJURY OR DEATH AND PROPERTY DAMAGE.** We recommend installation by a licensed electrician. This product must be installed in accordance with applicable installation code(s), by a person familiar with the construction and operation of the product and the hazards involved.\*

**Caution:** Do not exceed maximum wattage noted on fixture. Use only recommended bulbs with fixture.

Please Note: After installation extra hardware and accessories are possible; our kits are used on multiple products.

## To Install Fixture (Figures 1 & 2 - on following page)

**CAUTION: BE SURE POWER IS OFF AT THE MAIN BREAKER BOX PRIOR TO INSTALLATION.**

1. Carefully unpack fixture (G) from the carton.
2. Locate canopy assembly. Uncoil supply/support cables (K).
3. Unscrew cap (B) from nipple and remove cover plate (C) from canopy (A).
4. Unscrew two #8 screws (D) from standoffs that attach gripper plate (E) to canopy assembly. Remove gripper plate and set aside.
5. Thread supply wires through hole in canopy (A). Raise canopy (A) to electric box and secure with two machine screws (not provided).

*Note: A new electric box comes with screws. When replacing a fixture, retain the existing screws for use with the new fixture.*

6. Attach a pigtail lead to the canopy (A) using ground screw (H) and cupped washer (I).
7. Using the four lag screws (F) attach canopy (A) to a structural member in the ceiling.

**Note: Lag screws are supplied with your fixture; however, different materials and/or construction methods may require different fasteners. If in doubt, contact a qualified electrician.**

**CAUTION: INSTALLER MUST ENSURE THAT THE MOUNTING METHOD IS CAPABLE OF SUPPORTING THE WEIGHT OF THE FIXTURE.**

8. While holding gripper plate (E) close to canopy (A), use suitable wire connectors (not provided) to connect driver wires to supply wires (white to white and black to black).

**CAUTION: MAKE SURE WIRE CONNECTORS ARE TWISTED ON SECURELY AND NO BARE WIRE IS EXPOSED.**

9. Reattach gripper plate (E) to canopy (A) using two #8 screws (D).
10. Feed the supply/support cables (K) through appropriate holes in cover plate (C), making sure that the (+) cables go through the (+) holes and the (-) cables go through the (-) holes.
11. Hold cover plate (C) close to canopy (A). Connect all ground wires (bare copper or green to bare copper or green) together.

**CAUTION: MAKE SURE WIRE CONNECTORS ARE TWISTED ON SECURELY AND NO BARE WIRE IS EXPOSED.**

12. Install cover plate (C) over nipple and secure in place with cap (B).
13. Align (+) and (-) labels on the fixture (G) with the (+) and (-) labels on cover plate (C).
14. Insert supply/support cable (K) through gripper (J) on fixture (G) until cable sticks through slot in the side of gripper (J). (Figure 2)
15. Repeat step 13 for the remaining supply/support cables (K).
16. Follow steps on following pages to complete installation.



ASSEMBLY & INSTALLATION INSTRUCTIONS

A1038

Riverbed Circular Pendant 139982

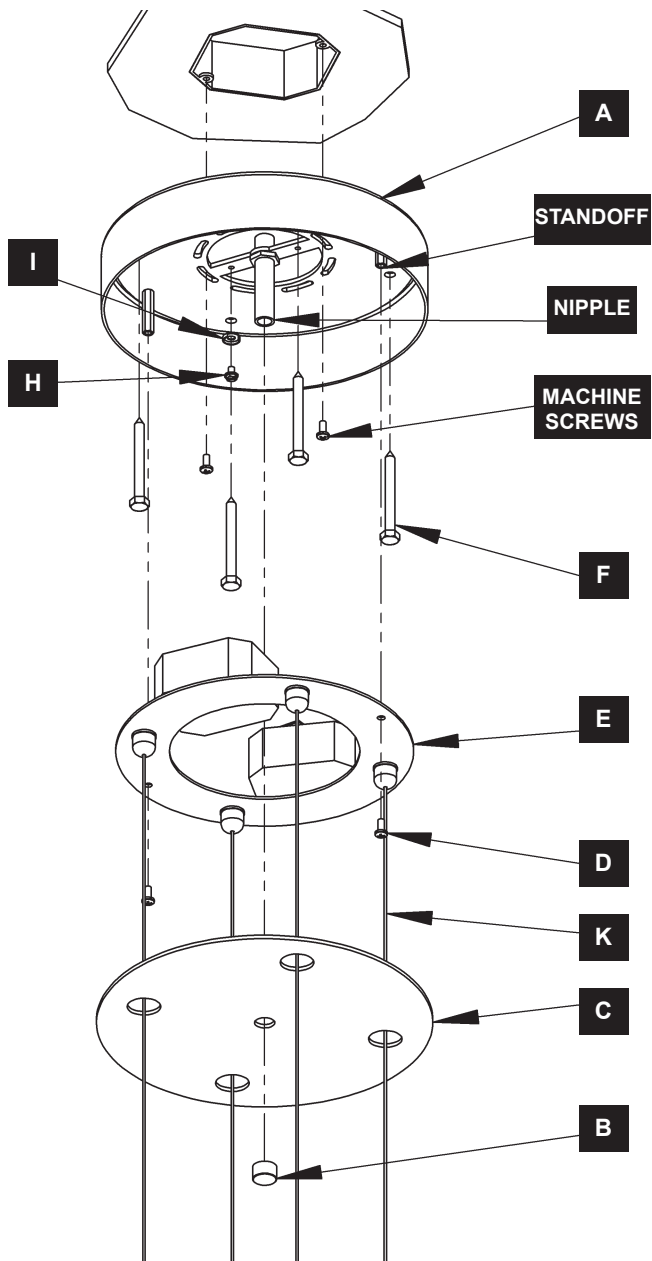

(Figure 1)

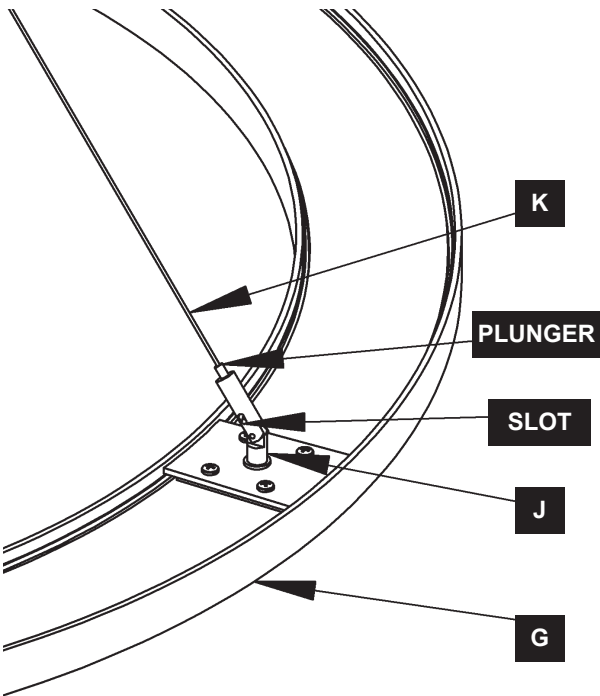

(Figure 2)

## To Install Glass (Figure 3)

1. Raise fixture (G) to a comfortable height for installing glass.
2. Carefully unpack glass (L,M,N) pieces.
3. Each quadrant will use (2) glass large (L), (2) glass medium (M), and (1) glass small (N). Repeat for remaining quadrants.

Note: See Figure 3 and front page for glass orientation. Each quadrant has the same layout.

4. Adjust fixture (G) to desired height by pressing in the plunger on the gripper (J) and pushing/pulling the supply/support cables (K) as necessary.
5. Once desired fixture height is achieved, cut excess cable (K) as close to the gripper (J) as possible.

**CAUTION:** Once excess cable is cut, fixture cannot be lowered.

**CAUTION:** Be sure no piece of the support cable is touching the fixture.

6. Restore electricity at main breaker.

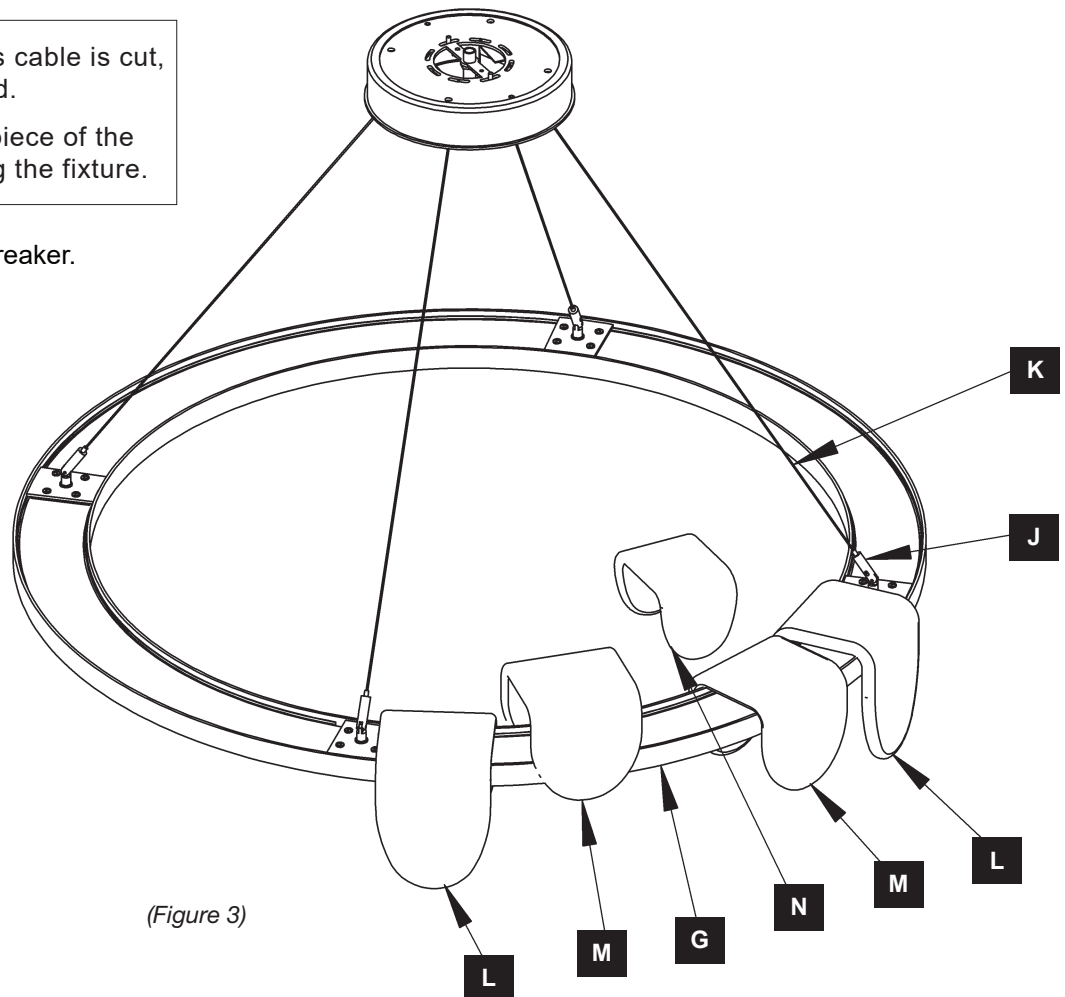

If you need further assistance, or find that you are missing any parts, please contact the dealer from which you purchased this product. We hope you enjoy your fixture!

*\* Hubbardton Forge will not be liable for injury or damage caused by improper installation, lamping or use of this fixture.*



HUBBARDTON FORGE.