

# ASSEMBLY & INSTALLATION INSTRUCTIONS

**B570**

Lyric Sconce 204074

---

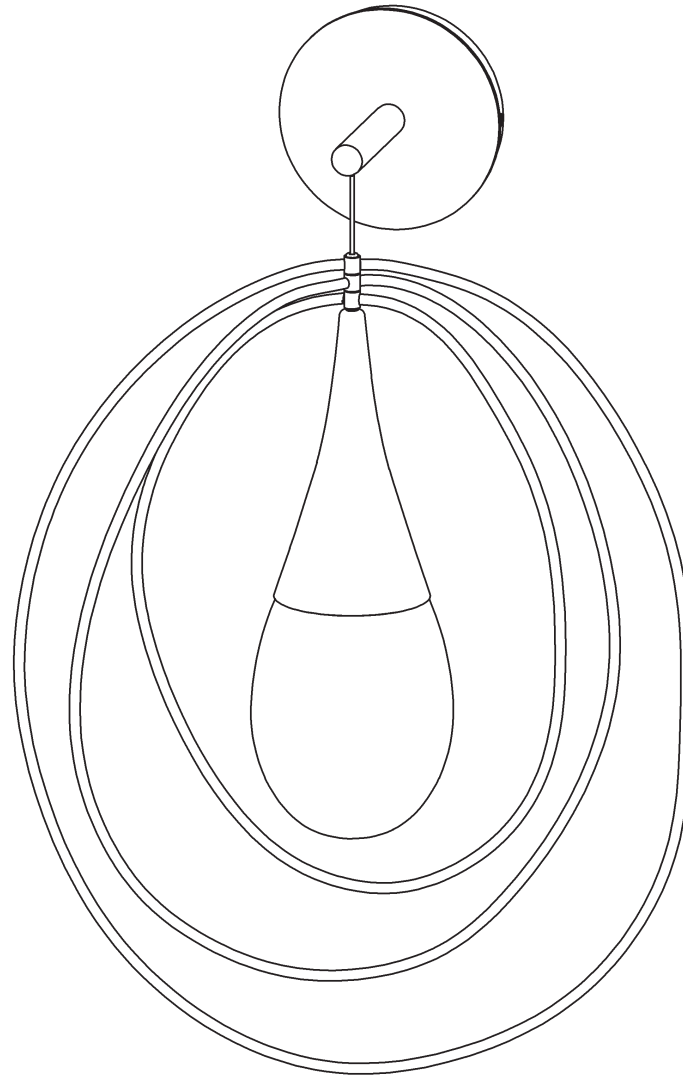

HUBBARDTON FORGE.

MODERN AMERICAN BLACKSMITHS | FINE, HAND CRAFTED LIGHTING  
CASTLETON, VERMONT USA | HUBBARDTONFORGE.COM

**Component Parts**

- A**      **Fixture**
- B**      **Crossbar**
- C**      **Transformer**
- D**      **Wire Connector (2)**
- E**      **#8 Screw (2)**
- F**      **Cupped Washer**
- G**      **Ground Screw**
- H**      **Supply/Support Cable**
- I**      **Collar**
- J**      **Nozzle**
- K**      **Threaded Collar**
- L**      **Socket**
- M**      **Bulb (not included)**
- N**      **Glass**

# ASSEMBLY & INSTALLATION INSTRUCTIONS

B570

Lyric Sconce 204074

**CAUTION: FAILURE TO INSTALL THIS FIXTURE PROPERLY MAY RESULT IN SERIOUS PERSONAL INJURY OR DEATH AND PROPERTY DAMAGE.** We recommend installation by a licensed electrician. This product must be installed in accordance with applicable installation code(s), by a person familiar with the construction and operation of the product and the hazards involved.\*

Please Note: After installation extra hardware and accessories are possible due to our kits are used on multiple products and options.

## To Install To Wall (Figure 1 - on following page)

**CAUTION: BE SURE POWER IS OFF AT THE MAIN BREAKER BOX PRIOR TO INSTALLATION.**

1. Carefully unpack fixture (A) from the carton.
2. Hold transformer (C) close to wall. Using suitable wire connectors (not provided) connect driver wires to supply wires (white to white and black to black).

**CAUTION: MAKE SURE WIRE CONNECTORS ARE TWISTED ON SECURELY AND NO BARE WIRE IS EXPOSED.**

3. Push transformer (C) into electrical box with wires w/ connectors (D) facing out.
4. Using two machine screws (not provided) attach crossbar (B) to electric box.  
**Note:** A new electrical box comes with screws. When replacing a fixture, retain the existing screws for use with the new fixture.
5. Attach a pigtail lead to crossbar (B) using cupped washer (F) and ground screw (G), found in kit bag.
6. Length of fixture can be adjusted before mounting to wall. Using hex wrench provided, loosen set screw in collar (I). Slide supply/supper cable (H) through fixture (A) until desired height is reached. Retighten set screw in collar (I) to secure adjustment.

**CAUTION: BE SURE NOT TO OVERTIGHTEN SET SCREW AS THIS COULD PINCH THE WIRE AND CAUSE THE FIXTURE NOT TO LIGHT.**

7. Hold fixture (A) close, connect all ground wires (bare copper or green to bare copper or green).
8. Using wire connectors provided (D), connect one red transformer wire to Braided side of cable (H). Connect the remaining red transformer wire to the stranded side of cable (H) wires. Either braided/stranded wire can be connected to either red transformer wire.

**CAUTION: MAKE SURE NO BARE WIRE IS EXPOSED.**

9. Tuck all excess cable and wire into electrical box.
10. Push fixture (A) firmly against the wall. Attach fixture (A) to wall using a #8 screw (E) on each side.

**CAUTION: BE SURE NO WIRES ARE PINCHED BETWEEN THE FIXTURE AND THE WALL.**

11. Follow steps on next page to complete installation.



HUBBARDTON FORGE.

MODERN AMERICAN BLACKSMITHS | FINE, HAND CRAFTED LIGHTING  
CASTLETON, VERMONT USA | HUBBARDTONFORGE.COM

59198

3 OF 5

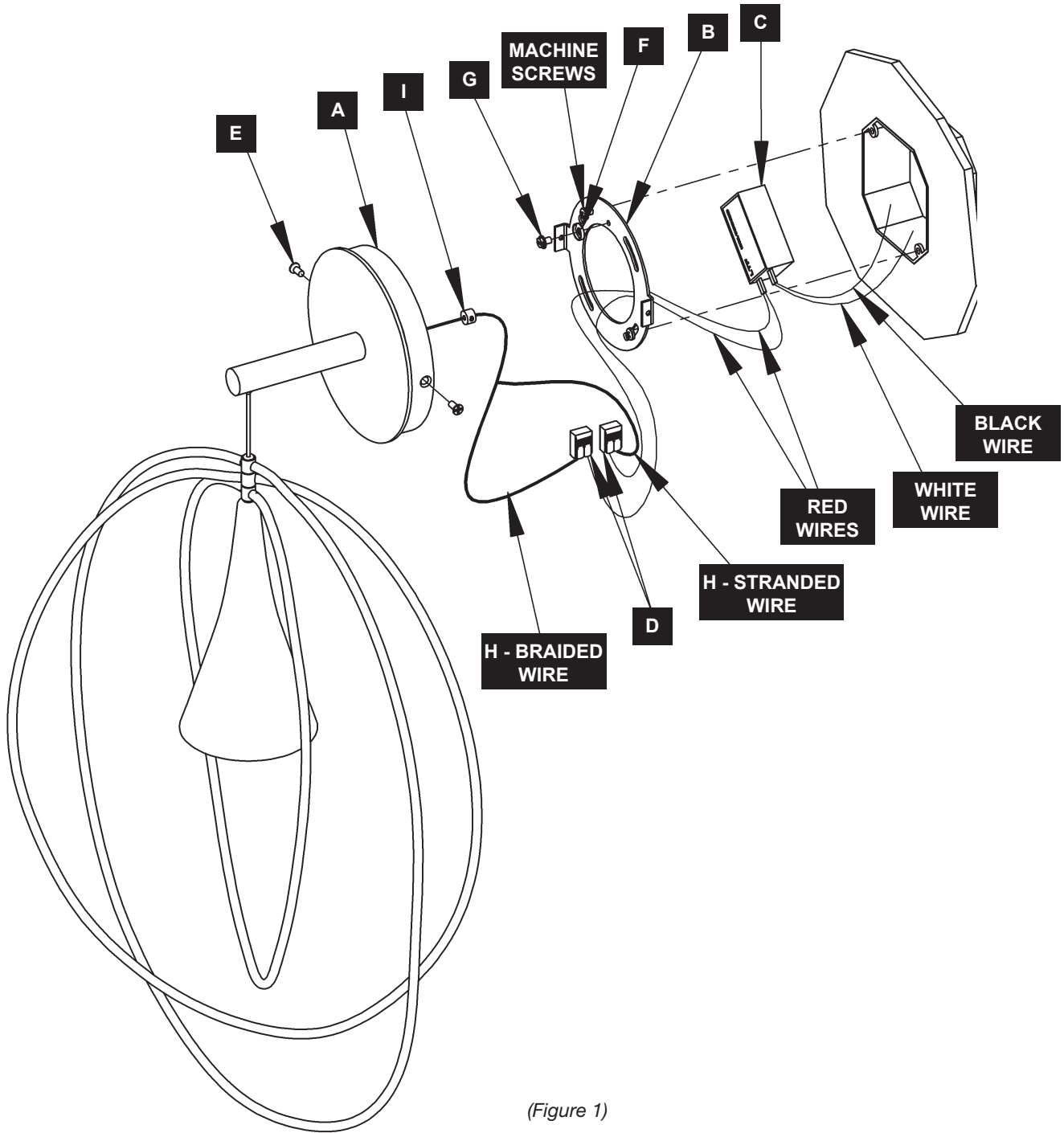

(Figure 1)

Lyric Sconce 204074

## To Install Glass *(Figure 2)*

1. Carefully unpack glass (N).
2. Slide decorative rings and vase up supply/support cable.
3. Holding nozzle (J) and threaded collar (K), install bulb (M), *not included*, into socket (L).
4. Thread glass (N) onto threaded collar (K) until it touches nozzle (J).
5. Carefully slide vase and decorative rings down cable until they rest on glass (N).
6. Restore electricity at the main breaker.

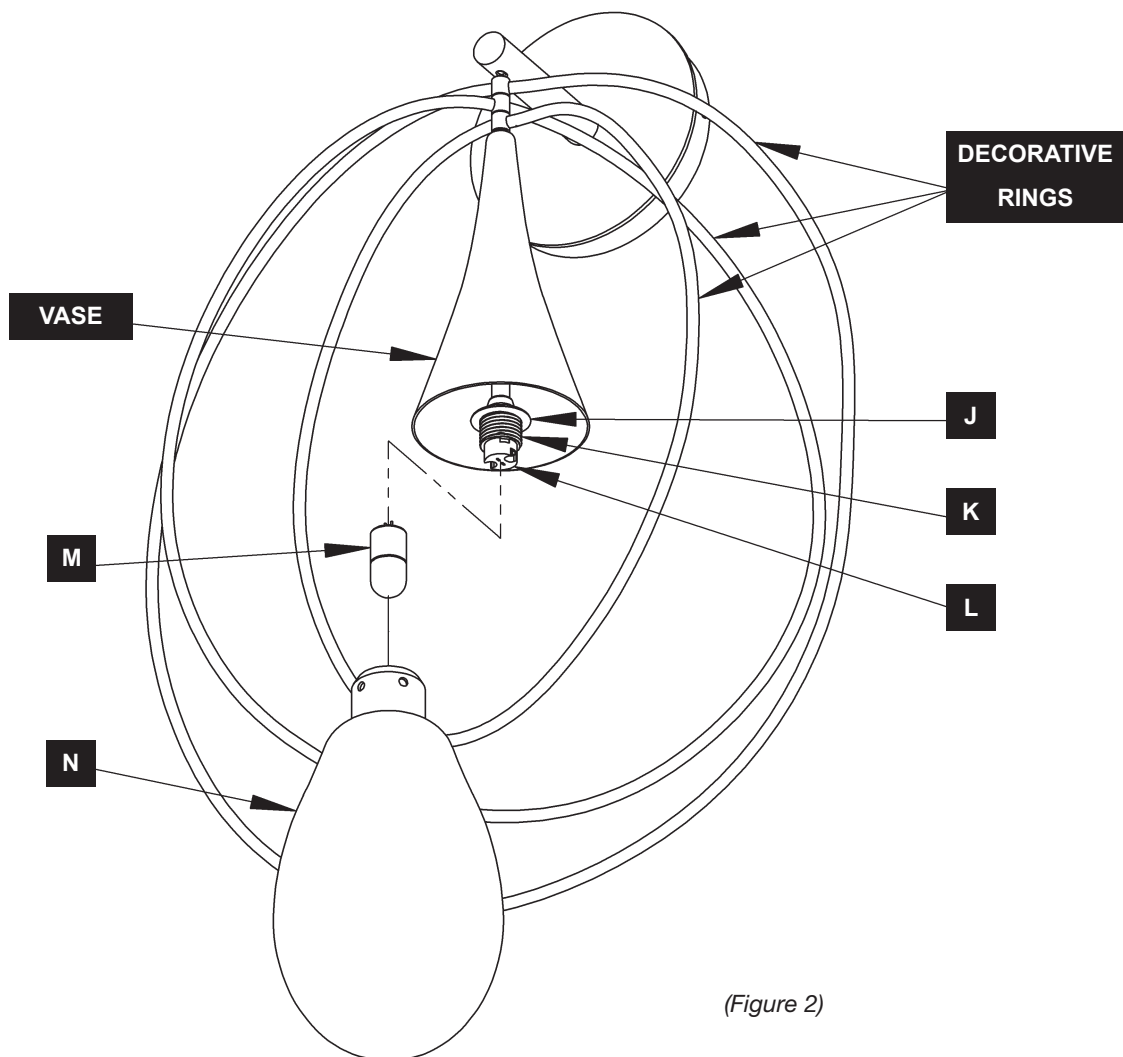

*(Figure 2)*

If you need further assistance, or find that you are missing any parts, please contact the dealer from which you purchased this product.  
We hope you enjoy your fixture!

***\* Hubbardton Forge will not be liable for injury or damage caused by improper installation, lamping or use of this fixture.***



HUBBARDTON FORGE.

MODERN AMERICAN BLACKSMITHS | FINE, HAND CRAFTED LIGHTING  
CASTLETON, VERMONT USA | HUBBARDTONFORGE.COM