

# ASSEMBLY & INSTALLATION INSTRUCTIONS

A1003

Axis Flush Mount Square Glass - 126400

---

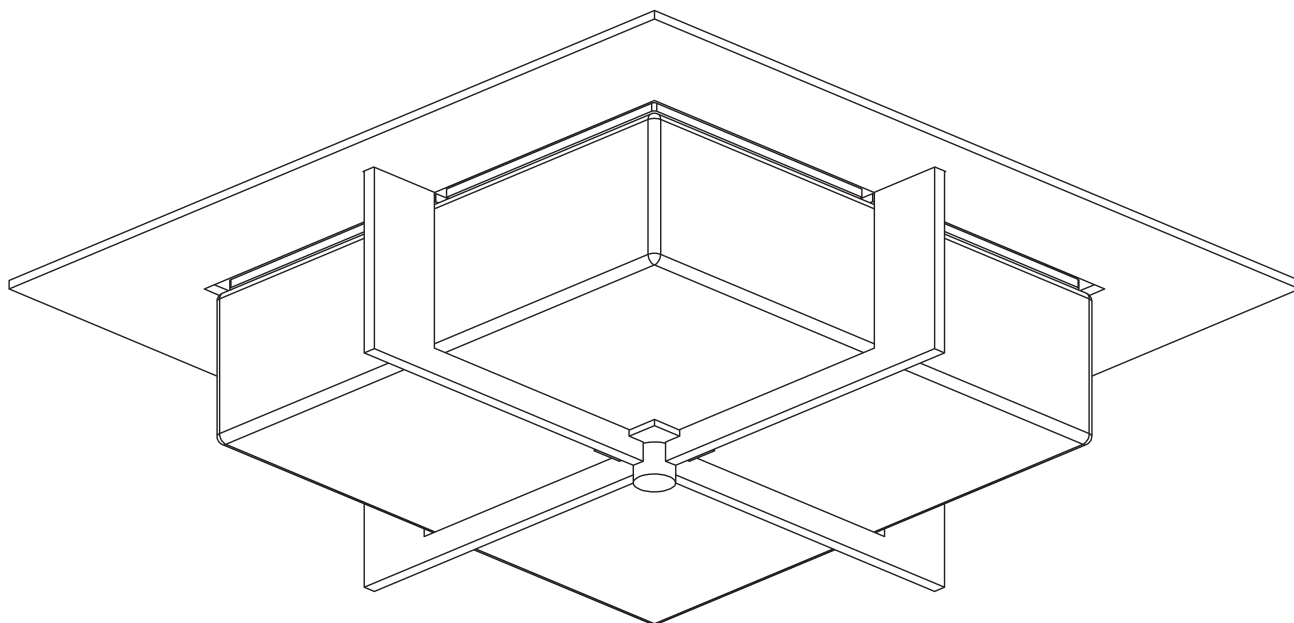

HUBBARDTON FORGE.

MODERN AMERICAN BLACKSMITHS | FINE, HAND CRAFTED LIGHTING  
CASTLETON, VERMONT USA | HUBBARDTONFORGE.COM

57328

1 OF 5

# ASSEMBLY & INSTALLATION INSTRUCTIONS

A1003

Axis Flush Mount Square Glass - 126400

---

## Component Parts

- A Fixture**
- B Mounting Plate**
- C Studs (4)**
- D Knurled Nut (4)**
- E Anchors (4)**
- F #10 Screws (4)**
- G Ground Screw**
- H Cupped Washer**
- I Inner Glass**
- J Nipple**
- K Rubber Washer**
- L Check Ring**
- M Coupling**
- N Outer Glass**
- O Frame**
- P Cap**



HUBBARDTON FORGE.

MODERN AMERICAN BLACKSMITHS | FINE, HAND CRAFTED LIGHTING  
CASTLETON, VERMONT USA | HUBBARDTONFORGE.COM

# ASSEMBLY & INSTALLATION INSTRUCTIONS

A1003

Axis Flush Mount Square Glass - 126400

**CAUTION: FAILURE TO INSTALL THIS FIXTURE PROPERLY MAY RESULT IN SERIOUS PERSONAL INJURY OR DEATH AND PROPERTY DAMAGE.** We recommend installation by a licensed electrician. This product must be installed in accordance with applicable installation code(s), by a person familiar with the construction and operation of the product and the hazards involved.\*

**Caution:** Do not exceed maximum wattage noted on fixture. Use only recommended bulbs with fixture.

## Install Canopy (Figure 1 - on following page)

1. Carefully unpack the fixture from the carton.
2. Center the mounting plate (B) over the electrical box. Be sure to line up oval slots in bracket with mounting holes in electrical box. With a pencil, mark the location of all mounting holes in the mounting plate (B) on the ceiling.
3. Put the mounting plate (B) down and drill 1/4" holes in the locations marked on the ceiling. Place the tapered end of the anchors (E) into the holes and gently tap them flush to the ceiling using a light weight hammer.
4. Thread the wires from the electrical box through the center hole in the mounting plate (B) while moving into position.
5. Using two machine screws (not provided), fasten the mounting plate (B) to the electric box using oval slots in center.

**Note:** Most electric boxes comes with screws. When replacing a fixture, retain the existing screws for use with the new fixture.

6. Using the #10 screws (F), screw the mounting plate (B) securely to the ceiling. Be careful not to over-tighten or strip the anchors (E).
7. Using suitable wire connectors (not provided); connect fixture wires to supply wires (white to white and black to black). Run a pigtail lead using ground screw (G) and cupped washer (H) from mounting plate (B) to the junction box and connect all ground wires (bare copper or green to bare copper or green).

**Caution:** Be sure wire connectors are twisted on securely, and no bare wire is exposed.

8. Slide fixture (A) over studs (C) and push firmly to ceiling. Fasten with knurled nuts (D) and tighten until snug against fixture (A).

**Caution:** Be sure no wires are pinched between the ceiling and fixture (A).

9. Complete steps on following pages to install glass and complete installation.

# ASSEMBLY & INSTALLATION INSTRUCTIONS

Axis Flush Mount Square Glass - 126400

A1003

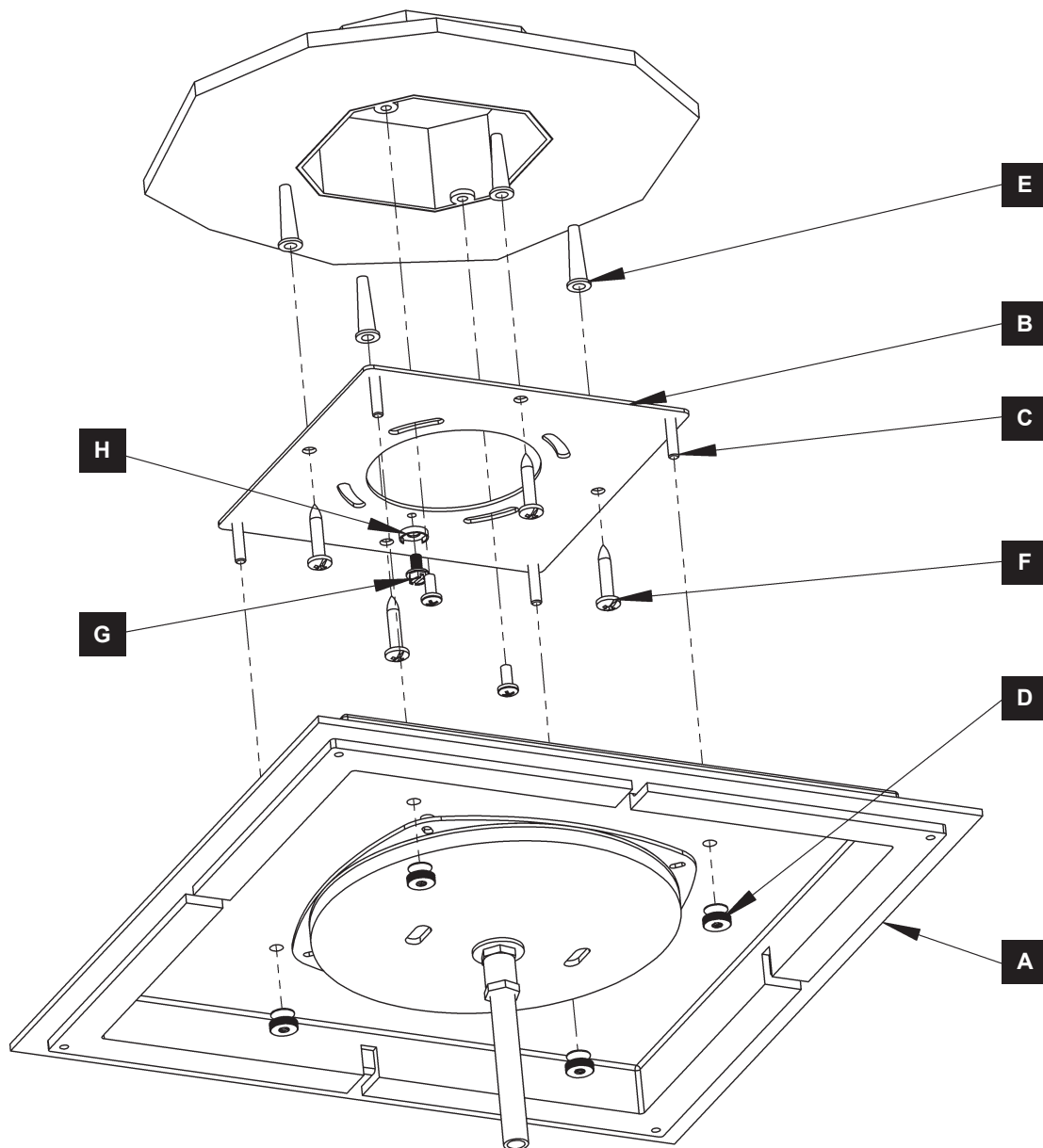

(Figure 1)



HUBBARDTON FORGE.

MODERN AMERICAN BLACKSMITHS | FINE, HAND CRAFTED LIGHTING  
CASTLETON, VERMONT USA | HUBBARDTONFORGE.COM

57328

4 OF 5

# ASSEMBLY & INSTALLATION INSTRUCTIONS

A1003

Axis Flush Mount Square Glass - 126400

## Install Glass & Outer Frame (Figure 2 - on following page)

1. Slip inner glass (I) over nipple (J) followed by rubber washer (K) and check ring (L). See figure 2
2. Thread coupling (M) onto nipple (J) and tighten until snug against check ring (L).

**Caution:** Be careful to not over tighten.

3. Install outer glass (N) into frame (O). See figure 3
4. Raise frame (O) with outer glass (N) installed up to fixture aligning the hole in the glass with nipple (J). Make sure also that frame tabs are aligned with slots in fixture (A).
5. Thread cap (P) onto nipple (J) and tighten until snug against frame (O).
6. Restore electricity at main breaker.

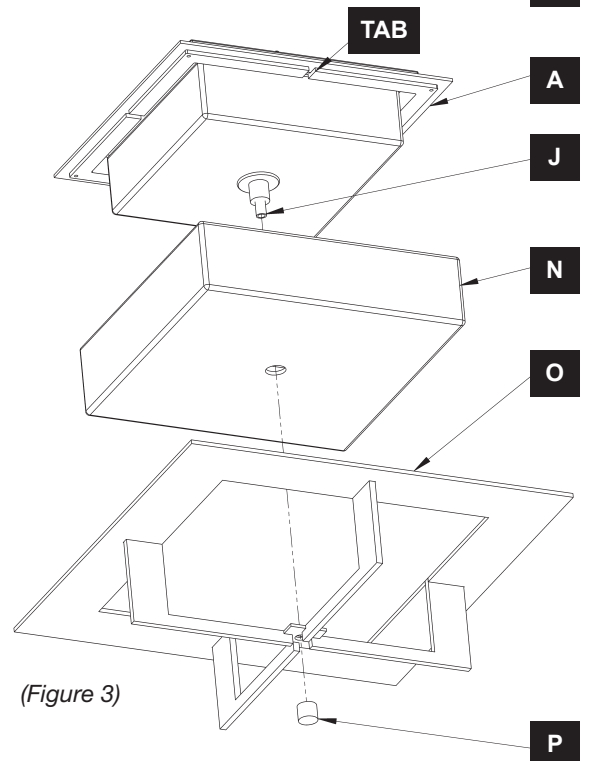
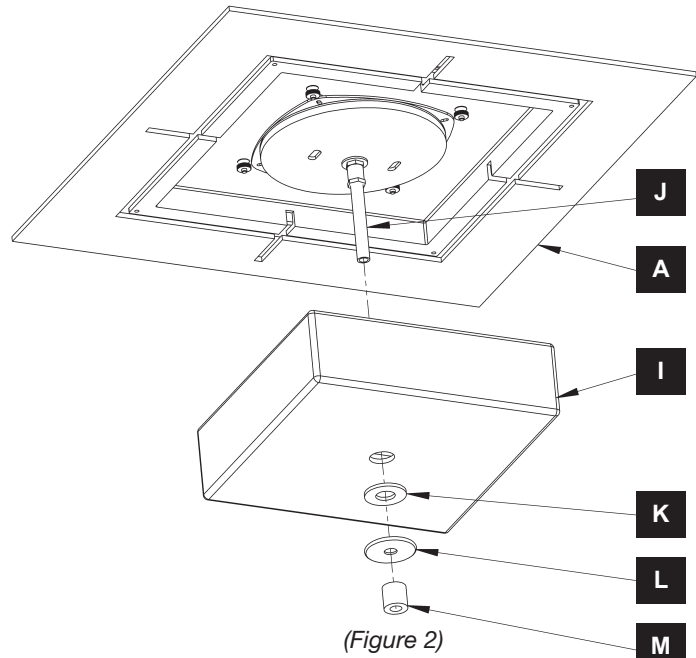

If you need further assistance, or find that you are missing any parts, please contact the dealer from which you purchased this product. We hope you enjoy your fixture!

**\* Hubbardton Forge will not be liable for injury or damage caused by improper installation, lamping or use of this fixture.**