

ASSEMBLY & INSTALLATION INSTRUCTIONS

Astra Semi Flush 121500

A1026

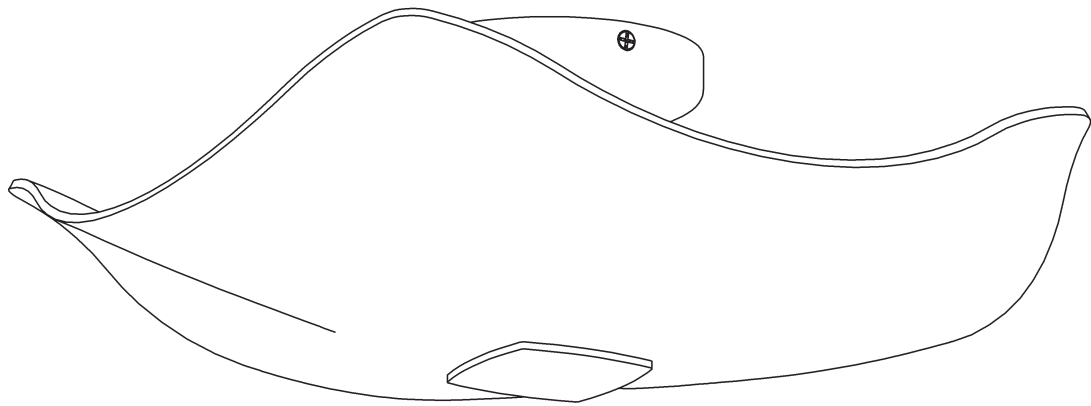

HUBBARDTON FORGE.

Component Parts

- A Fixture
- B Mounting Bracket
- C #8 Flat Head Screws (4)
- D Ground Screw
- E Cupped Washer
- F Socket (3)
- G Bulb (not included) (3)
- H Stud Plate
- I Glass
- J Nuts (2)
- K Attachment Plate

ASSEMBLY & INSTALLATION INSTRUCTIONS

A1026

Astra Semi Flush 121500

CAUTION: FAILURE TO INSTALL THIS FIXTURE PROPERLY MAY RESULT IN SERIOUS PERSONAL INJURY OR DEATH AND PROPERTY DAMAGE. We recommend installation by a licensed electrician. This product must be installed in accordance with applicable installation code(s), by a person familiar with the construction and operation of the product and the hazards involved.*

Please Note: After installation extra hardware and accessories are possible; our kits are used on multiple products.

To Install Fixture (Figure 1)

CAUTION: BE SURE POWER IS OFF AT THE MAIN BREAKER BOX PRIOR TO INSTALLA-

1. Carefully unpack the fixture (A) from the carton.
2. Mounting bracket (B) is shipped installed in fixture (A). Remove #8 flat head screws (C) to separate. Retain screws for later use.
3. Thread the wires in the electrical box through the hole in the mounting bracket (B) while moving the bracket into position. Using two machine screws (not provided) fasten mounting bracket (B) to the electric box.

Note: A new electric box comes with screws. When replacing a fixture, retain the existing screws for use with the new fixture.

4. Attach a pigtail lead to bracket (B) using ground screw (D) and cupped washer (E) found in kit bag.
5. Using suitable wire connectors (not provided) connect fixture wires to supply (white to white and black to black). Connect all ground wires (bare copper or green to bare copper or green) together.
6. Carefully tuck all wires inside fixture (A), push fixture firmly against the ceiling.

CAUTION: MAKE SURE WIRE CONNECTORS ARE TWISTED ON SECURELY, AND NO BARE WIRE IS EXPOSED.

7. Align holes in fixture (A) with holes in bracket (B) and secure with (4) #8 flat head screws (C). For ease of install, start all screws before tightening completely.

Note: Be sure no wires are pinched between the ceiling and the fixture.

8. Install bulbs (G) (not included) into sockets (F).
9. Locate stud plate (H), glass (I) and nuts (J). Place glass (I) over stud plate (H), aligning so the studs pass through the holes in the glass (I)
10. Raise glass (I) and stud plate (H) up to fixture (A), passing studs through holes in attachment plate (K). Secure with nuts (J)
11. Restore electricity at main breaker.



HUBBARDTON FORGE.

ASSEMBLY & INSTALLATION INSTRUCTIONS

Astra Semi Flush 121500

A1026

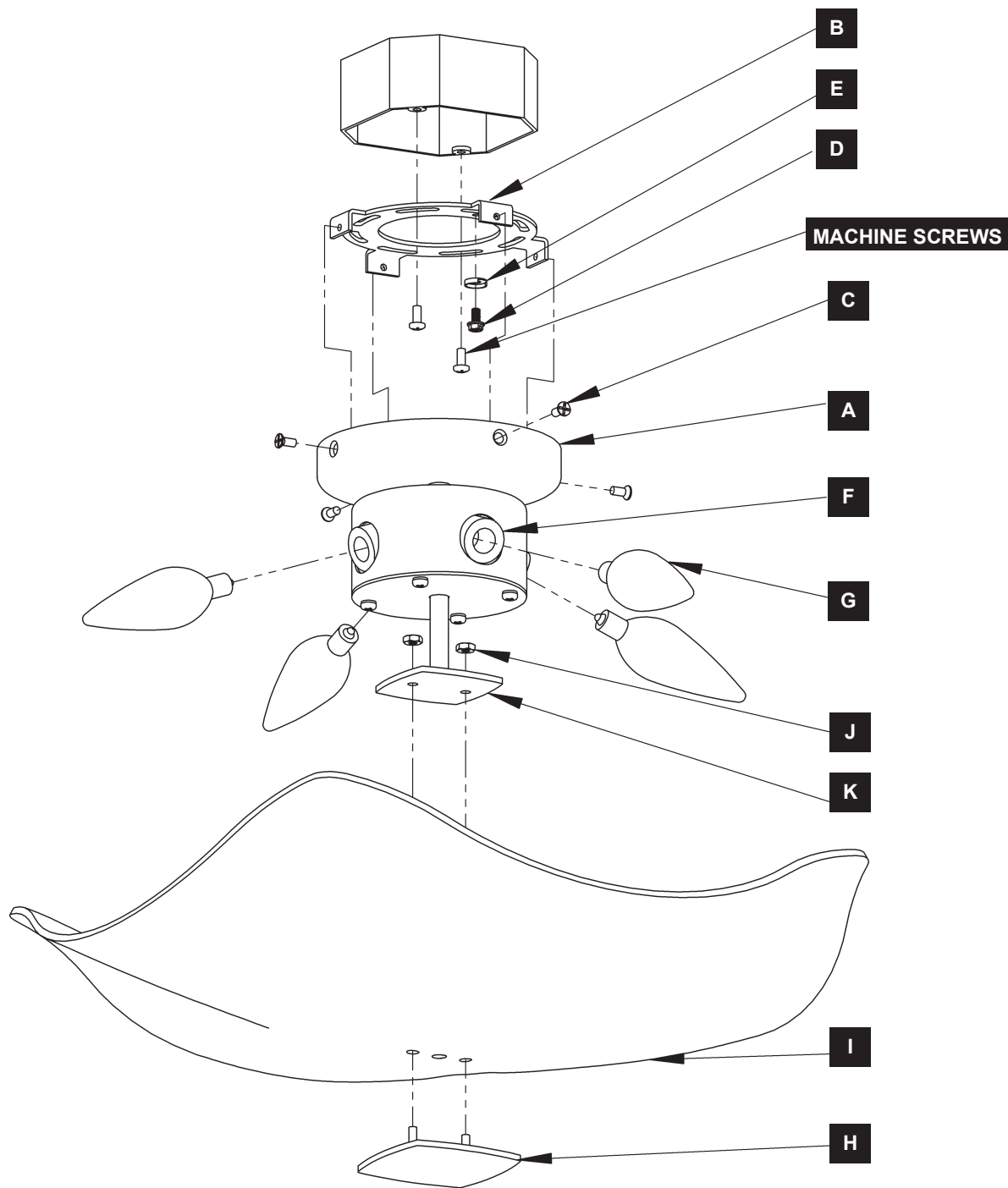

(Figure 1)

If you need further assistance, or find that you are missing any parts, please contact the dealer from which you purchased this product. We hope you enjoy your fixture!

** Hubbardton Forge will not be liable for injury or damage caused by improper installation, lamping or use of this fixture.*



HUBBARDTON FORGE.