

ASSEMBLY & INSTALLATION INSTRUCTIONS

B558

Davis Outdoor Sconce Small 305211, Medium 305212 & Large 305213

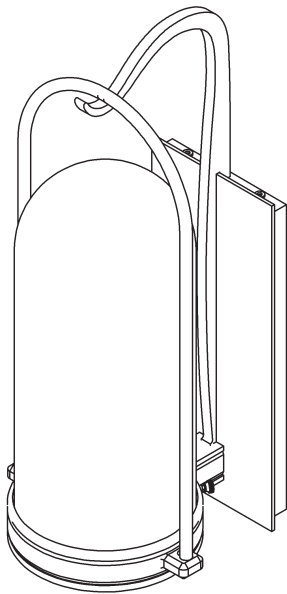

305211

Shown in Illustrations

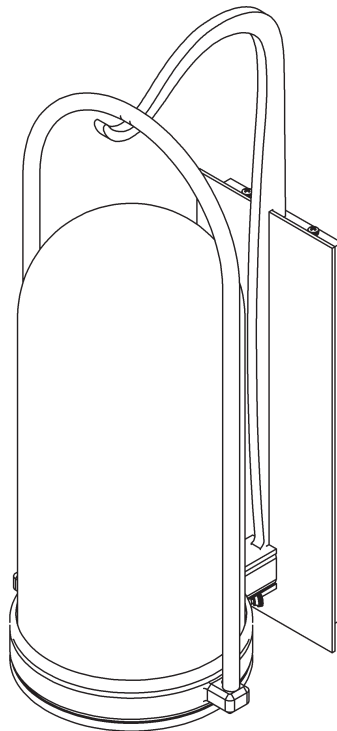

305212

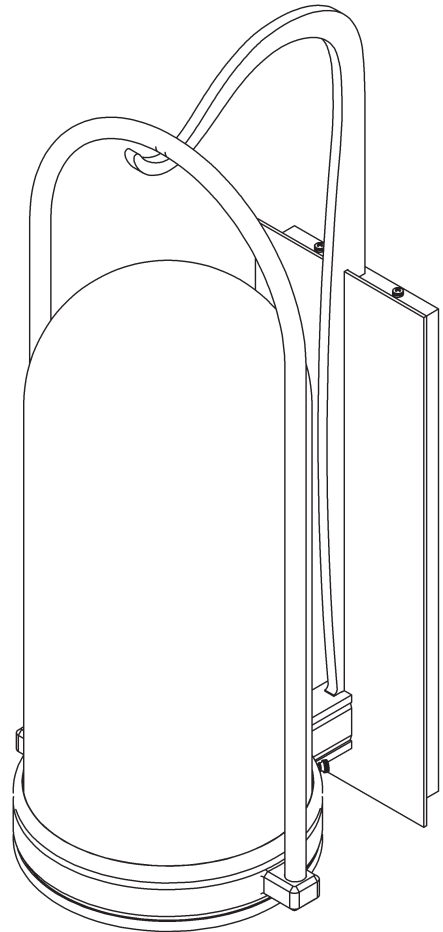

305213



HUBBARDTON FORGE.

MODERN AMERICAN BLACKSMITHS | FINE, HAND CRAFTED LIGHTING
CASTLETON, VERMONT USA | HUBBARDTONFORGE.COM

57344

1 OF 5

Component Parts

- A Fixture
- B Mounting Bracket
- C Anchors (4)
- D #10 Screws (4)
- E Ground Screw
- F Cupped Washer
- G Caulking Lip
- H #8 Screws (4)
- I Rubber Washer (4)
- J Socket
- K Glass
- L Bulb (not provided)
- M Thumb Screws (2)

ASSEMBLY & INSTALLATION INSTRUCTIONS

B558

Davis Outdoor Sconce Small 305211, Medium 305212 & Large 305213

CAUTION: FAILURE TO INSTALL THIS FIXTURE PROPERLY MAY RESULT IN SERIOUS PERSONAL INJURY OR DEATH AND PROPERTY DAMAGE. We recommend installation by a licensed electrician. This product must be installed in accordance with applicable installation code(s), by a person familiar with the construction and operation of the product and the hazards involved.*

Caution: Do not exceed maximum wattage noted on fixture. Use only recommended bulbs with fixture.

To Install Fixture (Figures 1 & 2 - on next page)

1. Carefully unpack the fixture (A) from the carton.
2. Remove (4) #8 screws (H) holding mounting bracket (B) to fixture (A). Retain screws (H) for later step. Remove mounting bracket (B) from fixture (A).
3. Place mounting bracket (B) over the electrical box being sure to hold it level. Line up holes in mounting bracket with holes in electrical box. With a pencil, mark the location of mounting holes in the mounting bracket on the wall behind. Set bracket aside.
4. Drill 1/4" holes in the locations marked on the wall. Place the tapered end of the anchors (C) into the holes and gently tap them flush to the wall using a light weight hammer.
5. Thread wires in electrical box through hole in mounting bracket (B) while moving bracket into position. Using (2) #8 machine screws (not provided), attach the bracket securely to the junction box.

Note: A new electric box comes with screws. When replacing an existing fixture, retain screws for use with the new fixture

6. Using #10 screws (D), screw bracket securely to the wall. Be careful not to over-tighten or strip anchors (C).
7. Attach a pigtail lead to the mounting bracket (B) using the ground screw (E) and cupped washer (F) found in kit bag.
8. Hold fixture (A) close to wall. Using suitable wire connectors (not provided), connect fixture wires to supply wires (one fixture wire to the negative supply wire and one fixture wire to the positive supply wire) - white to white and black to black. Connect all ground wires (bare copper or green to bare copper or green) together.

CAUTION: MAKE SURE WIRE CONNECTORS ARE TWISTED ON SECURELY, AND NO BARE WIRE IS EXPOSED.

9. Apply a generous bead of a suitable caulking material (not provided) to caulking lip (G) on the fixture (Figure 2).
10. Place fixture (A) over mounting bracket (B). Secure with #8 screws (H) and rubber washers (I) on top and #8 screws (H) in bottom of fixture. Rubber washer (I) can be found in the kit bag.

CAUTION: BE SURE NO WIRES ARE PINCHED BETWEEN THE WALL AND FIXTURE.

11. Follow steps on remaining pages to complete installation.

ASSEMBLY & INSTALLATION INSTRUCTIONS

B558

Davis Outdoor Sconce Small 305211, Medium 305212 & Large 305213

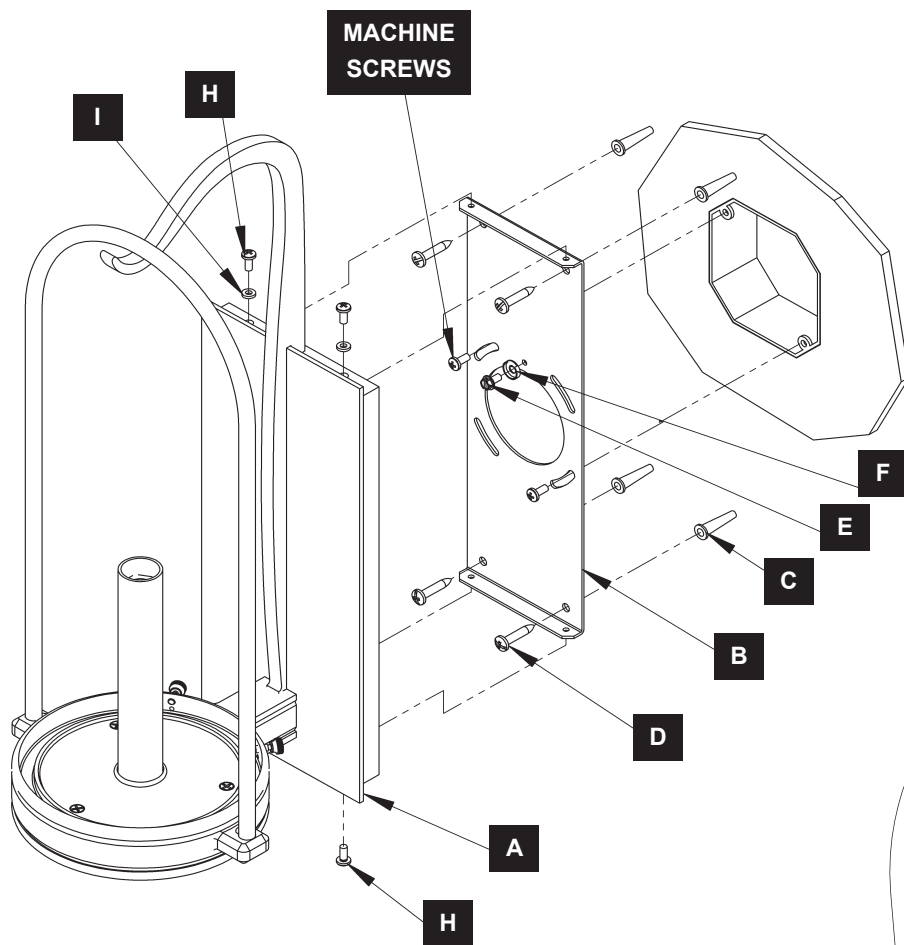

(Figure 1)

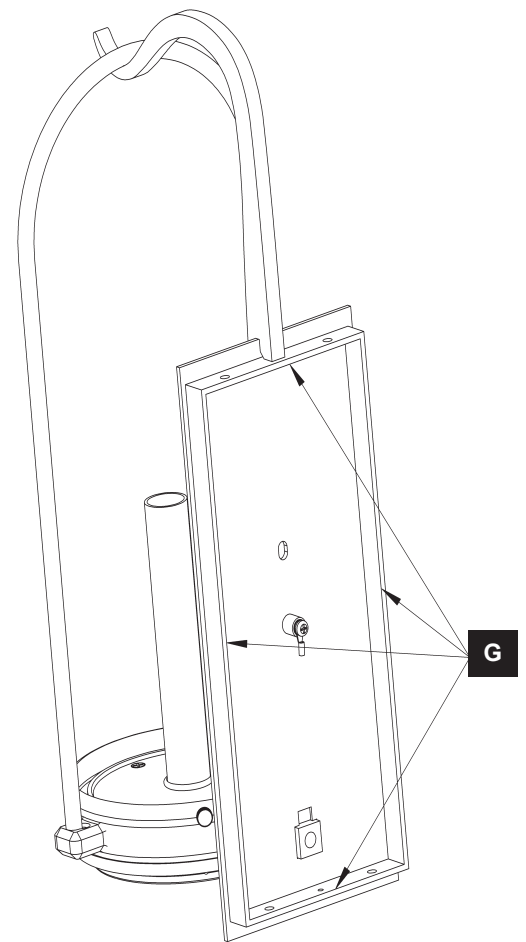

(Figure 2)



HUBBARDTON FORGE.

MODERN AMERICAN BLACKSMITHS | FINE, HAND CRAFTED LIGHTING
CASTLETON, VERMONT USA | HUBBARDTONFORGE.COM

ASSEMBLY & INSTALLATION INSTRUCTIONS

B558

Davis Outdoor Sconce Small 305211, Medium 305212 & Large 305213

Install Glass (Figure 3)

1. Install bulb (L) (not provided) into socket (J).

2. Tilt glass (K), over bulb (L) and into groove in fixture.

Note: It may be necessary to unthread thumb screws to allow glass to slide into position. Thumb screws will not need to be completely removed.

3. Tighten thumb screws (M) evenly to secure glass (K) in place.

Note: Be sure not to overtighten as this could break glass.

4. Restore electricity at main breaker.

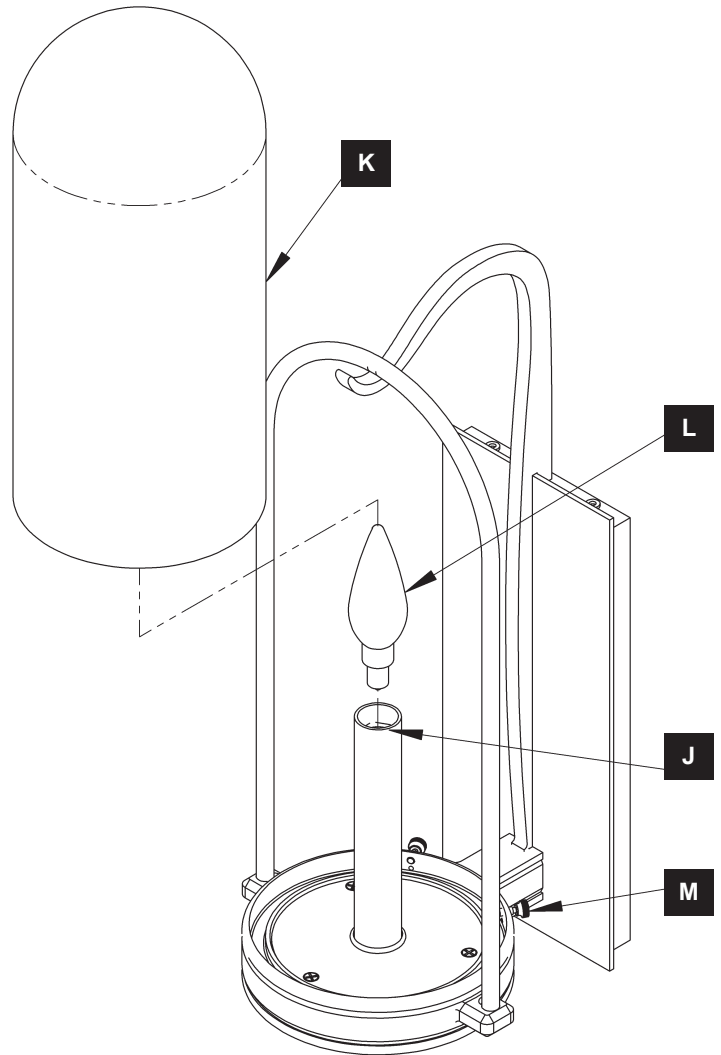

(Figure 3)

If you need further assistance, or find that you are missing any parts, please contact the dealer from which you purchased this product. We hope you enjoy your fixture!

*** Hubbardton Forge will not be liable for injury or damage caused by improper installation, lamping or use of this fixture.**