

ASSEMBLY & INSTALLATION INSTRUCTIONS

Summit Pendant 8 Light 132045

A1027

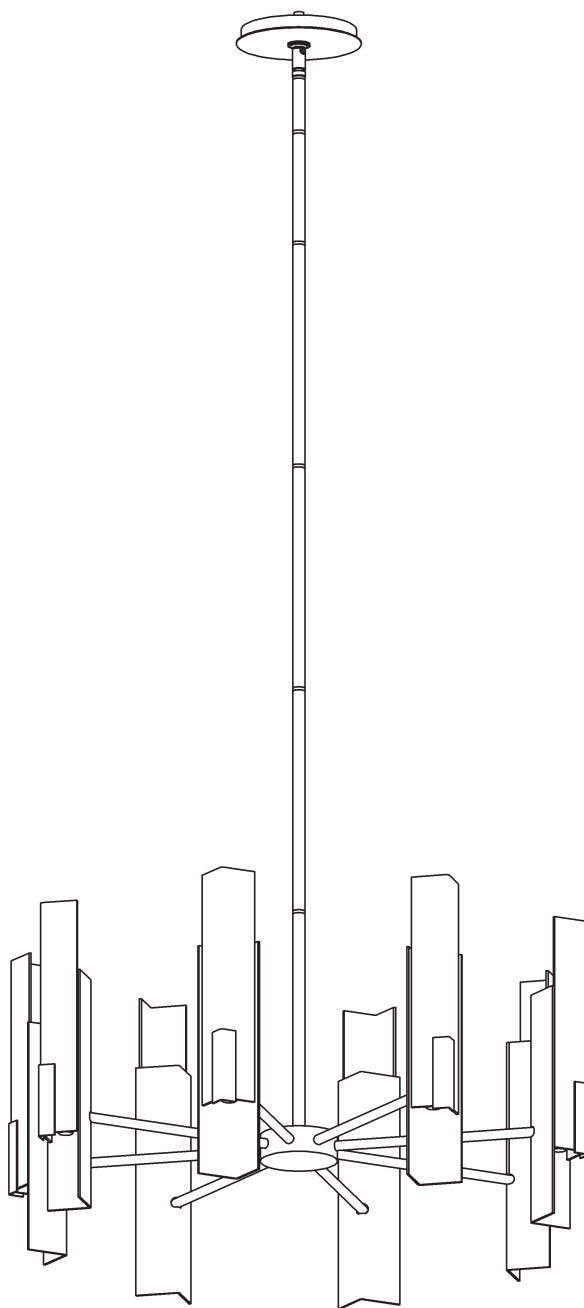

HUBBARDTON FORGE.

MODERN AMERICAN BLACKSMITHS | FINE, HAND CRAFTED LIGHTING
CASTLETON, VERMONT USA | HUBBARDTONFORGE.COM

57485

1 OF 6

Component Parts

A	Fixture
B	Crossbar
C	Jam Nut
D	Threaded Nipple
E	Ground Screw
F	Canopy Ring
G	Canopy
H	Swivel
I	3" Fixture Pipe (1)
J	6" Fixture Pipe (1)
K	12" Fixture Pipe (4)
L	Stem Couplings (5)
M	Glass (8)
N	Holder (8)
O	Screw (8)
P	Inner Glass (8) - Only Used w/ Clear Outer Glass Option
Q	O-rings (16) - Only Used w/ Clear Outer Glass Option
R	Socket (8)
S	Bulb (8) - Not Included
T	Cap (8)
U	Nipple (8)



ASSEMBLY & INSTALLATION INSTRUCTIONS

A1027

Summit Pendant 8 Light 132045

CAUTION: FAILURE TO INSTALL THIS FIXTURE PROPERLY MAY RESULT IN SERIOUS PERSONAL INJURY OR DEATH AND PROPERTY DAMAGE. We recommend installation by a licensed electrician. This product must be installed in accordance with applicable installation code(s), by a person familiar with the construction and operation of the product and the hazards involved.*

Caution: Do not exceed maximum wattage noted on fixture. Use only recommended bulbs with fixture.

Please Note: After installation extra hardware and accessories are possible due to our kits are used on multiple products and options.

To Install Fixture (Figure 1) on following page

CAUTION: BE SURE POWER IS OFF AT THE MAIN BREAKER BOX PRIOR TO INSTALLATION.

1. Carefully unpack fixture (A) from the carton.
2. Thread jam nut (C) and crossbar (B) onto threaded nipple (D) with ground screw (E) facing towards swivel (H); leave both parts loose.
3. Using two machine screws (not provided), temporarily fasten crossbar (B) to the electric box.

NOTE: A NEW ELECTRIC BOX COMES WITH SCREWS. WHEN REPLACING A FIXTURE, RETAIN THE EXISTING SCREWS FOR USE WITH THE NEW FIXTURE.

4. Adjust the length of threaded nipple (D) in crossbar (B) so that canopy ring (F) will hold canopy (G) against the ceiling with no threads showing for best appearance. When the correct adjustment is established, tighten jam nut (C) against crossbar (B) to secure the adjustment.
5. Remove crossbar (B) from the electrical box and proceed with the assembly instructions.
6. Locate fixture pipes (I, J, K), fixture (A), stem couplings (L) . Stem couplings (L) can be found in the kit bag.
7. Slip wires from fixture through (1) 12" fixture pipe (K) and thread onto fixture. Pipe needs to be installed to allow enough room for glass install.
8. Provided are multiple fixture pipes in three different lengths. Choose the combination that will achieve the overall height desired. Refer to the table below to determine the pipes required to reach the desired overall height. Once you have determined the components necessary, feed the wires that exit fixture (A) through the individual components. Wires will slip easier through loose components than through pipes and couplings that are pre-assembled. Once wires are run, apply thread locking compound to all the connection points and assemble the pipes and couplings.

		Overall Height of Fixture														
		23.1	26.1	29.1	32.1	35.1	38.1	41.1	44.1	47.1	50.1	53.1	56.1	59.1	62.1	65.1
# of Pipes Required	3" Pipe	1		1		1		1		1		1		1		1
	6" Pipe		1	1			1	1			1	1			1	1
	12" Pipe				1	1	1	1	2	2	2	2	3	3	3	3

NOTE: APPLICATION OF THE THREAD LOCKING COMPOUND IS NECESSARY TO PREVENT THE PIPE FROM LOOSENING DURING REGULAR MAINTENANCE AND CLEANING OF THE FIXTURE. BE CERTAIN TO APPLY THE COMPOUND.

9. Carefully slide canopy ring (F) and canopy (G) over wires and fixture pipes (I, J, K) until they rest on fixture (A).
10. Slip wires from the fixture (A) through assembled swivel (H) and threaded nipple (D).
11. Refer to instructions on next page to continue installation.



HUBBARDTON FORGE.

MODERN AMERICAN BLACKSMITHS | FINE, HAND CRAFTED LIGHTING
CASTLETON, VERMONT USA | HUBBARDTONFORGE.COM

57485

3 OF 6

ASSEMBLY & INSTALLATION INSTRUCTIONS

A1027

Summit Pendant 8 Light 132045

12. Using two machine screws (not provided), fasten crossbar (B) to the electric box.
13. Using suitable wire connectors (not provided) connect fixture wires to supply (white/ribbed to white and black/smooth to black). Attach a pigtail lead to crossbar ground screw (E). Hold canopy (G) close, connect all ground wires (bare copper or green to bare copper or green).

CAUTION: MAKE SURE WIRE CONNECTORS ARE TWISTED ON SECURELY, AND NO BARE WIRE IS EXPOSED.

14. Slide canopy (G) against ceiling, and secure with canopy ring (F).

CAUTION: BE SURE NO WIRES ARE PINCHED BETWEEN CANOPY (G) AND THE CEILING.

15. See steps on following pages for glass install.

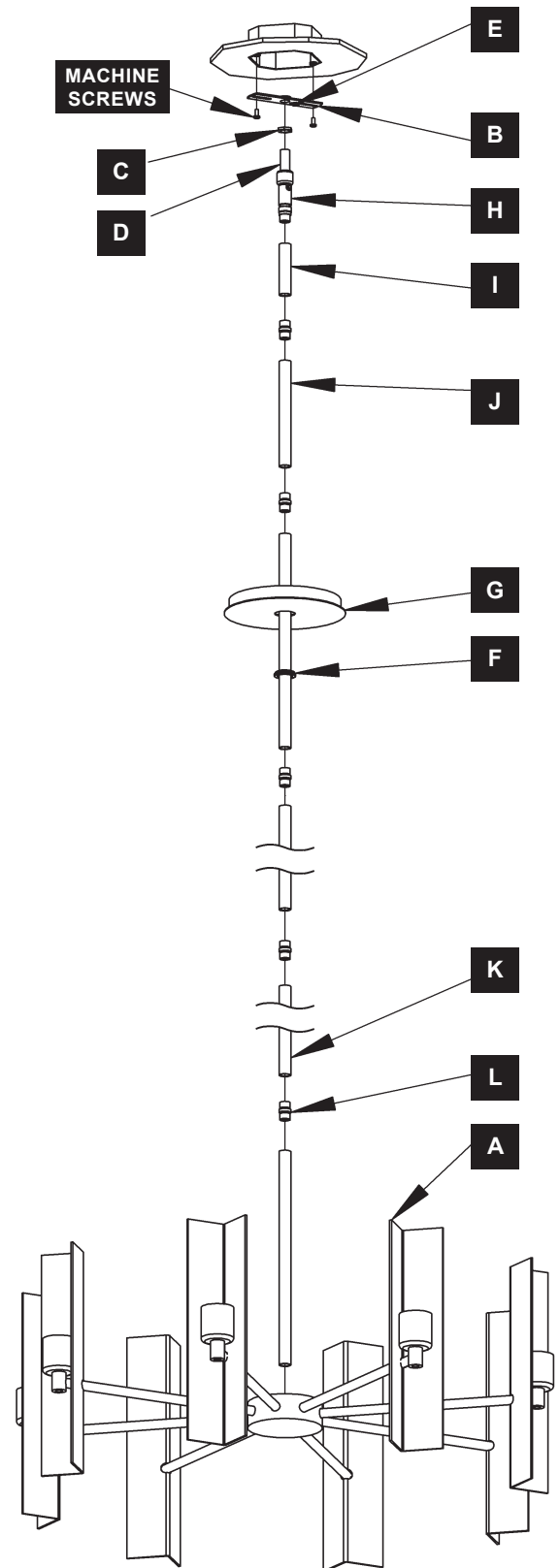

(Figure 1)



HUBBARDTON FORGE.

MODERN AMERICAN BLACKSMITHS | FINE, HAND CRAFTED LIGHTING
CASTLETON, VERMONT USA | HUBBARDTONFORGE.COM

57485

4 OF 6

ASSEMBLY & INSTALLATION INSTRUCTIONS

A1027

Summit Pendant 8 Light 132045

To Assemble Glass (Figure 2)

1. Carefully unpack glass (M).
2. Locate front bent plates found in kit bag.
3. Loosen screw (O) and washer (P). It is not necessary to completely remove it.
4. Slide glass (M) in between front bent plate and holder (N).
5. Position glass (M), press holder (N) up against glass (M) and tighten screw (O) to secure.
6. Repeat steps for remaining glass (M).
7. Follow steps on next page to complete installation.

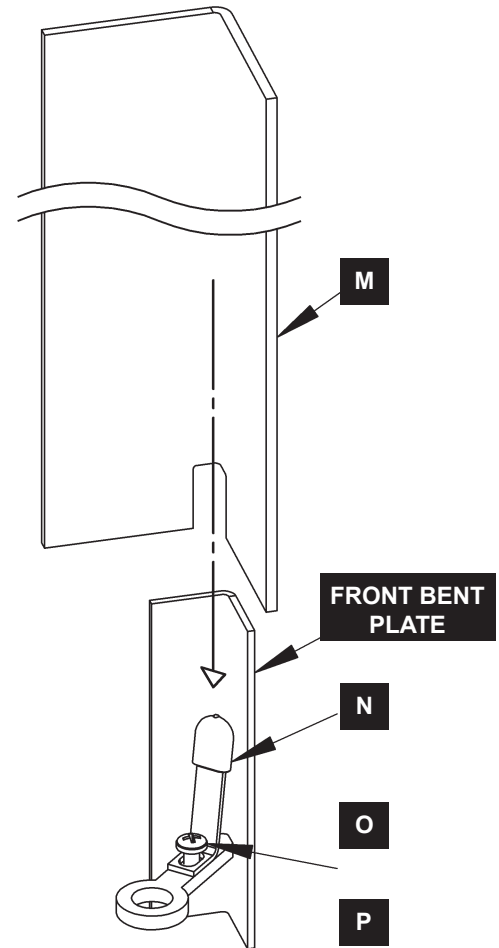

(Figure 2)

Summit Pendant 8 Light 132045

To Complete Install (Figure 3)

1. Install bulbs (S), not included, into sockets (R) .
2. If using clear glass (M), follow next steps. If using frosted glass (M), skip to step 7.
3. Carefully unpack inner glass (P).
4. If needed, slip o-rings (Q) onto end of inner glass (P).

NOTE: O-rings are optional. Either use one, two, or none depending on what's needed to help with gaps. Be sure o-rings slide into cup. It may be necessary to rotate glass or push on O-rings to allow them to slide into cup evenly.

5. Slip over bulb (S) and slide into cup.
6. Repeat for remaining inner glass (P).
7. Place glass (M) assembly over nipple (U) in coupling. Thread cap (T) onto nipple and tighten to secure glass assembly.
8. Repeat for remaining glass (M) assemblies.
9. Restore electricity at main breaker.

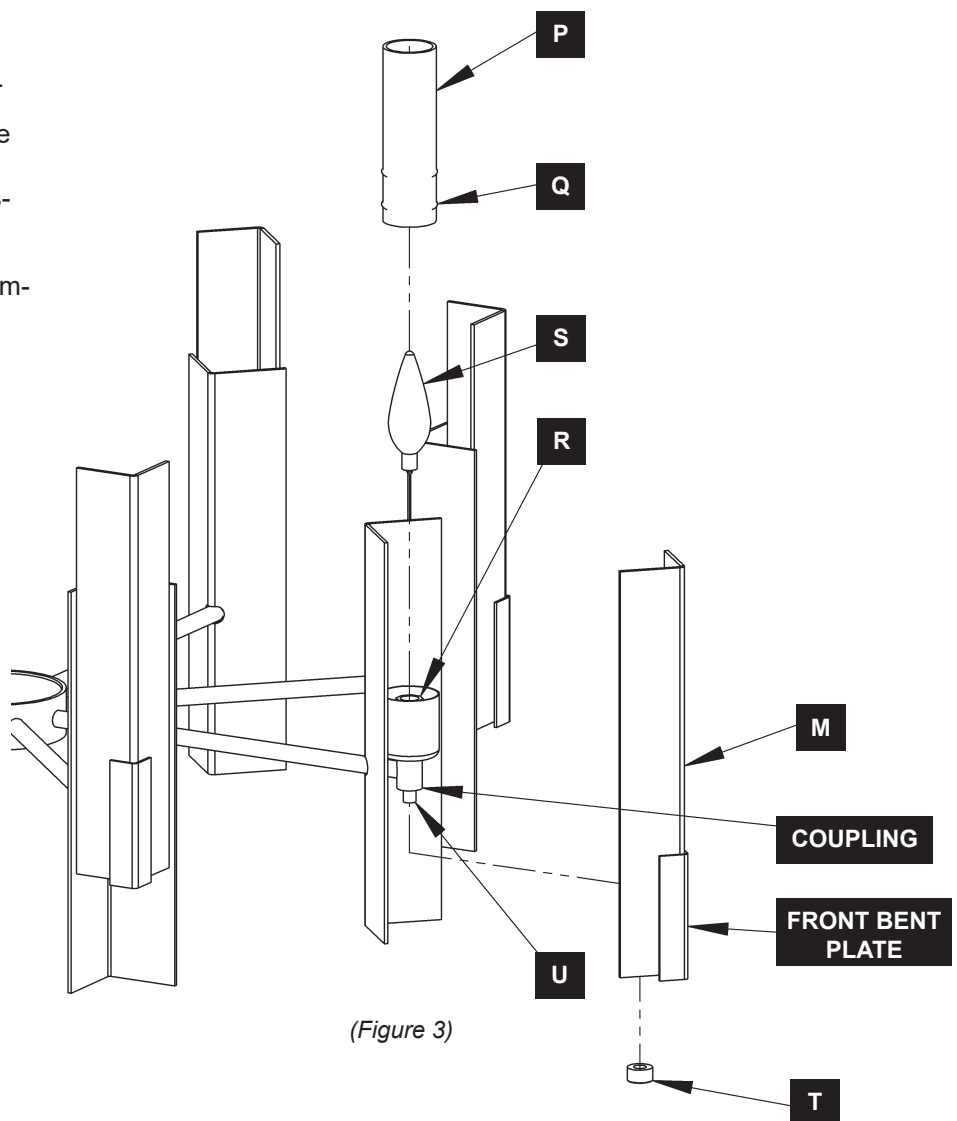

If you need further assistance, or find that you are missing any parts, please contact the dealer from which you purchased this product.
We hope you enjoy your fixture!

** Hubbardton Forge will not be liable for injury or damage caused by improper installation, lamping or use of this fixture.*



HUBBARDTON FORGE.

MODERN AMERICAN BLACKSMITHS | FINE, HAND CRAFTED LIGHTING
CASTLETON, VERMONT USA | HUBBARDTONFORGE.COM