

ASSEMBLY & INSTALLATION INSTRUCTIONS

Summit Lantern 132043

A1039

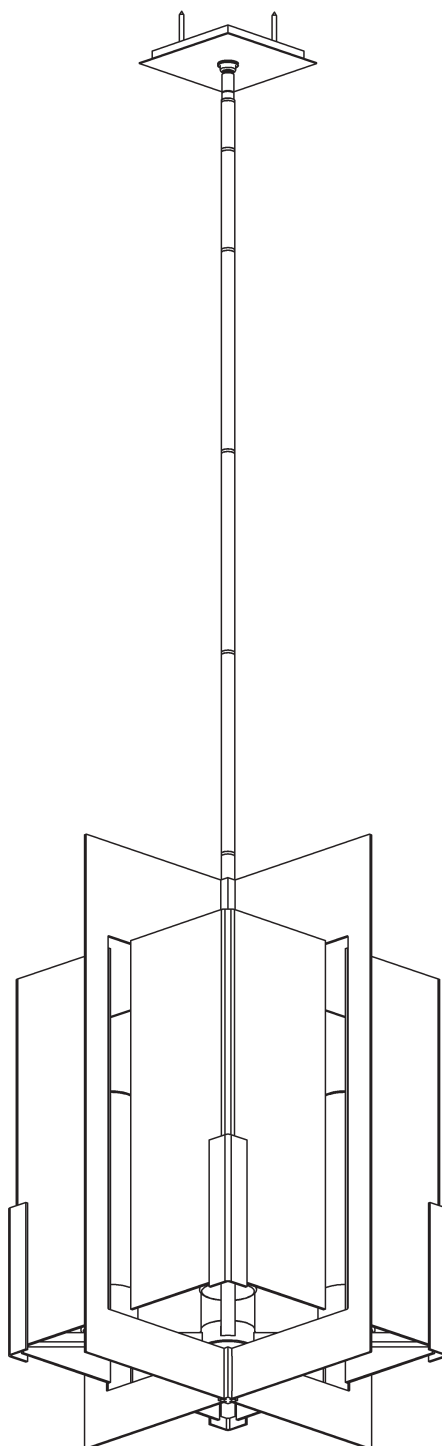

HUBBARDTON FORGE.

MODERN AMERICAN BLACKSMITHS | FINE, HAND CRAFTED LIGHTING
CASTLETON, VERMONT USA | HUBBARDTONFORGE.COM

58415

1 OF 6

Component Parts

A	Fixture
B	Crossbar
C	Jam Nut
D	Threaded Nipple
E	Ground Screw
F	Canopy Ring
G	Canopy
H	Swivel
I	3" Fixture Pipe (1)
J	6" Fixture Pipe (1)
K	12" Fixture Pipe (3)
L	Stem Couplings (5)
M	Lag Screws (2)
N	Glass (4)
O	Inner Glass (4)
P	Knurled Ball (8)
Q	Bent Washer (8)
R	Rubber Washer (8)
S	O-rings (8)
T	Socket (4)
U	Bulb (4) - Not Included



ASSEMBLY & INSTALLATION INSTRUCTIONS

A1039

Summit Lantern 132043

CAUTION: FAILURE TO INSTALL THIS FIXTURE PROPERLY MAY RESULT IN SERIOUS PERSONAL INJURY OR DEATH AND PROPERTY DAMAGE. We recommend installation by a licensed electrician. This product must be installed in accordance with applicable installation code(s), by a person familiar with the construction and operation of the product and the hazards involved.*

Caution: Do not exceed maximum wattage noted on fixture. Use only recommended bulbs with fixture.

Please Note: After installation extra hardware and accessories are possible due to our kits are used on multiple products and options.

To Install Fixture (Figure 1) on following page

CAUTION: BE SURE POWER IS OFF AT THE MAIN BREAKER BOX PRIOR TO INSTALLATION.

1. Carefully unpack fixture (A) from the carton.
2. Thread jam nut (C) and crossbar (B) onto threaded nipple (D) with ground screw (E) facing towards swivel (H); leave both parts loose.
3. Using two machine screws (not provided), temporarily fasten crossbar (B) to the electric box.

NOTE: A NEW ELECTRIC BOX COMES WITH SCREWS. WHEN REPLACING A FIXTURE, RETAIN THE EXISTING SCREWS FOR USE WITH THE NEW FIXTURE.

4. Adjust the length of threaded nipple (D) in crossbar (B) so that canopy ring (F) will hold canopy (G) against the ceiling with no threads showing for best appearance. When the correct adjustment is established, tighten jam nut (C) against crossbar (B) to secure the adjustment.
5. Remove crossbar (B) from the electrical box and proceed with the assembly instructions.
6. Locate fixture pipes (I, J, K), fixture (A), stem couplings (L) . Stem couplings (L) can be found in the kit bag.
7. Slip wires from fixture through (1) 12" fixture pipe (K) and thread onto fixture. Pipe needs to be installed to allow enough room for glass install.
8. Provided are multiple fixture pipes in three different lengths. Choose the combination that will achieve the overall height desired. Refer to the table below to determine the pipes required to reach the desired overall height. Once you have determined the components necessary, feed the wires that exit fixture (A) through the individual components. Wires will slip easier through loose components than through pipes and couplings that are pre-assembled. Once wires are run, apply thread locking compound to all the connection points and assemble the pipes and couplings.

		38.2	41.2	44.2	47.2	50.2	53.2	56.2	59.2	62.2	65.2	68.2	71.2	74.2	77.2	80.2
# of Pipes Required	3" Pipe (I)	1		1		1		1		1		1		1		1
	6" Pipe (J)		1	1			1	1			1	1			1	1
	12" Pipe (K)				1	1	1	1	2	2	2	2	3	3	3	3

NOTE: APPLICATION OF THE THREAD LOCKING COMPOUND IS NECESSARY TO PREVENT THE PIPE FROM LOOSENING DURING REGULAR MAINTENANCE AND CLEANING OF THE FIXTURE. BE CERTAIN TO APPLY THE COMPOUND.

9. Carefully slide canopy ring (F) and canopy (G) over wires and fixture pipes (I, J, K) until they rest on fixture (A).
10. Slip wires from the fixture (A) through assembled swivel (H) and threaded nipple (D).
11. Refer to instructions on next page to continue installation.



HUBBARDTON FORGE.

MODERN AMERICAN BLACKSMITHS | FINE, HAND CRAFTED LIGHTING
CASTLETON, VERMONT USA | HUBBARDTONFORGE.COM

58415

3 OF 6

ASSEMBLY & INSTALLATION INSTRUCTIONS

A1039

Summit Lantern 132043

12. Using two machine screws (not provided), fasten crossbar (B) to the electric box.
13. Using lag screws (M), attach crossbar (B) to a structural member in the ceiling.

Note: Lag screws are supplied with your fixture; however, different materials and/or construction methods may require different fasteners. If in doubt, contact a qualified electrician.

CAUTION: DO NOT RELY ON ELECTRIC BOX ALONE TO SUSPEND FIXTURE. FIXTURE MUST BE ATTACHED TO A STRUCTURAL MEMBER IN THE CEILING.

CAUTION: INSTALLER MUST ENSURE THAT THE MOUNTING METHOD IS CAPABLE OF SUPPORTING THE WEIGHT OF THE FIXTURE.

14. Using suitable wire connectors (not provided) connect fixture wires to supply (white/ribbed to white and black/smooth to black). Attach a pigtail lead to crossbar ground screw (E). Hold canopy (G) close, connect all ground wires (bare copper or green to bare copper or green) together.

CAUTION: MAKE SURE WIRE CONNECTORS ARE TWISTED ON SECURELY, AND NO BARE WIRE IS EXPOSED.

15. Slide canopy (G) against ceiling, and secure with canopy ring (F).

CAUTION: BE SURE NO WIRES ARE PINCHED BETWEEN CANOPY (G) AND THE CEILING.

16. Refer to instructions on following pages to complete install.

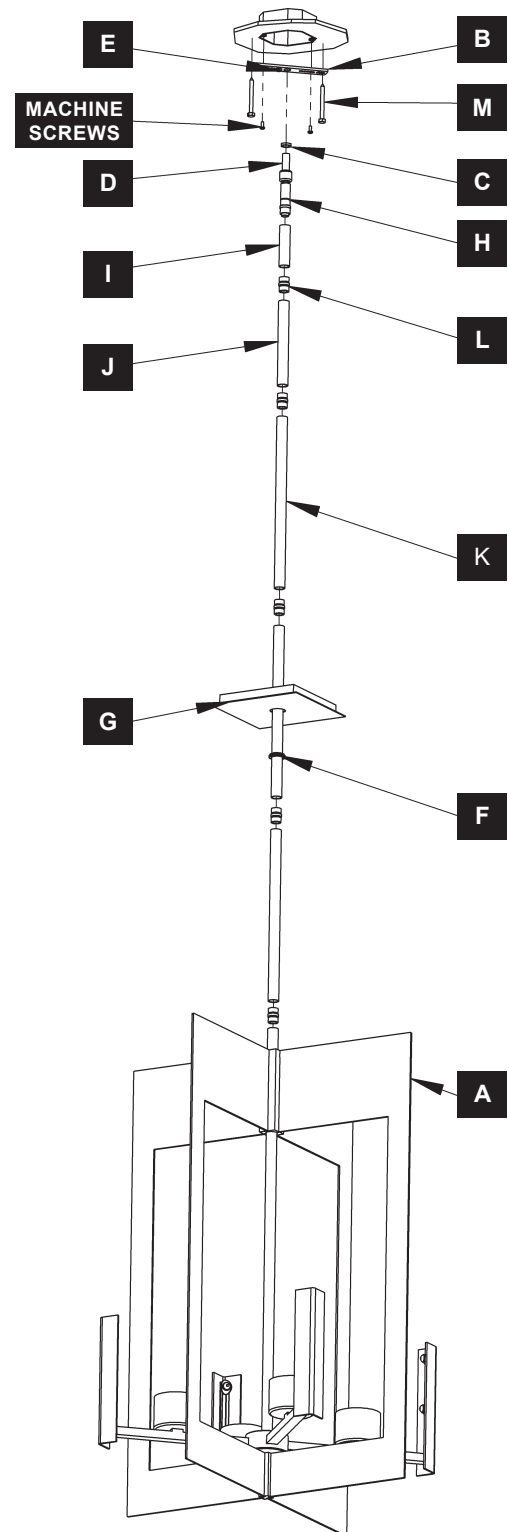

(Figure 1)



HUBBARDTON FORGE.

MODERN AMERICAN BLACKSMITHS | FINE, HAND CRAFTED LIGHTING
CASTLETON, VERMONT USA | HUBBARDTONFORGE.COM

58415

4 OF 6

ASSEMBLY & INSTALLATION INSTRUCTIONS

A1039

Summit Lantern 132043

To Install Glass (Figure 2)

1. Carefully unpack outer glass (N).
2. Remove knurled ball (P), bent washer (Q), and rubber washer (R) from threaded studs.
3. Place glass (N) onto fixture (A) and behind front plate. Slide glass (N) over threaded studs.
4. Place rubber washer (R) over threaded stud, followed by bent washer (Q). Thread knurled ball (P) onto stud to secure glass.
- NOTE:** Be careful not to over tighten knurled ball as this could break glass.
5. Repeat for remaining glass (N), washers (R,Q) and knurled balls (P).
6. Follow steps on next page to complete installation.

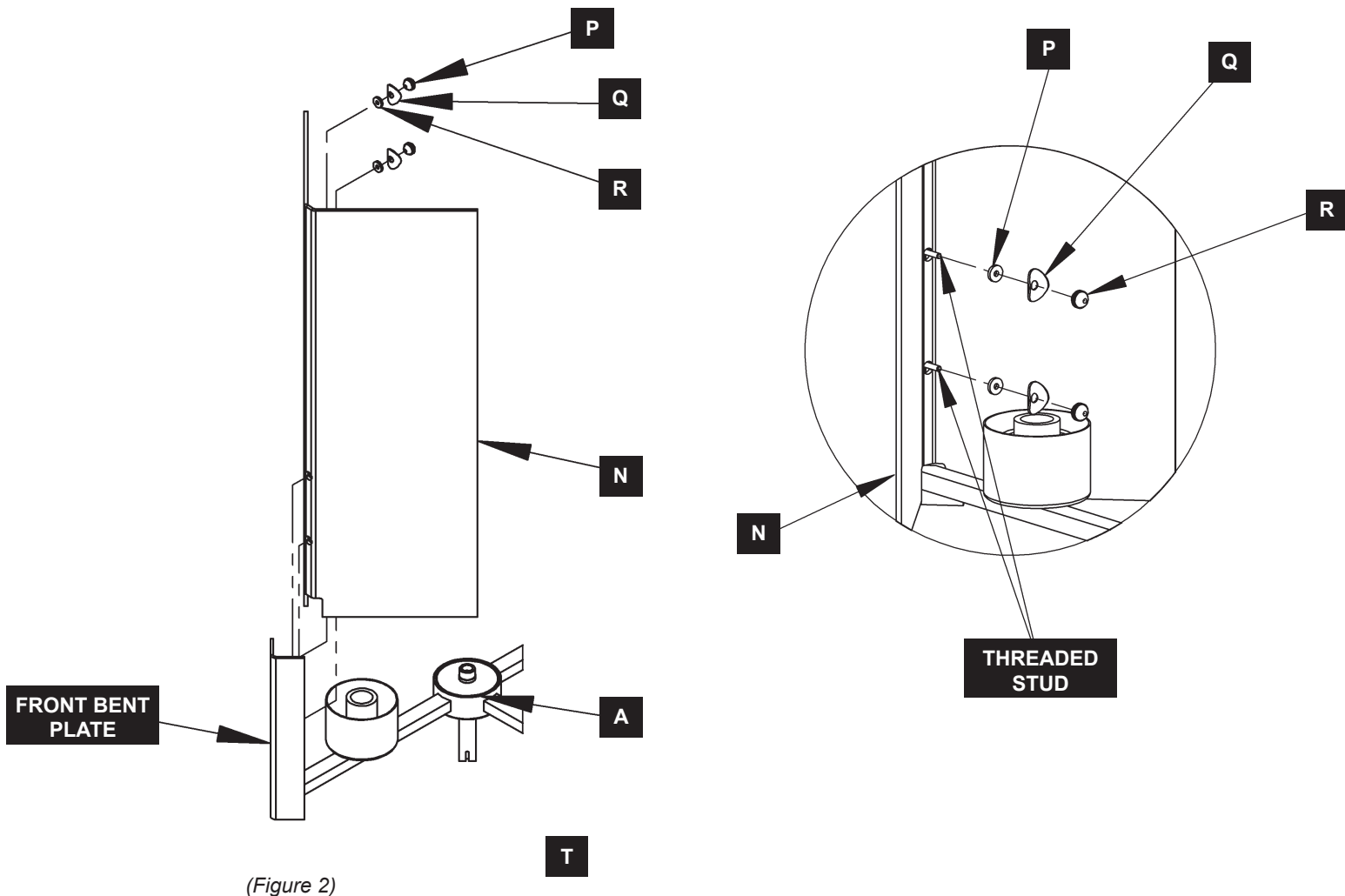

HUBBARDTON FORGE.

MODERN AMERICAN BLACKSMITHS | FINE, HAND CRAFTED LIGHTING
CASTLETON, VERMONT USA | HUBBARDTONFORGE.COM

58415

5 OF 6

Summit Lantern 132043

To Complete Install (Figure 3)

1. Carefully unpack inner glass (O).
2. Install bulb (U), *not provided*, into socket (T).
3. Slide o-ring (S) onto the open end of glass (O). One or two may be used to hold the glass securely.
4. Slide glass (O) over bulb (U) and into cup. Continue to press glass (O) into cup until o-ring (S) is inside cup and glass (O) has bottomed out.
5. Repeat for remaining bulbs and glass.
6. Restore electricity at main breaker.

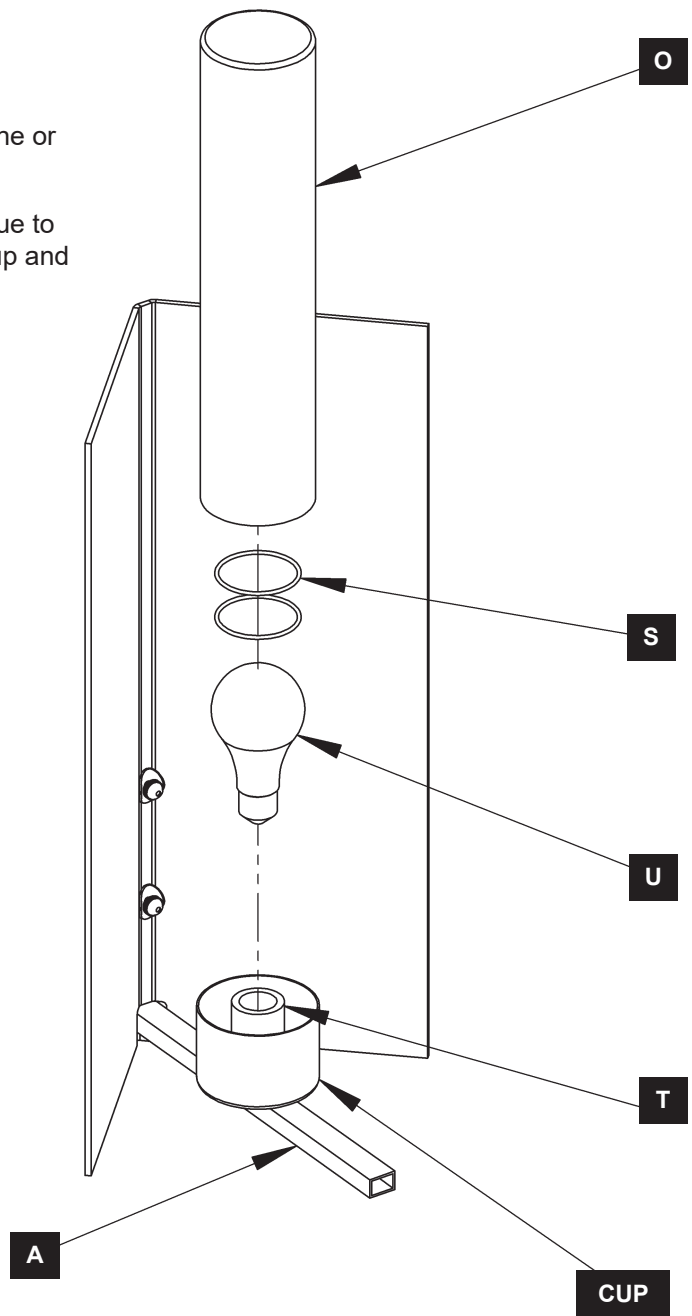

(Figure 3)

If you need further assistance, or find that you are missing any parts, please contact the dealer from which you purchased this product.
We hope you enjoy your fixture!

*** Hubbardton Forge will not be liable for injury or damage caused by improper installation, lamping or use of this fixture.**



HUBBARDTON FORGE.

MODERN AMERICAN BLACKSMITHS | FINE, HAND CRAFTED LIGHTING
CASTLETON, VERMONT USA | HUBBARDTONFORGE.COM