



ASSEMBLY & INSTALLATION INSTRUCTIONS

CAUTION: FAILURE TO INSTALL THIS FIXTURE PROPERLY MAY RESULT IN SERIOUS PERSONAL INJURY OR DEATH AND PROPERTY DAMAGE. We recommend installation by a licensed electrician. This product must be installed in accordance with applicable installation code(s), by a person familiar with the construction and operation of the product and the hazards involved.*

Caution: Do not exceed 60 watt bulbs for this fixture. Use only recommended bulbs with fixture.

INSTALL FIXTURE

CAUTION: BE SURE POWER IS OFF AT THE MAIN BREAKER BOX PRIOR TO INSTALLATION.

CAUTION: INSTALLATION REQUIRES 2 PEOPLE

1. Carefully unpack all items from the upper section of the crate. In the upper section you will find:

- Canopy/Gripper Plate Assembly
- Hardware Kit
- Cables
- Canopy Cover Plate

CAUTION: DO NOT REMOVE GLASS FROM BOXES OR STICKERS FROM THE FIXTURE. LABELING OF THESE PIECES IS CRITICAL TO A SUCCESSFUL INSTALL.

2. Locate the canopy/gripper plate assembly.

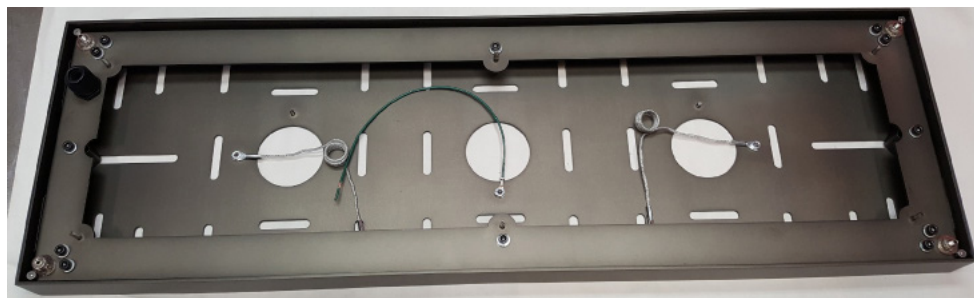

CANOPY GRIPPER PLATE ASSEMBLY

3. Unscrew (12) 1/4-20 screws and (4) 8-32 shoulder bolts. Remove bolts, screws and lockwashers and retain for later use.

ASSEMBLY & INSTALLATION INSTRUCTIONS

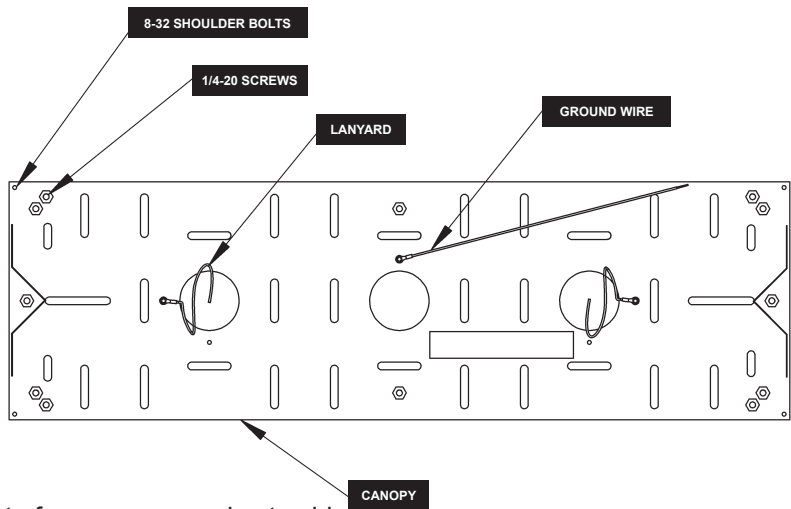

4. Separate gripper plate from canopy and set aside.



5. Thread the wires in the electrical box through one of the center holes in the canopy.

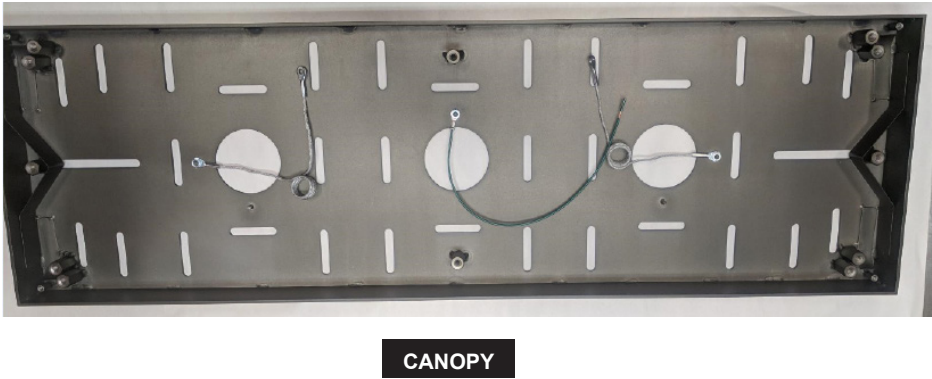

ASSEMBLY & INSTALLATION INSTRUCTIONS

CAUTION: THIS FIXTURE IS VERY HEAVY. INDIVIDUAL BUILDING AND STRUCTURAL CONDITION PRESENT UNIQUE REQUIREMENTS AND CONSULTATION WITH A STRUCTURAL ENGINEER IS STRONGLY RECOMMENDED. DRILLING ADDITIONAL HOLES FOR MOUNTING SCREWS MAY BE REQUIRED.

6. Attach canopy to solid framing member in at least 6 places, distributing the load evenly. It may be necessary to add additional framing members to adequately and evenly support this heavy fixture. We've supplied 5/16" x 2 1/2" lag screws with your fixture, however, different materials and/or construction methods may require different fasteners.
7. Unpack fixture from the middle section of the crate.
8. Move fixture into place under canopy. Orient fixture in desired position regarding cloth covered supply wires.
9. Thread (4) cables into fixture cable mounting block.

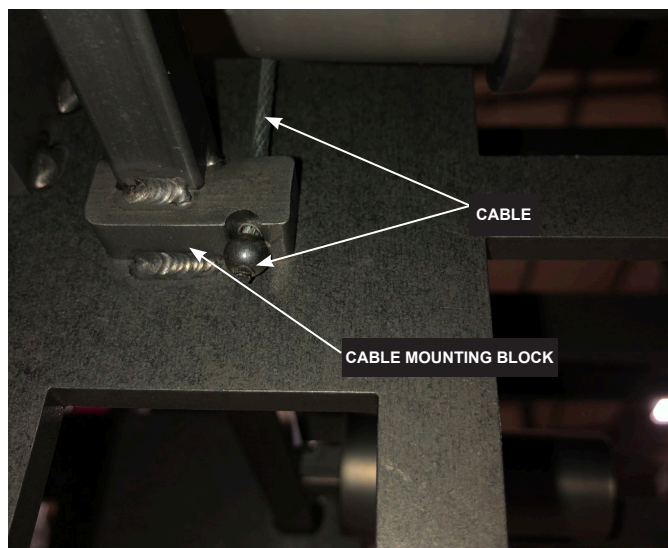

10. Locate canopy cover plate, Orient plate with screws pointing up. Feed (4) cables and (1) cloth covered supply wire through canopy cover plate. Place a protective layer on top of the fixture, to prevent scratching. Rest canopy cover plate on top of the protective layer on the fixture.



ASSEMBLY & INSTALLATION INSTRUCTIONS

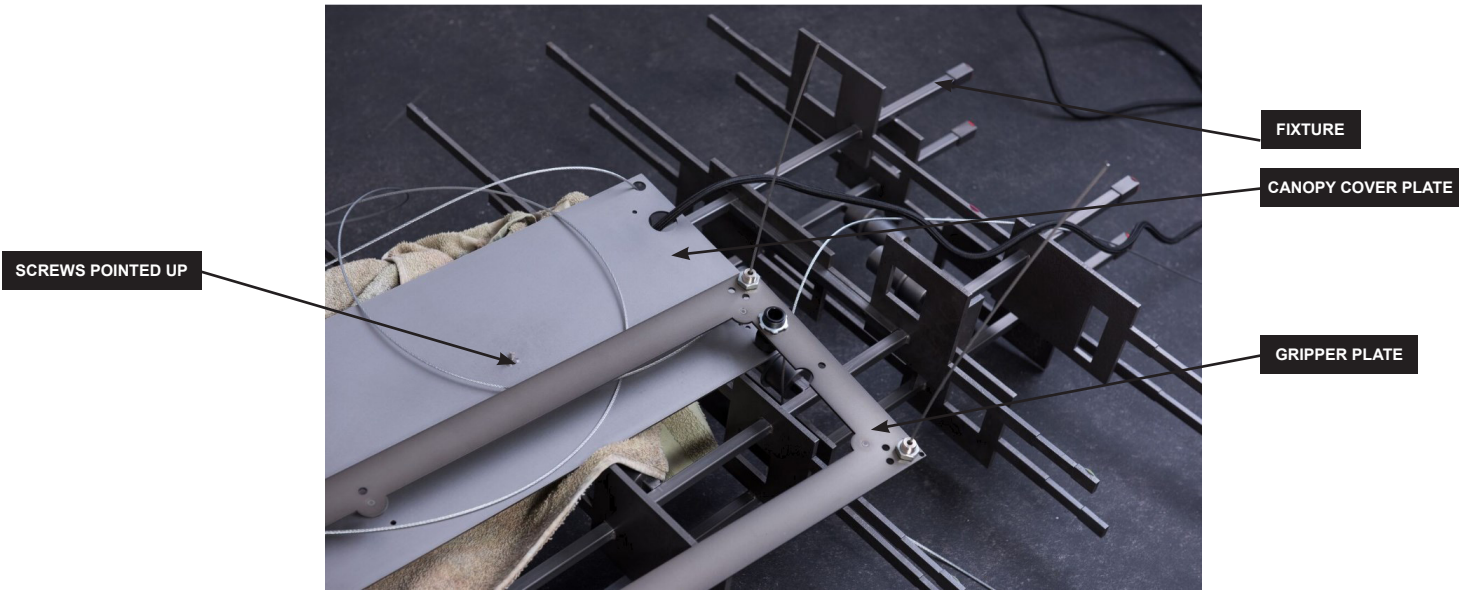

- 11. Locate gripper plate.
- 12. Orient gripper plate so that studs and the knurled side of the cable grippers are facing down.
- 13. Loosen nuts on strain relief and cable grippers.

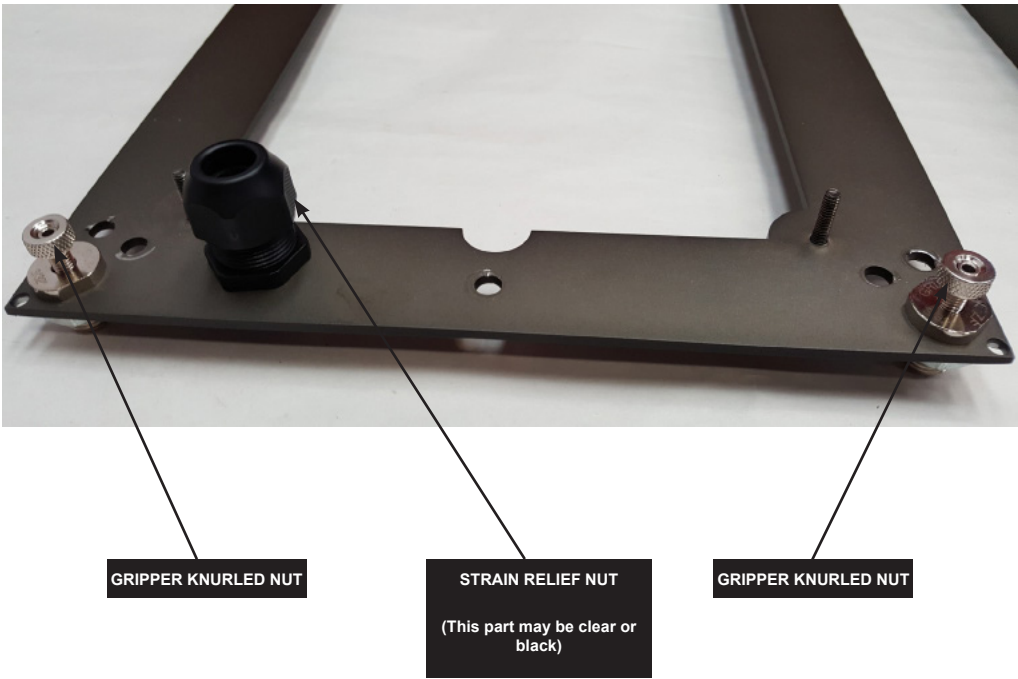

ASSEMBLY & INSTALLATION INSTRUCTIONS

14. Feed cables through grippers. Feed the cloth covered supply wire through the strain relief.



15. Attach gripper plate to the canopy using lockwashers, 1/4-20 screws and 8-32 shoulder bolts.

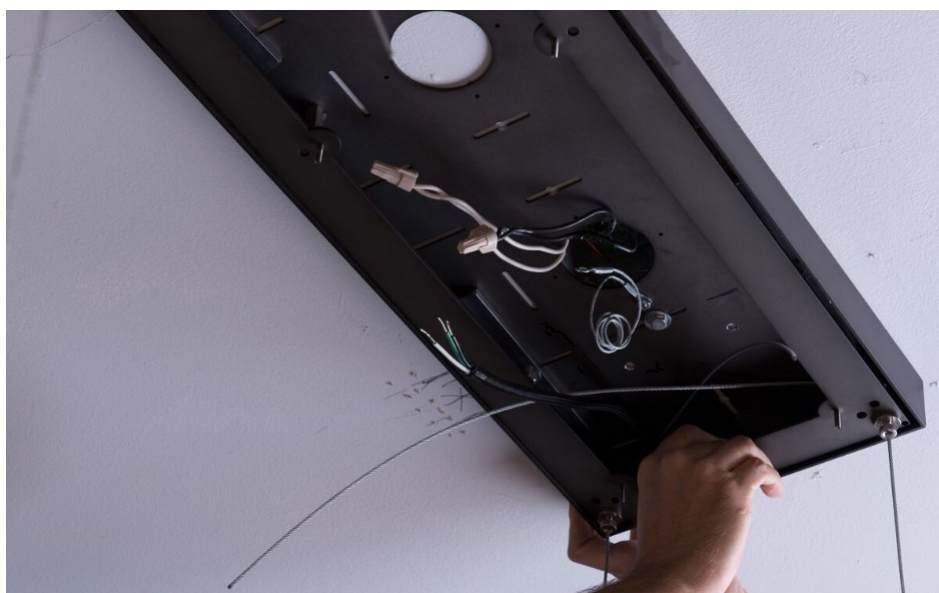

ASSEMBLY & INSTALLATION INSTRUCTIONS

16. Unscrew (2) 8-32 nuts from the canopy cover plate.
17. Raise canopy cover plate and attach lanyards to the studs. Secure with the 8-32 nuts.



CAUTION: LIFTING OF FIXTURE REQUIRES 2 PEOPLE

18. Lift fixture and push cables into grippers. Raise fixture to desired height.
19. Gently apply downward pressure to fixture to help set cable tension.
20. Level fixture and balance tension between all 4 cables. Fixture can be lowered by supporting fixture and then pressing in plunger on gripper and allowing cables to slide out.

CAUTION: HEIGHT AND LEVEL OF FIXTURE MAY NOT BE ADJUSTED AFTER THIS POINT. GLASS MUST BE REMOVED BEFORE ADJUSTING FIXTURE HEIGHT.

21. Tighten nuts on strain relief and cable grippers. Be sure fixture is supported by the cables not the cloth covered supply wire. For best appearance, push cloth covered supply wire up into the canopy until it is taut.
22. Using suitable wire connectors (not provided), connect fixture wires to supply wires (white to white and black to black). Connect all ground wires (bare copper or green to bare copper or green) together.

Caution: Make sure wire connectors are twisted on securely and no bare wires are exposed.

23. The ground wire is shipped to you installed near the center opening. The ground wire can be moved to the stud near either of the other two openings if necessary.

ASSEMBLY & INSTALLATION INSTRUCTIONS

24. This fixture uses 63 pieces of glass. Each piece of glass is boxed individually and labeled with a part number. Each piece of glass also has a blue dot placed on it. The dot will be used to help in describing glass orientation in these instructions. Each piece of glass has a glossy side and a matte side. The blue dot has been placed on the glossy side.
25. The fixture has been labeled to help with glass installation. Each arm is numbered and/or labeled with letters indicating where the glass is to be installed.

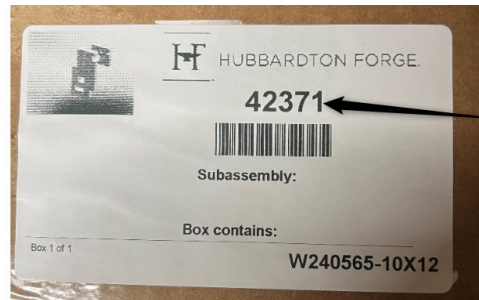

GLASS PART NUMBER

SAMPLE LABEL

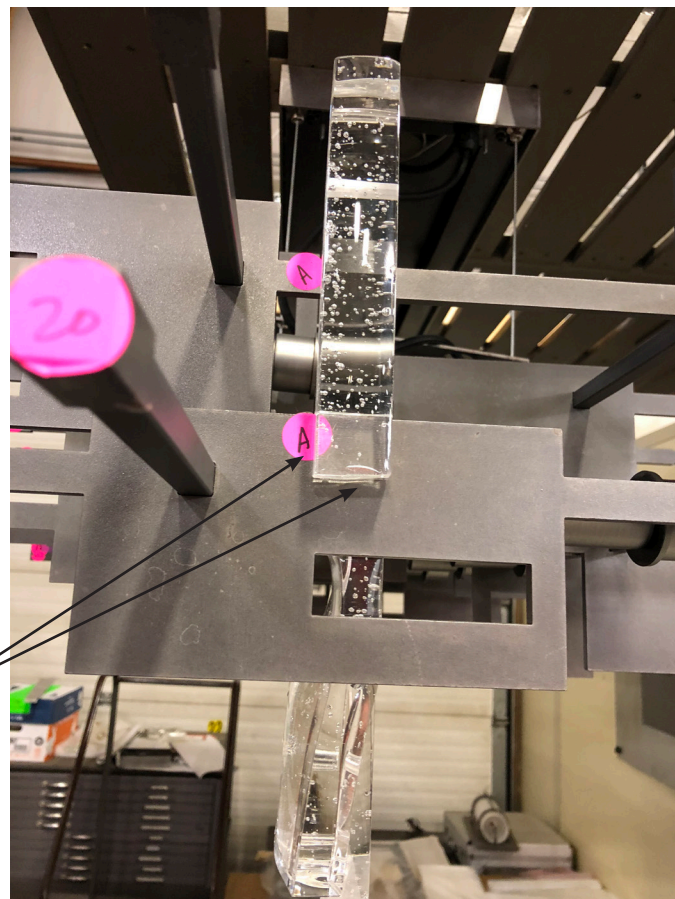

LABEL INDICATES LOCATION OF GLASS

26. Utilizing the chart on page 9 and the pictures following, follow the steps to install the glass. The pictures show the glass orientation as well as the arm of the fixture that the glass is to be placed. The labels on the fixture also indicate where the glass is to be located.

ASSEMBLY & INSTALLATION INSTRUCTIONS

GLASS PART NUMBERS AND QUANTITIES

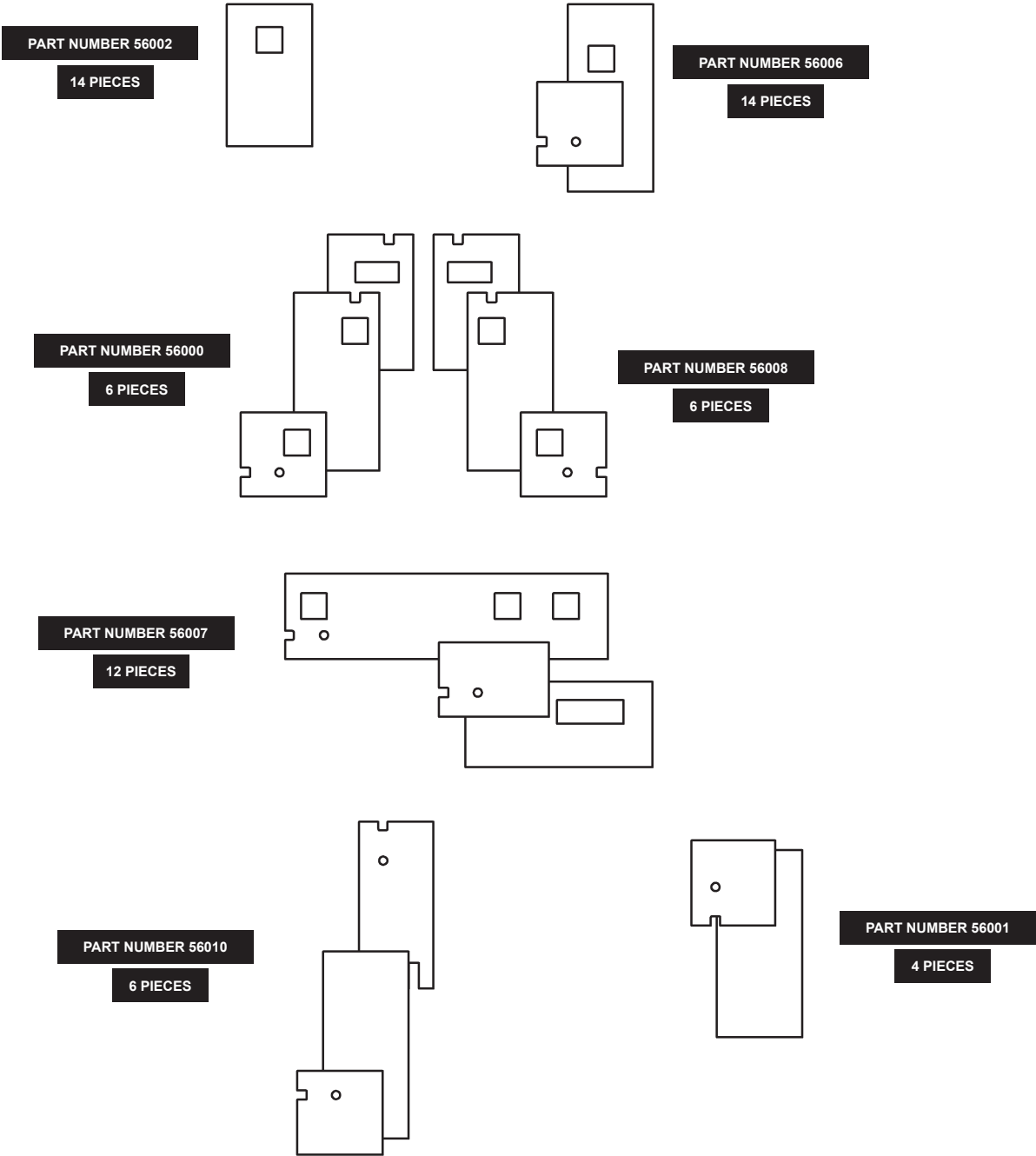

ASSEMBLY & INSTALLATION INSTRUCTIONS

Step	Glass Part Number	Orientation	Location	Picture
1	56001	Longer Edge on Socket Side	G	Page 10
2	56001	Longer Edge on Socket Side	H	
3	56001	Longer Edge on Socket Side	I	
4	56001	Longer Edge on Socket Side	J	
5	56010	Hooks on one plate - leans to the other	A+A	Pages 11 & 12
6	56010	Hooks on one plate - leans to the other	B+B	
7	56010	Hooks on one plate - leans to the other	C+C	
8	56010	Hooks on one plate - leans to the other	D+D	
9	56010	Hooks on one plate - leans to the other	E+E	
10	56010	Hooks on one plate - leans to the other	F+F	
10a	install all light bulbs			
11	56007	Blue dot (Glossy) Side Out	42, 44	Page 12
12	56006	Blue dot (Glossy) Side Out	42	
13	56007	Blue dot (Glossy) Side Out	41, 43, 44	Page 13
14	56007	Blue dot (Glossy) Side Out	19, 21, 22	
15	56007	Blue dot (Glossy) Side In	20, 22	
16	56006	Blue dot (Glossy) Side Out	22	
17	56002		20	
18	56006	Blue dot (Glossy) Side Out	39	Page 14
19	56002		37	
20	56002		36	
21	56002		35	
22	56006	Blue dot (Glossy) Side In	34	
23	56002		30	
24	56000	Left Hand, Blue Dot (Glossy) Side Out, Rectangle Hole Upper Right Corner	27, 28	Page 15
25	56006	Blue dot (Glossy) Side In	23	
26	56006	Blue dot (Glossy) Side Out	18	
27	56002		16	
28	56002		13	
29	56006	Blue dot (Glossy) Side Out	10	
30	56002		7	Page 16
31	56008	Right Hand, Blue Dot (Glossy) Side Out, Rectangular Hole Upper Left Corner	5, 6	
32	56006	Blue dot (Glossy) Side Out	2	
33	56007	Blue dot (Glossy) Side Out	33, 35	
34	56000	Left Hand, Blue Dot (Glossy) Side Out, Rectangular Hole Lower Left Corner	31, 32	
35	56006	Blue dot (Glossy) Side In	26	
36	56007	Blue dot (Glossy) Side Out	12, 14	Page 17
37	56008	Right Hand, Blue Dot (Glossy) Side Out, Rectangular Hole Lower Right Corner	9, 10	
38	56007	Blue dot (Glossy) Side Out	4, 6	
39	56006	Blue dot (Glossy) Side In	40	
40	56007	Blue dot (Glossy) Side In	35, 36, 38	
41	56007	Blue dot (Glossy) Side In	29, 30, 32	
42	56007	Blue dot (Glossy) Side Out	25, 27	Page 18
43	56008	Right Hand, Blue Dot (Glossy) Side In, Rectangular Hole Lower Left Corner	23, 24	
44	56000	Left Hand, Blue Dot (Glossy) Side In, Rectangular Hole Lower Right Corner	17, 18	
45	56006	Blue dot (Glossy) Side Out	15	
46	56007	Blue dot (Glossy) Side Out	9, 11, 12	
47	56007	Blue dot (Glossy) Side Out	5, 7, 8	
48	56008	Right Hand, Blue Dot (Glossy) Side Out, Rectangular Hole Lower Right Corner	1, 2	Page 19
49	56008	Right Hand, Blue Dot (Glossy) Side In, Rectangular Hole Lower Left Corner	39, 40	
50	56006	Blue dot (Glossy) Side Out	37	
51	56002		36	
52	56000	Left Hand, Blue Dot (Glossy) Side Out, Rectangle Hole Upper Right Corner	33, 34	
53	56002		28	
54	56008	Right Hand, Blue Dot (Glossy) Side In, Rectangle Hole Upper Right Corner	25, 26	Page 20
55	56002		23	
56	56002		18	
57	56006	Blue dot (Glossy) Side In	16	
58	56000	Left Hand, Blue Dot (Glossy) Side In, Rectangle Hole Upper Left Corner	13, 14	
59	56002		10	
60	56006	Blue dot (Glossy) Side Out	8	Page 21
61	56000	Left Hand, Blue Dot (Glossy) Side in, Rectangular Hole Lower Right Corner	5, 6	
62	56006	Blue dot (Glossy) Side Out	3	
63	56002		2	

ASSEMBLY & INSTALLATION INSTRUCTIONS

REFERENCE STEPS 1-4

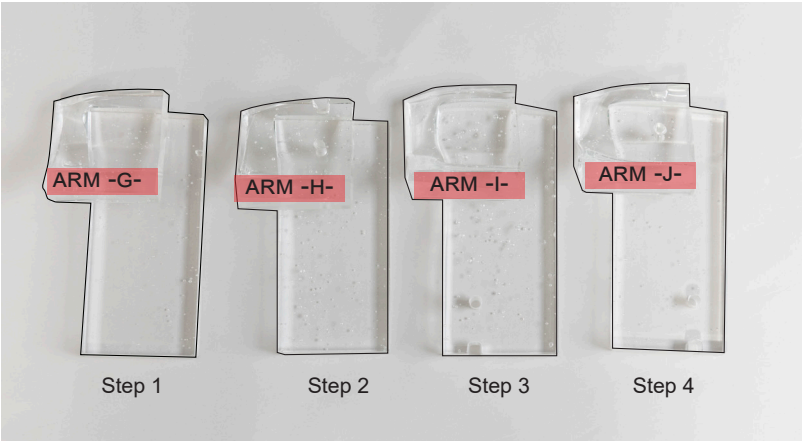
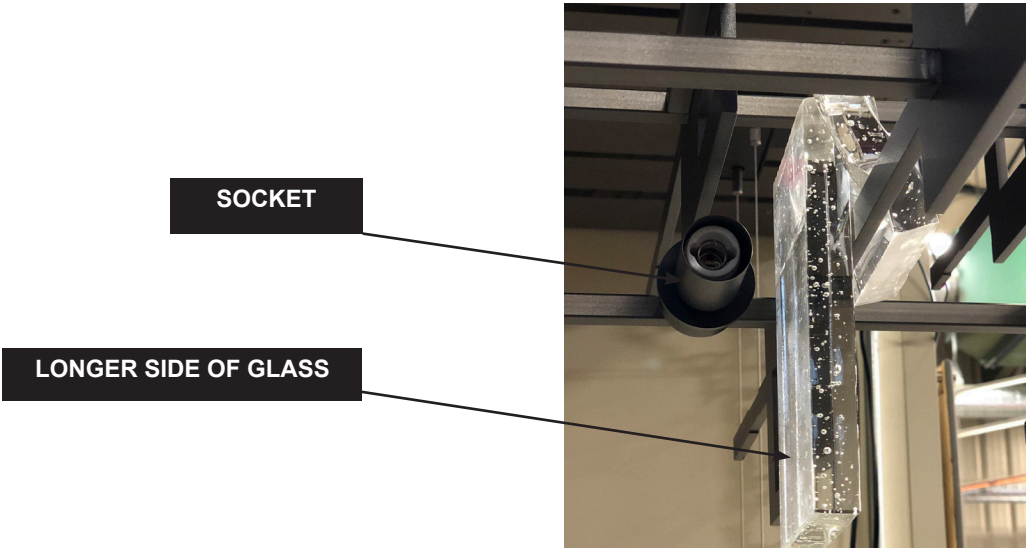

ASSEMBLY & INSTALLATION INSTRUCTIONS

REFERENCE STEPS 5-10



ANGLE THE GLASS
AND SLIDE IT UP
BETWEEN THE TWO
BARS



LONG EDGE OF GLASS
RESTS AGAINST THIS
BAR

NOTCH IN GLASS SITS
ON THIS BAR

ASSEMBLY & INSTALLATION INSTRUCTIONS

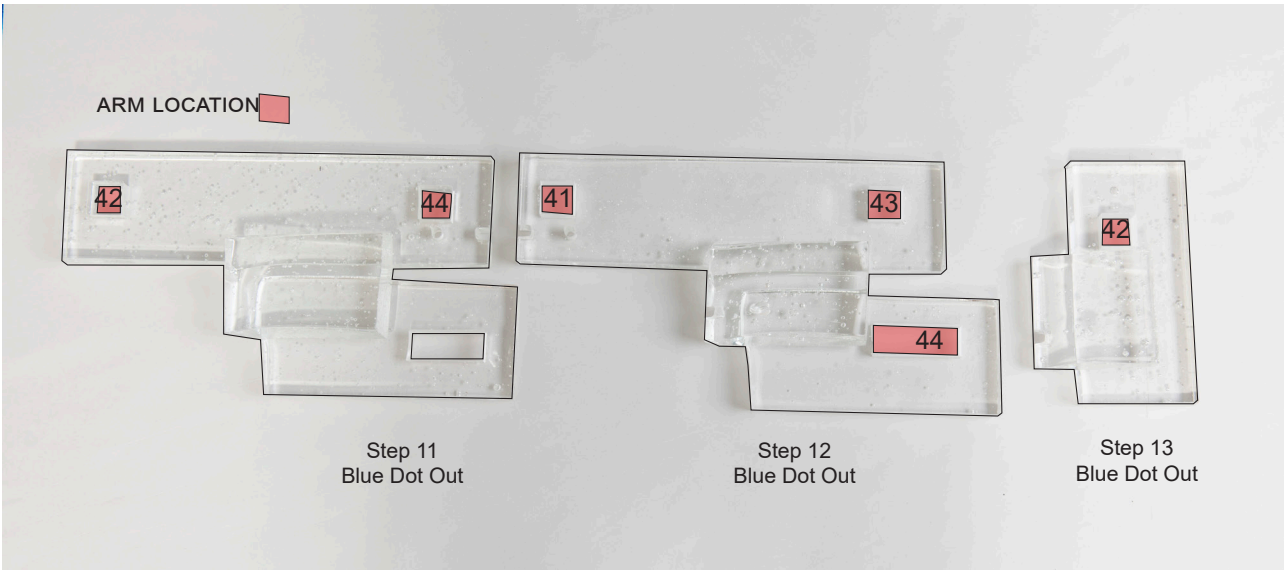
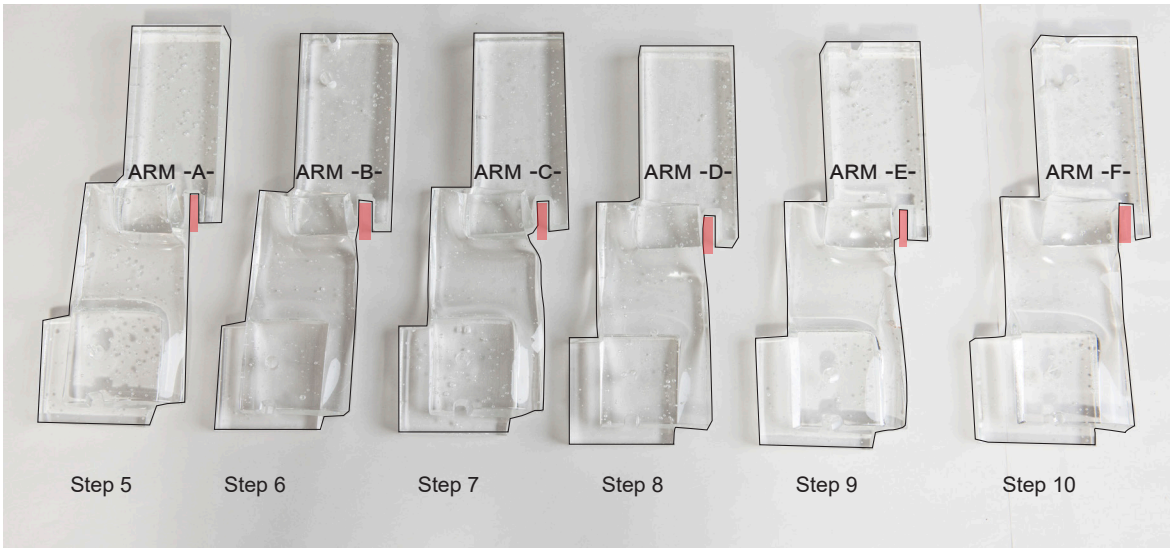

ASSEMBLY & INSTALLATION INSTRUCTIONS

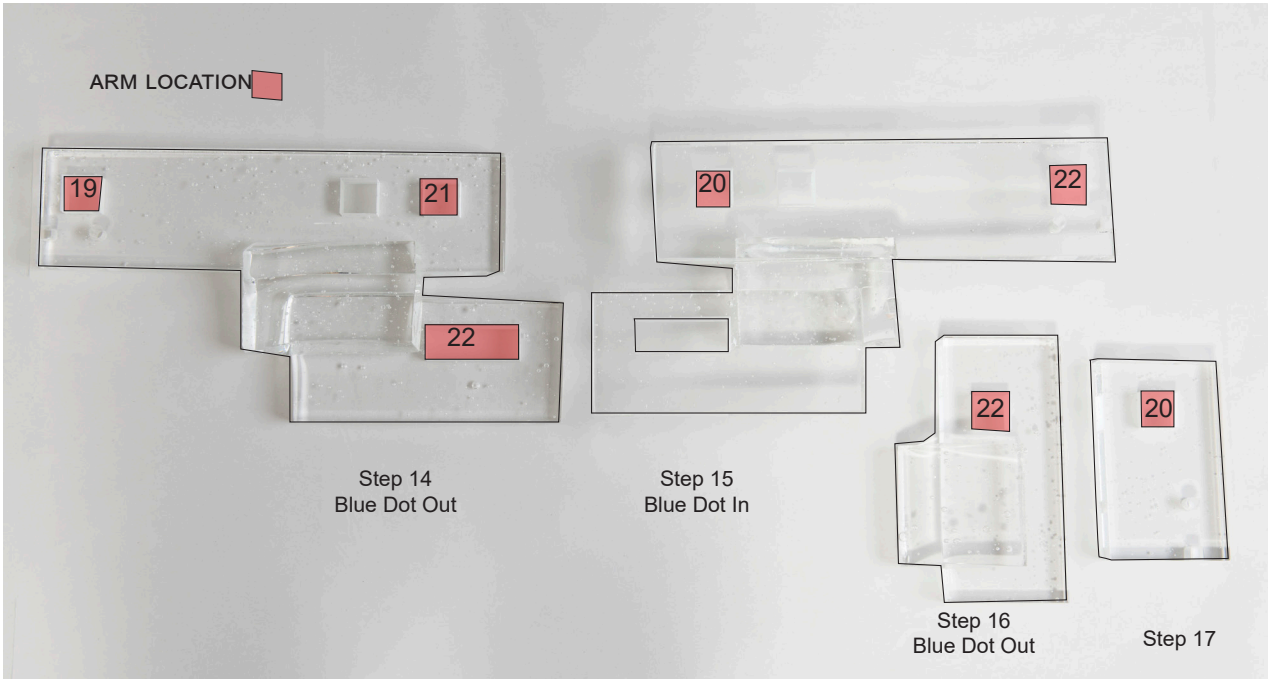

ASSEMBLY & INSTALLATION INSTRUCTIONS

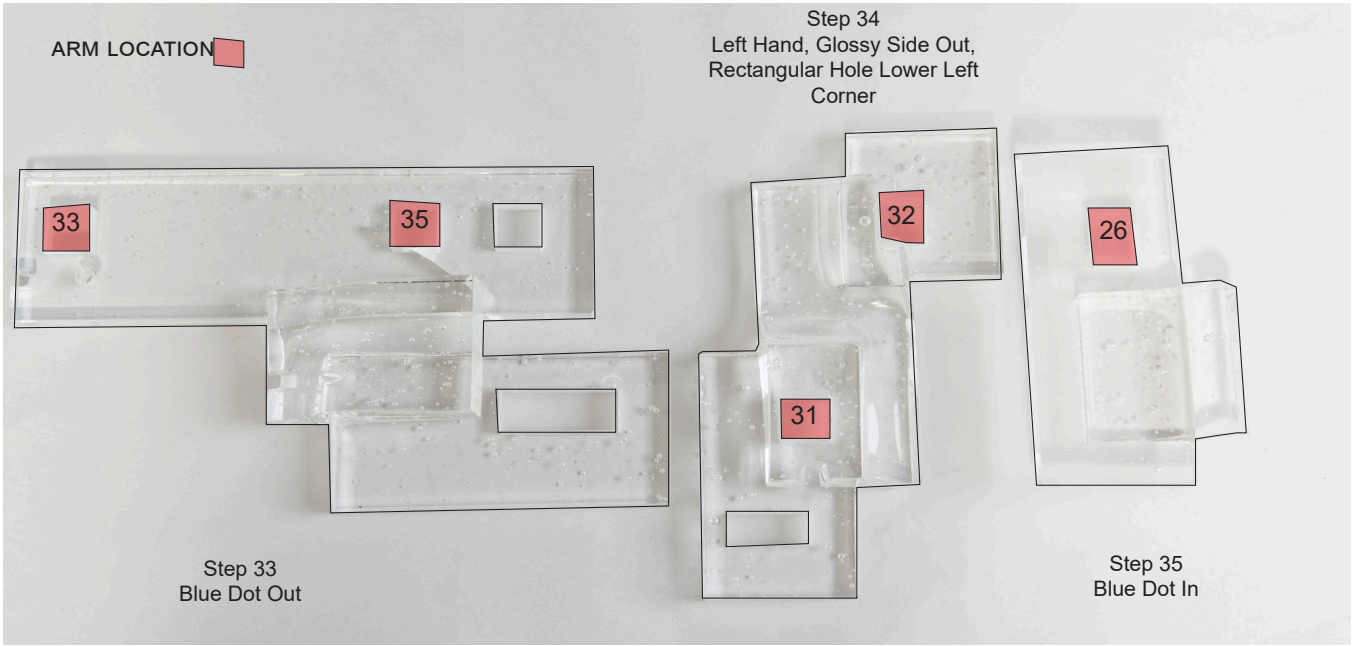

ASSEMBLY & INSTALLATION INSTRUCTIONS

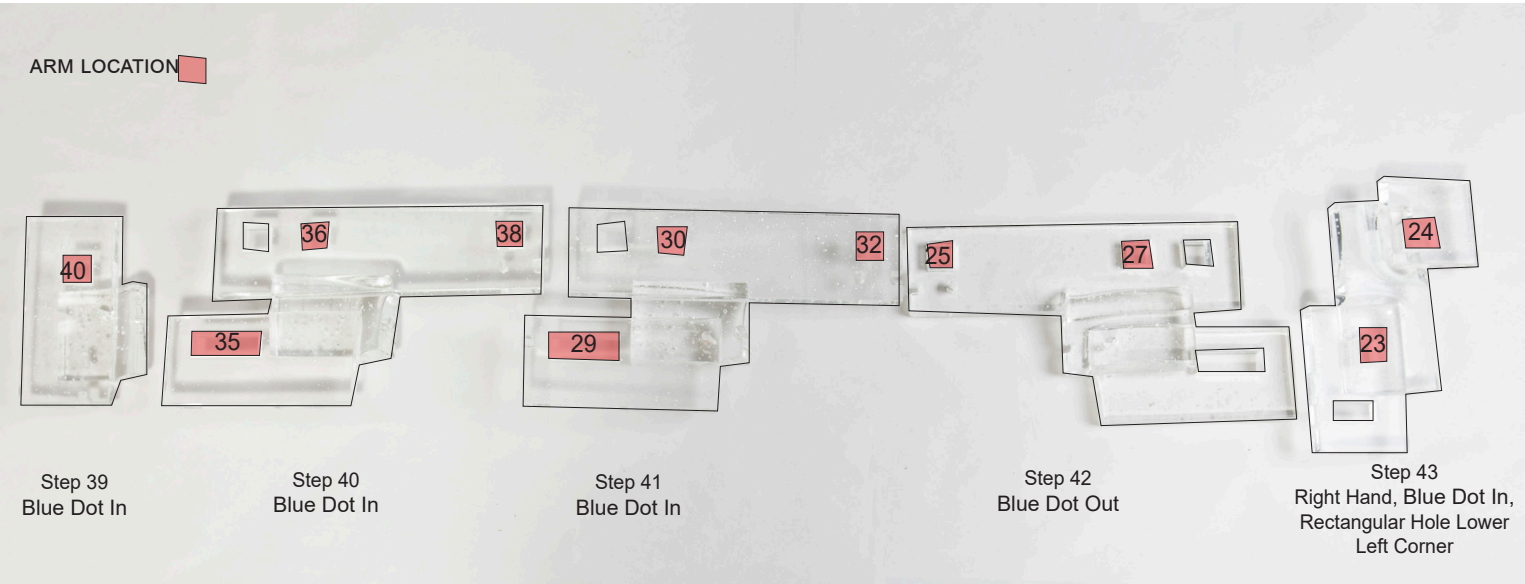
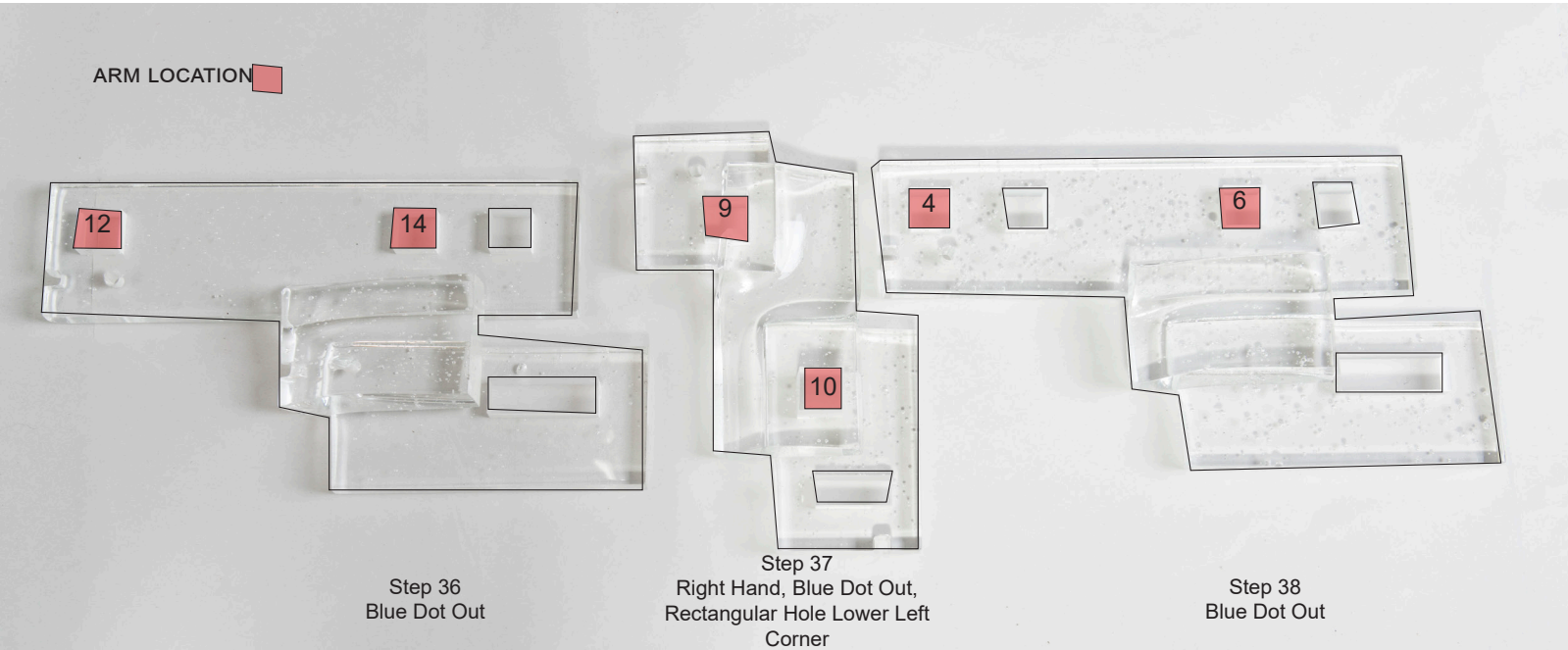

ASSEMBLY & INSTALLATION INSTRUCTIONS



ASSEMBLY & INSTALLATION INSTRUCTIONS

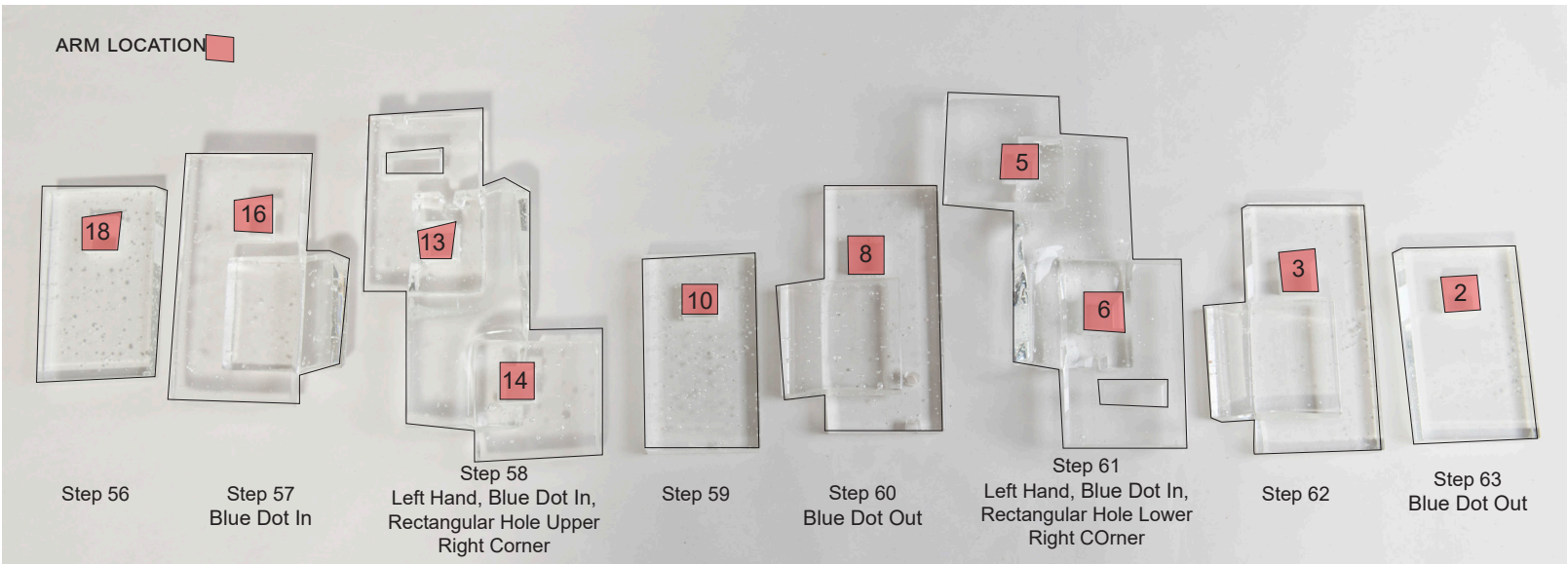

- 27. Gripper knurled nuts may have loosened during glass installation. Re-check that gripper knurled nuts are tight.
- 28. Attach canopy cover plate using the (6) barrel nuts.
- 29. Restore electricity at main breaker.

If you need further assistance, or find that you are missing any parts, please contact the dealer from which you purchased this product. We hope you enjoy your fixture!
**ART+ALCHEMY will not be liable for injury or damage caused by improper installation, lamping or use of this fixture.*