

IMPORTANT

Safety, Warning and Suggestions

1. Qualified electrician is required to install this product/s.
2. Please read instructions carefully before installation.
3. All wiring and installations should meet local, state and national electrical codes.
4. Install correct lamp type and wattage.

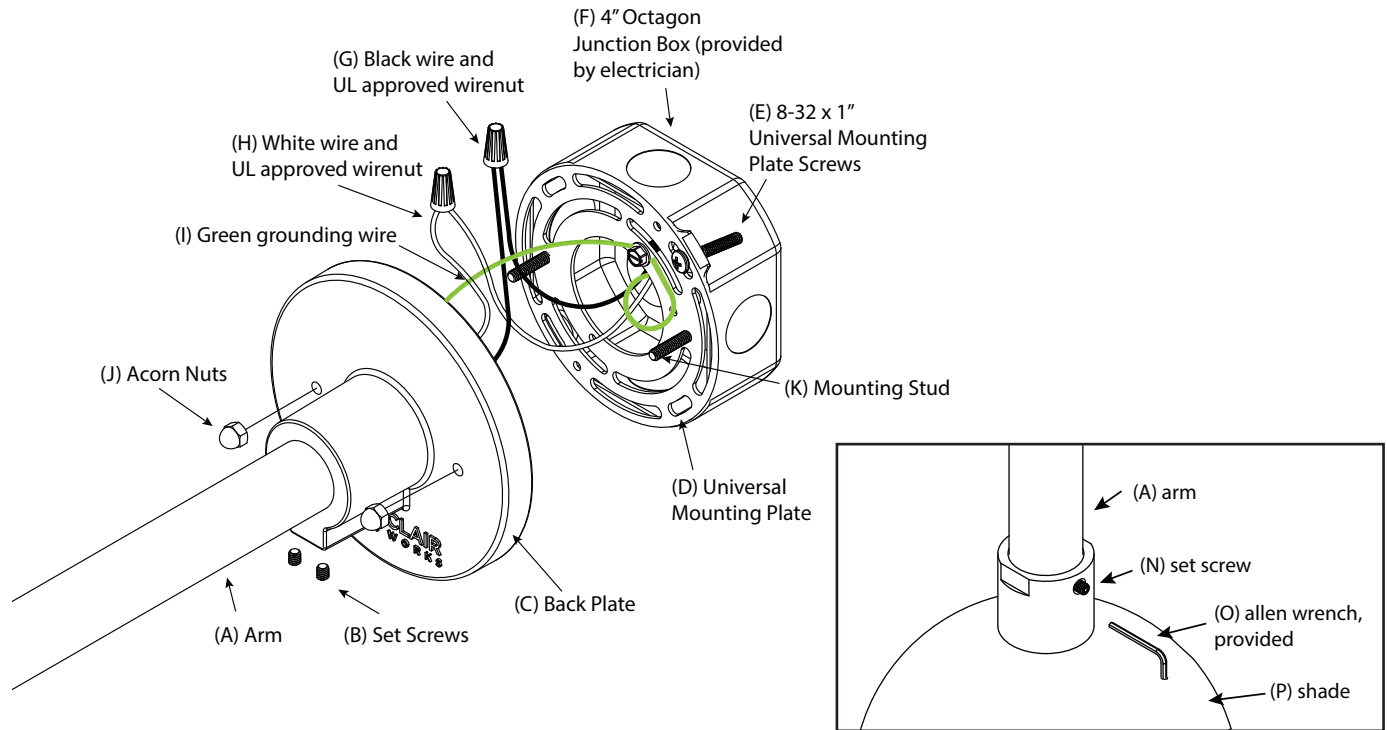

1. **Prior to installation, disconnect power at main electrical box.**
2. Feed lead wires through arm (A) and slide shade (P) onto arm (A). Tighten set screw (N) with allen wrench (O) provided.
3. If Decorative Back Plate Cover was ordered, slide over arm (A).
4. Place arm (A) into Back Plate (C) and tighten set screws (B) using allen wrench (O) provided.
5. Attach Universal Mounting Plate (D) to 4" Octagon junction box (F) using 8-32 x 1" Universal Mounting Plate screws (E).
6. Connect wires (green grounding wire (I) to bare copper pigtail, black to black (G) and white to white (H) using provided UL approved wirenuts. Carefully push wires into junction box (F) through center hole on Universal Mounting Plate.
7. Apply a bead of silicone sealant, provided by others, around junction box.
8. Slide Back Plate (C) with arm assembly onto Mounting Studs (K) and attach with Acorn Nuts (J) provided. Tighten nuts evenly to assure proper seal.
9. With cast back plate mounted, loosen set screws (B), adjust arm to correct position and re-tighten set screws. Use Loctite for most secure connection.
10. If ordered, place optional Decorative Back Plate Cover over Back Plate (B) and tighten set screw using allen wrench (O) provided.