

ASSEMBLY INSTRUCTIONS

Option 1: Canopy Mounted Driver

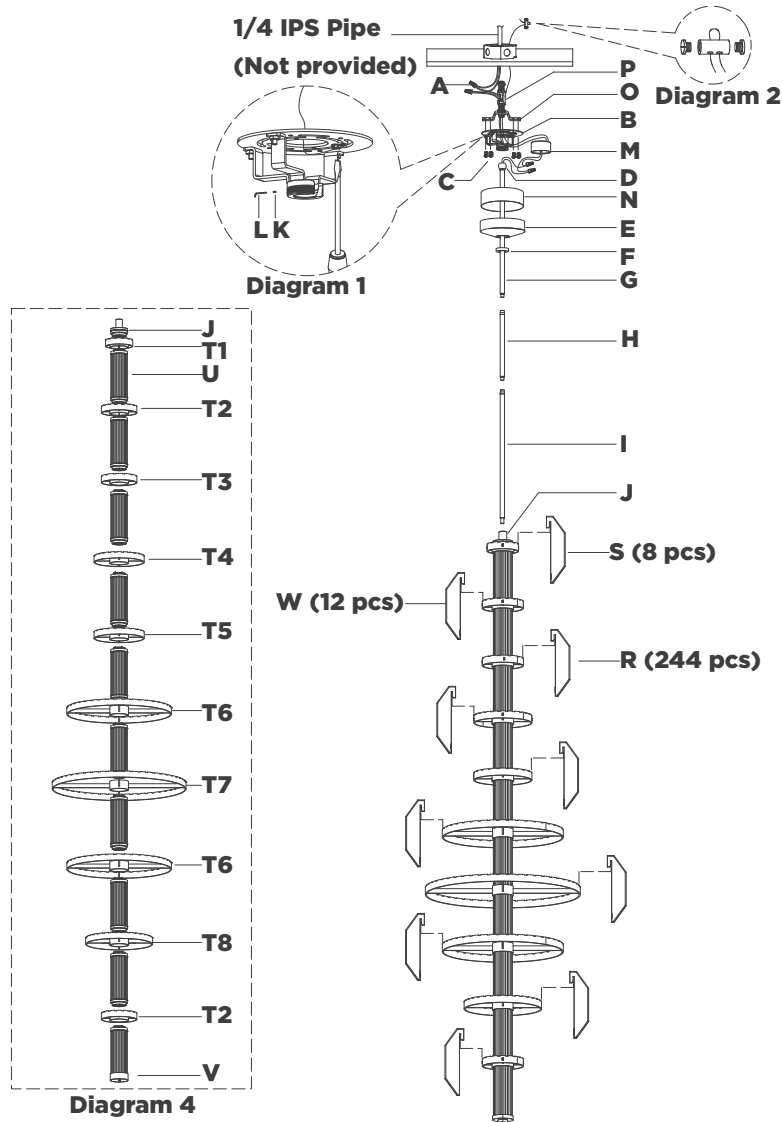

Killarney 19" Layered Entry Chandelier

Item # WF5020

NOTICE:

This light fixture should be installed in accordance with all applicable, local installation codes, and by a person familiar with the construction and operation of it, as well as the hazards involved. Inspect item and contents carefully. If any damage or defect is found, do not install. Retain all packaging material until installation is complete and approved.

TOOLS REQUIRED (NOT INCLUDED):

Phillips Screwdriver	Slotted Screwdriver	Wire Strippers
Slip Joint Pliers	Measuring Tape	Chain Pliers
Wire Cutters		

PERSONS REQUIRED: Two

- Carefully remove all parts from the box. Place on a clean, soft surface.
- Remove canopy (**E**) and driver housing (**N**) from from mounting plate (**B**) by removing collar ring (**F**).
- Remove mounting bracket (**O**) from mounting plate (**B**) by removing screws (**C**).
- Remove hickey (**P**) from mounting bracket (**O**) by removing hex nut.
- It is recommended to install a 1/4 IPS threaded pipe, secured to a structural member of the building. Then install hickey (**P**) into threaded pipe and tighten with wrench.
NOTE: Item must be supported independent of the junction box due to hanging weight.
- Install threaded nipple to hickey (**P**), then install mounting bracket (**O**) to threaded nipple by tightening locknut.
- Install mounting plate (**B**) to mounting bracket (**O**) and secure with screws (**C**).

WATERFORD

IRELAND 1783



ASSEMBLY INSTRUCTIONS

Option 1: Canopy Mounted Driver

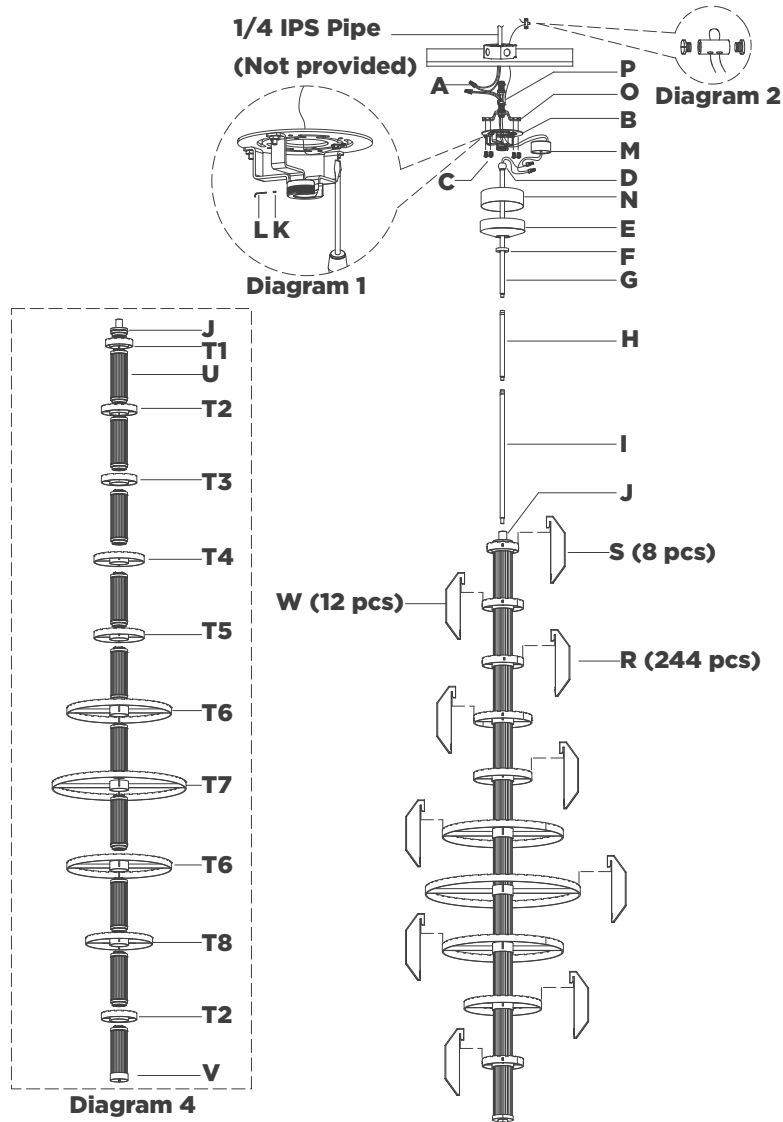

Killarney 19" Layered Entry Chandelier

Item # WF5020

NOTICE:

This light fixture should be installed in accordance with all applicable, local installation codes, and by a person familiar with the construction and operation of it, as well as the hazards involved. Inspect item and contents carefully. If any damage or defect is found, do not install. Retain all packaging material until installation is complete and approved.

8. Feed electrical wires through bottom rod (**I**) and connect to fixture body (**J**). Repeat for middle rod (**H**), connecting to bottom rod (**I**).
 9. Continue feeding wires through collar ring (**F**), canopy (**E**), driver housing (**N**) and top rod (**G**).
 10. Holding fixture upright, slide collar ring (**F**), canopy (**E**) and driver housing (**O**) down and rest on fixture body. Then connect top rod (**G**) to middle rod (**H**).
- NOTE:** Slide components down slowly to avoid damage.
11. Hang fixture swivel ball (**D**) to the center of metal part (**B**) and secure with set screw (**K**) using provided screwdriver (**L**) (see diagram 1).
 12. Cut excess wires, being sure to leave enough to reach the junction box. Separate wires and strip insulation on each 5/8".
 13. Loosen cable lock and install to end of safety cable. Run safety cable through junction box and around structural member of building. Insert cable through cable lock and tighten the ends with a screwdriver to secure (see diagram 2).
 14. Connect fixture neutral wire (black) to driver (**M**) output wire (black) using wire nut (**A**).

WATERFORD

IRELAND 1783



ASSEMBLY INSTRUCTIONS

Option 1: Canopy Mounted Driver

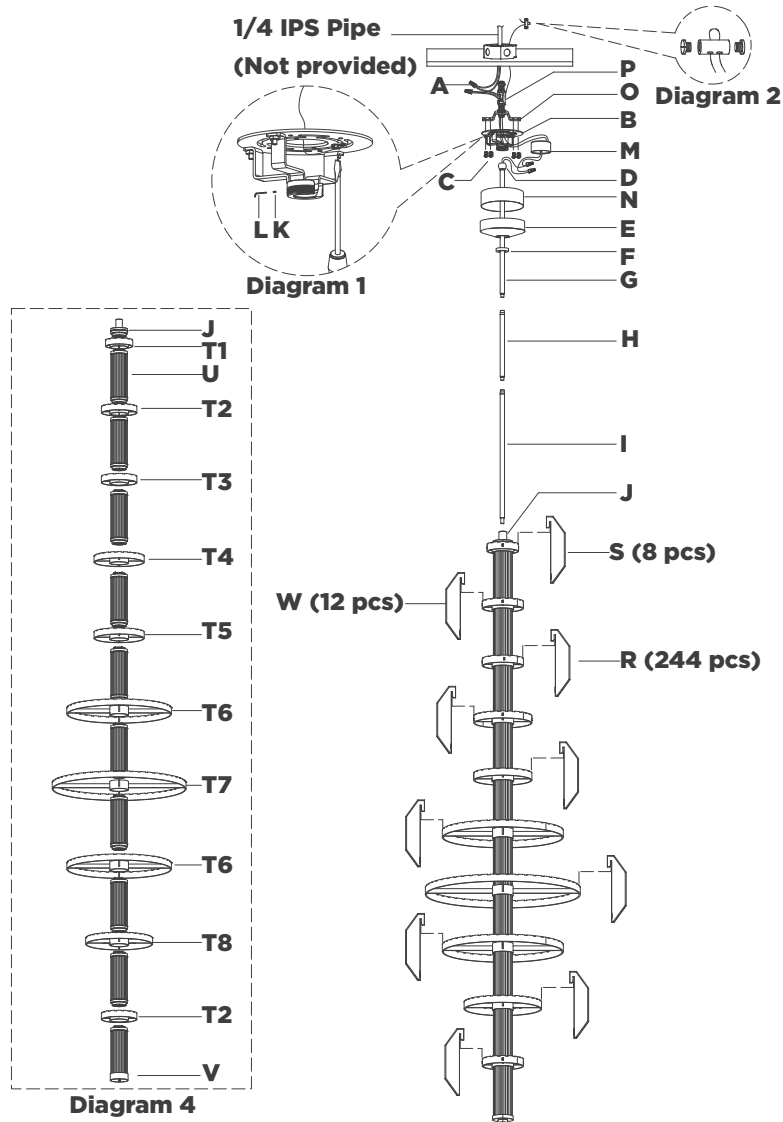

Killarney 19" Layered Entry Chandelier

Item # WF5020

NOTICE:

This light fixture should be installed in accordance with all applicable, local installation codes, and by a person familiar with the construction and operation of it, as well as the hazards involved. Inspect item and contents carefully. If any damage or defect is found, do not install. Retain all packaging material until installation is complete and approved.

15. Connect fixture hot wire (red) to driver **(M)** output wire (red) using wire nut **(A)**.
 16. Connect supply ground wire (usually green or bare copper) around the green grounding screw (see diagram 1). Tighten.
- NOTE:** It is imperative that the fixture is grounded.
17. Connect driver **(M)** input neutral wire (white) to the supply neutral wire (usually white) using wire nut **(A)**.
 18. Connect driver **(M)** input hot wire (black) to the supply hot wire (usually black) using wire nut **(A)**.
- CAUTION:** Do not reverse the hot and neutral connections.
19. Make sure all wire connections are tight, then carefully tuck into the junction box.
 20. Insert driver **(M)** into the mounting plate **(B)** bracket.
 21. Install driver housing **(N)** and canopy **(E)** to mounting plate **(B)** and secure with collar ring **(F)**.
 22. Install fixture ring **(T1)** to fixture **(J)** and secure with LED module **(U)**.
 23. Repeat fixture rings **(T2 & T3 & T4 & T5 & T6 & T7 & T6 & T8 & T2)** and secure with LED modules (see diagram 4).
 24. Threaded end cap **(V)** to bottom of LED module.
 25. Hang glasses **(S)** to fixture ring **(T1)** and glasses **(W)** to top fixture ring **(T2)**.
 26. Hang glasses **(R)** to the remaining of fixture rings starting from bottom through to the top.

CARE INSTRUCTIONS: Clean only with a soft dry cloth or feather duster. Do not use abrasive or chemical agents.

WATERFORD

IRELAND 1783



ASSEMBLY INSTRUCTIONS

Option 2: Ceiling Mounted Driver

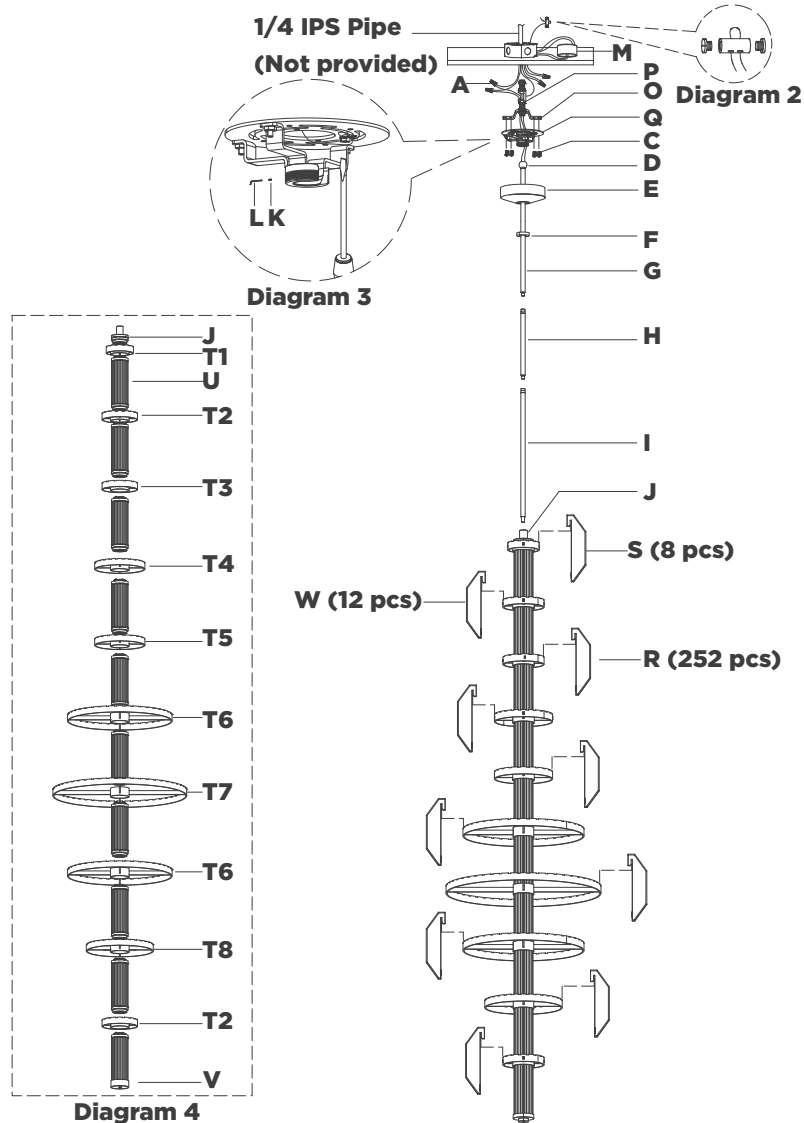

Killarney 19" Layered Entry Chandelier

Item # WF5020

NOTICE:

This light fixture should be installed in accordance with all applicable, local installation codes, and by a person familiar with the construction and operation of it, as well as the hazards involved. Inspect item and contents carefully. If any damage or defect is found, do not install. Retain all packaging material until installation is complete and approved.

TOOLS REQUIRED (NOT INCLUDED):

Phillips Screwdriver	Slotted Screwdriver	Wire Strippers
Slip Joint Pliers	Measuring Tape	Chain Pliers
Wire Cutters		

PERSONS REQUIRED: Two

- Carefully remove all parts from the box. Place on a clean, soft surface.
- Place driver (M) into ceiling and route all wires through one of the knockouts in the junction box.
- Remove canopy (E) and driver housing (N) from from mounting plate (B) by removing collar ring (F).
- Remove mounting bracket (O) from mounting plate (B) by removing screws (C).
- Remove hickey (P) from mounting bracket (O) by removing hex nut.
- It is recommended to install a 1/4 IPS threaded pipe, secured to a structural member of the building. Then install hickey (P) into threaded pipe and tighten with wrench.

NOTE: Item must be supported independent of the junction box due to hanging weight.

WATERFORD

IRELAND 1783



Option 2: Ceiling Mounted Driver

1/4 IPS Pipe _____
(Not provided)

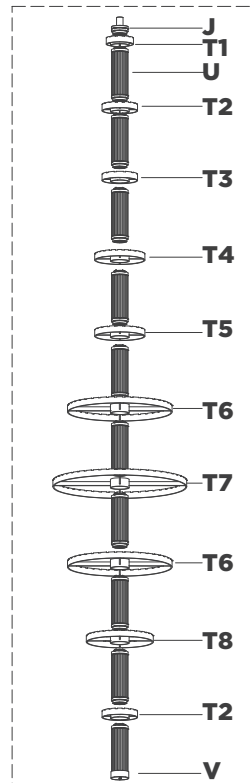
[illegible]

Item # WF5020

This light fixture should be installed in accordance with all applicable, local installation codes, and by a person familiar with the construction and operation of it, as well as the hazards involved. Inspect item and contents carefully. If any damage or defect is found, do not install. Retain all packaging material until installation is complete and approved.

- WATERFORD
IRELAND 1783

