

ASSEMBLY INSTRUCTIONS

Melange 54" Multi-Positional Chandelier

Item # KW5609

NOTICE:

This light fixture should be installed in accordance with all applicable, local installation codes, and by a person familiar with the construction and operation of it, as well as the hazards involved. Inspect item and contents carefully. If any damage or defect is found, do not install. Retain all packaging material until installation is complete and approved.

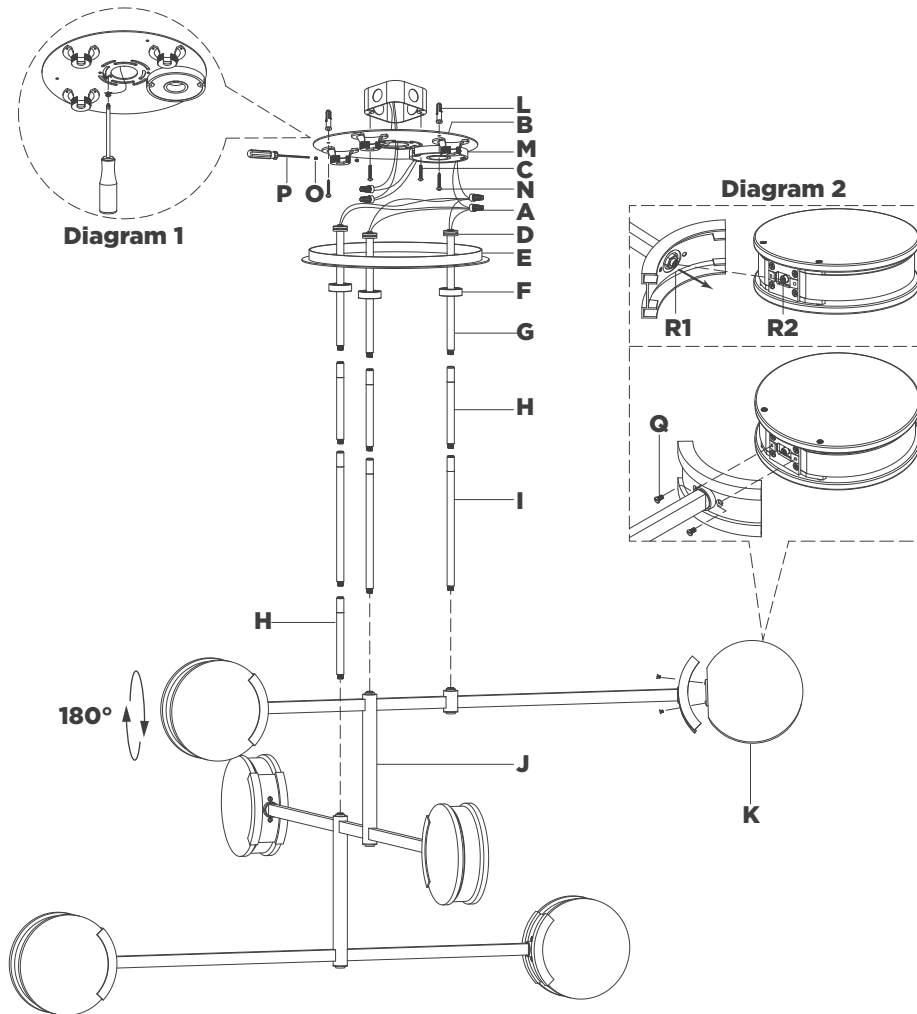

TOOLS REQUIRED (NOT INCLUDED):

Phillips Screwdriver	Slotted Screwdriver	Wire Strippers
Wire Cutters	Hammer	Pencil
Drill		

- Carefully remove all parts from the box. Place on a clean, soft surface.
- Remove canopy **(E)** from mounting plate **(B)** by removing collar rings **(F)**.
- Using mounting plate **(B)** as a guide, line up with the junction box and mark anchor positions.
- Using a drill bit slightly smaller than the anchor, drill holes in the marked positions. Install anchors **(L)** into the holes using a hammer.
- Install mounting plate **(B)** to the junction box and secure with mounting screws **(C)**, then secure wood screws **(N)** to anchors **(L)**.
- Feed electrical wires through rod **(H)** and connect to fixture **(J)**.
- Feed electrical wires through rods **(I)** and connect to fixture **(J)** and rod **(H)**. Repeat for the remaining rods **(H)**, connecting to rods **(I)**.
- Continue feeding wires through collar rings **(F)**, canopy **(E)**, and rods **(G)**.

ASSEMBLY INSTRUCTIONS

Melange 54" Multi-Positional Chandelier

Item # KW5609

NOTICE:

This light fixture should be installed in accordance with all applicable, local installation codes, and by a person familiar with the construction and operation of it, as well as the hazards involved. Inspect item and contents carefully. If any damage or defect is found, do not install. Retain all packaging material until installation is complete and approved.

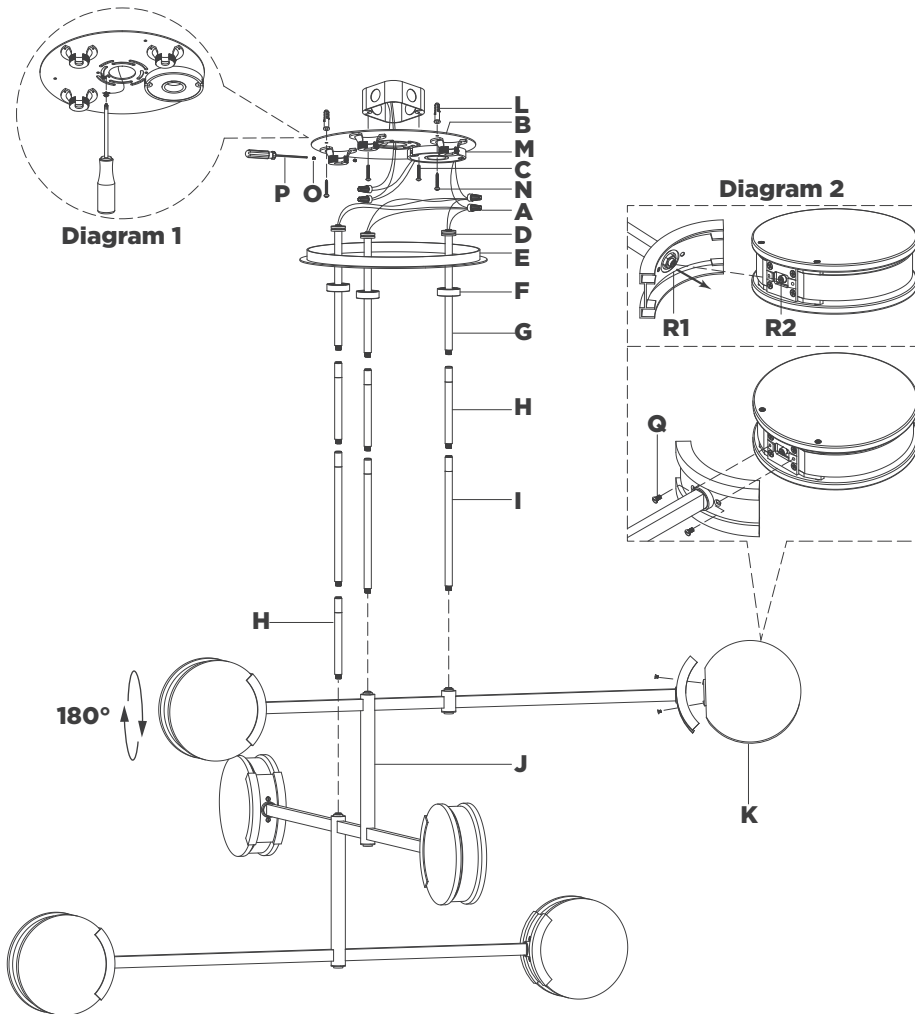

9. Holding fixture upright, slide collar rings **(F)** and canopy **(E)** down and rest on fixture **(J)**. Then connect rods **(G)** to rods **(H)**.

NOTE: Slide components down slowly to avoid damage.

10. Hang fixture fan mounts **(D)** to the center of mounting plate **(B)** and secure with set screws **(O)** using provided screwdriver **(P)**.
 11. Cut excess wires, being sure to leave enough to reach the junction box. Separate wires and strip insulation on each 5/8".
 12. Connect fixture neutral wires (black) to driver **(M)** output wire (black) using wire nut **(A)**.
 13. Connect fixture hot wires (red) to driver **(M)** output wire (red) using wire nut **(A)**.
 14. Connect supply ground wire (usually green or bare copper) around the green grounding screw (see diagram 1). Tighten.
- NOTE:** It is imperative that the fixture is grounded.
15. Connect driver **(M)** input neutral wire (white) to the supply neutral wire (usually white) using wire nut **(A)**.
 16. Connect driver **(M)** input hot wire (black) to the supply hot wire (usually black) using wire nut **(A)**.
- CAUTION:** Do not reverse the hot and neutral connections.
17. Make sure all wire connections are tight, then carefully tuck into the junction box.

ASSEMBLY INSTRUCTIONS

Melange 54" Multi-Positional Chandelier

Item # KW5609

NOTICE:

This light fixture should be installed in accordance with all applicable, local installation codes, and by a person familiar with the construction and operation of it, as well as the hazards involved. Inspect item and contents carefully. If any damage or defect is found, do not install. Retain all packaging material until installation is complete and approved.

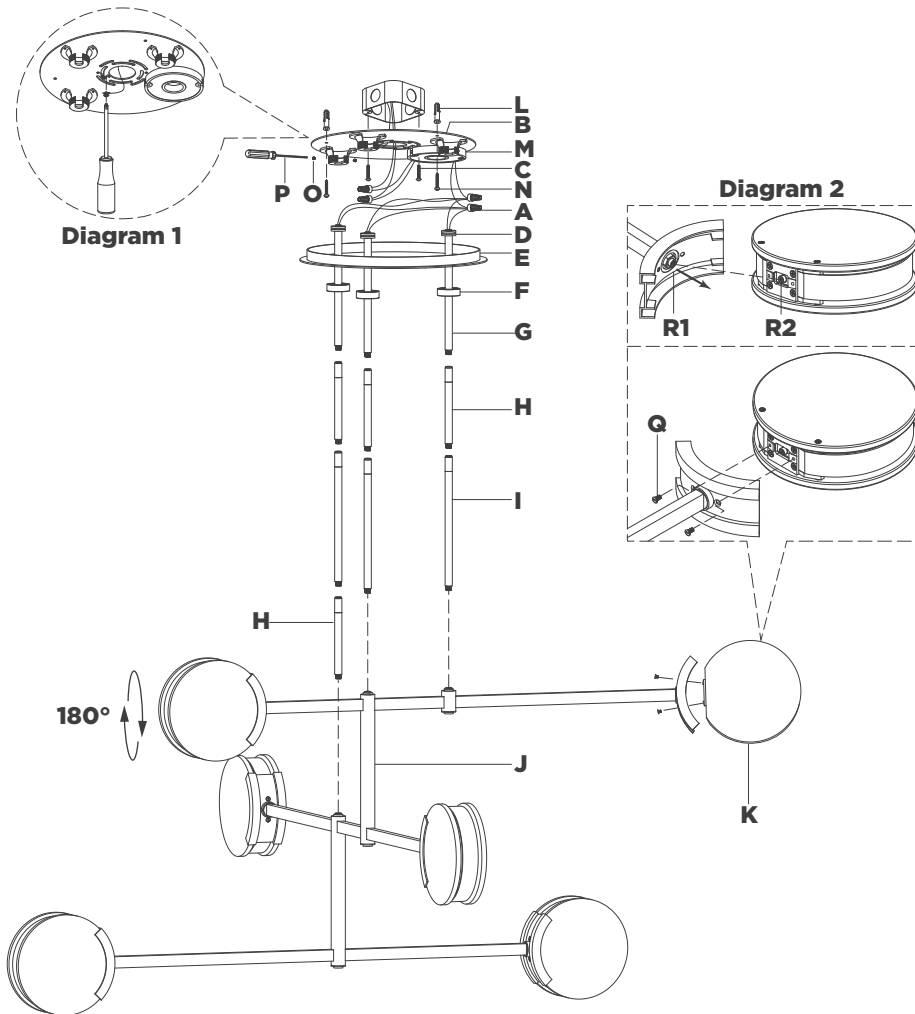

18. Install canopy (E) to mounting plate (B) and secure with collar rings (F).
19. Align guide pins (R2) on shades (K) to receivers (R1), then install shades (K) to fixture and secure with screws (O) (see diagram 2).
20. Adjust shades (K) to desired angle.

CARE INSTRUCTIONS: Clean only with a soft dry cloth or feather duster. Do not use abrasive or chemical agents.