

# ASSEMBLY & INSTALLATION INSTRUCTIONS

A970

Cypress Dining Pendant - 131540

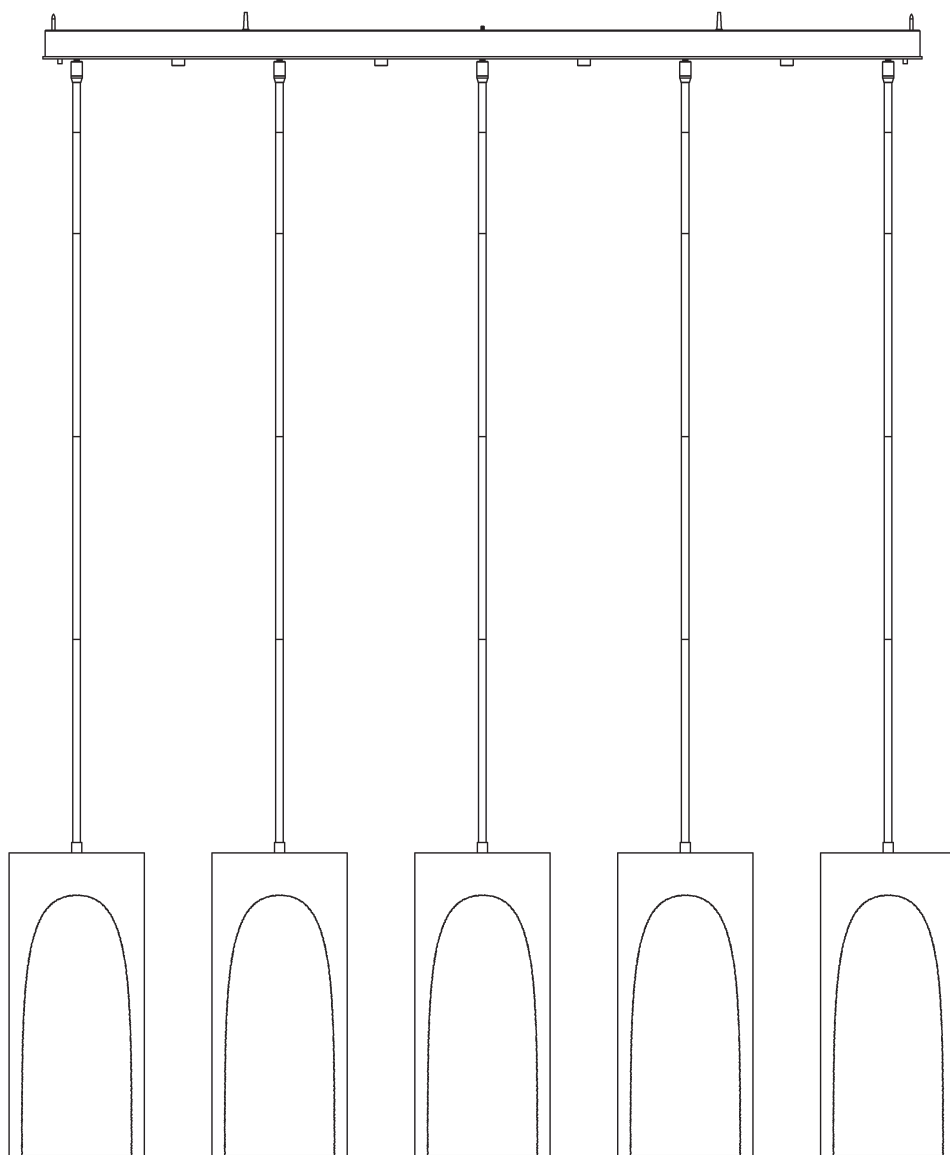

HUBBARDTON FORGE.

MODERN AMERICAN BLACKSMITHS | FINE, HAND CRAFTED LIGHTING  
CASTLETON, VERMONT USA | HUBBARDTONFORGE.COM

54833

1 OF 7

## Component Parts

**A Fixture Pendant (5)**

**B Fixture Coupling (5)**

**C Swivel (5)**

**D Canopy Plate**

**E Stem Nipple (25)**

**F Hex Nut (5)**

**G Lock Washer (5)**

**H 3" Fixture Pipe (5)**

**I 6" Fixture Pipe (5)**

**J 12" Fixture Pipe (15)**

**K Canopy**

**L Anchors (4)**

**M #10 Screws (8)**

**N Support Cable (2)**

**O Hex Nut (2)**

**P Driver (5)**

**Q Stud (4)**

**R Cap (4)**

**S Knob with Stud (2)**

**T Standoff (2)**

**U Ground Screw**

**V Cupped Washer**

**W Glass (5)**

**X Flat Head Screw (10)**

**Y Fixture Front (5)**

**Z Fixture Back (5)**



# ASSEMBLY & INSTALLATION INSTRUCTIONS

A970

Cypress Dining Pendant - 131540

**CAUTION: FAILURE TO INSTALL THIS FIXTURE PROPERLY MAY RESULT IN SERIOUS PERSONAL INJURY OR DEATH AND PROPERTY DAMAGE.** We recommend installation by a licensed electrician. This product must be installed in accordance with applicable installation code(s), by a person familiar with the construction and operation of the product and the hazards involved.\*

**Caution:** Do not exceed maximum wattage noted on fixture. Use only recommended bulbs with fixture.

## Assemble Fixture (Figure 1 - on following page)

1. Carefully unpack fixture from the carton.
2. Locate fixture pipes (H,I,J), and stem nipples (E). Stem nipples (E) can be found in the kit bag.
3. Provided are multiple fixture pipes in three different lengths. Choose the combination that will achieve the overall height desired. Refer to the table below to determine the pipes required to reach the desired overall height. Once you have determined the components necessary, feed the wires that exit fixture pendant (A) from the fixture coupling (B) through the individual components. Wires will slip easier through loose components than through pipes and couplings that are pre-assembled. Once wires are run, apply thread locking compound to all the connection points and assemble the pipes and nipples.

		Overall Height of Fixture															
		21.6	24.6	27.6	30.6	33.6	36.6	39.6	42.6	45.6	48.6	51.6	54.6	57.6	60.6	63.6	66.6
# of Pipes Required	3" Pipe (J)		1		1		1		1		1		1		1		1
	6" Pipe (K)			1	1			1	1			1	1			1	1
	12" Pipe (L)					1	1	1	1	2	2	2	2	3	3	3	3

**NOTE:** APPLICATION OF THE THREAD LOCKING COMPOUND IS NECESSARY TO PREVENT THE PIPE FROM LOOSENING DURING REGULAR MAINTENANCE AND CLEANING OF THE FIXTURE. BE CERTAIN TO APPLY THE COMPOUND.

4. Slip wires from the fixture pendant (A) through assembled swivel (C) and thread swivel into fixture pipe.
5. Repeat repeat steps 3 & 4 for the remaining sets of pipes.
6. Ensure that slots on swivels (C) are aligned.
7. Carefully place canopy plate (D) over swivels (C) and secure with lock washer (G) and hex nut (F) as shown. Washers (G) and nuts (F) can be found in the kit bag.
8. Repeat for all pendants.
9. Follow instructions on following pages to continue install.

ASSEMBLY & INSTALLATION INSTRUCTIONS

A970

Cypress Dining Pendant - 131540

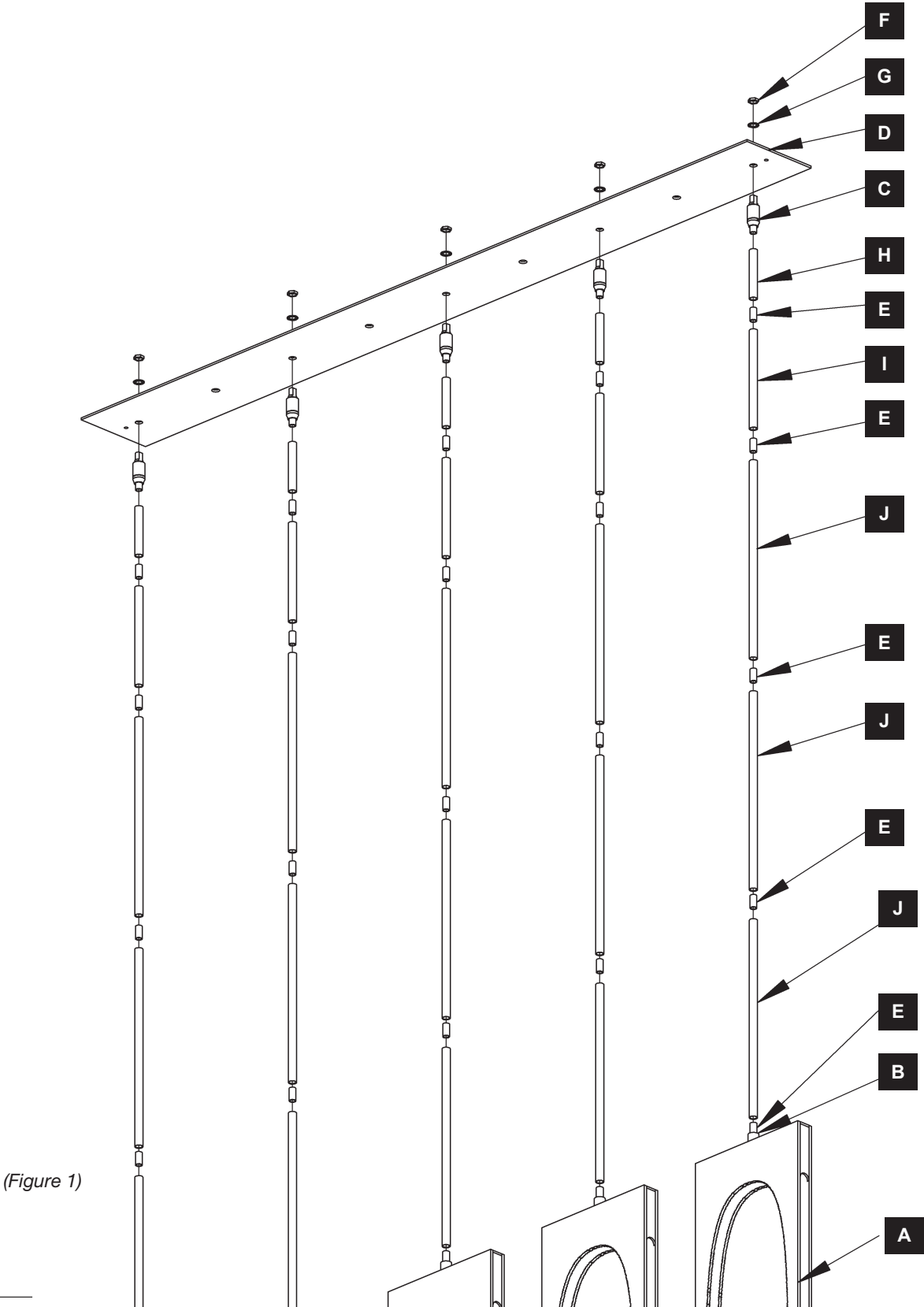

(Figure 1)

# ASSEMBLY & INSTALLATION INSTRUCTIONS

A970

Cypress Dining Pendant - 131540

## To Install Fixture (Figure 2 & 3) on following page

1. Position the canopy (K) over the electrical box aligning ovals in bracket with mounting holes in electrical box. Orient fixture to desired hanging position and mark the location of all the mounting holes on the ceiling. Set the canopy aside.
2. Drill 1/4" holes in the locations marked on the ceiling where anchors are to be used. Place the tapered end of anchor (L) into the hole and gently tap them flush to the ceiling using a light weight hammer.
3. Place canopy (K) over electrical box. Using two machine screws (not provided) fasten the canopy (K) to the electric box. Thread #10 screws (M) into anchors (L). Using #10 screws (M), screw canopy (K) to structural member in the ceiling.

**Note:** Wood screws are supplied with your fixture; however, different materials and/or construction methods may require different fasteners. If in doubt, contact a qualified electrician.

**CAUTION:** INSTALLER MUST ENSURE THAT THE MOUNTING METHOD IS CAPABLE OF SUPPORTING THE WEIGHT OF THE FIXTURE.

4. Raise canopy plate (D) with fixture pendants installed close to ceiling. Attach support cables (N) to canopy (K) using hex nuts (O) onto threaded studs installed on the canopy (K). Cables are used to temporarily hold fixtures during wiring.
5. Using provided wire connector; attach fixture wires to driver (P) DC output wires (red to red, black to black). Caution: Make sure no bare wire is exposed.

**Note:** Wire connectors are shipped attached to driver output wires. Fixture wires must be stripped before inserted into provided wire connector.

6. Using suitable wire connectors (not provided) connect driver wires to supply wires (white to white or black to black). Using cupped washer (V) and ground screw (U) run a pigtail lead to the junction box and connect all ground wires (bare copper or green to bare copper or green).

**CAUTION:** MAKE SURE WIRE CONNECTORS ARE TWISTED ON SECURELY, AND NO BARE WIRE IS EXPOSED.

7. Secure canopy plate (D) by threading caps (R) onto studs (Q).
8. Attach the ends of the canopy plate (D) using the two knobs with studs (S) thread into the two standoffs (T).

**CAUTION:** BE SURE NO WIRES ARE PINCHED BETWEEN THE CANOPY (K) AND CANOPY PLATE (D).

9. Follow instructions on following page to install glass.



HUBBARDTON FORGE.

MODERN AMERICAN BLACKSMITHS | FINE, HAND CRAFTED LIGHTING  
CASTLETON, VERMONT USA | HUBBARDTONFORGE.COM

54833

5 OF 7

ASSEMBLY & INSTALLATION INSTRUCTIONS

A970

Cypress Dining Pendant - 131540

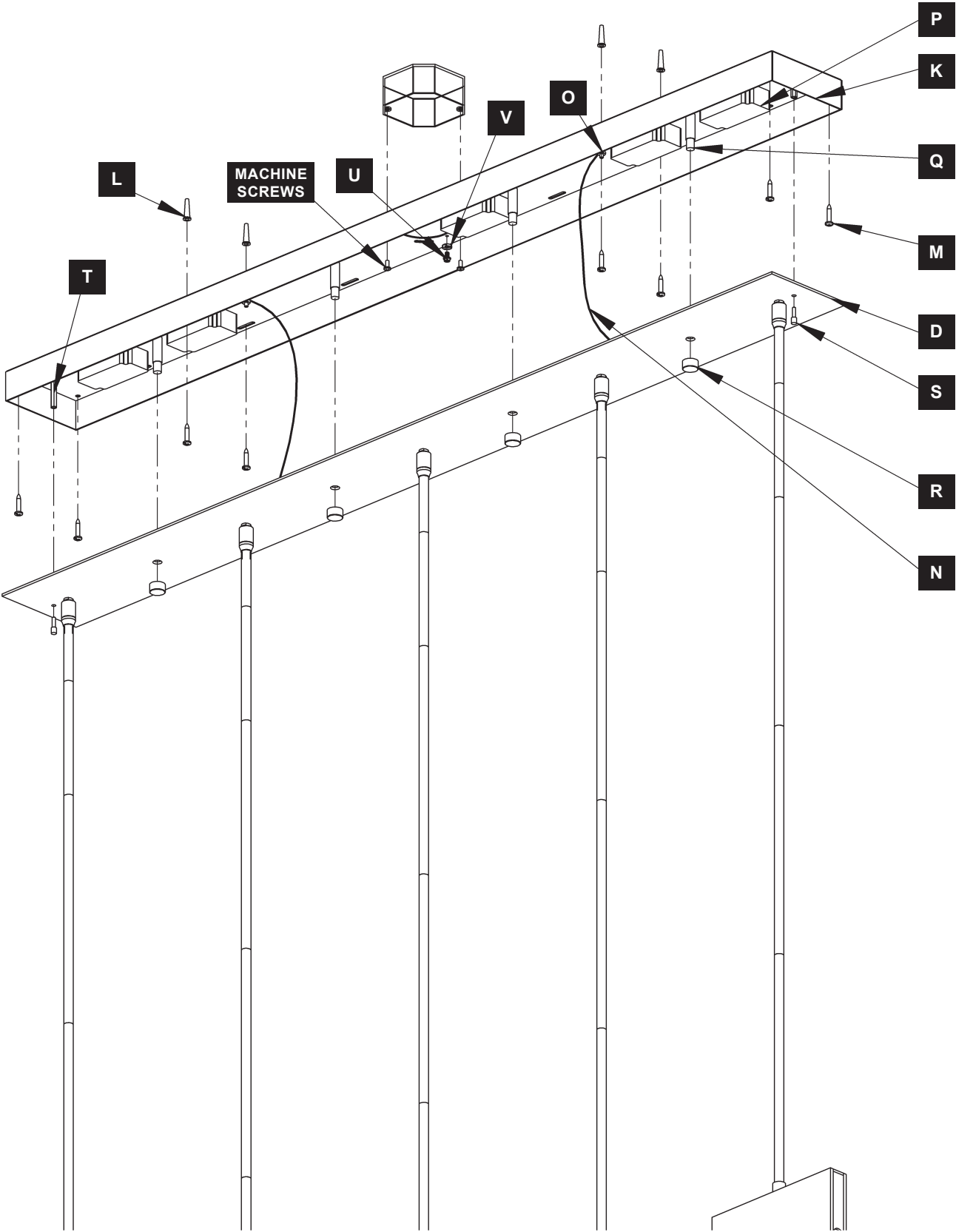

# ASSEMBLY & INSTALLATION INSTRUCTIONS

A970

Cypress Dining Pendant - 131540

## Install Glass (Figure 2)

1. Remove flat head screws (X) from fixture front (Y) and fixture back (Z).
2. Separate two halves.
3. Place glass (W) into fixture back (Z) and place fixture front (Y) over the glass (W).
4. Re attach fixture halves together using flat head screws (X).
5. Restore electricity at main breaker.

**CAUTION:** FIXTURE MAY BE ROTATED TO DESIRED POSITION. CARE SHOULD BE TAKEN TO NOT ROTATE FIXTURES COUNTER CLOCKWISE. ROTATING FIXTURES COUNTERCLOCKWISE TOO FAR WILL CAUSE THE STEM PIPES TO UNSCREW FROM EACH OTHER.

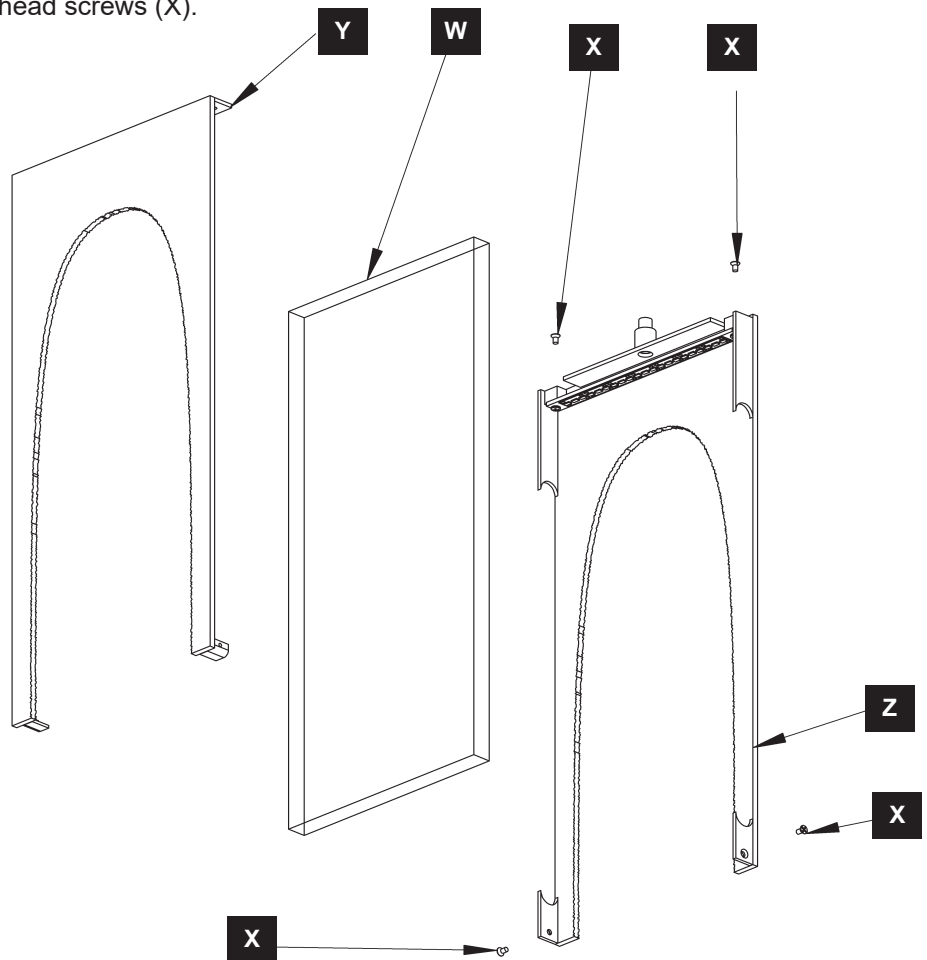

(Figure 2)

If you need further assistance, or find that you are missing any parts, please contact the dealer from which you purchased this product. We hope you enjoy your fixture!

**\* Hubbardton Forge will not be liable for injury or damage caused by improper installation, lamping or use of this fixture.**



HUBBARDTON FORGE.

MODERN AMERICAN BLACKSMITHS | FINE, HAND CRAFTED LIGHTING  
CASTLETON, VERMONT USA | HUBBARDTONFORGE.COM

54833

7 OF 7