

BERYL 13 CYLINDER TABLE LAMP

SLTB744

General Product Information

Go to www.visualcomfort.com for product specs.

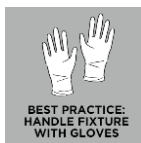
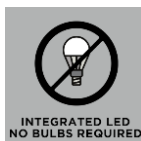
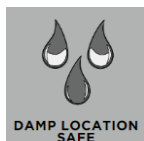
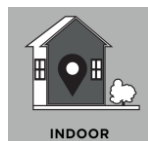

Safety Information

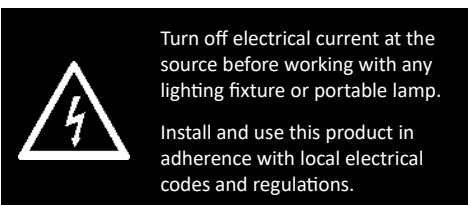

Turn off electrical current at the source before working with any lighting fixture or portable lamp.

Install and use this product in adherence with local electrical codes and regulations.

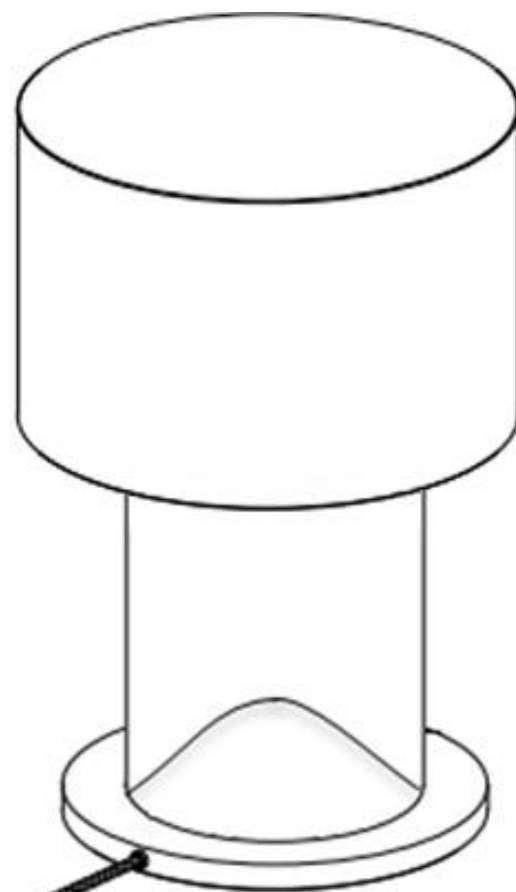

FIXTURE PARTS

- A. Shade with Attached Stem
- B. LED
- C. Base
- D. Touch Switch
- E. Electrical Cord Male Connector
- F. Electrical Cord Female Connector
- G. Adapter
- H. Plug

Please note the following:

- CE, SAA, UK, and CCC plug adapters are included.
- The shade is heavy. Support it with one hand while seating to prevent damage to internal components or tipping the fixture.

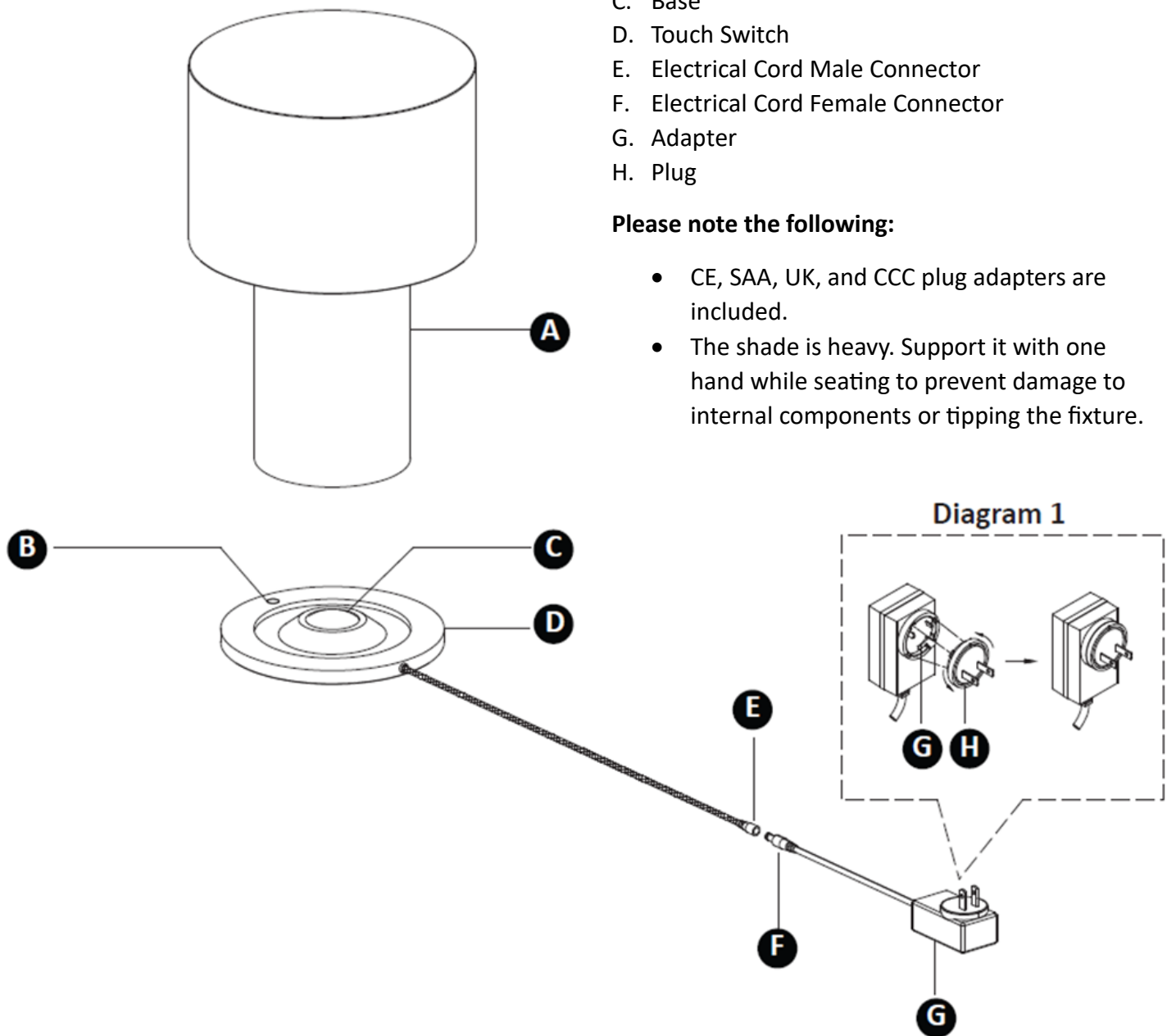

INSTRUCTIONS

1. Remove the lamp and all its parts from the packaging.
2. Place the shade with the attached stem onto the center ring surrounding the LED at the lamp base.
3. Connect the electrical components by plugging the male and female connectors together.
4. If needed, attach the plug adapter to the power supply.
5. Plug the lamp into a working electrical outlet and test its function.
6. Use the touch-sensitive switch to turn the lamp on/off and adjust brightness settings.