

ASSEMBLY INSTRUCTIONS

ITEM DESCRIPTION:

ITEM NO.: FCI13

NAME: Delaney Coffee Table

MATERIAL TYPE: Mangowood/Marble FINISH: Amber/White

ITEM NET WEIGHT: 172.2 LBS

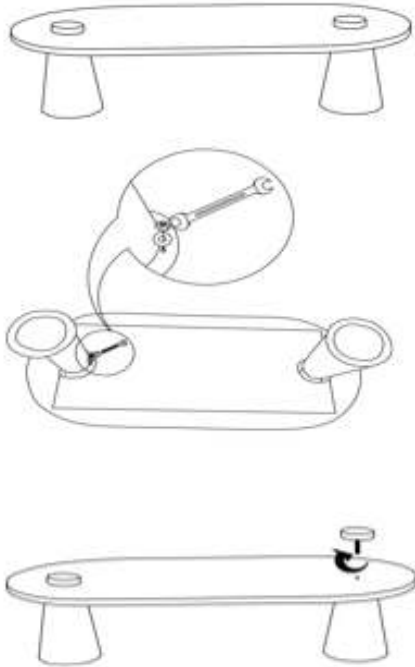

PARTS INCLUDED:

Top	Qty: 1 Pc
Base Marble	Qty: 2 Pc
wooden Cap	Qty: 2 Pc
Nut	Qty: 8 Pc
Washer	Qty: 8 Set
Spanner	Qty: 1 Pc

Note : check all the hardware periodically as it may get loose and need to be tightened.



TO ASSEMBLE:

1. This Item has two feet which need to be attached using the hardware and tools provided.
- 2 Lay out all the components and identify the various parts of the coffee table, including two table bases and the marble top.
- 3 Place the marble top upside down on a soft surface to protect it. Align the two legs with the holes on the underside of the marble top.
- 4 Use the spanner to tighten the nuts, securing the marble top in place. Let's carefully flip the coffee table right side up so that its legs are back on the floor.
- 5 Insert a wooden cap screw through each of the pre-drilled holes in the marble top into the corresponding holes in the legs. Make sure the legs are firmly attached to the marble top, but avoid overtightening, which may damage the marble.
- 6 Clean the marble top with a soft, damp cloth to remove any fingerprints or smudges.
7. Tighten the screws completely to finish the assembly.

CARE INSTRUCTIONS:

Wipe with a soft, dry cloth. To protect finish, avoid the use of chemicals and household cleaners.

For customer service questions call 1-800-338-2150

ARTERIO RS