

5084 / 5085 / 5086

LED-CE / 230V

**WARNING!**



Be sure electrical power is OFF before and during installation or maintenance.  
The luminaire must be installed by a qualified electrician, in accordance with all applicable local codes.

Ensure that the rated luminaire voltage requirements are compatible with the available mains supply in which it will be installed.  
All LEDs are included in your lamp. Never touch the LED surface with your bare hands as this may reduce the life of your LED.  
Do not alter, relocate or remove any electrical component.

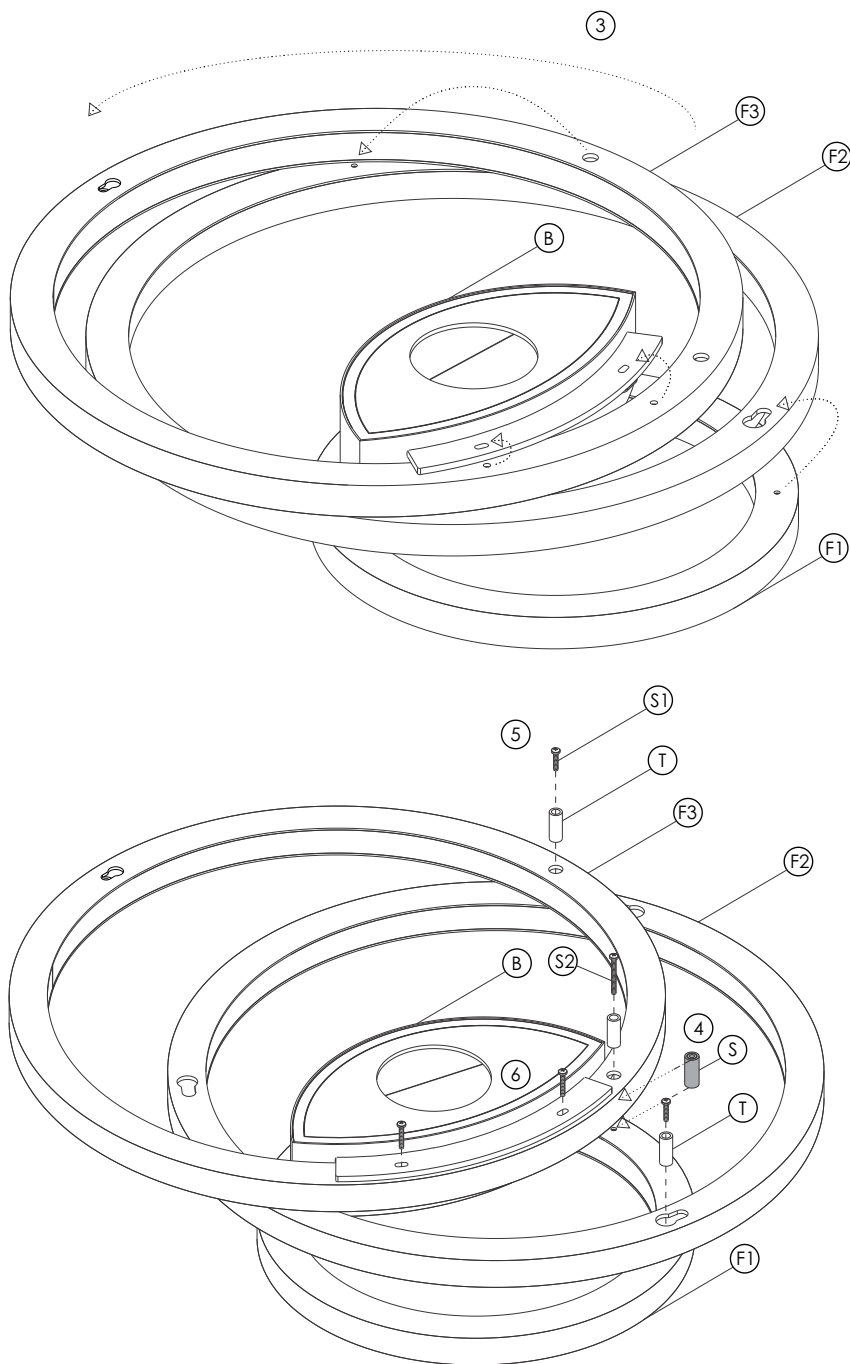

Line: Frame  
Family: Ceiling/Wall Lamp  
Description: Ceiling/Wall Accord Frame 5084 / 5085 / 5086  
Material: Natural Wood Veneer, MDF and Acrylic

**ASSEMBLING THE FIXTURE**

Read carefully all the assembling instructions below, before starting the installation process:

- 1 Remove the protecting package from the pieces taking care to not harm any parts with cutting surfaces or objects. Lay the parts of the fixture on some horizontal surface, if needed use the protecting package to soften the surface and protect the parts from getting scratched or harmed.
- 2 Notice that the fixture has three parts which are joined by one articulated point. The frame (F1), frame (F2) and frame (F3), must be correctly positioned and mounted by the user, through the following steps:
- 3 Carefully slide the frames (F2) and (F3) aligning both through the holes in which will be threaded the provided screws. Before sliding the frames, slightly lift them up so that the friction between them doesn't harm the surface of the fixture.
- 4 After all the frames are correctly aligned through the holes, insert the metallic support (S) between the frame 3 (F3) and frame 2 (F2), aligning it with the holes on both frames.
- 5 Use the plastic tubes (T) to guide the screws to their holes and prevent them to fall into the frames, then fasten the provided screws (S1 and S2) fixing both frames. After securing the screws, remove the guiding tubes.
- 6 After the screws are tight, fixing all the frames together, fix the frames to the base fastening the provided screws (S1).

**PROVIDED SCREWS**

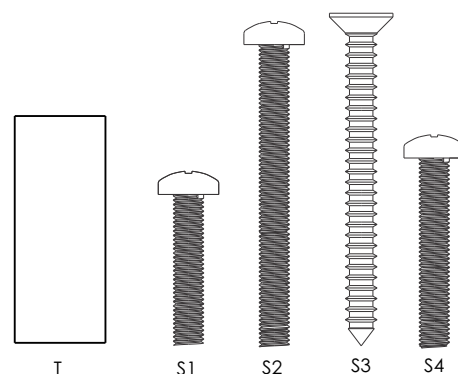

**ATTENTION!**



FAILURE TO COMPLY WITH THESE INSTRUCTIONS MAY CAUSE ACCIDENTS AND LOSS OF PRODUCT WARRANTY.  
It's recommended to read these instructions completely and carefully before proceeding.

SAVE THESE INSTRUCTIONS FOR FUTURE REFERENCE.

ACCORD Lighting guarantees coverage against manufacturing defects including electrical components and finishes, for a period of three years, under normal use, from the date of purchase. For warranty service, please contact your local dealer for further instructions. Proof of date of purchase will be required for validation of warranty service.

The responsibility of the manufacturer regarding the product warranty is related to the correct observation of the instructions contained in this manual.  
The manufacturer is not responsible for any damage to the product caused by accidents, alterations of any kind, improper usage or improper installation.  
See the website for additional warranty details.

ACCORD Lighting reserves the right to change the dimensions and specifications contained in this manual without prior notice, in accordance with its policy of continuous product improvement. Please, contact the manufacturer if additional information is necessary. The illustrations in this manual are for guidance only and may vary in scale, dimensions and model details.

5084 / 5085 / 5086

LED-CE / 230V

**WARNING!**



Be sure electrical power is OFF before and during installation or maintenance.  
The luminaire must be installed by a qualified electrician, in accordance with all applicable local codes.

Ensure that the rated luminaire voltage requirements are compatible with the available mains supply in which it will be installed.  
All LEDs are included in your lamp. Never touch the LED surface with your bare hands as this may reduce the life of your LED.  
Do not alter, relocate or remove any electrical component.

Input voltage: 230 V  
Input frequency: 50 Hz  
Isolation: Class II

Material: Natural Wood Veneer, MDF and Acrylic

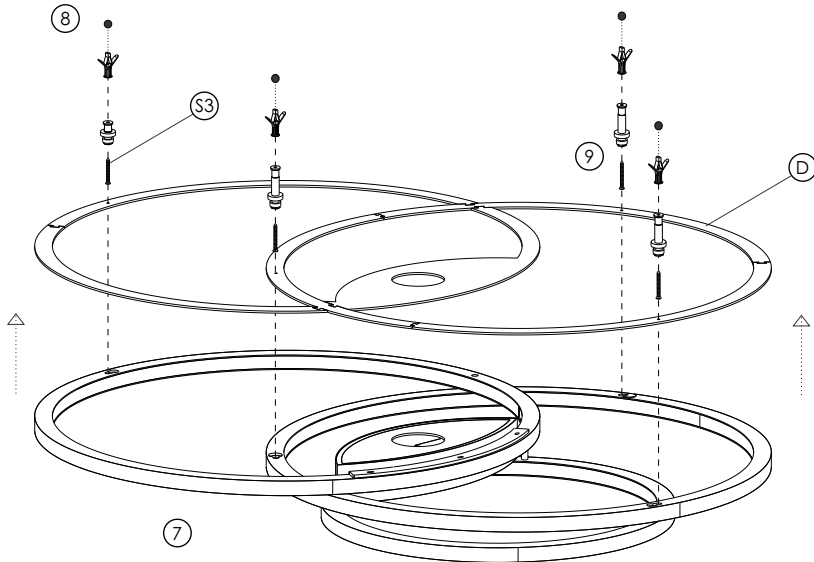

- ⑦ Once the fixture is assembled, position it on the ceiling to assure the correct orientation before starting the installation.
- ⑧ As soon as the position of the piece is decided, place the drilling template (G) on the ceiling and secure it with tape. Then, bring the light fixture to the template to ensure the hole positions are correct. Once the correct positions of the template and the light fixture are determined, make marks on the ceiling where the metal supports will be installed. Next, use an 8mm drill bit to make the holes and insert the plastic anchors into the ceiling. Note that the circle on the canopy should be located below the junction box.
- ⑨ Fix the metallic supports on the ceiling fastening the provided screws (S3).
- ⑩ Once the supports are fixed in the ceiling, bring the fixture close to the junction box and make all electrical connections according to all applicable local codes. Insert the excess energy cable inside the junction box.
- ⑪ Fit the fixture in the metallic supports, installed on the ceiling, by rotating it counterclockwise until it locks.
- ⑫ Insert the covers on top of the fixture, close to the metallic supports, to avoid light leak.

Turn ON the energy power, your luminaire is ready for use.

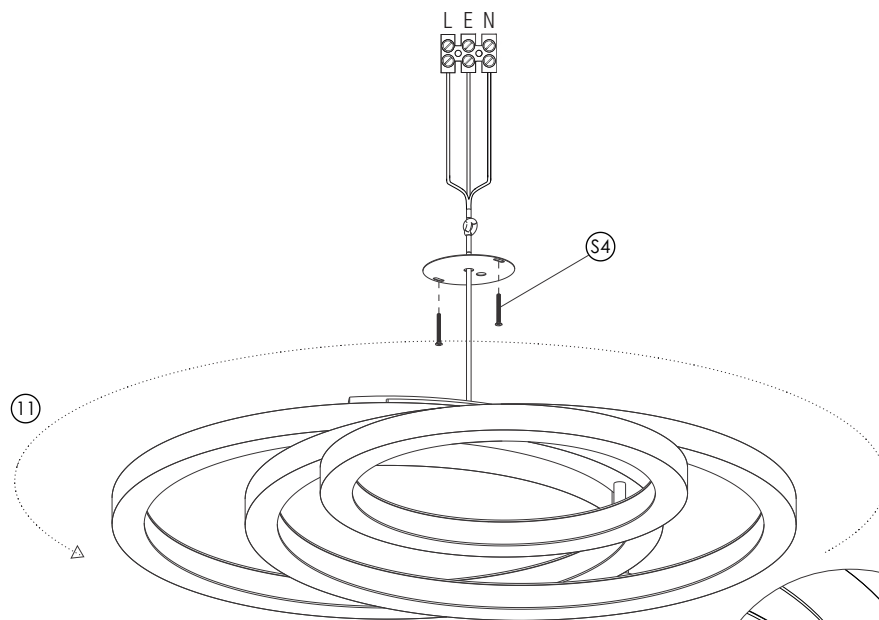

PROVIDED SCREWS

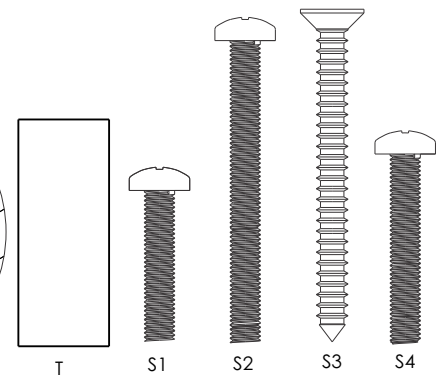

**ATTENTION!**



FAILURE TO COMPLY WITH THESE INSTRUCTIONS MAY CAUSE ACCIDENTS AND LOSS OF PRODUCT WARRANTY.  
It's recommended to read these instructions completely and carefully before proceeding.

SAVE THESE INSTRUCTIONS FOR FUTURE REFERENCE.

ACCORD Lighting guarantees coverage against manufacturing defects including electrical components and finishes, for a period of three years, under normal use, from the date of purchase. For warranty service, please contact your local dealer for further instructions. Proof of date of purchase will be required for validation of warranty service.

The responsibility of the manufacturer regarding the product warranty is related to the correct observation of the instructions contained in this manual.  
The manufacturer is not responsible for any damage to the product caused by accidents, alterations of any kind, improper usage or improper installation.  
See the website for additional warranty details.

ACCORD Lighting reserves the right to change the dimensions and specifications contained in this manual without prior notice, in accordance with its policy of continuous product improvement. Please, contact the manufacturer if additional information is necessary. The illustrations in this manual are for guidance only and may vary in scale, dimensions and model details.