

WARNING!



Be sure electrical power is OFF before and during installation or maintenance.
The luminaire must be installed by a qualified electrician, in accordance with all applicable local codes.

Ensure that the rated luminaire voltage requirements are compatible with the available mains supply in which it will be installed.
All LEDs are included in your lamp. Never touch the LED surface with your bare hands as this may reduce the life of your LED.
Do not alter, relocate or remove any electrical component.

Line: Frame
Family: Ceiling/Wall Lamp
Material: Natural Wood Veneer, MDF and Acrylic

ASSEMBLING THE FIXTURE

Read carefully all the assembling instructions below, before starting the installation process:

- 1 Remove the protecting package from the pieces taking care to not harm any parts with cutting surfaces or objects. Lay the parts of the fixture on some horizontal surface, if needed use the protecting package to soften the surface and protect the parts from getting scratched or harmed.
- 2 Notice that the fixture is disassembled in three separate parts which are wrapped with the protecting package. The frame (F1), frame (F2) and frame (F3), must be assembled together by the user, through the following steps:
- 3 Align the frame (F2) with the frame (F1) through the holes in which will be threaded the provided screws, carefully inserting the energy cable along with the connector inside the base (B).
- 4 Use the plastic tubes (T) to guide the screws to their holes and prevent them to fall into the frames, then fasten the provided screws (S1) fixing both frames. After securing the screws, remove the guiding tubes.
- 5 Repeat the same process aligning the frame (F3) with the frame (F2), inserting its energy cable inside the base (B).
- 6 Repeat step number 4.

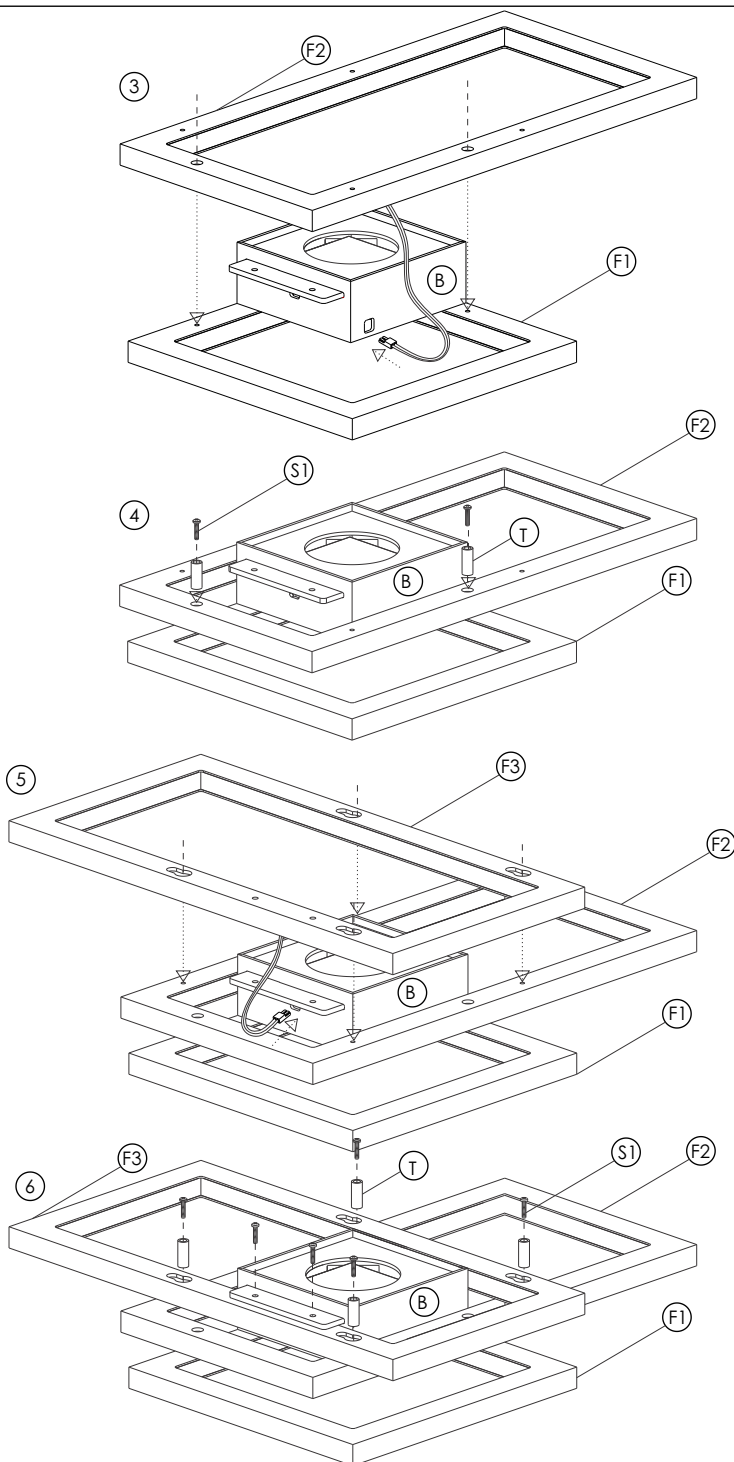

ATTENTION!



FAILURE TO COMPLY WITH THESE INSTRUCTIONS MAY CAUSE ACCIDENTS AND LOSS OF PRODUCT WARRANTY.
It's recommended to read these instructions completely and carefully before proceeding.

SAVE THESE INSTRUCTIONS FOR FUTURE REFERENCE.

ACCORD Lighting guarantees coverage against manufacturing defects including electrical components and finishes, for a period of three years, under normal use, from the date of purchase. For warranty service, please contact your local dealer for further instructions. Proof of date of purchase will be required for validation of warranty service.

The responsibility of the manufacturer regarding the product warranty is related to the correct observation of the instructions contained in this manual.
The manufacturer is not responsible for any damage to the product caused by accidents, alterations of any kind, improper usage or improper installation.
See the website for additional warranty details.

ACCORD Lighting reserves the right to change the dimensions and specifications contained in this manual without prior notice, in accordance with its policy of continuous product improvement. Please, contact the manufacturer if additional information is necessary. The illustrations in this manual are for guidance only and may vary in scale, dimensions and model details.

PROVIDED SCREWS

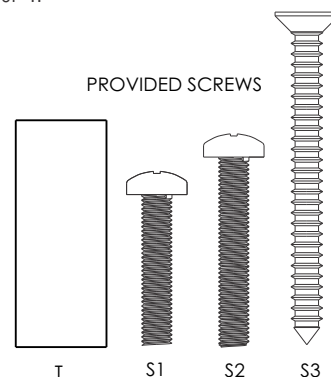

WARNING!



Be sure electrical power is OFF before and during installation or maintenance.
The luminaire must be installed by a qualified electrician, in accordance with all applicable local codes.

Ensure that the rated luminaire voltage requirements are compatible with the available mains supply in which it will be installed.
All LEDs are included in your lamp. Never touch the LED surface with your bare hands as this may reduce the life of your LED.
Do not alter, relocate or remove any electrical component.

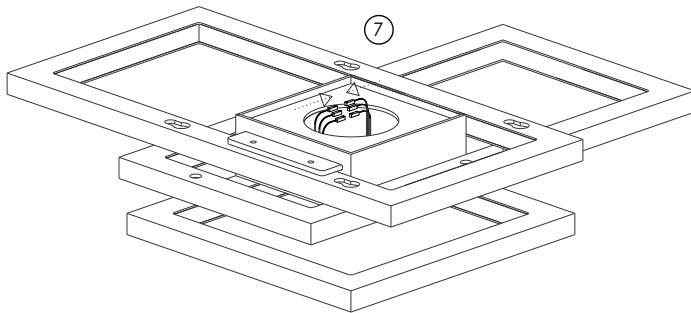

Input voltage: 120-277 V

Input frequency: 60 Hz

Isolation: Class II

Material: Natural Wood Veneer, MDF and Acrylic

- ⑦ Join the connectors from the frames with their relative terminals.
- ⑧ Use the template to make the markings on the ceiling where the holes must be made.
- ⑨ Use 8mm drills and make the holes. Next insert the plastic bushings and screw the metallic supports using the provided screws (S3).
- ⑩ Bring the fixture next to the ceiling and make all electrical connections according to all applicable local codes. Insert the excess energy cable inside the junction box.
- ⑪ Fix the junction box cover on the junction box using the provided screws (S2).
- ⑫ Raise the fixture against the ceiling and fit it in the metallic supports, fixed on the ceiling.
- ⑬ Insert the covers on top of the fixture, close to the metallic supports, to avoid light leak.
- ⑭ Turn ON the energy power, your luminaire is ready to use.

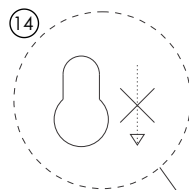
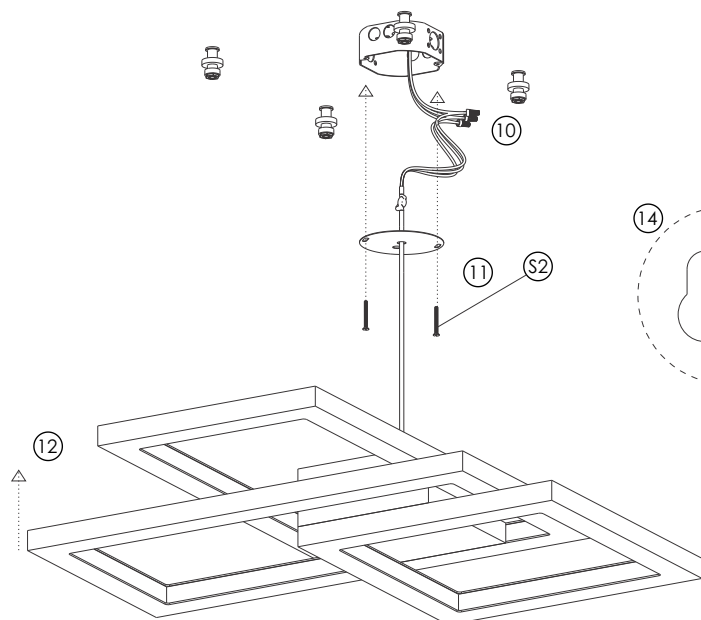
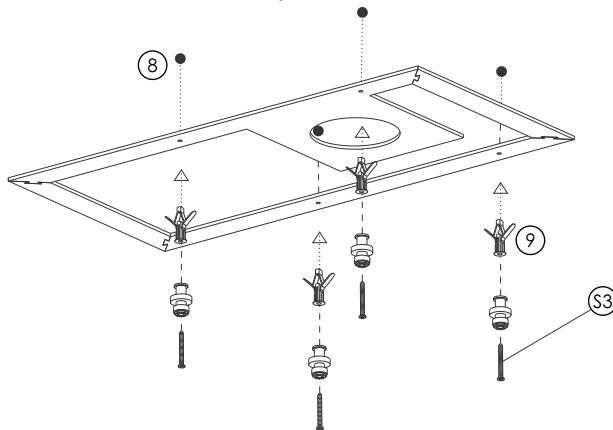

WHEN INSTALLING THE FIXTURE IN THE WALL, DO NOT POSITION THE FIXTURE WITH THE MOUNTING HOLES ORIENTED AS SHOWN IN THE DIAGRAM, THE SMALLER OPENING MUST BE POINTING DOWN/SIDWAYS FOR THE FIXTURE TO BE CORRECTLY FIT AND STAY SECURED.

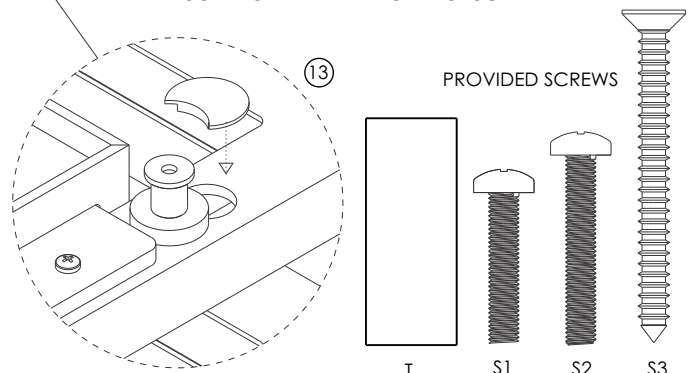

ATTENTION!



FAILURE TO COMPLY WITH THESE INSTRUCTIONS MAY CAUSE ACCIDENTS AND LOSS OF PRODUCT WARRANTY.
It's recommended to read these instructions completely and carefully before proceeding.

SAVE THESE INSTRUCTIONS FOR FUTURE REFERENCE.

ACCORD Lighting guarantees coverage against manufacturing defects including electrical components and finishes, for a period of three years, under normal use, from the date of purchase. For warranty service, please contact your local dealer for further instructions. Proof of date of purchase will be required for validation of warranty service.

The responsibility of the manufacturer regarding the product warranty is related to the correct observation of the instructions contained in this manual.
The manufacturer is not responsible for any damage to the product caused by accidents, alterations of any kind, improper usage or improper installation.
See the website for additional warranty details.

ACCORD Lighting reserves the right to change the dimensions and specifications contained in this manual without prior notice, in accordance with its policy of continuous product improvement. Please, contact the manufacturer if additional information is necessary. The illustrations in this manual are for guidance only and may vary in scale, dimensions and model details.