

WARNING!



Be sure electrical power is OFF before and during installation or maintenance.
The luminaire must be installed by a qualified electrician, in accordance with all applicable local codes.

Ensure that the rated luminaire voltage requirements are compatible with the available mains supply in which it will be installed.
All LEDs are included in your lamp. Never touch the LED surface with your bare hands as this may reduce the life of your LED.
Do not alter, relocate or remove any electrical component.

REF.	/	WATTAGE
1311	/	16W
1312	/	24W
1313	/	32W
1314	/	40W
1315	/	48W

Input Voltage: 120V - 277V
Input Frequency: 60 Hz
Isolation: Class II

Material: Natural Wood Veneer MDF and Acrylic

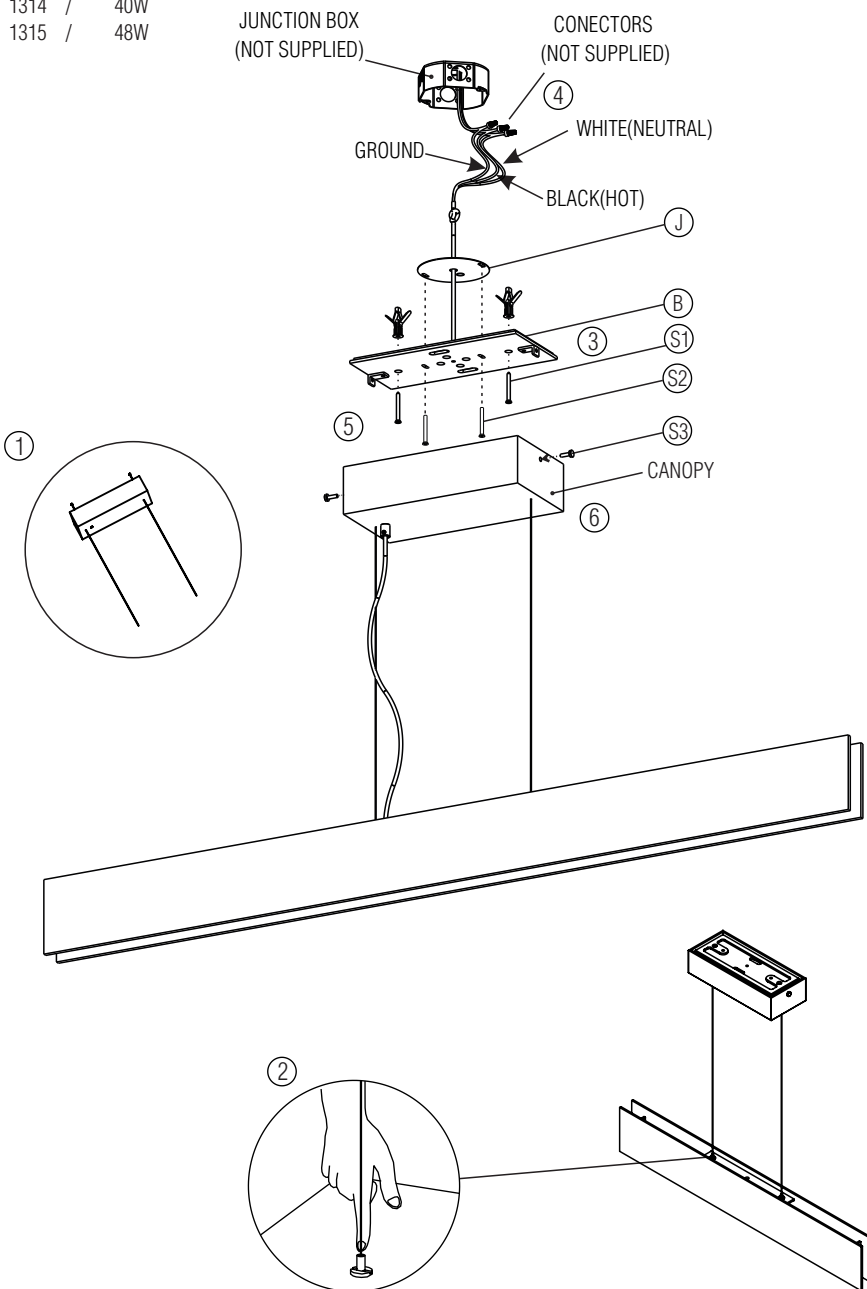

INSTALLING THE FIXTURE ON CEILING

Turn off the electrical power before starting the installation, and keep it turned off until the installation is completed.

This assembly may require the work of two people so it can be secure and well executed.

- 1 Insert the suspension cables through the canopy holes, and make sure that the ball-end is located inside of the canopy.
- 2 The other end of the suspension cable shall be inserted at the adjustable cable grippers installed on the fixture. To insert the cable and adjust the height, press the tip of the gripper while simultaneously sliding the cable in. When you release it, the gripper will lock the cable and anchor the fixture. Repeat this process with all the grippers, adjusting the height and leveling the fixture. Reserve the extra cables by wrapping it inside the fixture, and make sure that it does not touch any electrical connections and electrical components.
- 3 Using the support base (B) as template, position and drill the fixation holes in the ceiling with an 8mm drill, and insert the plastic bushings in the holes, to support the luminaire.
- 4 Make the electrical connections in compliance with all the safety standards and local electrical codes.
This product must be installed in accordance with the applicable installation code by a person familiar with the construction and operation of the product, and the hazards involved.
- 5 Using the (S1) screws, fixate the junction box cover (J) into the junction box, and with the (S2) screws, fixate the support base into the bushings previously installed in the ceiling. Make sure they are tight and secured.
- 6 Bring the canopy close to the support base (B), fit them together, and using the (S3) finishing screws, fixate the fixture in the support base. Make sure everything is well secured

Turn on the electrical power.

The luminaire is ready for use.

DIMMER COMPATIBILITY

The LED driver included with this fixture is designed to operate with most standard dimmers. All power ratings and installation instructions from dimmer manufacturers' instruction sheets must be followed.

ATTENTION!



FAILURE TO COMPLY WITH THESE INSTRUCTIONS MAY CAUSE ACCIDENTS AND LOSS OF PRODUCT WARRANTY.
It's recommended to read these instructions completely and carefully before proceeding.

PROVIDED SCREWS

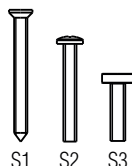

SAVE THESE INSTRUCTIONS FOR FUTURE REFERENCE.

ACCORD Lighting guarantees coverage against manufacturing defects including electrical components and finishes, for a period of three years, under normal use, from the date of purchase. For warranty service, please contact your local dealer for further instructions. Proof of date of purchase will be required for validation of warranty service.

The responsibility of the manufacturer regarding the product warranty is related to the correct observation of the instructions contained in this manual.
The manufacturer is not responsible for any damage to the product caused by accidents, alterations of any kind, improper usage or improper installation.
See the website for additional warranty details.

ACCORD Lighting reserves the right to change the dimensions and specifications contained in this manual without prior notice, in accordance with its policy of continuous product improvement. Please, contact the manufacturer if additional information is necessary. The illustrations in this manual are for guidance only and may vary in scale, dimensions and model details.