

WARNING!



Be sure electrical power is OFF before and during installation or maintenance.
The luminaire must be installed by a qualified electrician, in accordance with all applicable local codes.

Ensure that the rated luminaire voltage requirements are compatible with the available mains supply in which it will be installed.
All LEDs are included in your lamp. Never touch the LED surface with your bare hands as this may reduce the life of your LED.
Do not alter, relocate or remove any electrical component.

Material: Natural Wood Veneer MDF and Acrylic

INSTALLING THE FIXTURE ON CEILING

Turn off the electrical power before starting the installation, and keep it turned off until the installation is completed.

This assembly may require the work of two people so it can be secure and well executed.

- ① Align and mark on ceiling the position of the holes where anchors will be installed. Drill using an 8mm drill bit and install the supplied plastic plugs.
- ② Screw the anchors to the plastic plugs.
- ③ Insert the suspension cables on the holes at the bottom of the gripper, then pass them through the cover and the hole at the side of the cable gripper. After that, close the cable gripper with its cover, and make sure the installation is secured.
- ④ To insert the cable and adjust the height, press the tip of the gripper while simultaneously sliding the cable in. When you release it, the gripper will lock the cable and anchor the fixture. Repeat this process with all the grippers, adjusting the height and leveling the fixture. Reserve the extra cables by wrapping it, or cut the excess. Keep in mind that if you cut it, it will limit the height adjustments in the future.

Ref.	/	Wattage
1345	/	21W
1346	/	28W
1347	/	35W
1348	/	44W

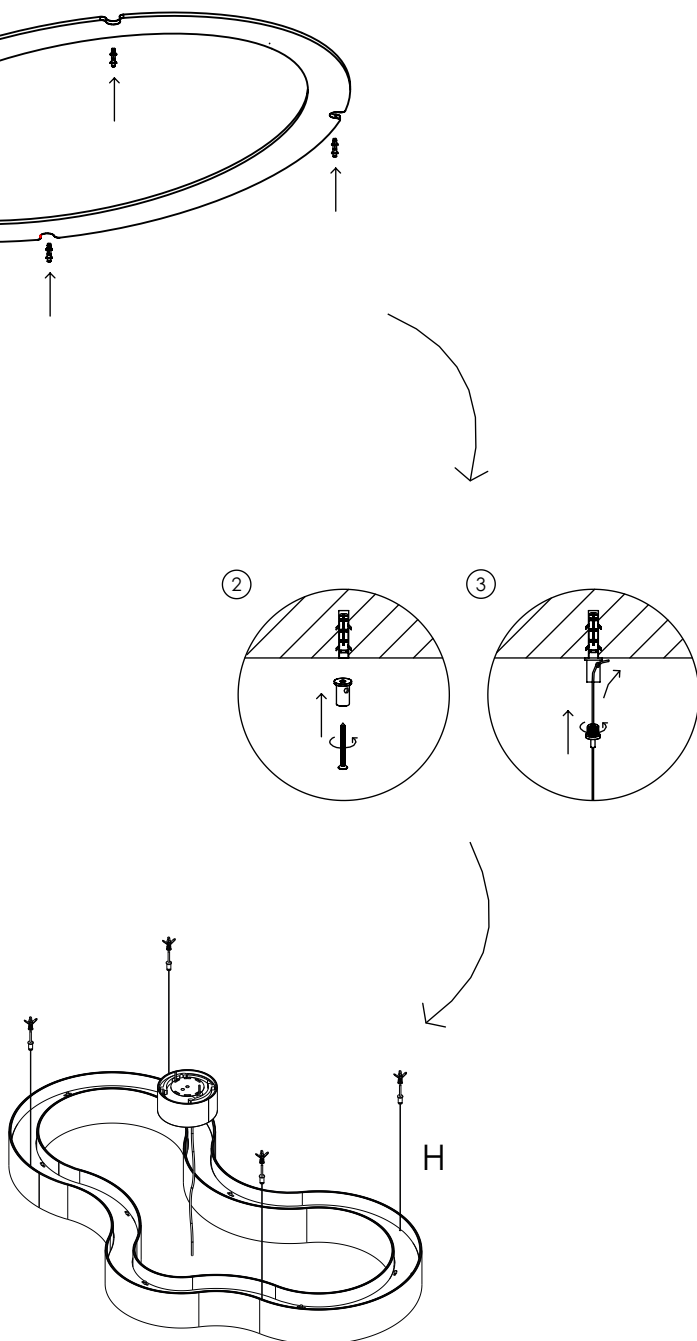

ADJUSTING THE FIXTURE HEIGHT

Choose the height (H) you want the luminaire to hang below the ceiling by pushing on the anchor to release tension. While pressing the tip, move the cable until it reaches the desired length. Release the tip and the cable will be locked again. Final adjustments can be made after the fixture is mounted.

Now you are ready to make the electrical connection.

ATTENTION!



FAILURE TO COMPLY WITH THESE INSTRUCTIONS MAY CAUSE ACCIDENTS AND LOSS OF PRODUCT WARRANTY.
It is recommended to read these instructions completely and carefully before proceeding.

SAVE THESE INSTRUCTIONS FOR FUTURE REFERENCE.

ACCORD Lighting guarantees coverage against manufacturing defects including electrical components and finishes, for a period of three years, under normal use, from the date of purchase. For warranty service, please contact your local dealer for further instructions. Proof of date of purchase will be required for validation of warranty service.

The responsibility of the manufacturer regarding the product warranty is related to the correct observation of the instructions contained in this manual. The manufacturer is not responsible for any damage to the product caused by accidents, alterations of any kind, improper usage or improper installation. See the website for additional warranty details.

ACCORD Lighting reserves the right to change the dimensions and specifications contained in this manual without prior notice, in accordance with its policy of continuous product improvement. Please, contact the manufacturer if additional information is necessary. The illustrations in this manual are for guidance only and may vary in scale, dimensions and model details.

WARNING!



Be sure electrical power is OFF before and during installation or maintenance.
The luminaire must be installed by a qualified electrician, in accordance with all applicable local codes.

Ensure that the rated luminaire voltage requirements are compatible with the available mains supply in which it will be installed.
All LEDs are included in your lamp. Never touch the LED surface with your bare hands as this may reduce the life of your LED.
Do not alter, relocate or remove any electrical component.

Ref.	/	Wattage
1345	/	21W
1346	/	28W
1347	/	35W
1348	/	44W

JUNCTION BOX
(NOT SUPPLIED)

CONNECTORS
(NOT SUPPLIED)

GROUND

WHITE (NEUTRAL)

BLACK (HOT)

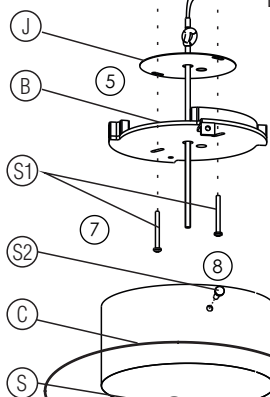

Input voltage: 120-277 V

Input frequency: 60 Hz

Isolation: Class II

Material: Natural Wood Veneer MDF and Acrylic

INSTALLATION AND ELECTRICAL CONNECTIONS

- Pass the flat 3 core cable through the support base (B) and the junction box cover (J).
- Using the white flat 3 core cable, make the electrical connections to the mains supply, in accordance with all safety standards and local electrical codes.
This product must be installed in accordance with the applicable installation code by a person familiar with the construction and operation of the product, and the hazards involved.
- Screw the junction box cover (J) and the support base (B) into the junction box using the provided (S1) screws.
- With the support base fixed and secured, bring the canopy close to the support base, slide it in and rotate it to lock it in place. Fasten the finishing screw (S2) to secure the canopy to the support base.

Turn ON the electrical power, the luminaire is ready for use.

DIMMER COMPATIBILITY

The LED driver included with this fixture is designed to operate with most standard dimmers. All power ratings and installation instructions from dimmer manufacturers' instruction sheets must be followed.

ATTENTION!



FAILURE TO COMPLY WITH THESE INSTRUCTIONS MAY CAUSE ACCIDENTS AND LOSS OF PRODUCT WARRANTY.
It is recommended to read these instructions completely and carefully before proceeding.

PROVIDED SCREWS



S1

SAVE THESE INSTRUCTIONS FOR FUTURE REFERENCE.

ACCORD Lighting guarantees coverage against manufacturing defects including electrical components and finishes, for a period of three years, under normal use, from the date of purchase. For warranty service, please contact your local dealer for further instructions. Proof of date of purchase will be required for validation of warranty service.

The responsibility of the manufacturer regarding the product warranty is related to the correct observation of the instructions contained in this manual.
The manufacturer is not responsible for any damage to the product caused by accidents, alterations of any kind, improper usage or improper installation.
See the website for additional warranty details.

ACCORD Lighting reserves the right to change the dimensions and specifications contained in this manual without prior notice, in accordance with its policy of continuous product improvement. Please, contact the manufacturer if additional information is necessary. The illustrations in this manual are for guidance only and may vary in scale, dimensions and model details.