

# LED Exterior Pendant

# EP265104

INSTALLATION SHEET

## START FROM HERE

- Make sure **POWER** is **COMPLETELY OFF** at the fuse box
- Have your fixture installed by a qualified licensed electrician
- Prepare everything in a clear area
- Wear gloves at all times during this installation
- Read instructions carefully before you start assembly
- Keep this installation sheet for future reference

Technical Support: 1-855-855-8926

## Please Note:

- This Kuzco LED fixture comes with pre-wired LED module(s)
- Unless instructed, Do Not touch any part of the LED module(s) as any unnecessary contact with the module could cause permanent damage
- For dimming, an ELV (Electronic Low Voltage) type of dimmer is required
- Must be installed on a covered ceiling
- 120V input

## PREPARING FIXTURE

1. Remove EC265104 from original packaging
2. Identify the following parts to be discarded from EC265104 package (**See Illustration 1**)
3. Disconnect the power lead wire by disengaging the quick connector. Discard the power lead wire (**6a**). A longer power lead wire is provided in the X-265-EP-ROD-SET package.
4. Assemble the rod adaptor plate (**4a**) using the threaded tube (**4b**), tooth washer (**4c**) and nut (**4d**) (**See Illustration 2**)
5. Connect the power lead wires included in the X-265-EP-ROD-SET package using the quick connector provided (**3e**)
6. Attach safety cable (**5a**) to fixture (**3a**)
7. Run the power lead wires (**7a**) and safety cable (**5a**) through the rod adaptor plate (**4a**)
8. Secure fixture (**3a**) to rod adaptor plate (**4a**) with screws (**4e**)

ILLUSTRATION 1

Discard the following parts from EC265104 package

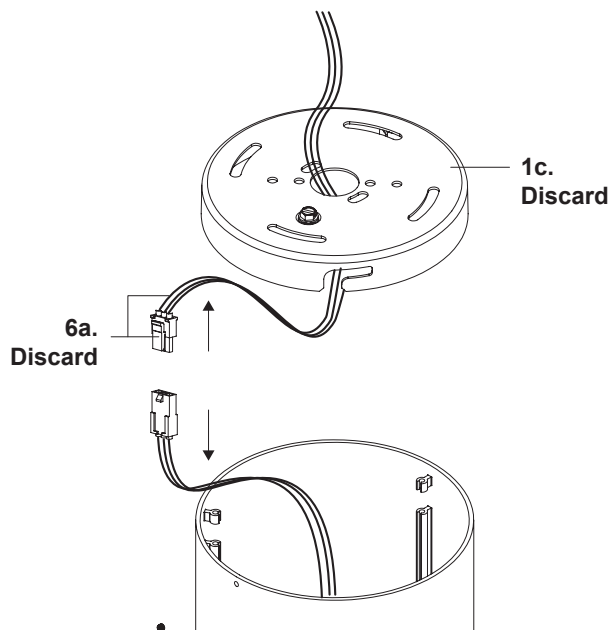
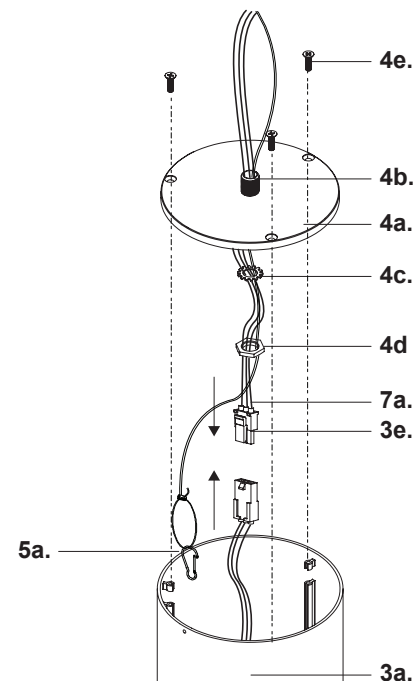

ILLUSTRATION 2

Assembling fixture parts



# KUZCO

19054 28th Avenue Surrey, BC Canada V3Z 6M3  
T: 604 538 7162 TF: 1-855 85 KUZCO F: 604 538 7196  
W: kuzcolighting.com  
20250818

# LED Exterior Pendant

# EP265104

INSTALLATION SHEET

## START FROM HERE

- Make sure **POWER** is **COMPLETELY OFF** at the fuse box
- Have your fixture installed by a qualified licensed electrician
- Prepare everything in a clear area
- Wear gloves at all times during this installation
- Read instructions carefully before you start assembly
- Keep this installation sheet for future reference

Technical Support: 1-855-855-8926

## Please Note:

- This Kuzco LED fixture comes with pre-wired LED module(s)
- Unless instructed, Do Not touch any part of the LED module(s) as any unnecessary contact with the module could cause permanent damage
- For dimming, an ELV (Electronic Low Voltage) type of dimmer is required
- Must be installed on a covered ceiling
- 120V input

## INSTALLING FIXTURE

1. Remove fixture parts from rod set package
2. Separate mounting plate (1c) from canopy (2a) by removing decorative nuts (2c)
3. Align mounting plate screws (1d) to desired orientation, and then attach mounting plate (1c) to electrical junction box (1a) using junction box screws provided (1e) in hardware package
4. Secure safety cable (5a) in aircraft barrel (5b) with screw and attach to a suitable supporting member in the ceiling (See Illustration 3)
5. Determine hanging height of fixture by securing rods (2d) to canopy (2a) and fixture head (3a) after feeding fixture wires and safety cable (5a) through rods
6. Make proper electrical connections (black to hot "L", white to neutral "N", ground to "GND") with wire nuts (1b) provided in hardware package
7. Align and insert mounting plate screws (1d) through holes on canopy (2a), secure with decorative nuts (2c)

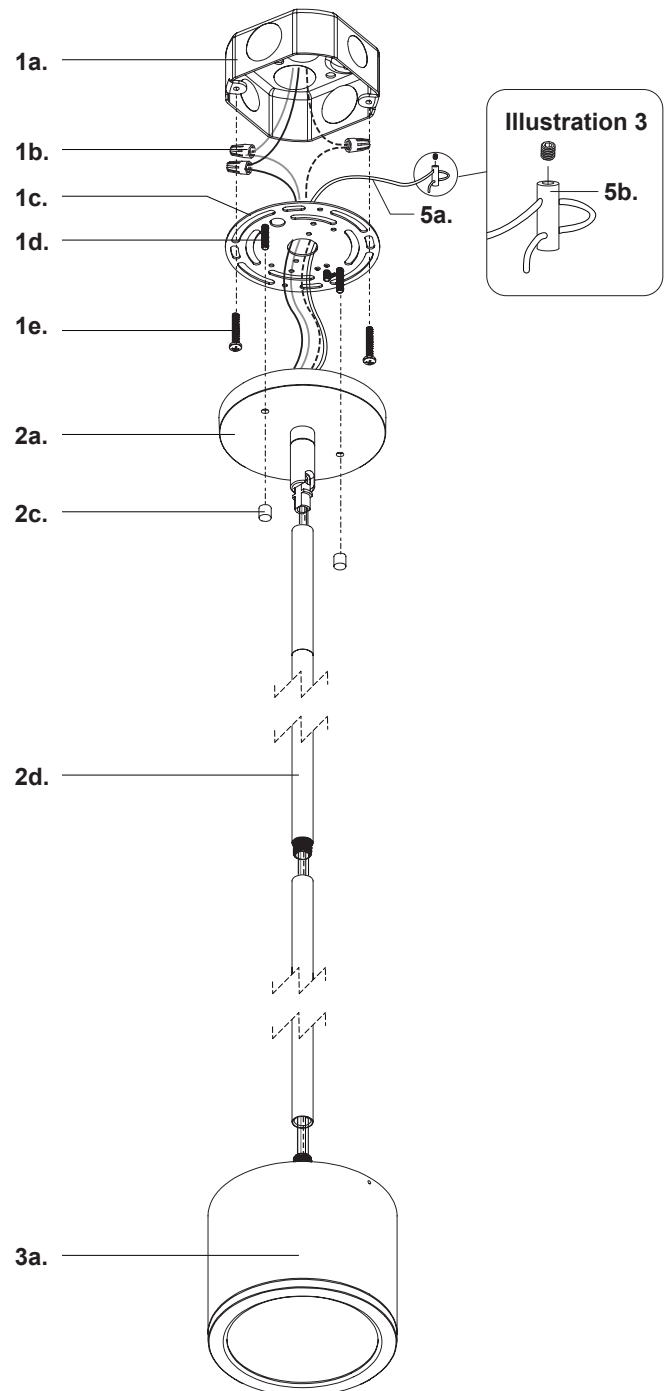

# KUZCO

19054 28th Avenue Surrey, BC Canada V3Z 6M3  
T: 604 538 7162 TF: 1-855 85 KUZCO F: 604 538 7196  
W: kuzcolighting.com  
20250818