

## Socket + Column + Plate

### Assembly Instructions

VIRO-0005



THIS PRODUCT MUST BE INSTALLED IN  
ACCORDANCE WITH THE APPLICABLE  
INSTALLATION CODE BY A PERSON FAMILIAR  
WITH THE CONSTRUCTION AND OPERATION OF  
THE PRODUCT AND THE HAZARDS INVOLVED



Scan to view online

# VIRO-0005 Parts List

Part Names and Quantities

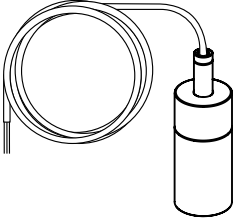
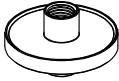
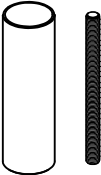
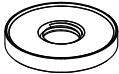
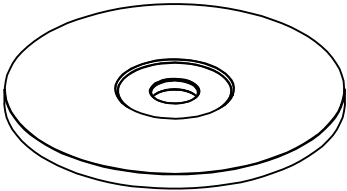
	<p><b>VIRO-PEN-0001</b> 1 Socket + Cord</p>
	<p><b>VIRO-COM-0008</b> 1 Check Ring B</p>
	<p><b>VIRO-CLM-XXXX</b> 1 Column + 1 Threaded Tube</p>
	<p><b>VIRO-COM-0007</b> 1 Check Ring A</p>
	<p><b>VIRO-SHD-0007</b> 1 Shade  (your shade may look different)</p>

# READ FIRST

## BEFORE CUTTING THE CORD

To cut the cord, follow these steps to prevent the cord's cloth cover from fraying and to ensure successful assembly and installation.

1. Determine the position the cord hangs from the canopy. The cut position is 3 inches above that.



2. Wrap electrical tape around the cut position.



3. Cut the cord in the middle of the electrical tape and continue to assemble and install the fixture as shown in the instructions.



4. After the fixture is assembled and during canopy installation, remove the tape, strip the cord and wires, then connect them to your junction box's wires as shown in the instructions.

# 1. Disassemble VIRO-PEN-0001

Disassemble parts in the order shown

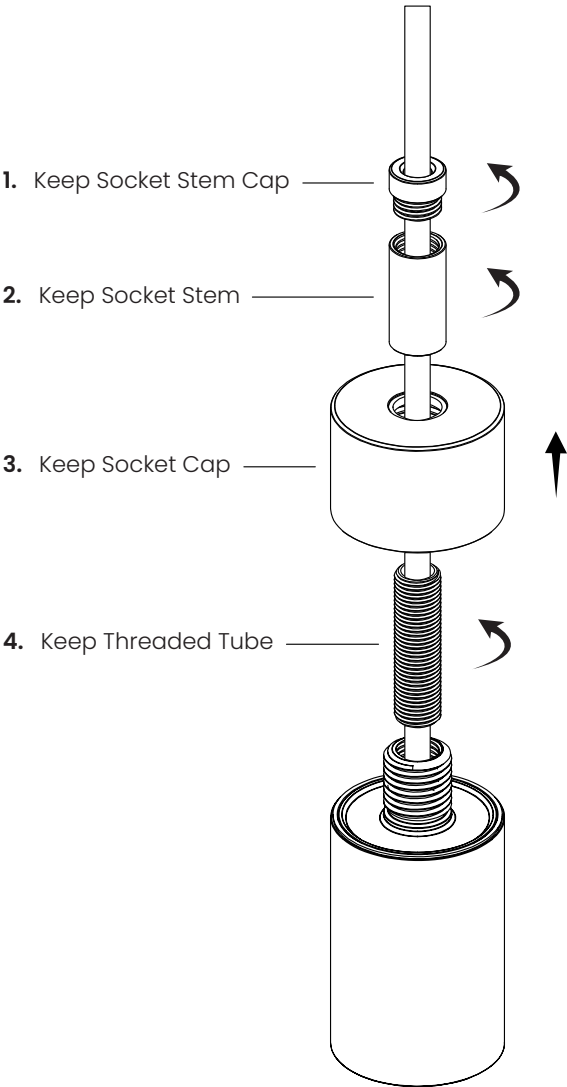

## 2. Assemble VIRO-0005

Assemble parts in the order shown

4. Assemble the Column  
**VIRO-CLM-XXXX**

3. Assemble the threaded tube included with the Column  
**VIRO-CLM-XXXX**

2. Assemble the Check Ring A  
**VIRO-COM-0007**

1. Assemble the Plate  
**VIRO-SHD-0007**

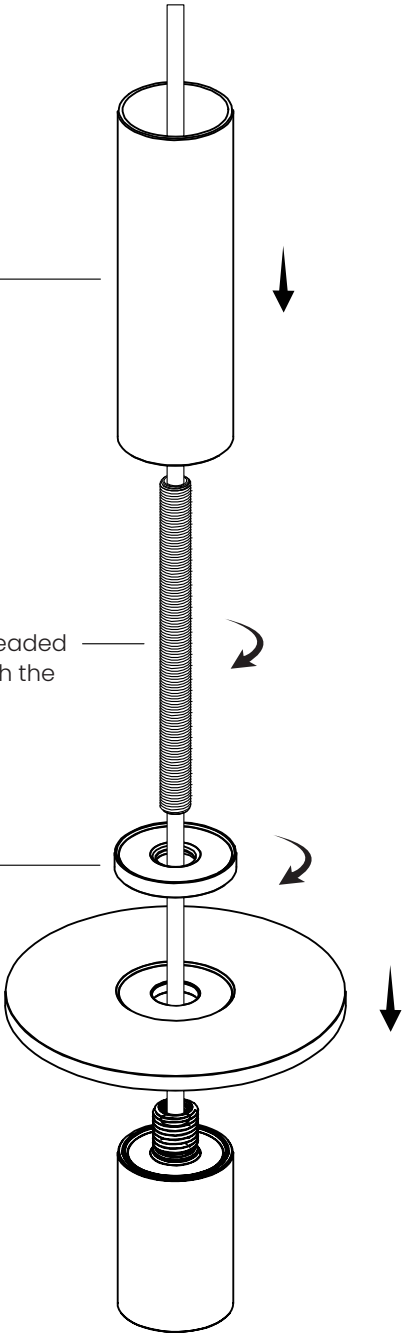

### 3. Assemble VIRO-0005 (cont.)

Assemble parts in the order shown

- 5. Assemble the Socket Stem —  
Cap from **VIRO-PEN-0001**
- 4. Assemble the Socket Stem —  
from **VIRO-PEN-0001**
- 3. Assemble the Socket Cap —  
from **VIRO-PEN-0001**
- 2. Assemble the Threaded —  
Tube from **VIRO-PEN-0001**
- 1. Assemble the —  
Check Ring B  
**VIRO-COM-0008**

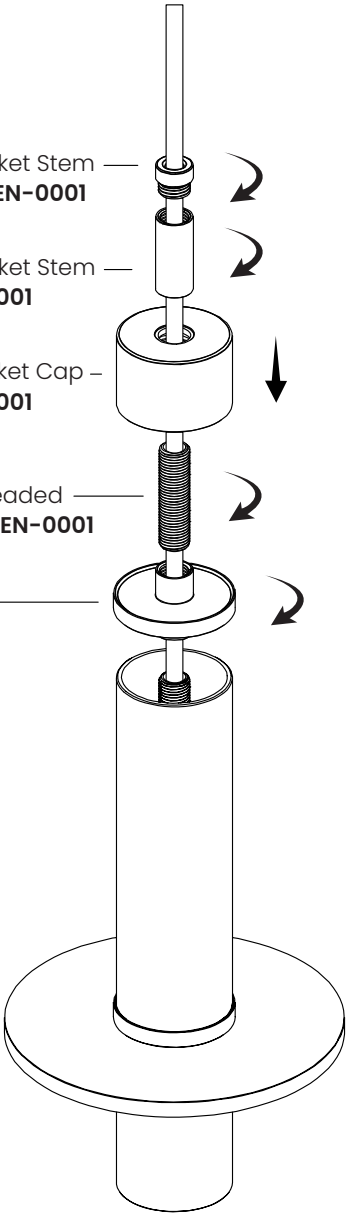



# VIRO Pendant Canopy

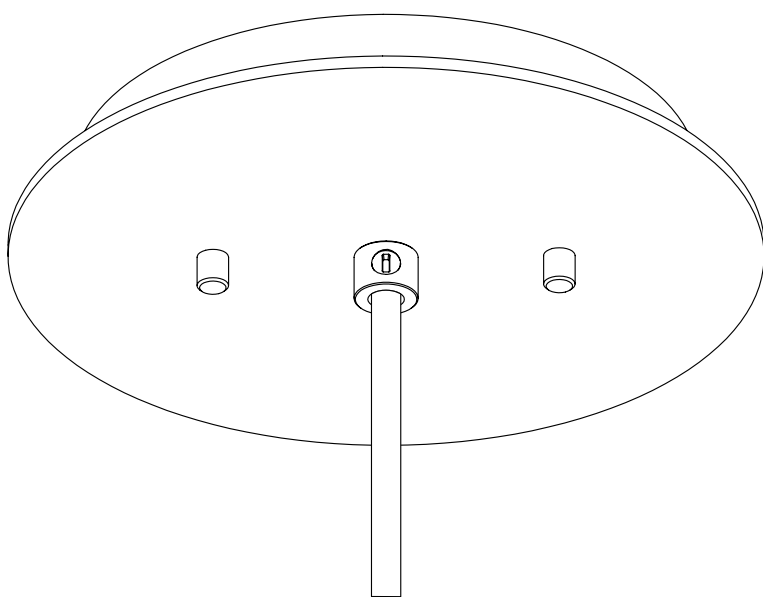

## Single Canopy

### Assembly Instructions

VIRO-CAN-0001





THIS PRODUCT MUST BE INSTALLED IN  
ACCORDANCE WITH THE APPLICABLE  
INSTALLATION CODE BY A PERSON FAMILIAR  
WITH THE CONSTRUCTION AND OPERATION OF  
THE PRODUCT AND THE HAZARDS INVOLVED



Scan to view online

**VIRO-CAN-0001**

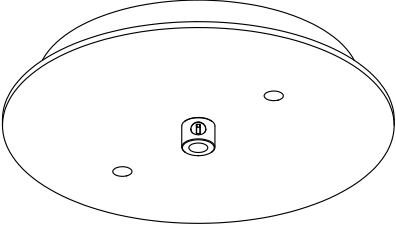
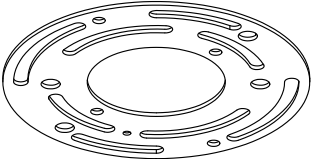
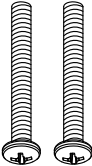
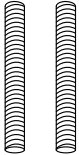
Part Names and Quantities

	<p><b>VIRO-CAN-0001</b></p> <p>Single Canopy</p>
	<p>1 Universal Mount</p>
	<p>2 8-32 Junction Box Screws</p>
	<p>2 Canopy Mount Threaded Rod</p>
	<p>2 Locking Nuts</p>
	<p>2 Wire Nuts</p>



## 1. Install the universal mount

Screw the Universal Mount onto the ceiling junction box

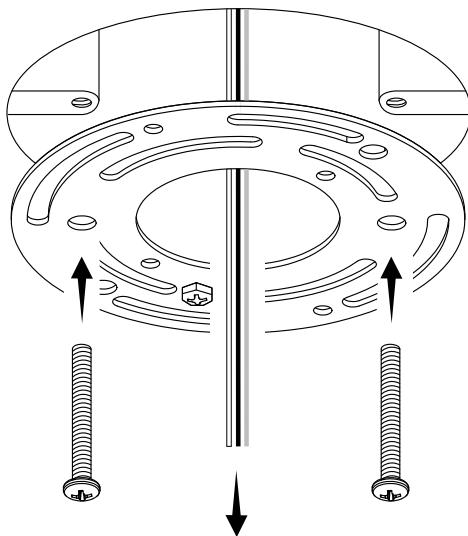

## 2. Install the canopy mounting rods

Screw the threaded rods into the universal mount

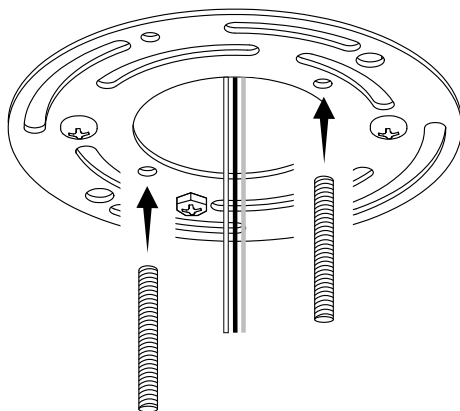

### 3. Install the cord into the canopy

Cut the cord to length, insert it into the canopy and lock it

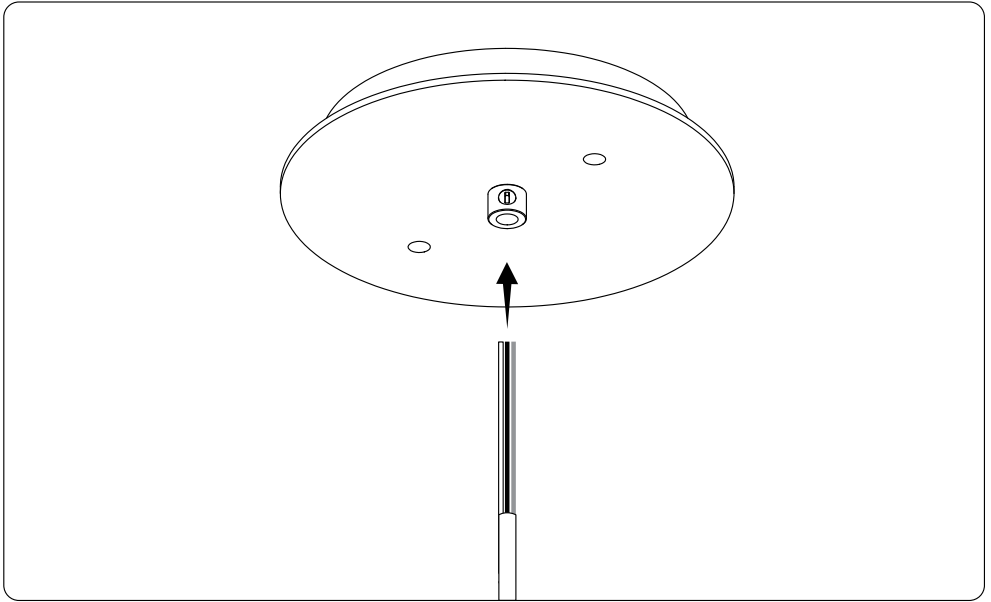

### 4. Connect the electric and ground wires

Connect ground wires to ground terminal and match power with power and neutral with neutral wires

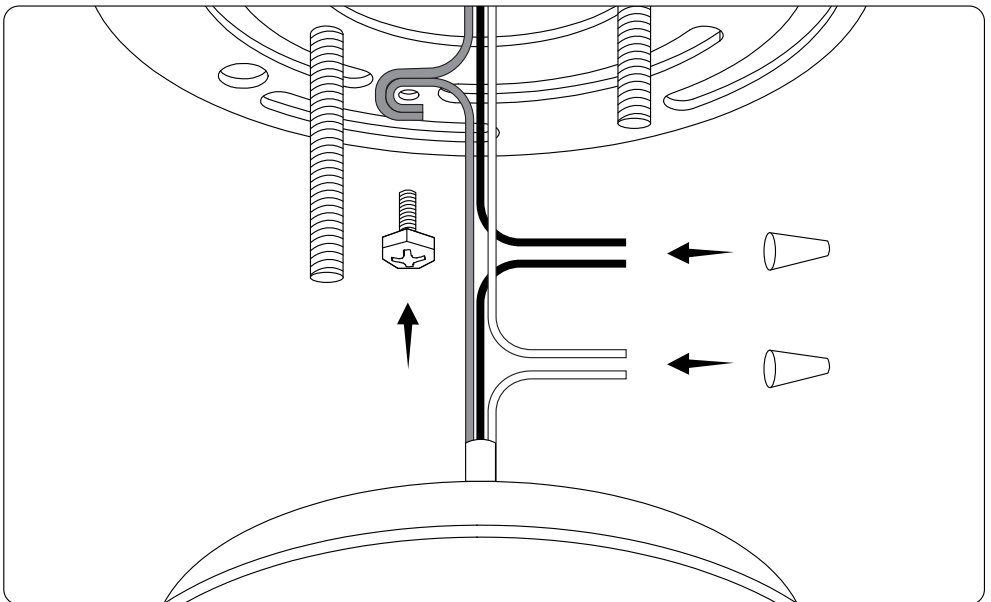

## 5. Install the canopy

Align the canopy to the mounting rods and install

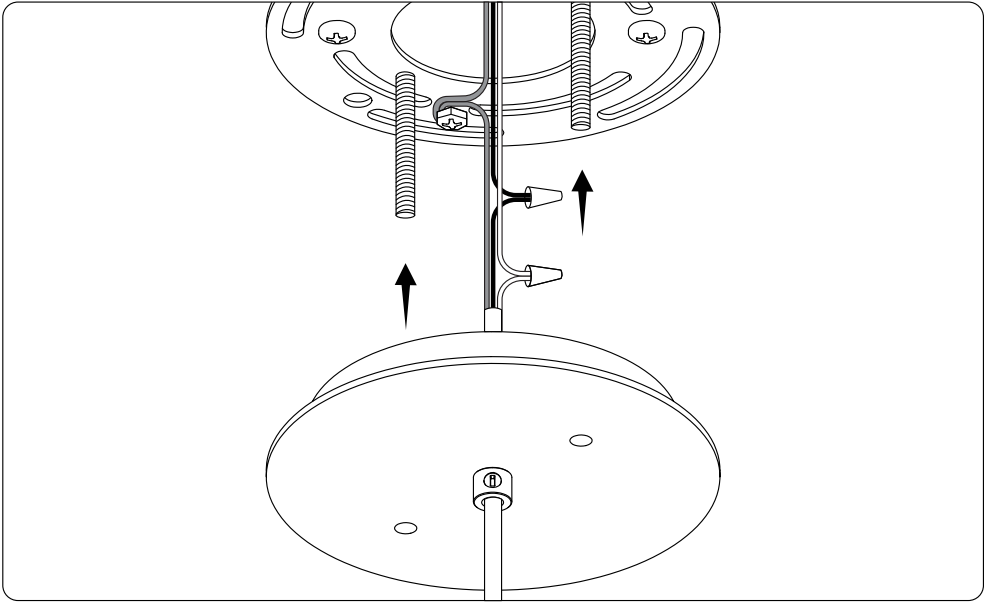

## 6. Lock the canopy in place

Screw the locking nuts onto the canopy mounting rods

