

ASSEMBLY & INSTALLATION INSTRUCTIONS

C135

Lattice Torchiera - 241204

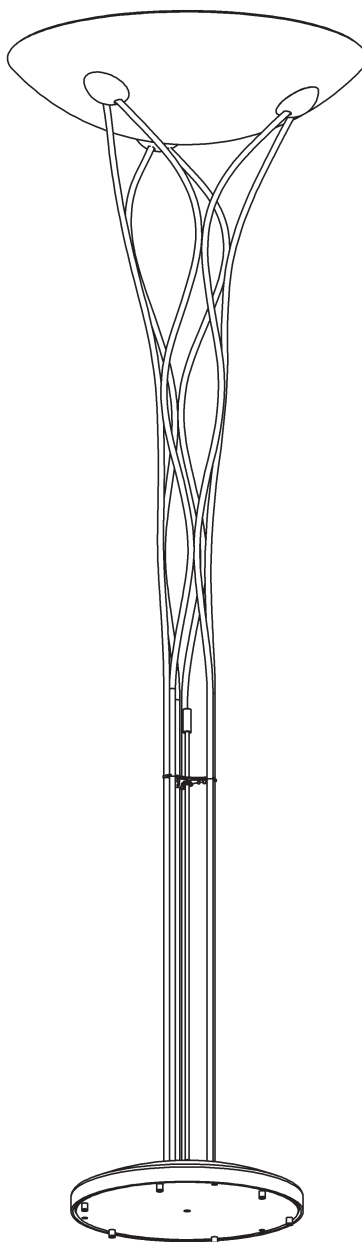

HUBBARDTON FORGE.

MODERN AMERICAN BLACKSMITHS | FINE, HAND CRAFTED LIGHTING
CASTLETON, VERMONT USA | HUBBARDTONFORGE.COM

59190

1 OF 6

Component Parts

A	Base Assembly
B	Base Plate
C	Flat Head Screw (3)
D	Power Cord
E	Top Assembly
F	Socket Stem
G	Base Tube
H	Short Screws (3)
I	Cover Plate
J	Grommet
K	Dimmer
L	Dimmer Rod
M	Dimmer Coupling
N	Set Screw
O	Glass
P	Socket (3)
Q	Bulb (3 - not included)
R	Bumpon (6)



CAUTION: FAILURE TO INSTALL THIS FIXTURE PROPERLY MAY RESULT IN SERIOUS PERSONAL INJURY OR DEATH AND PROPERTY DAMAGE. We recommend installation by a licensed electrician. This product must be installed in accordance with applicable installation code(s), by a person familiar with the construction and operation of the product and the hazards involved.*

Caution: Do not exceed maximum wattage noted on fixture. Use only recommended bulbs with fixture.

Prepare Fixture (Figure 1)

1. Carefully unpack all parts from the carton.
2. Locate base assembly (A) with base plate (B) attached.
3. Lay base assembly (A) on it's side on a soft surface to prevent damage to fixture finish.
4. Remove (3) flat head screws (C) from base assembly (A). Retain for later step.
5. Remove base plate (B) and lay next to base (A).

Caution: Be careful as plate (B) will still be attached with wires.

6. Follow steps on next page to continue fixture assembly.

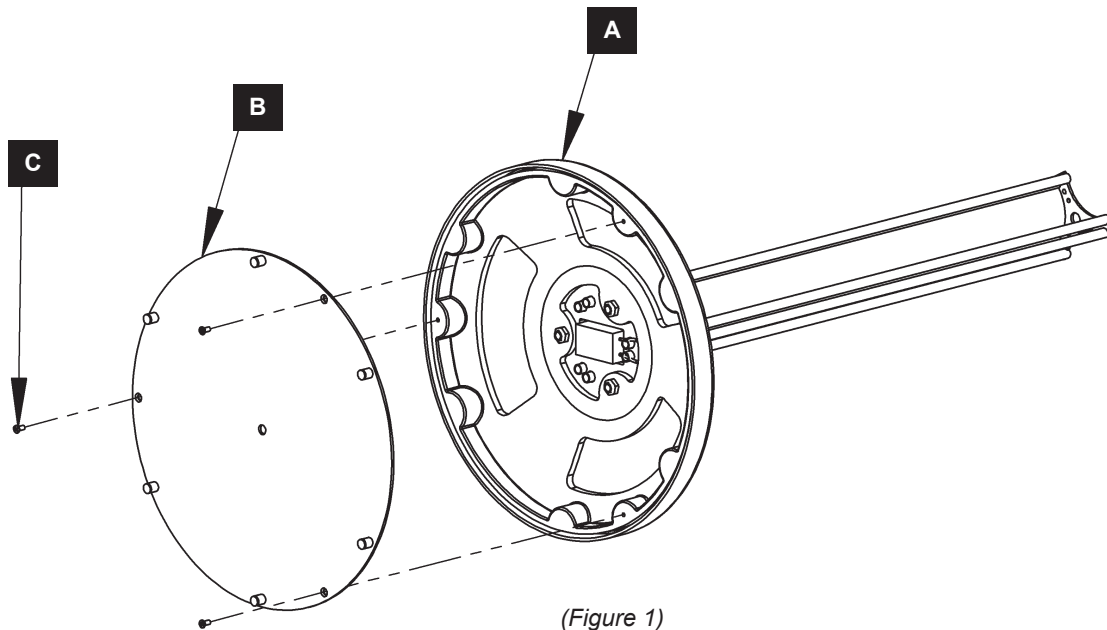

(Figure 1)



Lattice Torchiere - 241204

Assemble Fixture (Figure 2)

1. Locate top assembly (E)
2. Carefully lay top assembly (E) on it's side near base assembly (A) as seen in Figure 2.
3. Run individual black and white socket wires from socket stems (F), through base tubes (G) until wires exit in base assembly (A).
4. Align pins in countersunk plate with holes in threaded plate.
5. Slide top assembly (E) and base assembly (A) together. Install (3) short screws (H) and tighten to secure top and base assemblies (E & A).

Caution: Be sure no wires are pinched between the two plates.

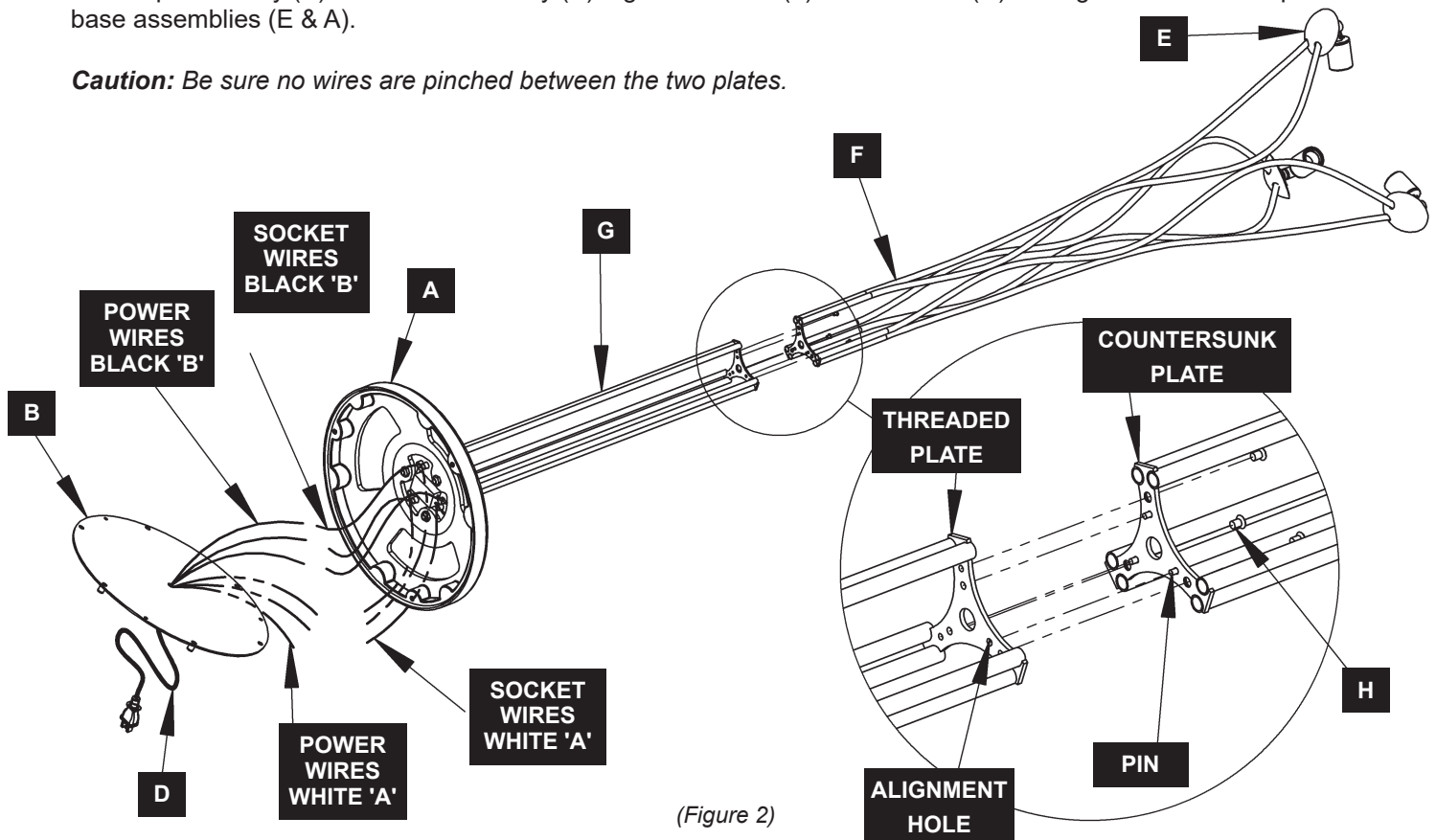

(Figure 2)

6. In base assembly (A), locate white socket wires with connectors attached. They will be labeled A.
7. Locate white power wires that are also labeled A. Connect white socket wires and white power wires by pushing supplied connectors together until you hear a snap.
8. Repeat for black wires - labeled B.

Caution: Be sure connectors are snapped together fully and no bare metal is exposed.

9. Tuck all wires into base assembly (A) and re-install base plate (B) using flat head screws (C).
10. Stand fixture upright and follow next steps to continue assembly.



HUBBARDTON FORGE.

MODERN AMERICAN BLACKSMITHS | FINE, HAND CRAFTED LIGHTING
CASTLETON, VERMONT USA | HUBBARDTONFORGE.COM

Lattice Torchiere - 241204

To Install Dimmer Rod (Figure 3)

1. Locate cover plate (I) and grommet (J).
2. Place cover plate (I) on countersunk plate.
3. Install grommet (J) through all three plates to hold cover (I) in place. A small flat head screw driver can aid in grommet install.
4. Locate dimmer rod (L) which is shipped with knob attached.
5. Slide dimmer rod (L) through grommet (J) in cover plate (I).
6. Thread dimmer coupling (M) onto bottom of dimmer rod (L) and tighten securely.
7. Slide dimmer coupling (M) over dimmer (K) in base assembly (A) and secure in place by tightening set screw (N).

Note: It may be necessary to loosen set screw to allow coupling to slide onto dimmer.

8. See next page for glass install.

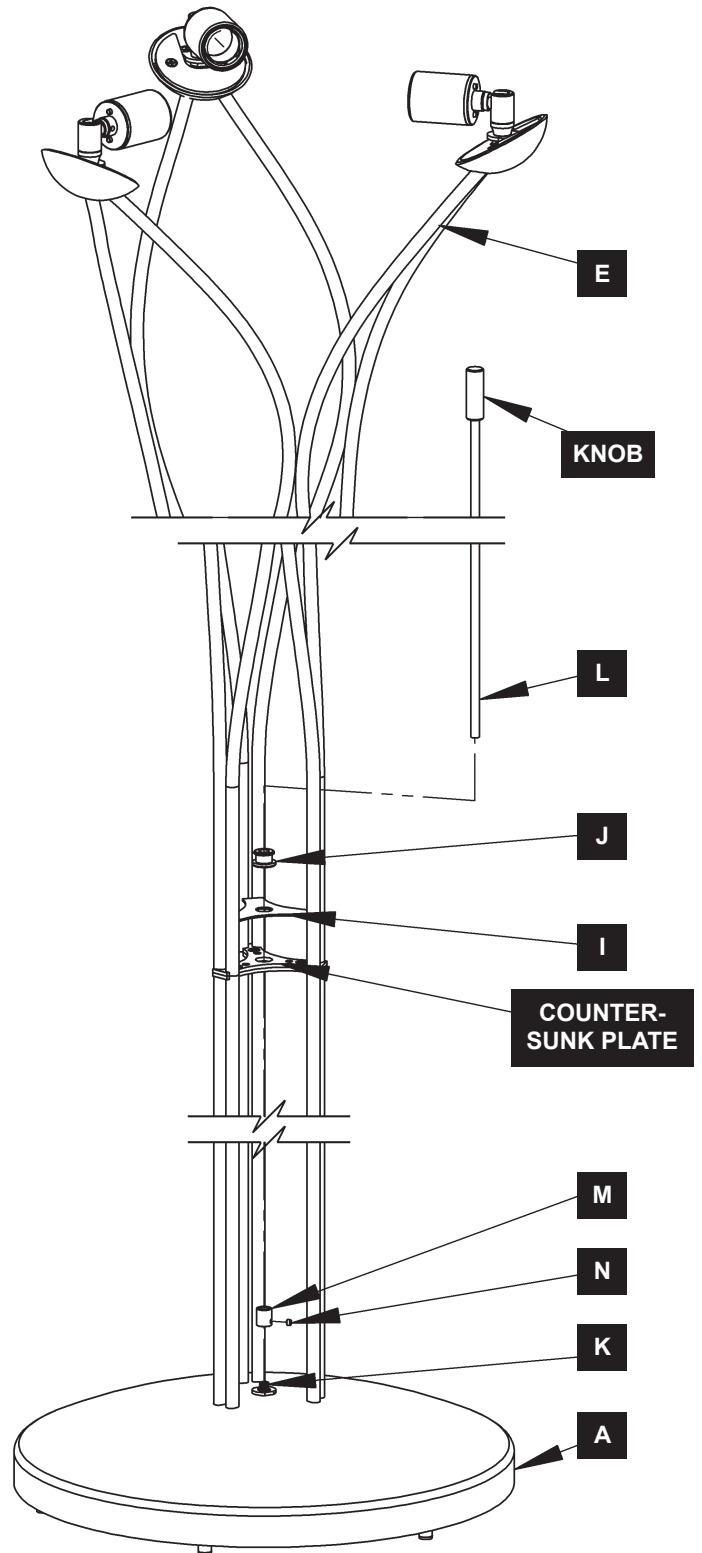

(Figure 3)



HUBBARDTON FORGE.

MODERN AMERICAN BLACKSMITHS | FINE, HAND CRAFTED LIGHTING
CASTLETON, VERMONT USA | HUBBARDTONFORGE.COM

Lattice Torchiere - 241204

Install Glass (Figures 4 & 5)

1. Carefully unpack glass (O)
2. Sockets (P) are mounted on swivels; rotate sockets (P) until facing upward as seen in Figure 4.
3. Carefully slide glass (O) over sockets (P) and set on top assembly (E).
4. Rotate swivels back to 90 degrees as seen in Figure 5.
5. If desired, clear rubber bumpers (R) can be installed to top assembly (E) to hold glass from rotating. See Figure 5.

Note: Do not place rubber bumpers underneath glass.

6. Plug in power cord.

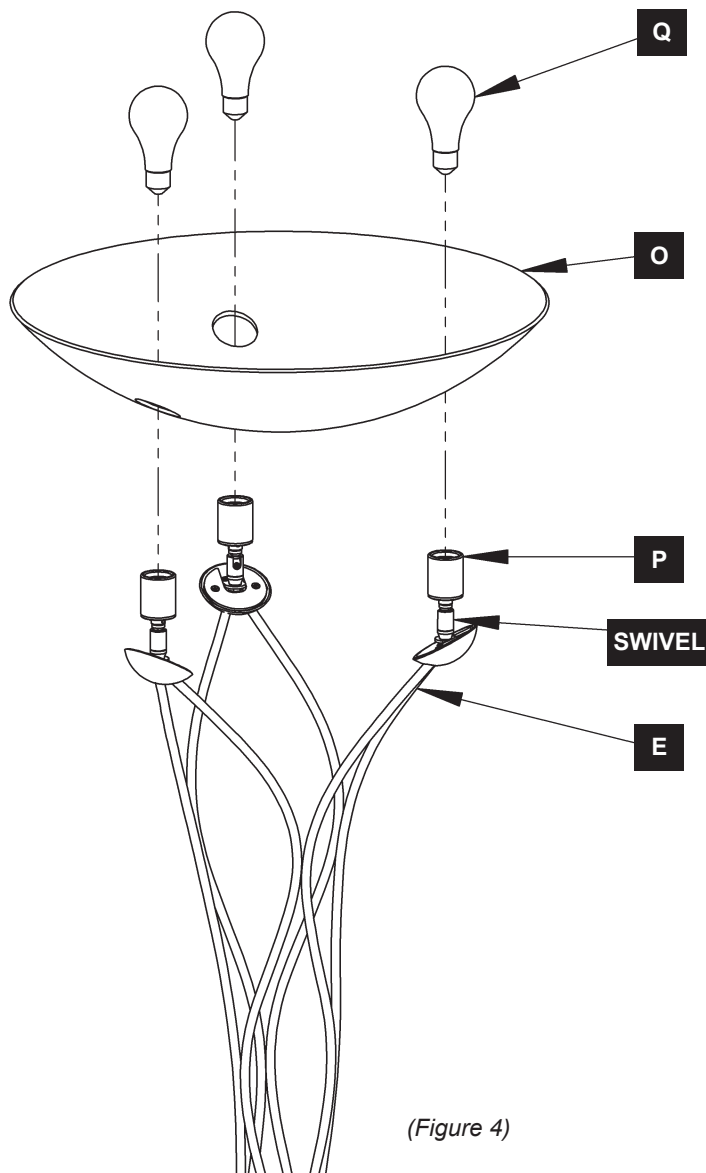

(Figure 4)

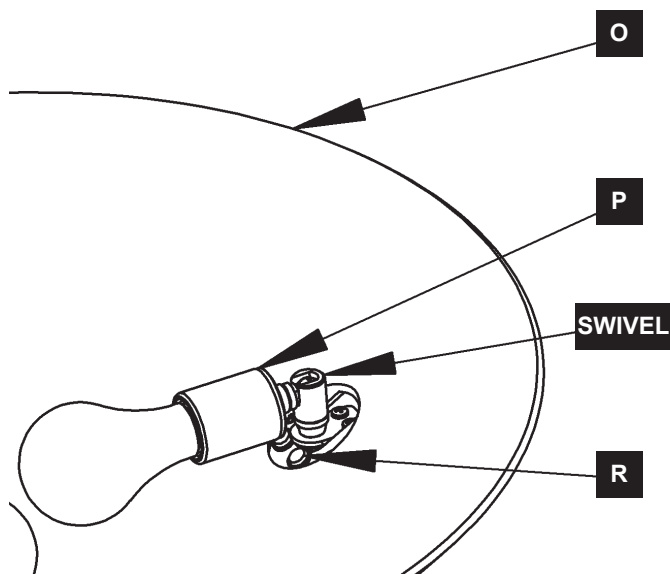

(Figure 5)

If you need further assistance, or find that you are missing any parts, please contact the dealer from which you purchased this product. We hope you enjoy your fixture! * **Hubbardton Forge will not be liable for injury or damage caused by improper installation, lamping or use of this fixture.**



HUBBARDTON FORGE.

MODERN AMERICAN BLACKSMITHS | FINE, HAND CRAFTED LIGHTING
CASTLETON, VERMONT USA | HUBBARDTONFORGE.COM